

STATE OF ILLINOIS  
DEPARTMENT OF TRANSPORTATION  
DIVISION OF HIGHWAYS

**PROPOSED  
FEDERAL AID PROJECT**

ILLINOIS ROUTE 59 PEDESTRIAN BRIDGE  
VIRGIL GILMAN TRAIL WEST AND VIRGIL GILMAN TRAIL EAST  
SECTION: 05-00130-00-BR  
PROJECT: M-8003(642)  
JOB NO.: C-91-355-06  
CITY OF NAPERVILLE  
WILL COUNTY

F.A. RTE.	SECTION	COUNTY	TOTAL SHEETS	SHEET NO.
	05-00130-00-BR	WILL	41	1
STA.	TO STA.			
FED. ROAD DIST. NO.	ILLINOIS	FED. AID PROJECT		
CONTRACT NO. 83889				

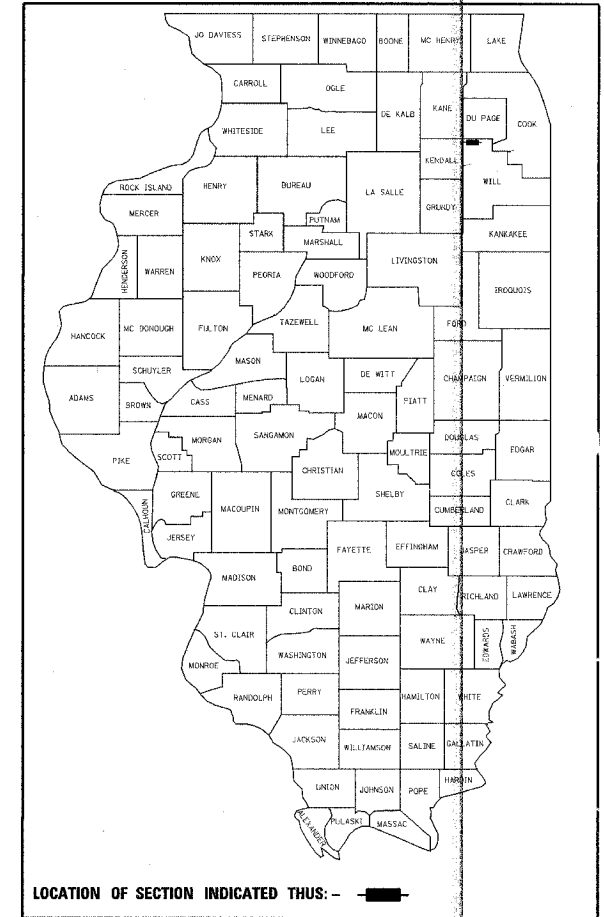

CITY OF NAPERVILLE

Approved December 8 2006  
*[Signature]*  
CITY ENGINEER

Passed JANUARY 10 2007  
*[Signature]*  
DISTRICT 1 ENGINEER OF LOCAL ROADS AND STREETS

Releasing for Bid Jan. 10 2007  
Based on Limited Review  
*[Signature]*  
DEPUTY DIRECTOR OF HIGHWAYS, REGION 1 ENGINEER

**PRINTED BY THE AUTHORITY  
OF THE STATE OF ILLINOIS**

PLANS PREPARED BY:  
**URS** 100 S. WACKER DR, STE 500 TEL (312) 939-1000  
CHICAGO IL, 60606 FAX (312) 939-4198

INDEX OF SHEETS

SHEET NO.	DESCRIPTION
1	TITLE & INDEX OF SHEETS
2	GENERAL NOTES, STANDARDS
3	SUMMARY OF QUANTITIES
4	TYPICAL SECTIONS
5-6	PLAN AND PROFILE SHEETS (ALIGNMENT & TIES INCLUDED)
7-8	ROADWAY DETAILS
9-12	LIGHTING SHEETS
13-35	STRUCTURAL SHEETS
36-41	CROSS SECTIONS

HIGHWAY STANDARDS, SEE SHEET NO. 2

TRAFFIC DATA  
AD<sub>1</sub> (2003) = 11,400 (RTE 59)  
POSTED SPEED = 40 mph

BENCHMARKS  
TBM-1 = SQUARE CHISELED @ S.E.X. OF COMED BOX  
NORTH-SIDE OF ACCESS ROAD HALFWAY DOWN.  
E.L. = 667.495  
TBM-2 = "X" CHISELED @ P.C. OF CURB @ S.W.X. OF  
STORAGE PROPERTY LINE.  
E.L. = 687.565

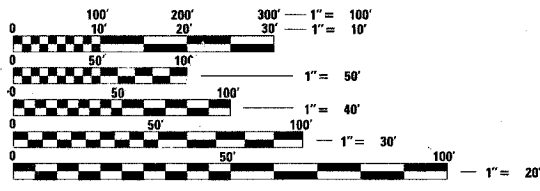

FULL SIZE PLANS HAVE BEEN PREPARED USING STANDARD ENGINEERING SCALES. REDUCED SIZED PLANS WILL NOT CONFORM TO STANDARD SCALES. IN MAKING MEASUREMENTS ON REDUCED PLANS, THE ABOVE SCALES MAY BE USED.

J.U.L.I.E.  
JOINT UTILITY LOCATION INFORMATION FOR EXCAVATION  
1-800-892-0123

PROJECT LIMIT  
STATION 120+17.84

SN = 099-6002

PROJECT LIMIT  
STATION 99+80

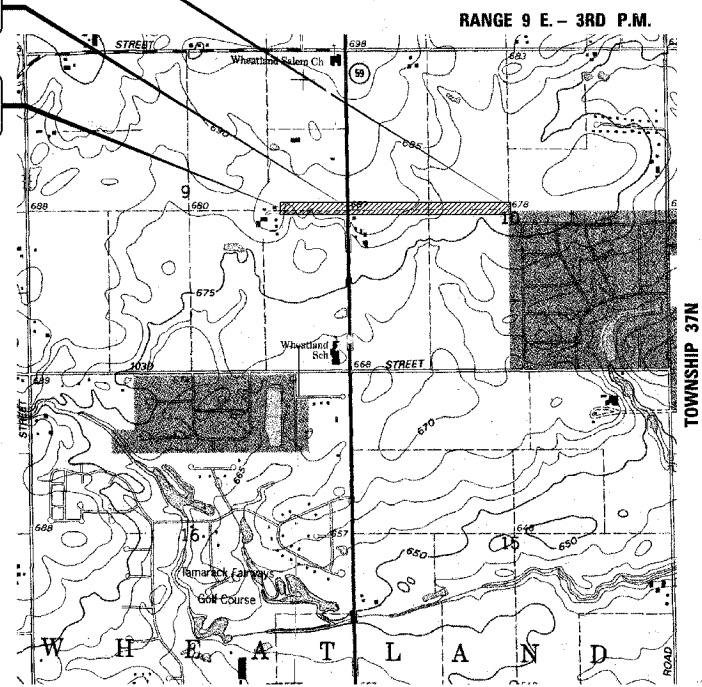

LOCATION MAP  
1"=800'

GROSS LENGTH AND NET LENGTH = 2037.84 FEET (0.4 MILES)

*[Signature]*  
11/30/2007 Date: 12-8-06  
Expires:

FEDERAL AID DESIGN ENGINEER: JESSICA A. FELICIA, J (047) 705-4787

CONTRACT NO. 83889