

04-27-2018 LETTING ITEM 074

STATE OF ILLINOIS
DEPARTMENT OF TRANSPORTATION

F.A. SITE	SECTION	COUNTY	TOTAL SHEETS	SHEET NO.
VAR.	D2 BDS 2018-2	VARIOUS	16	1
ILLINOIS CONTRACT NO. 64M86				

FOR INDEX OF SHEETS, SEE SHEET NO. 2
FOR STATE STANDARDS, SEE SHEET NO. 2

PROPOSED HIGHWAY PLANS

VARIOUS ROUTES
SECTION: D2 BDS 2018-2
TYPE of IMPROVEMENT: BRIDGE DECK SEALING
BOONE & CARROLL COUNTIES

C-92-040-18

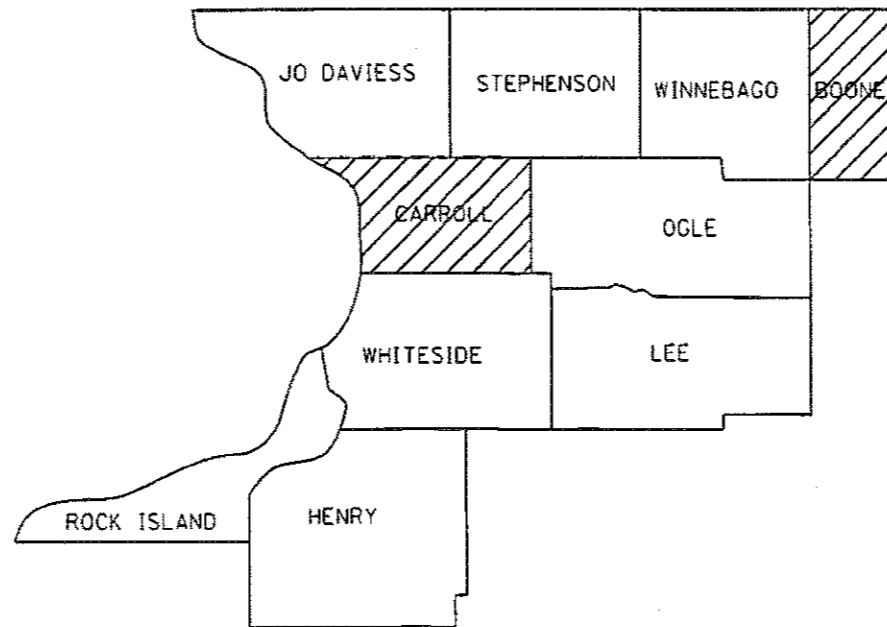
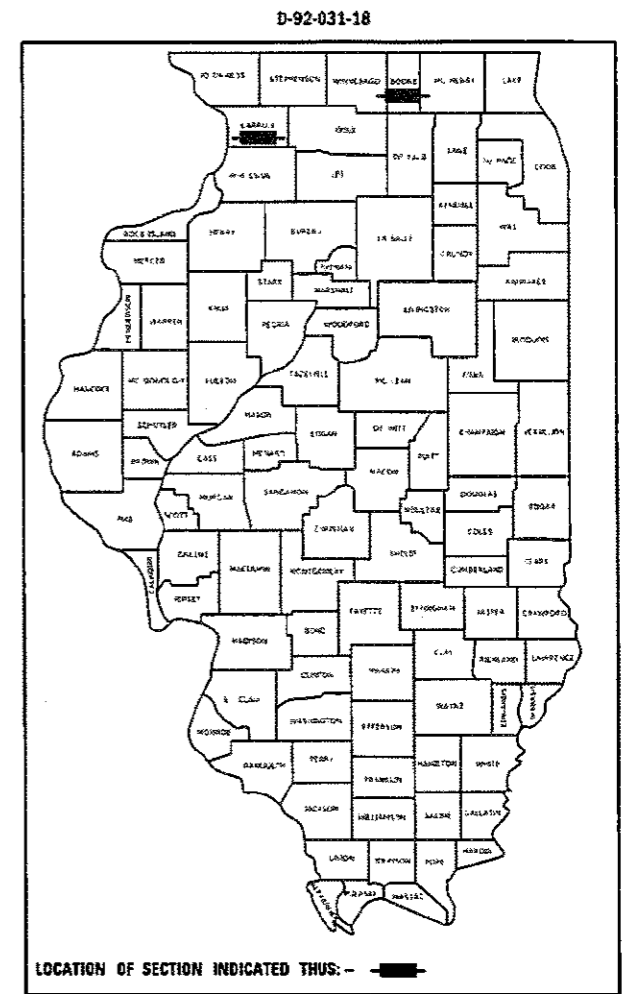

DISTRICT 2

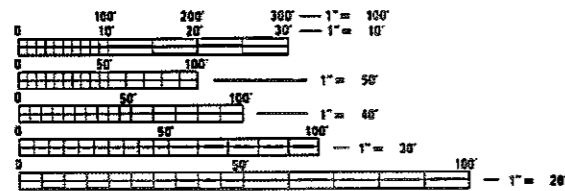

FULL SIZE PLANS HAVE BEEN PREPARED USING STANDARD ENGINEERING SCALES. REDUCED SIZED PLANS WILL NOT CONFORM TO STANDARD SCALES. IN MAKING MEASUREMENTS ON REDUCED PLANS, THE ABOVE SCALES MAY BE USED.

J.U.L.I.E.
JOINT UTILITY LOCATION INFORMATION FOR EXCAVATION
1-800-892-0123
OR 811

PROJECT ENGINEER: DAVID DOSS (815) 284-5416
PROJECT MANAGER: MAHMOUD ETEMADI (815) 284-5393

CONTRACT NO. 64M86

STATE OF ILLINOIS
DEPARTMENT OF TRANSPORTATION

SUBMITTED Feb. 7 2018
K. Marshall
REGIONAL ENGINEER

Mar 23 2018
Scott E. Elk
ENGINEER OF DESIGN AND ENVIRONMENT

Mar 23 18
David P. [Signature]
DIRECTOR OF HIGHWAYS PROJECT IMPLEMENTATION

PRINTED BY THE AUTHORITY
OF THE STATE OF ILLINOIS

INDEX OF SHEETS

- 1 COVER SHEET
- 2 INDEX OF SHEETS, STATE STANDARDS & GENERAL NOTES
- 3 SUMMARY OF QUANTITIES
- 4 SCHEDULE OF QUANTITIES
- 5 SEALING DETAIL
- 6 LOCATION MAP BOONE COUNTY
- 7 LOCATION MAP CARROLL COUNTY
- 8-11 WORK ZONE SIGN DETAILS (DISTRICT STANDARD 34.1)
- 12-15 TRAFFIC CONTROL FOR TRANSITION AREAS (DISTRICT STANDARD 38.1)
- 16 TRAFFIC CONTROL AND PROTECTION AT TURN BAYS (TO REMAIN OPEN TO TRAFFIC) (DISTRICT STANDARD 94.2)

GENERAL NOTES

THE CONCRETE SEALER SHALL BE APPLIED TO THE ENTIRE TOP SURFACE OF THE DECK, INCLUDING THE INSIDE FACES AND TOPS OF PARAPETS.

WATER BASED CONCRETE SEALERS WILL NOT BE ALLOWED.

WORK ON THIS PROJECT MAY POTENTIALLY CONFLICT WITH WORK ON OTHER CONTRACTS IN THE AREA. THE CONTRACTOR SHOULD BE PREPARED TO PLAN FOR POTENTIAL DELAYS AND COOPERATE WITH CONTRACTORS ON THE OTHER PROJECTS.

NO WORK SHALL BE PERFORMED ON THIS CONTRACT AFTER NOVEMBER 15 OR PRIOR TO APRIL 15.

NO STREAM PERMITS HAVE BEEN PROCURED FOR THIS PROJECT. NONE ARE REQUIRED FROM THE REGULATORY AGENCIES AS LONG AS THERE IS NO DEBRIS FALLING OR BEING PLACED INTO THE STREAM. ANY TEMPORARY FILL IN THE STREAM OR THE COMPROMISING OF THE DIKE (IF APPLICABLE) WILL NOT BE ALLOWED. IF THE CONTRACTOR CHOOSES TO USE ALTERNATE/MODIFIED CONSTRUCTION METHOD(S) FROM THE AFOREMENTIONED, THEY WILL BE RESPONSIBLE FOR OBTAINING THE PROPER PERMITS. NO RELIEF OR COMPENSATION WILL BE GIVEN FOR ANY DELAYS, WORKING DAYS CHARGED, OR CALENDAR DAYS EXPIRED AS A RESULT OF THE LOSS TIME OR DELAY DURING THE RE-SUBMITTAL PROCESS TO PROCURE THE NECESSARY PERMIT(S) DUE TO THE CONTRACTOR CHOOSING ALTERNATE/MODIFIED CONSTRUCTION METHOD(S). ABSOLUTELY NO CONSTRUCTION ACTIVITIES WILL TAKE PLACE WITHOUT THE PROPER PERMITS BEING SECURED.

STATE STANDARDS

- 701006-05 OFF-RD OPERATIONS, 2L, 2W, 15'(4.5m) TO 24"(600mm) FROM PAVEMENT EDGE
- 701101-05 OFF-RD OPERATIONS, MULTILANE, 15'(4.5m) TO 24"(600mm) FROM PAVEMENT EDGE
- 701201-04 LANE CLOSURE, 2L, 2W, DAY ONLY, FOR SPEEDS \geq 45 MPH
- 701306-04 LANE CLOSURE, 2L, 2W, SLOW MOVING OPERATIONS DAY ONLY, FOR SPEEDS \geq 45 MPH
- 701901-07 TRAFFIC CONTROL DEVICES

MODEL: Default
 FILE NAME: \\UORAEH01NTEG\illinois.gov\WIDOT\Documents\DOT Offices\District 2\Projects\Operations\Index Section\Boone Deck Sealing Contracts\2018\64M86\CADD\Ds_shtcover.dgn

USER NAME = dssjld PLOT SCALE = 100.0000 / in. PLOT DATE = Feb-01-2018 02:07:51 PM	DESIGNED - _____ DRAWN - _____ CHECKED - _____ DATE - _____	REVISED - _____ REVISED - _____ REVISED - _____ REVISED - _____	STATE OF ILLINOIS DEPARTMENT OF TRANSPORTATION	INDEX OF SHEETS STATE STANDARDS & GENERAL NOTES	F.A. RTE. VAR.	SECTION D2 BDS 2018-2	COUNTY VARIOUS	TOTAL SHEETS 16	SHEET NO. 2
				SCALE: _____ SHEET _____ OF _____ SHEETS STA. _____ TO STA. _____	ILLINOIS FED. AID PROJECT CONTRACT NO. 64M86				

SUMMARY OF QUANTITIES

CODE NUMBER	ITEM	UNIT	100% STATE	100% STATE	100% STATE
			TOTAL QUANTITY	BOONE COUNTY 0047	CARROLL COUNTY 0047
X5870015	BRIDGE DECK CONCRETE SEALER	SQ FT	115,326	37,387	77,939
67100100	MOBILIZATION	L SUM	1	0.25	0.75
70100450	TRAFFIC CONTROL AND PROTECTION, STANDARD 701201	L SUM	1	0.25	0.75

MODEL: C:\msdnet\util\0848EBD\INTEG\Illinois.gov\PM\DOT\Documents\DOT_Offices\District 2\Projects\Operations\Bridge Section\Bridge Deck Spalling_Contract\2018\4M86\CADD\02-sh-cv-cover.dgn

SCHEDULE OF QUANTITIES

SN	Facility Carried	Feature Crossed	Location	Length Total	Bridge Rdwy Width	Area to be Sealed	Traffic Control Standard
0040013	BR 20 BR	KISHWAUKEE RIVER	E EDGE OF BELVIDERE	363	44	17,969	701201
0040015	POPLAR GROVE RD	US 20 BR	NE OF BELVIDERE	241.7	30	8,580	701201
0040018	IL 173	PISCASAW CREEKTRIB.	AT MCHENRY CO. LN.	90	35.4	3,681	701201
0040020	IL 173	BEAVER CREEK	2.0 MI E POPLAR GROV	130.1	40	5,920	701201
0080020	ILL 78	BN RAILROAD	2 MI N ARGO FAY RD	114.5	31.5	4,237	701201
0080028	ILL 84	PLUM RIVER	1.0 MI S JCT ILL 64	355.5	43.1	17,277	701201
0080033	ILL 40	JOHNSON CREEK	1.5 MI E OF ILL 78	73.5	32.2	2,771	701201
0080034	ARGO FAY ROAD	JOHNSON CREEK	1.9 MI E OF ILL 84	185.5	32	6,956	701201
0080036	ILL 73	STRADDLE CREEK	0.2 MI N OF LANARK	104.8	32	3,930	701201
0080037	US 52 & IL 64	STRADDLE CREEK	2.4 MI. W. LANARK	167.3	32	6,274	701201
0080038	ILL 78	SAND CREEK	N EDGE ARGO FAY RD	68.8	32.5	2,614	701201
0080039	ILL 78	N BRANCH SAND CREEK	.1 MI N ARGO FAY RD	59	32.5	2,242	701201
0080040	IL 84	BN RR & ACCESS RD	.3 MI S IL64 SAVANNA	260.9	30	9,262	701201
0080041	IL 84	SOO LINE RR/CITY ST	.1 MI S IL64 SAVANNA	264.4	30	9,386	701201
0080042	IL 78	EAST PLUM RIVER	3 MI. N. MT CARROLL	185	32	6,938	701201
0080043	IL 78	EAST JOHNSON CREEK	4 MI. S. MT CARROLL	77.5	35.5	3,178	701201

MODEL: Default
 FILE: \\mhc-pw\hulb\B&E\BID\NTEC\Illinois\gov\PW\DOT\Documents\BID\DOT\Office\BID\BID\2\Projects\Operations\Bridges_Section\Bridges_Deck_Sealing_Contract\2018\64M86\CADD\02-2-bc-cover.dgn

USER NAME = dssdd	DESIGNED - _____	REVISED - _____
	DRAWN - _____	REVISED - _____
PLOT SCALE = 100,0000' / in.	CHECKED - _____	REVISED - _____
PLOT DATE = Feb-01-2018 02:08:14 PM	DATE - _____	REVISED - _____

STATE OF ILLINOIS
DEPARTMENT OF TRANSPORTATION

SCHEDULE OF QUANTITIES	
SCALE: _____	SHEET ____ OF ____ SHEETS
STA. _____	TO STA. _____

F.A. RTE.	SECTION	COUNTY	TOTAL SHEETS	SHEET NO.
VAR.	D2 BDS 2018-2	VARIOUS	16	4
CONTRACT NO. 64M86				
ILLINOIS FED. AID PROJECT				

SEALING DETAIL

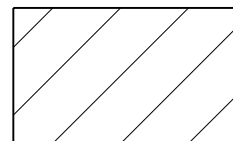
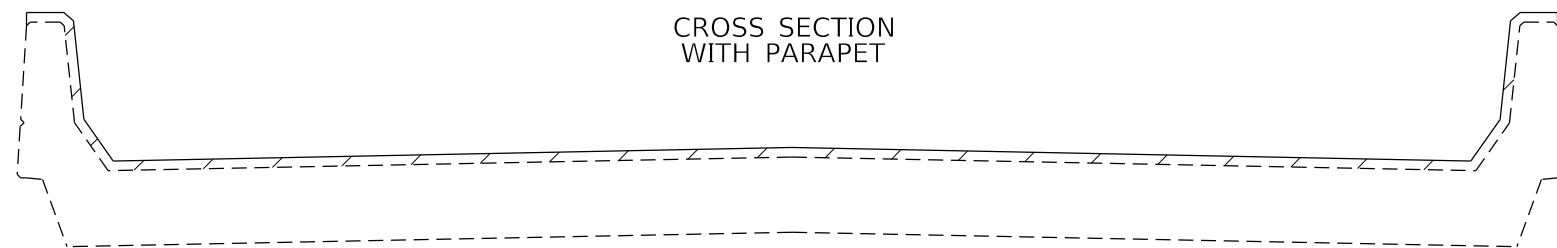
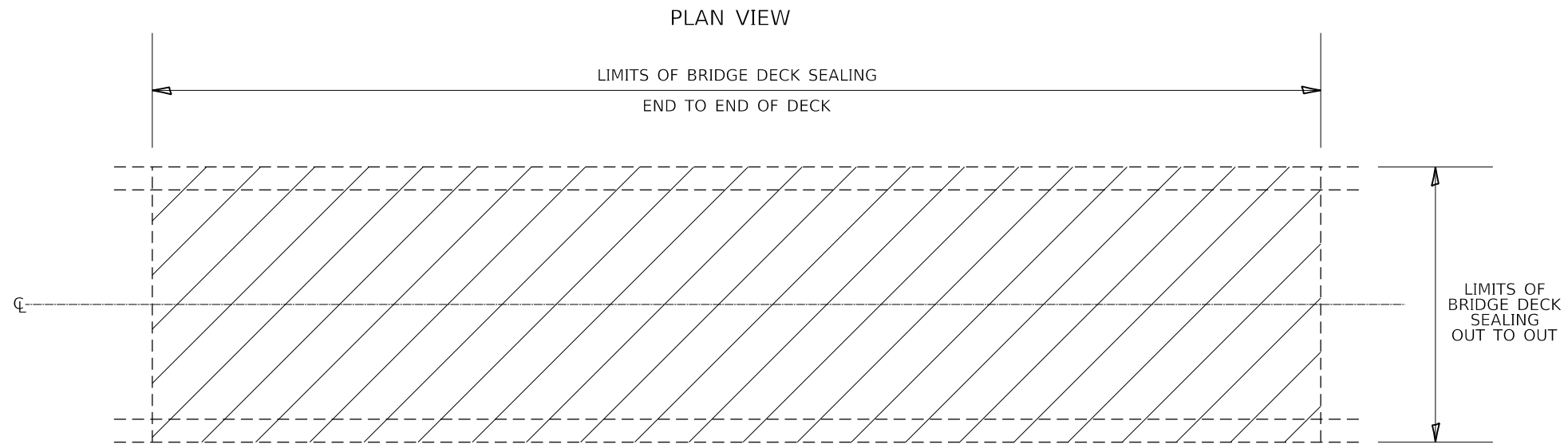

AREA TO BE SEALED

MODEL: Default
 FILE: \\nas01.cpe.uiuc.edu\BID\NTEC\Illinois\gov\PIW\DOT\Documents\DOT_Offices\District 2\Projects\Operations\Bridges_Section\Bridges_Deck_Sealing_Contracts\2018\64M86\CADD\02-4bc-cover.dgn

USER NAME = dossed	DESIGNED - _____	REVISED - _____
	DRAWN - _____	REVISED - _____
PLOT SCALE = 100.0000' / in.	CHECKED - _____	REVISED - _____
PLOT DATE = Feb-01-2018 02:08:21 PM	DATE - _____	REVISED - _____

**STATE OF ILLINOIS
DEPARTMENT OF TRANSPORTATION**

SEALING DETAIL

SCALE: _____ SHEET ____ OF ____ SHEETS STA. _____ TO STA. _____

F.A. RTE.	SECTION	COUNTY	TOTAL SHEETS	SHEET NO.
VAR.	D2 BDS 2018-2	VARIOUS	16	5
			CONTRACT NO. 64M86	
		ILLINOIS	FED. AID PROJECT	

LOCATION MAP BOONE COUNTY

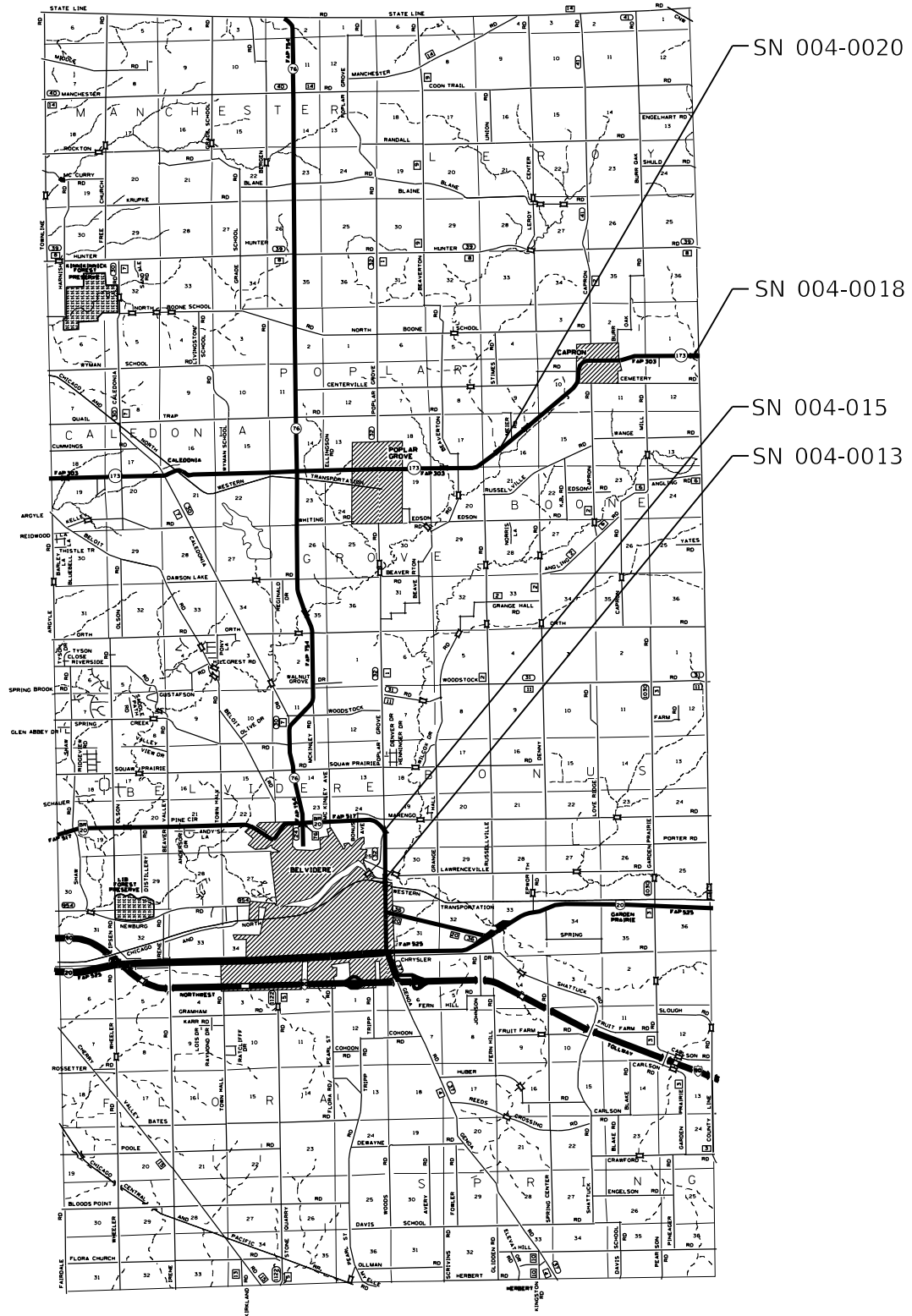

MODEL: Default
 FILE: \\nas01c.psu.edu\B&E\BID\ITEC\Illinois\gov\PWD\DOT\Documents\BID\DOT\Office\BID\BID\2\Projects\Operations\Bridges_Section\Bridges_Deck_Scaling_Contract\2018\64M86\CADD\02-2bc-cover.dgn

USER NAME = drossdd	DESIGNED - _____	REVISED - _____
	DRAWN - _____	REVISED - _____
PLOT SCALE = 100,0000' / in.	CHECKED - _____	REVISED - _____
PLOT DATE = Feb-01-2018 02:08:29 PM	DATE - _____	REVISED - _____

STATE OF ILLINOIS
DEPARTMENT OF TRANSPORTATION

LOCATION MAP BOONE COUNTY

SCALE: _____ SHEET ____ OF ____ SHEETS STA. _____ TO STA. _____

F.A. RTE.	SECTION	COUNTY	TOTAL SHEETS	SHEET NO.
VAR.	D2 BDS 2018-2	VARIOUS	16	6
			CONTRACT NO. 64M86	
ILLINOIS FED. AID PROJECT				

LOCATION MAP CARROLL COUNTY

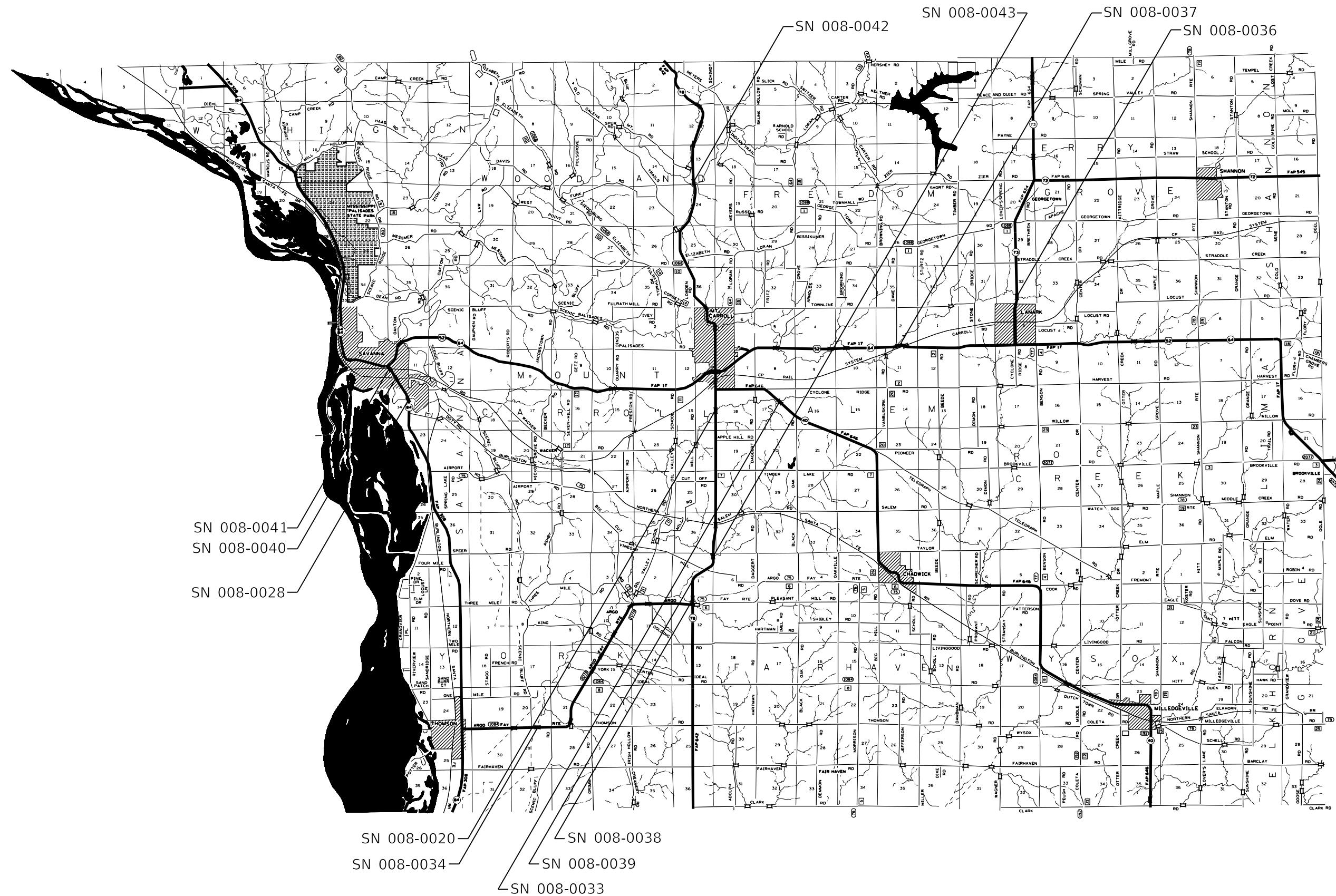

MODEL: Default
 FILE: \\mllc\p\mllc\B&E\ID\NTEC\Illinois\gov\PIWDOT\Documents\1\DOT\Office\1\District 2\Projects\Operations\Bridges_Section\Bridges_Deck_Scaling_Contract\2018\64486\CADD\02-4bc-cover.dgn

USER NAME = drossdd	DESIGNED - _____	REVISED - _____
	DRAWN - _____	REVISED - _____
PLOT SCALE = 100,0000' / in.	CHECKED - _____	REVISED - _____
PLOT DATE = Feb-01-2018 02:08:47 PM	DATE - _____	REVISED - _____

STATE OF ILLINOIS
DEPARTMENT OF TRANSPORTATION

LOCATION MAP CARROLL COUNTY

SCALE: _____ SHEET _____ OF _____ SHEETS STA. _____ TO STA. _____

F.A. RTE.	SECTION	COUNTY	TOTAL SHEETS	SHEET NO.
VAR.	D2 BDS 2018-2	VARIOUS	16	7
			CONTRACT NO. 64486	
		ILLINOIS	FED. AID PROJECT	

WORK ZONE SIGN DETAILS

ILLINOIS STANDARD G20-I100

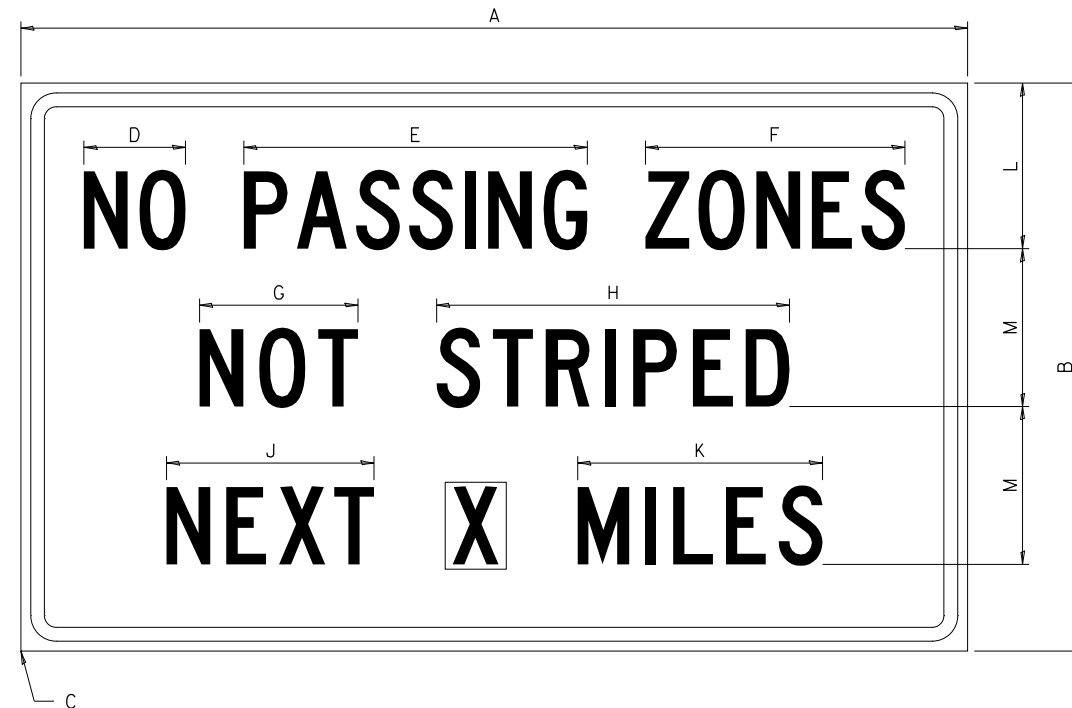

COLOR LEGEND AND BORDER BACKGROUND BLACK ORANGE NON-REFLECTORIZED REFLECTORIZED

SIGN SIZE	DIMENSIONS											
	A	B	C	D	E	F	G	H	J	K	L	M
60 x 36	60.00	36.00	2.25	6.4	21.80	16.40	10.00	22.40	13.20	15.50	10.50	10.00

SIGN SIZE	SERIES BY LINE			MARGIN	BORDER
	1	2	3		
60 x 36	5C	5C	5C	0.625	0.875

Sign not to scale

ILLINOIS STANDARD W8-I107

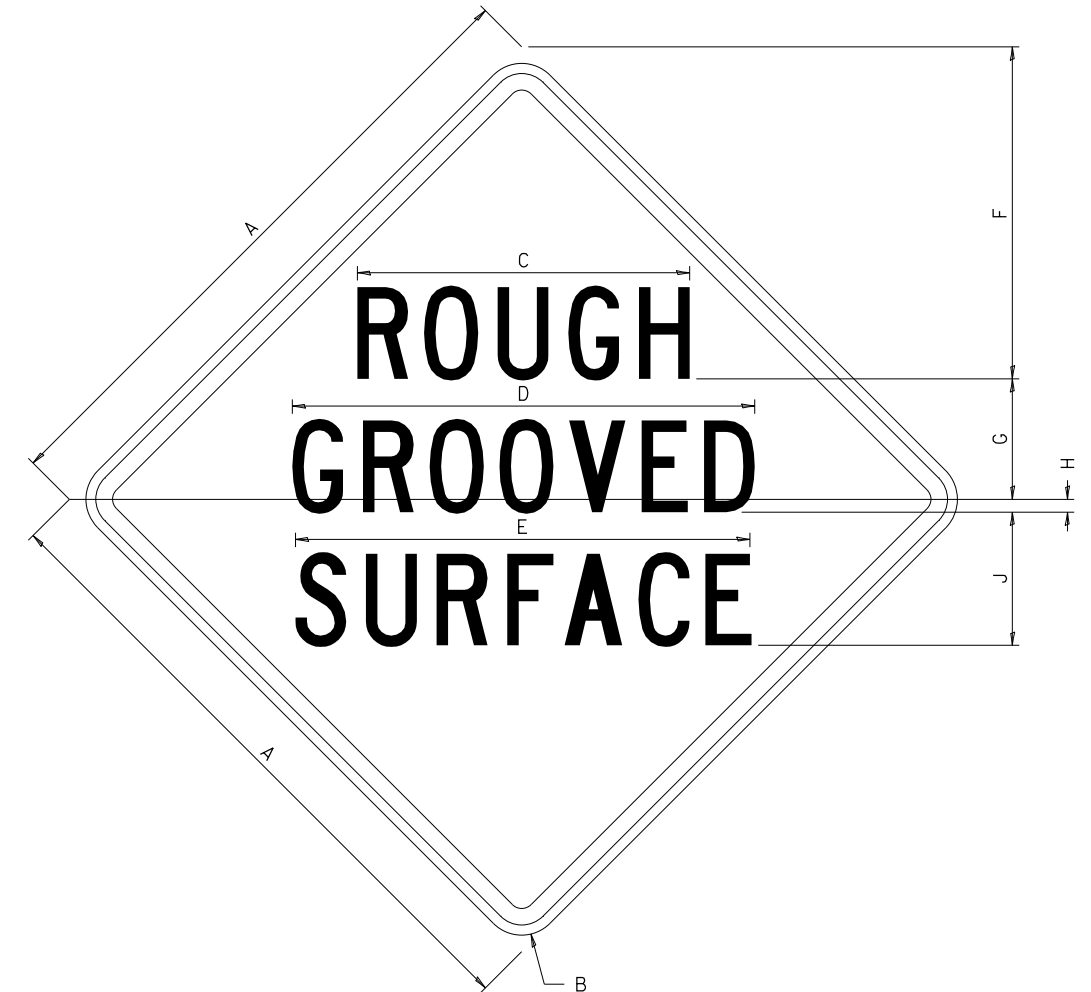

COLOR LEGEND AND BORDER BACKGROUND BLACK ORANGE NON-REFLECTORIZED REFLECTORIZED

SIGN SIZE	DIMENSIONS								
	A	B	C	D	E	F	G	H	J
48 x 48	48.00	3.00	25.00	34.80	34.20	24.94	9.00	1.00	10.00

SIGN SIZE	SERIES BY LINE			MARGIN	BORDER
	1	2	3		
48 x 48	7C	7C	7C	1.250	0.750

Sign not to scale

GENERAL NOTES

All work to furnish and install these signs shall be included in the cost of the specified traffic control standards and shall not be paid separately.

All Illinois Standard signs shall conform to the latest edition of the "Illinois Standard Highway Signs Book" in effect on the date of invitation for bids.

Signs shall meet the applicable portions of Sections 701 and 720 of the Standard Specifications.

All dimensions are in inches unless otherwise noted.

FILE NAME =	USER NAME = dosddd	DESIGNED -	REVISED - 3-02-16
p:\11\084EBID\INTEG\illinois.gov\PI\DOT\Documents\DOT Offices\District 2\Projects\Open Bridge-Section\Bridge Deck Sealing\REVISED\2018\64M86\CADD\02-sht-cover.dgn		DRAWN -	REVISED -
	PLOT SCALE = 100.0000' / 1"	CHECKED -	REVISED -
	PLOT DATE = Feb-01-2018 02:09:05 PM	DATE -	REVISED -

**STATE OF ILLINOIS
DEPARTMENT OF TRANSPORTATION**

REGION 2 / DISTRICT 2 STANDARD

SCALE: _____ SHEET NO. ____ OF ____ SHEETS STA. _____ TO STA. _____

F.A. RTE.	SECTION	COUNTY	TOTAL SHEETS	SHEET NO.
VAR.	D2 BDS 2018-2	VARIOUS	16	8
FED. ROAD DIST. NO. - ILLINOIS FED. AID PROJECT			CONTRACT NO. 64M86	

WORK ZONE SIGN DETAILS

ILLINOIS STANDARD W12-I102

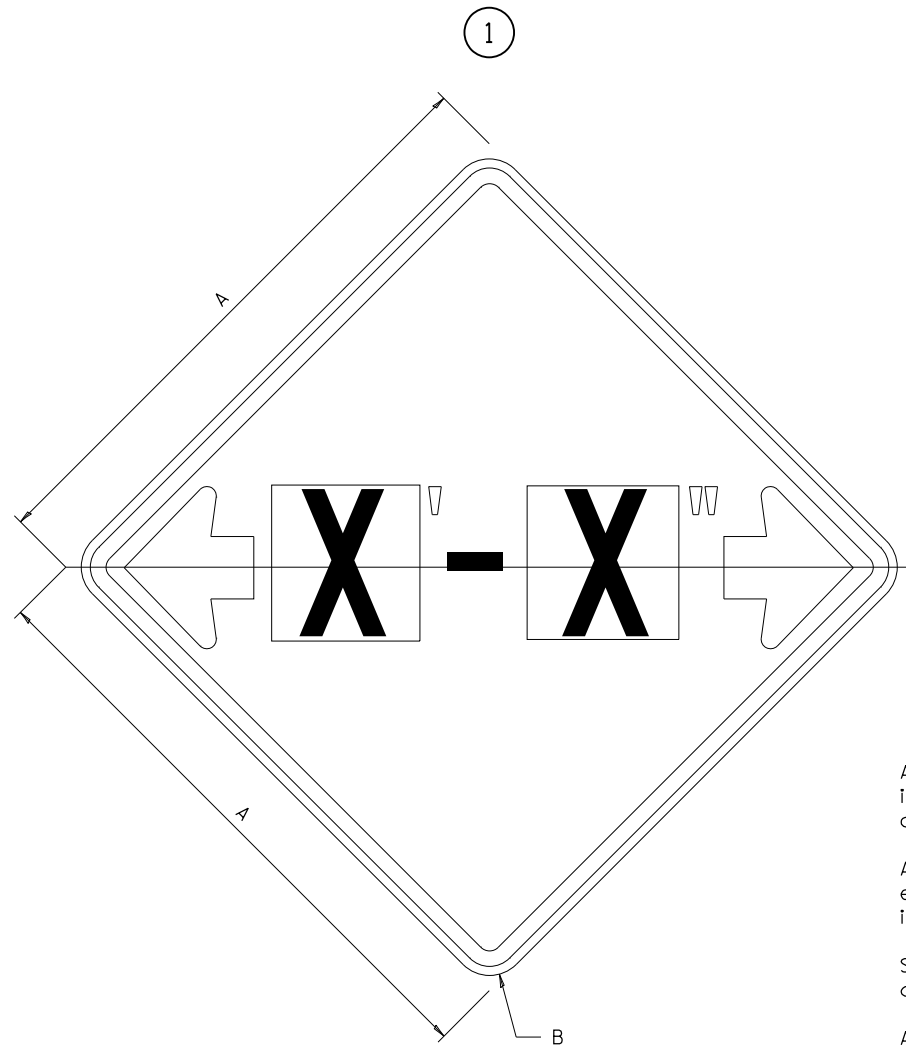

GENERAL NOTES

All work to furnish and install these signs shall be included in the cost of the specified traffic control standards and shall not be paid separately.

All Illinois Standard signs shall conform to the latest edition of the "Illinois Standard Highway Signs Book" in effect on the date of invitation for bids.

Signs shall meet the applicable portions of Sections 701 and 720 of the Standard Specifications.

All dimensions are in inches unless otherwise noted.

COLOR LEGEND AND BORDER BACKGROUND BLACK FL ORANGE NON-REFLECTORIZED REFLECTORIZED

SIGN SIZE	DIMENSIONS	
	A	B
48 x 48	48.00	3.00

① Illinois Standard signs W12-I102 and W12-I103 shall be used as described in the special provisions.

SIGN SIZE	SERIES BY LINE	MARGIN	BORDER
	1		
48 x 48	12C	0.750	1.250

Sign not to scale

ILLINOIS STANDARD W12-I103

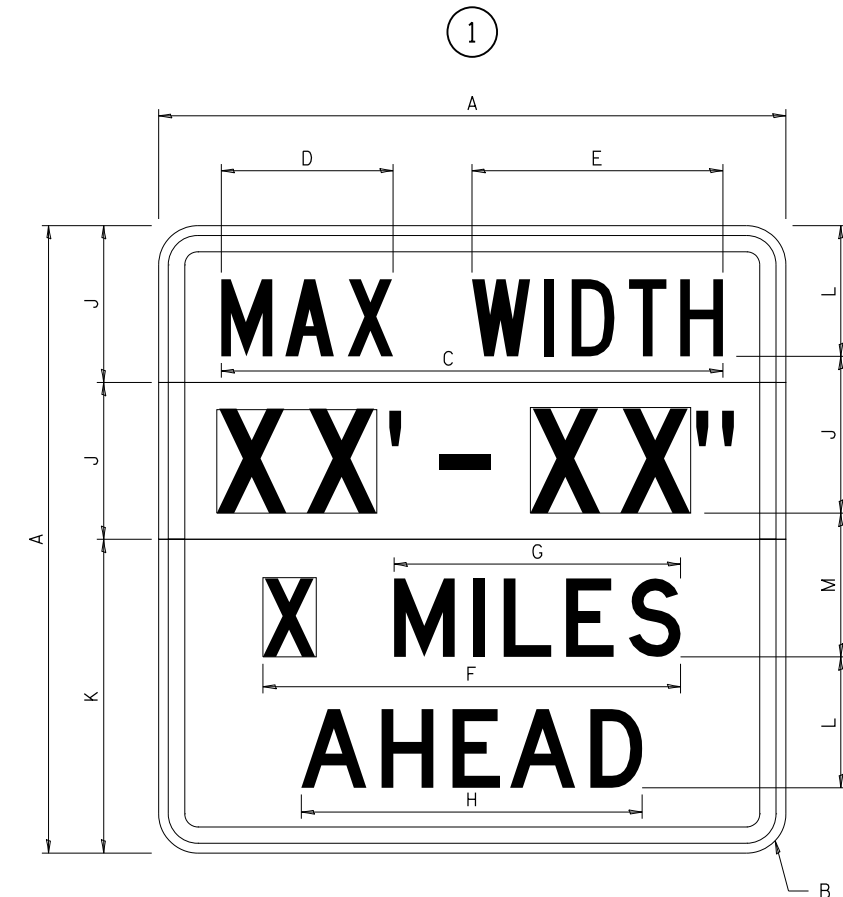

COLOR LEGEND AND BORDER BACKGROUND (WIDTH) BLACK WHITE FL ORANGE NON-REFLECTORIZED REFLECTORIZED

SIGN SIZE	DIMENSIONS											
	A	B	C	D	E	F	G	H	J	K	L	M
48 x 48	48.00	3.00	38.40	13.20	19.20	32.00	22.00	26.20	12.00	24.00	10.00	11.00

SIGN SIZE	SERIES BY LINE				MARGIN	BORDER
	1	2	3	4		
48 x 48	6C	8D	6D	6D	0.750	1.250

Sign not to scale

XX'-XX" WIDTH AND X MILES ARE VARIABLE TOP AND BOTTOM OF BACKGROUND WHITE

FILE NAME =	USER NAME = dosddd	DESIGNED -	REVISED - 3-02-16
p:\11\084EBIDINTEG\illinois.gov\PIDOT\Documents\IDOT Offices\District 2\Projects\Open Bridge-Section\Bridge Deck Sealing\REVISED\2018\64M86\CADD\02-sht-cover.dgn		CHECKED -	REVISED -
PLOT SCALE = 100.0000' / 1in.		DATE -	REVISED -
PLOT DATE = Feb-01-2018 02:09:12 PM			

STATE OF ILLINOIS
DEPARTMENT OF TRANSPORTATION

REGION 2 / DISTRICT 2 STANDARD

SCALE: _____ SHEET NO. ____ OF ____ SHEETS STA. _____ TO STA. _____

F.A. RTE.	SECTION	COUNTY	TOTAL SHEETS	SHEET NO.
VAR.	D2 BDS 2018-2	VARIOUS	16	9
CONTRACT NO. 64M86				
FED. ROAD DIST. NO. _____ ILLINOIS FED. AID PROJECT				

WORK ZONE SIGN DETAILS

ROAD CLOSED TO OVERSIZED LOADS

STOP LINE SIGN FOR TEMPORARY SIGNALS

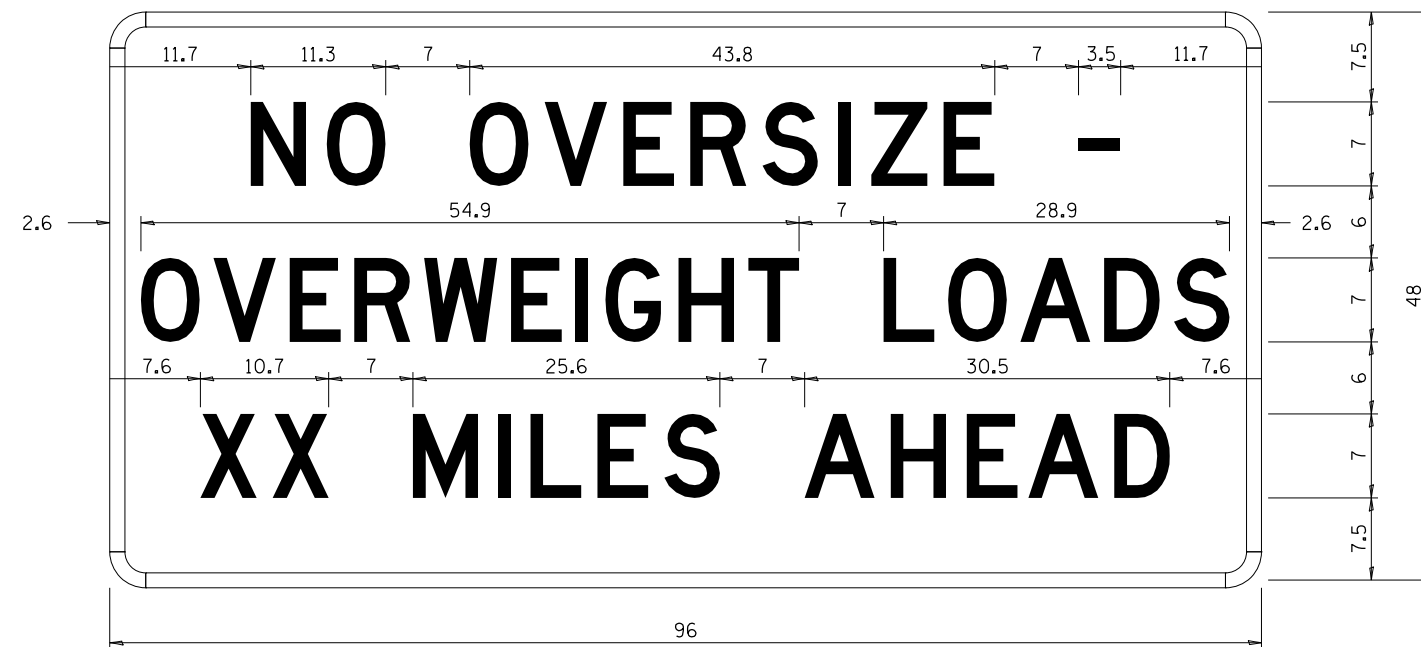

COLOR LEGEND AND BORDER BACKGROUND BLACK ORANGE NON-REFLECTORIZED REFLECTORIZED

COLOR LEGEND AND BORDER BACKGROUND BLACK WHITE NON-REFLECTORIZED REFLECTORIZED

Permit Loads - Loads Over 13 Feet; 3.0" Radius, 1.3" Border; [NO OVERSIZE -] D; [OVERWEIGHT LOADS] D 85% spacing; [XX MILES AHEAD] D; Table of letter and object lefts.

SIGN SIZE	SERIES BY LINE		
	1	2	3
24 x 24	4C	4C	4C

N	O	O	V	E	R	S	I	Z	E	-
11.7	18.1	30.0	36.2	42.8	48.4	54.4	60.7	63.5	69.5	80.8

Sign not to scale

O	V	E	R	W	E	I	G	H	T	L	O	A	D	S
2.6	8.6	15.0	20.4	26.2	33.4	38.8	41.3	47.4	53.2	64.5	69.9	75.9	82.9	88.7

GENERAL NOTES

All work to furnish and install these signs shall be included in the cost of the specified traffic control standards and shall not be paid separately.

All Illinois Standard signs shall conform to the latest edition of the "Illinois Standard Highway Signs Book" in effect on the date of invitation for bids.

Signs shall meet the applicable portions of Sections 701 and 720 of the Standard Specifications.

All dimensions are in inches unless otherwise noted.

X	X	M	I	L	E	S	A	H	E	A	D
7.6	13.6	25.3	32.3	35.1	40.6	46.2	57.9	65.1	71.4	76.6	83.7

Sign not to scale

FILE NAME =	USER NAME = dosddd	DESIGNED -	REVISED - 3-02-16
PLOT SCALE = 100.0000' / 1in.		CHECKED -	REVISED -
PLOT DATE = Feb-01-2018 02:09:18 PM		DATE -	REVISED -

STATE OF ILLINOIS
DEPARTMENT OF TRANSPORTATION

REGION 2 / DISTRICT 2 STANDARD

SCALE: _____ SHEET NO. ___ OF ___ SHEETS STA. _____ TO STA. _____

F.A. RTE.	SECTION	COUNTY	TOTAL SHEETS	SHEET NO.
VAR.	D2 BDS 2018-2	VARIOUS	16	10
FED. ROAD DIST. NO. - ILLINOIS FED. AID PROJECT			CONTRACT NO. 64M86	

**ENTRANCE SIGN FOR USE
WITH TEMPORARY SIGNALS**

WORK ZONE SIGN DETAILS

②

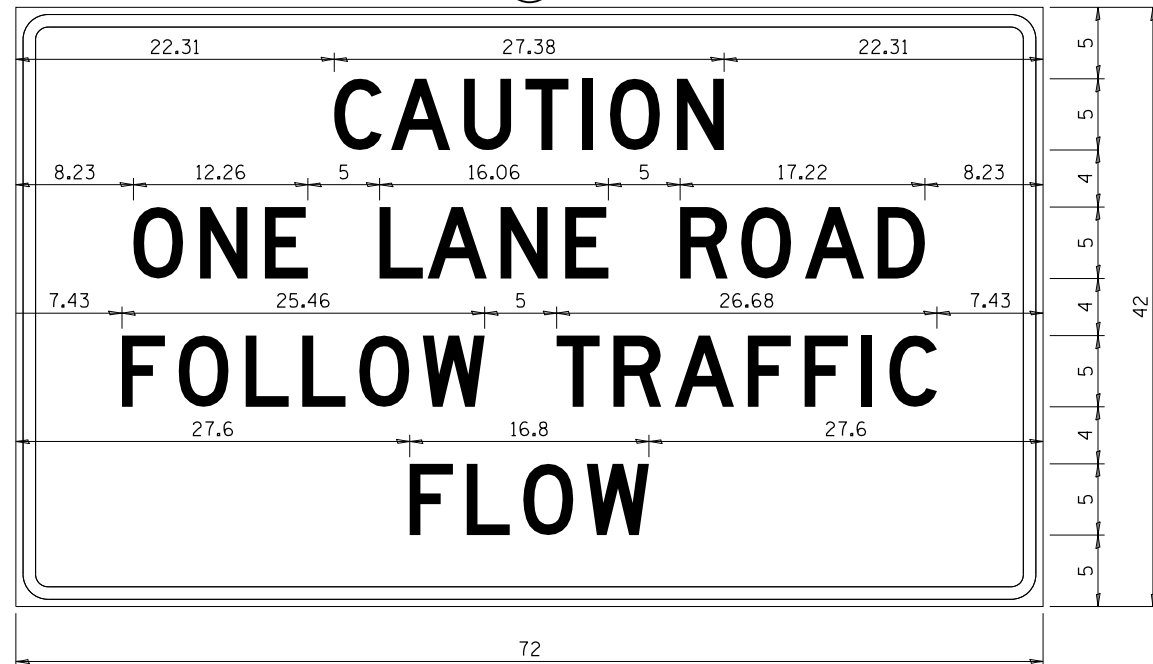

COLOR LEGEND AND BORDER BACKGROUND BLACK ORANGE NON-REFLECTORIZED REFLECTORIZED

2.25" Radius, 0.88" Border, 0.50" Indent;
[CAUTION] D; [ONE LANE ROAD] D;
[FOLLOW TRAFFIC] D; [FLOW] D

② This sign shall be installed at entrances located between the temporary signals as shown in the staging plans.

Table Of Widths And Spaces

22.31	C	0.62	A	0.94	U	0.94	T	0.94	I	1.17	O	1.17	N	3.36	22.31
	3.36		4.18		3.36		3.04		0.78		3.52		3.36		

8.23	O	1.17	N	1.18	E
	3.51		3.36		3.04

5.00	L	0.31	A	0.94	N	1.17	E
	3.05		4.18		3.36		3.05

5.00	R	0.93	O	0.94	A	0.93	D	8.23
	3.36		3.52		4.18		3.36	

7.43	F	0.94	O	1.17	L	0.94	L	0.94	O	0.94	W
	3.04		3.52		3.04		3.05		3.51		4.37

5.00	T	0.94	R	0.94	A	0.93	F	0.94	F	0.94	I	1.18	C	7.43
	3.05		3.36		4.18		3.05		3.04		0.78		3.35	

27.60	F	0.94	L	0.94	O	0.93	W	27.60
	3.05		3.04		3.52		4.38	

Sign not to scale

STAY IN YOUR LANE

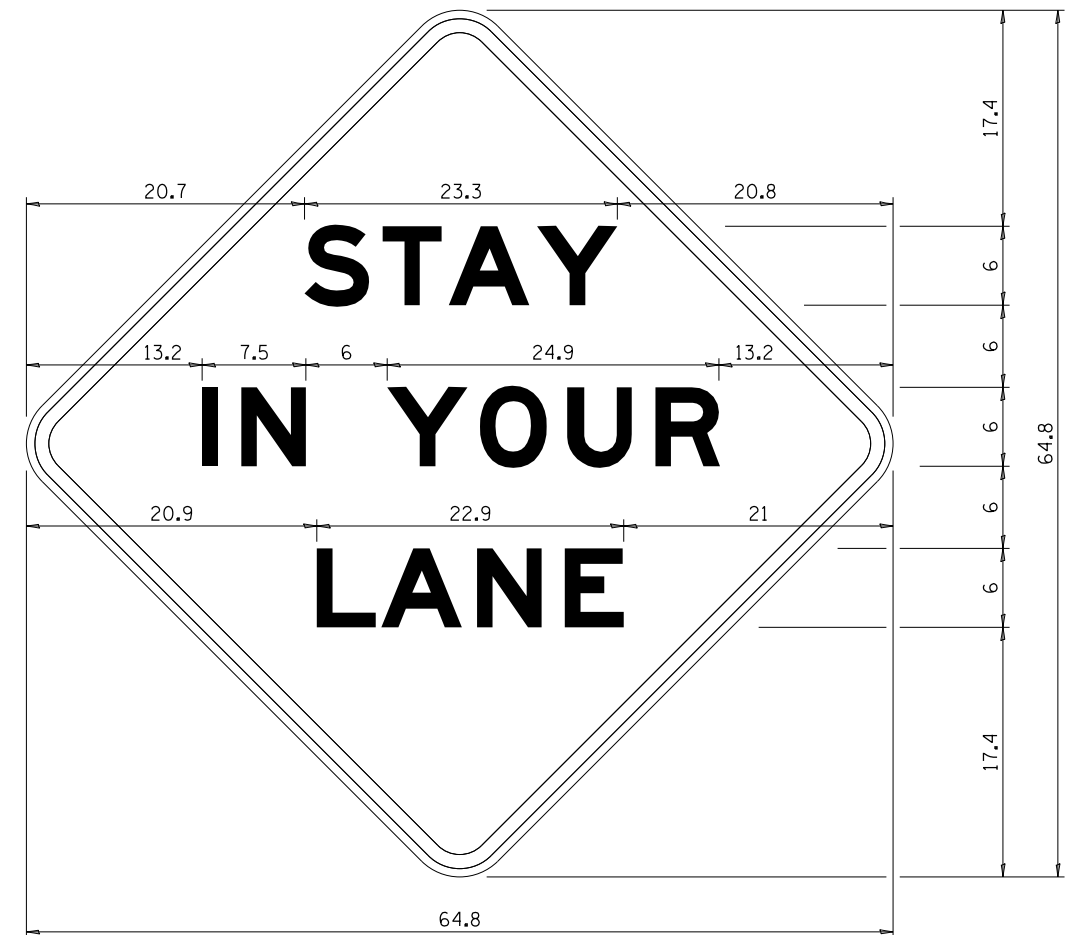

COLOR LEGEND AND BORDER BACKGROUND BLACK ORANGE NON-REFLECTORIZED REFLECTORIZED

48.0" across sides 3.8" Radius, 1.0" Border, 0.6" Indent;
"STAY" E Mod; "IN YOUR" E Mod; "LANE" E Mod;

Table of Letter and Object Lefts

S	T	A	Y
20.7	26.8	31.6	38.0

I	N	Y	O	U	R
13.2	15.9	26.7	33.9	40.5	46.8

L	A	N	E
20.9	25.8	33.1	39.4

Sign not to scale

GENERAL NOTES

All work to furnish and install these signs shall be included in the cost of the specified traffic control standards and shall not be paid separately.

All Illinois Standard signs shall conform to the latest edition of the "Illinois Standard Highway Signs Book" in effect on the date of invitation for bids.

Signs shall meet the applicable portions of Sections 701 and 720 of the Standard Specifications.

All dimensions are in inches unless otherwise noted.

FILE NAME =	USER NAME = dossed	DESIGNED -	REVISED - 3-02-16
p:\11\084EBID\INTEG\illinois.gov\PIDOT\Documents\DOT Offices\District 2\Projects\Operations\Bridges\Section\Bridge Deck Sealing\REVISED\2018\64M86\CADD\02-sht-cover.dgn		DRAWN -	REVISIONS -
PLOT SCALE = 100.0000' / 1"	CHECKED -	REVISOR -	
PLOT DATE = Feb-01-2018 02:09:24 PM	DATE -	REVISOR -	

**STATE OF ILLINOIS
DEPARTMENT OF TRANSPORTATION**

REGION 2 / DISTRICT 2 STANDARD

SCALE: _____ SHEET NO. ____ OF ____ SHEETS STA. _____ TO STA. _____

F.A. RTE.	SECTION	COUNTY	TOTAL SHEETS	SHEET NO.
VAR.	D2 BDS 2018-2	VARIOUS	16	11
FED. ROAD DIST. NO. _____ ILLINOIS FED. AID PROJECT			CONTRACT NO. 64M86	

TRAFFIC CONTROL FOR TRANSITION AREAS

CASE 1

SIGNS, DEVICES & FLAGGERS ACCORDING TO APPLICABLE TRAFFIC CONTROL STANDARDS

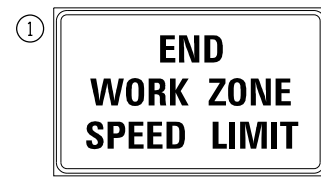

G20-1103-6036

DRUMS OR BARRICADES @ 40' CENTERS

L(2)

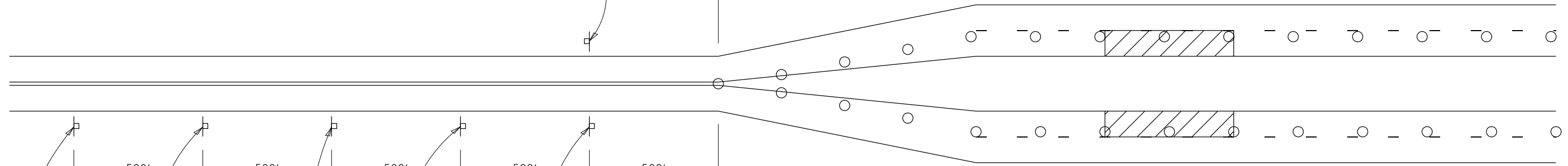

500' 500' 500' 500' 500' 500'

DRUMS OR BARRICADES @ 40' CENTERS

L(2)

SIGNS, DEVICES & FLAGGERS ACCORDING TO APPLICABLE TRAFFIC CONTROL STANDARDS

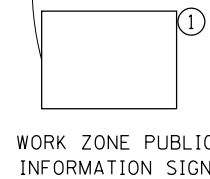

WORK ZONE PUBLIC INFORMATION SIGN

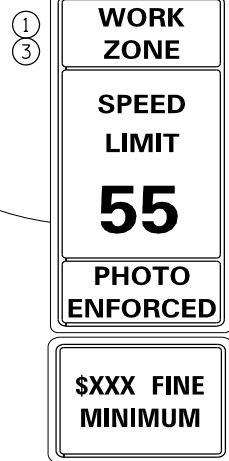

W2-1115(0)-3618

R2-1-3648

R10-1108p-3618 (only along roadways under the jurisdiction of the State.)

R2-1106-3618



W20-1(0)-48

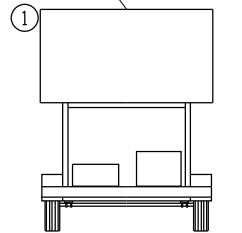

PORTABLE CHANGEABLE MESSAGE SIGN

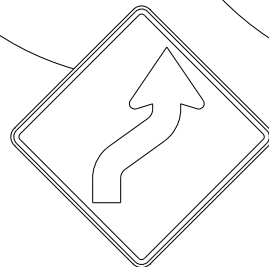

* W1-4R(0)-48

GENERAL NOTES
THIS DETAIL IS TO BE USED IN CONJUNCTION WITH THE APPLICABLE MULTILANE TRAFFIC CONTROL AND PROTECTION STANDARD.

1. If applicable, use if shown on applicable multilane Traffic Control and Protection Standard being used.
2. If the work is within 2500 feet of the transition when the speed is > 40 mph, or 1500 feet for all other speeds, the detail shall be used.
3. WORK ZONE SPEED LIMIT 55 SIGN ASSEMBLY shall be replaced with WORK ZONE SPEED LIMIT 45 SIGN ASSEMBLY where the workers are within 500 feet of the transition.

THIS TRAFFIC CONTROL DETAIL SHALL BE INCLUDED IN THE COST OF SPECIFIED TRAFFIC CONTROL STANDARDS OR ITEMS.

○ DRUMS OR BARRICADES WITH LIGHTS

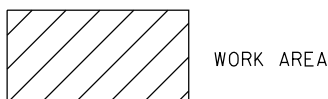

WORK AREA

NOTE: STANDARDS 701301 AND 701306 SHALL NOT BE USED WITHIN 500 FEET OF THE TRANSITION.

* DEPENDS ON GEOMETRICS OF THE TRANSITION. MAY SWITCH THE "STAY IN YOUR LANE" AND "WEAVE SIGNS"

FILE NAME =	USER NAME = dosddd	DESIGNED -	REVISED - 4-20-17
pw:\IL\084EBIDINTEG\illinois.gov\PI\DOT\Documents\DOT Offices\District 2\Projects\Open Bridge-Section\Bridge Deck Sealing\REVISED\2018\64M86-02-sht-cover.dgn		DRAWN -	REVISED - 8-27-13
		CHECKED -	REVISED - 1-16-13
		DATE -	

STATE OF ILLINOIS
DEPARTMENT OF TRANSPORTATION

REGION 2 / DISTRICT 2 STANDARD

SCALE: SHEET NO. OF SHEETS STA. TO STA.

F.A. RTÉ.	SECTION	COUNTY	TOTAL SHEETS	SHEET NO.
VAR.	D2 BDS 2018-2	VARIOUS	16	12
CONTRACT NO. 64M86				
FED. ROAD DIST. NO. ILLINOIS FED. AID PROJECT				

TRAFFIC CONTROL FOR TRANSITION AREAS

CASE 2

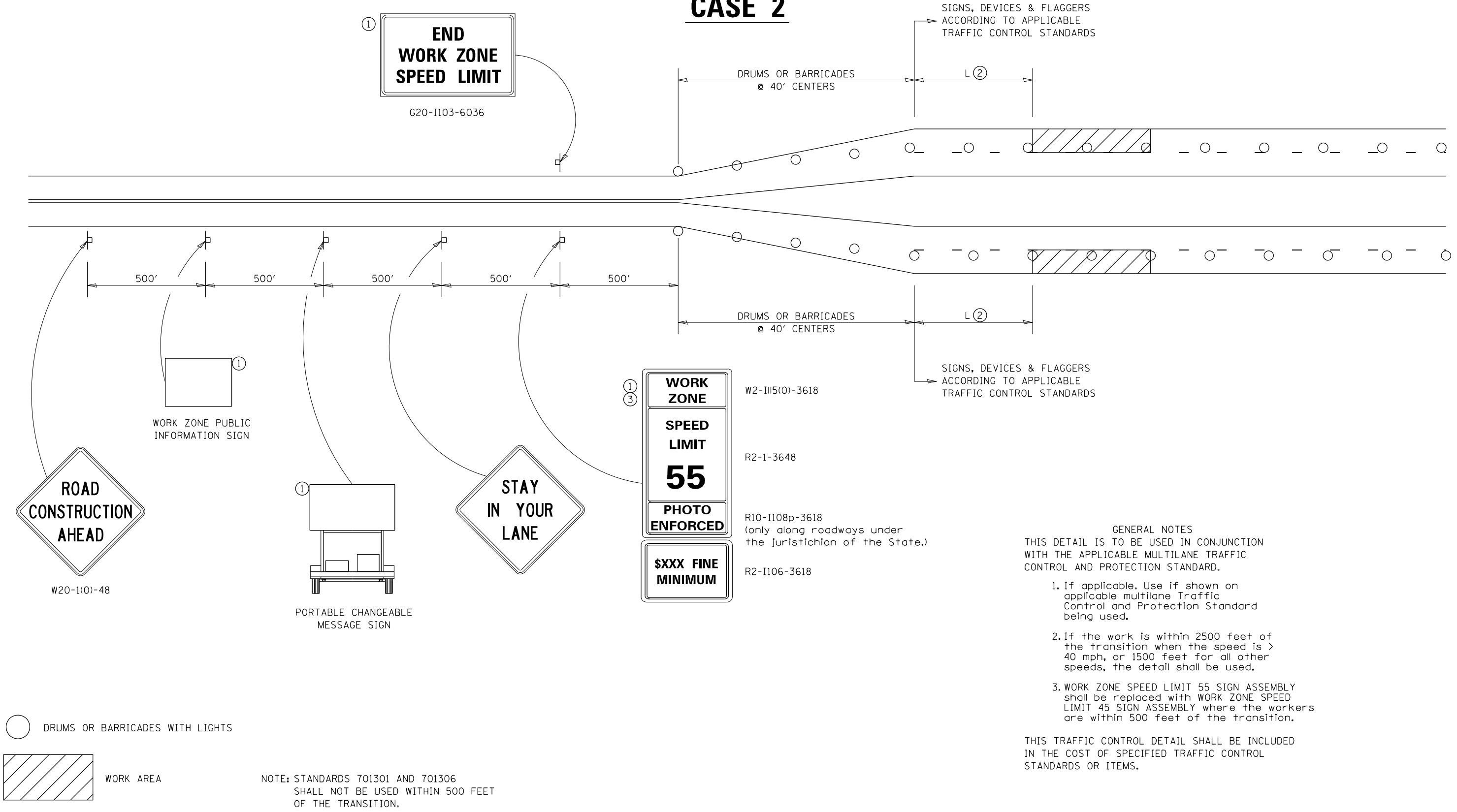

FILE NAME =	USER NAME = dosddd	DESIGNED -	REVISED - 4-20-17
pw:\IL\084EBIDINTEG\illinois.gov\PIWIDOT\Documents\DOT Offices\District 2\Projects\Open Bridge-Section\Bridge Deck Sealing\REVISED\2018\64M86-010-D2-sht-cover.dgn		DRAWN -	REVISED - 8-27-13
		CHECKED -	REVISED - 1-16-13
		DATE -	

STATE OF ILLINOIS
DEPARTMENT OF TRANSPORTATION

REGION 2 / DISTRICT 2 STANDARD	
SCALE: _____	SHEET NO. ___ OF ___ SHEETS
STA. _____ TO STA. _____	

F.A. RTÉ.	SECTION	COUNTY	TOTAL SHEETS	SHEET NO.
VAR.	D2 BDS 2018-2	VARIOUS	16	13
CONTRACT NO. 64M86			FED. ROAD DIST. NO. ILLINOIS FED. AID PROJECT	

TRAFFIC CONTROL FOR TRANSITION AREAS

CASE 3

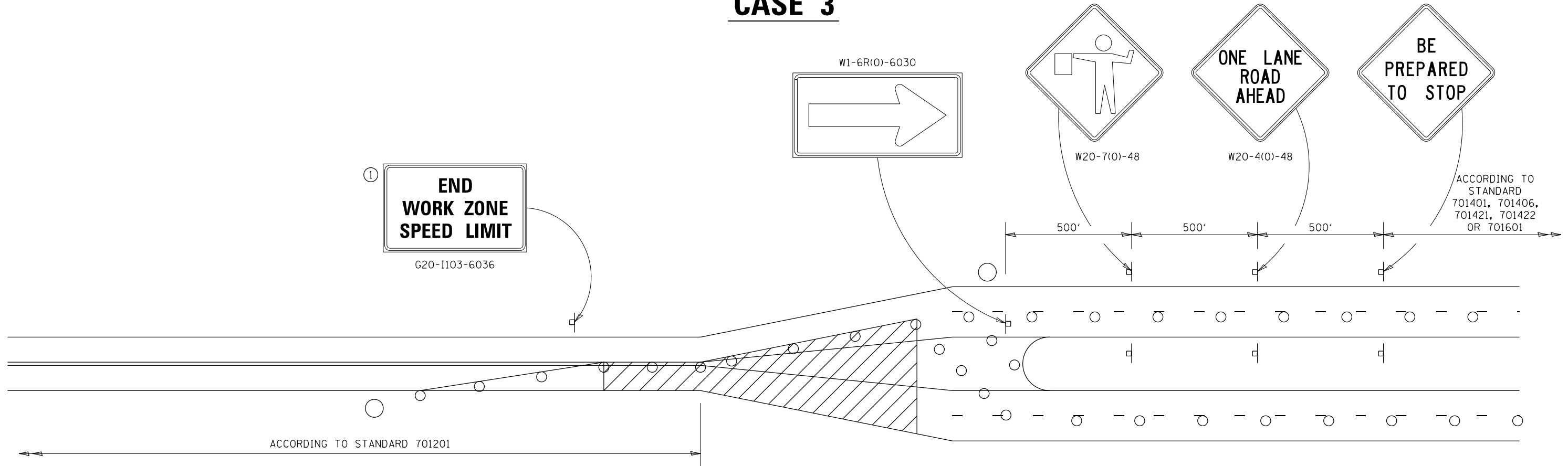

GENERAL NOTES
THIS DETAIL IS TO BE USED IN CONJUNCTION WITH THE APPLICABLE MULTILANE TRAFFIC CONTROL AND PROTECTION STANDARD.

1. If applicable, Use if shown on applicable multilane Traffic Control and Protection Standard being used.
2. If the work is within 2500 feet of the transition when the speed is > 40 mph, or 1500 feet for all other speeds, the detail shall be used.
3. WORK ZONE SPEED LIMIT 55 SIGN ASSEMBLY shall be replaced with WORK ZONE SPEED LIMIT 45 SIGN ASSEMBLY where the workers are within 500 feet of the transition.

THIS TRAFFIC CONTROL DETAIL SHALL BE INCLUDED IN THE COST OF SPECIFIED TRAFFIC CONTROL STANDARDS OR ITEMS.

- FLAGGER WITH TRAFFIC CONTROL SIGN
- DRUMS OR BARRICADES WITH LIGHTS
- WORK AREA

NOTE: STANDARDS 701301 AND 701306 SHALL NOT BE USED WITHIN 500 FEET OF THE TRANSITION.

FILE NAME =	USER NAME = dosddd	DESIGNED -	REVISED - 4-20-17	STATE OF ILLINOIS DEPARTMENT OF TRANSPORTATION	REGION 2 / DISTRICT 2 STANDARD	F.A. RTE.	SECTION	COUNTY	TOTAL SHEETS	SHEET NO.			
DRAWN BY: [unclear]						SCALE: _____	SHEET NO. ____ OF ____ SHEETS	STA. _____ TO STA. _____	VAR.	D2 BDS 2018-2	VARIABLE	16	14
PLOT SCALE = 100.0000' / in.						CHECKED -	REVISED - 8-27-13	CONTRACT NO. 64M86					
PLOT DATE = Feb-01-2018 02:09:48 PM				DATE -	REVISED - 3-05-12	FED. ROAD DIST. NO. _ ILLINOIS FED. AID PROJECT							

TRAFFIC CONTROL FOR TRANSITION AREAS

CASE 4

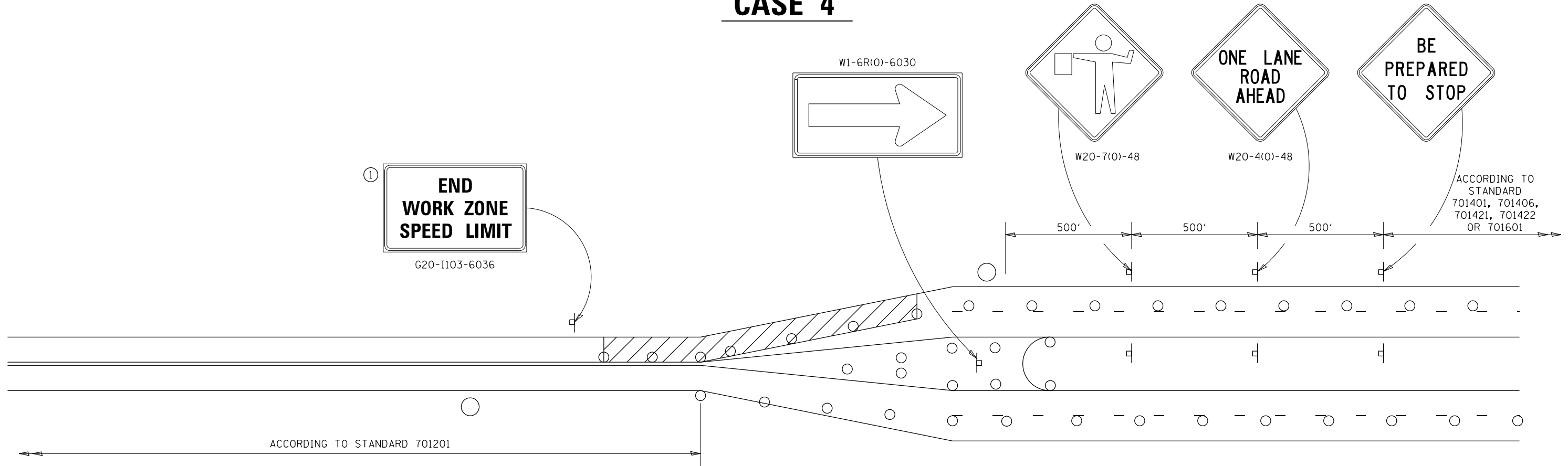

GENERAL NOTES
 THIS DETAIL IS TO BE USED IN CONJUNCTION WITH THE APPLICABLE MULTILANE TRAFFIC CONTROL AND PROTECTION STANDARD.

1. If applicable, Use if shown on applicable multilane Traffic Control and Protection Standard being used.
2. If the work is within 2500 feet of the transition when the speed is > 40 mph, or 1500 feet for all other speeds, the detail shall be used.
3. WORK ZONE SPEED LIMIT 55 SIGN ASSEMBLY shall be replaced with WORK ZONE SPEED LIMIT 45 SIGN ASSEMBLY where the workers are within 500 feet of the transition.

THIS TRAFFIC CONTROL DETAIL SHALL BE INCLUDED IN THE COST OF SPECIFIED TRAFFIC CONTROL STANDARDS OR ITEMS.

- FLAGGER WITH TRAFFIC CONTROL SIGN
- DRUMS OR BARRICADES WITH LIGHTS
- WORK AREA



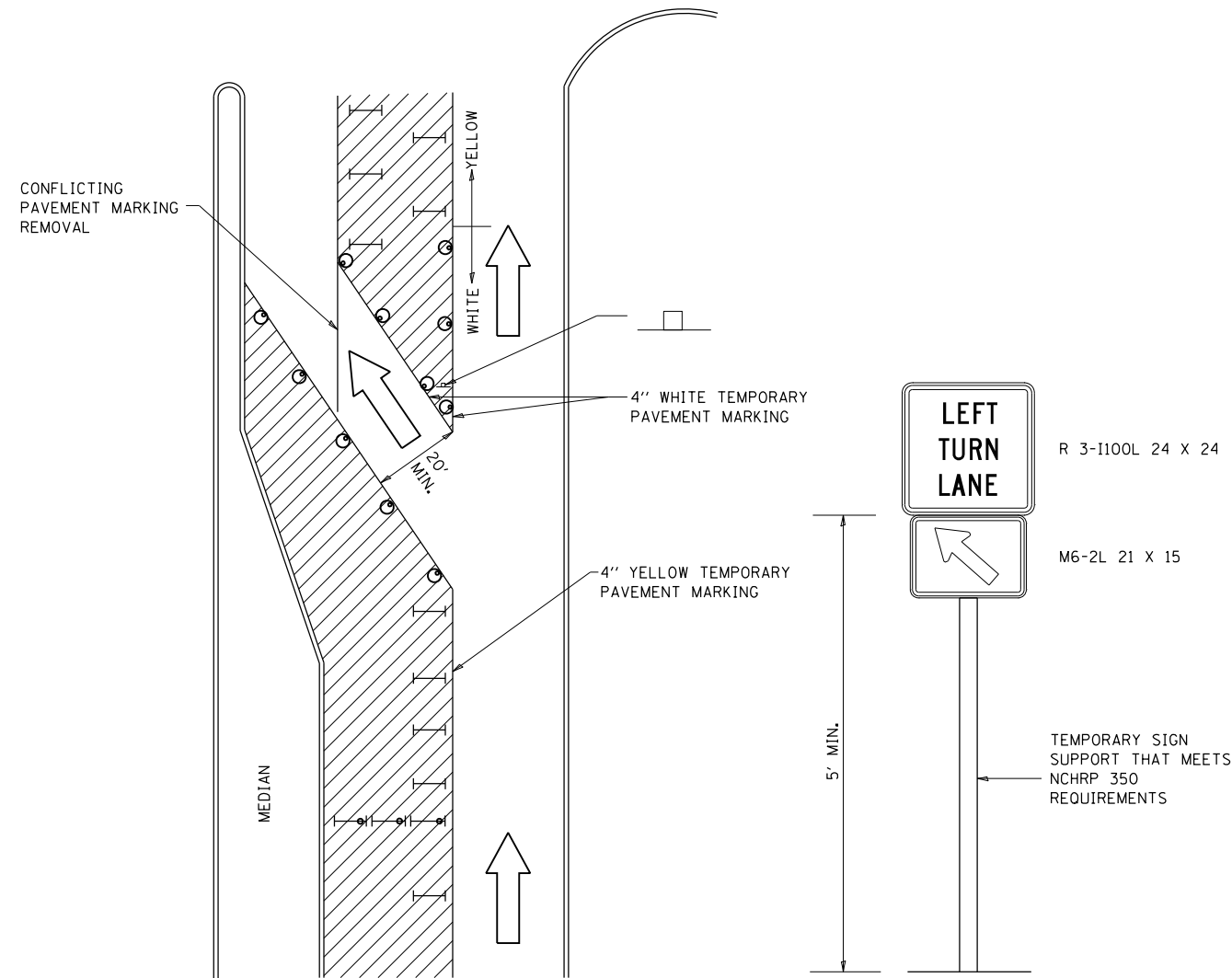

NOTE: STANDARDS 701301 AND 701306 SHALL NOT BE USED WITHIN 500 FEET OF THE TRANSITION.

FILE NAME =	USER NAME = dosddd	DESIGNED -	REVISED - 4-20-17	STATE OF ILLINOIS DEPARTMENT OF TRANSPORTATION	REGION 2 / DISTRICT 2 STANDARD	F.A. RTE.	SECTION	COUNTY	TOTAL SHEETS	SHEET NO.			
DRAWN -						SCALE: _____	SHEET NO. ____ OF ____ SHEETS	STA. _____ TO STA. _____	VAR.	D2 BDS 2018-2	VARIOUS	16	15
PLOT SCALE = 100.0000' / in.						CHECKED -	REVISED - 8-27-13	CONTRACT NO. 64M86					
PLOT DATE = Feb-01-2018 02:09:55 PM				DATE -	REVISED - 3-05-12	FED. ROAD DIST. NO. _ ILLINOIS FED. AID PROJECT							

TRAFFIC CONTROL AND PROTECTION AT TURN BAYS (TO REMAIN OPEN TO TRAFFIC)

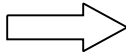

LEGEND

-  WORK AREA
-  LANE OPEN TO TRAFFIC
-  TYPE I OR II BARRICADE OR DRUM WITH FLASHING BURNING LIGHT
-  DRUM OR BARRICADE WITH STEADY BURN LIGHT
-  SIGN (SEE DETAIL)
-  TYPE I OR II CHECK BARRICADE WITH STEADY LIGHT BURN

REVISED - 10-14-11

GENERAL NOTES

- CONES MAY BE SUBSTITUTED FOR BARRICADES OR DRUMS AT HALF THE SPACING DURING DAY OPERATIONS. CONES SHALL BE A MINIMUM OF 28 IN HEIGHT.
- STEADY BURNING LIGHTS WILL NOT BE REQUIRED ON BARRICADES OR DRUMS FOR DAY OPERATIONS. ALL LIGHTS WILL BE MONODIRECTIONAL.
- TEMPORARY PAVEMENT MARKING SHALL BE PLACED THROUGHOUT THE BARRICADED AREA OF EACH BAY WHERE THE CLOSURE TIME IS GREATER THAN FOURTEEN DAYS.
- THIS APPLICATION ALSO APPLIES WHEN WORK IS BEING PERFORMED IN THE RIGHT LANE(S) AND THE RIGHT TURN BAY IS TO REMAIN OPEN. UNDER THIS CONDITION, "RIGHT TURN LANE" R3-100 24 X 24 AND M6-2R 21 X 15 SHALL BE USED.
- THESE CONTROLS SHALL SUPPLEMENT MAINLINE TRAFFIC CONTROL FOR LANE CLOSURES. LONGITUDINAL DIMENSIONS MAY BE ADJUSTED TO FIT FIELD CONDITIONS.
- TRAFFIC CONTROL AND PROTECTION AT TURN BAYS (TO REMAIN OPEN TO TRAFFIC) SHALL BE INCLUDED IN THE COST SPECIFIED TRAFFIC CONTROL STANDARDS OR ITEMS.
- ALL DIMENSIONS ARE IN INCHES UNLESS OTHERWISE NOTED.

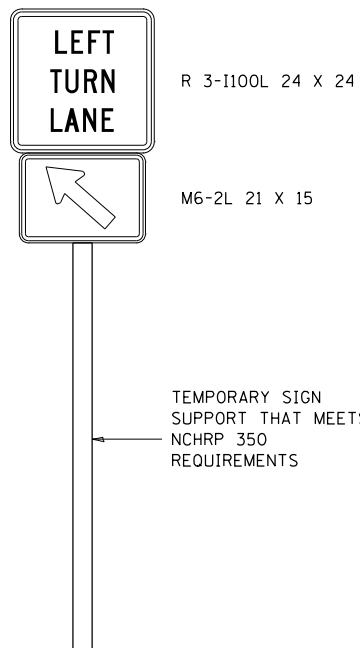

REVISED - ____	REGION 2 / DISTRICT 2 STANDARD	F.A. RTE.	SECTION	COUNTY	TOTAL SHEETS	SHEET NO.
REVISED - ____		VAR.	D2 BDS 2018-2	VARIOUS	16	16
REVISED - ____		CONTRACT NO. 64M86				
REVISED - ____		FED. ROAD DIST. NO. ILLINOIS FED. AID PROJECT				
REVISED - ____		SCALE: 100,000' / 1" SHEET NO. ____ OF ____ SHEETS	STA. _____ TO STA. _____			

PLOT DATE = Feb-01-2018 02:18:03 PM