

ROUTE	SECTION	COUNTY	TOTAL SHEETS	SHEET NO.
FAS 924	05-00094-00-RS	UNION	11	6
PROJECT NO. RS-924 (121)			CONTRACT NO. 99256	

85

CURVE DATA
 $\Delta = 39^{\circ}24'00''$ $T = 683.91'$
 $D = 2^{\circ}59'59''$ $L = 1313.48'$
 $R = 1910.08'$ $E = 118.75'$
 $S.E. = 0.053'/ft.$
 Attain Sta. 58+94 to Sta. 60+44
 Remove Sta. 72+56 to Sta. 74+06

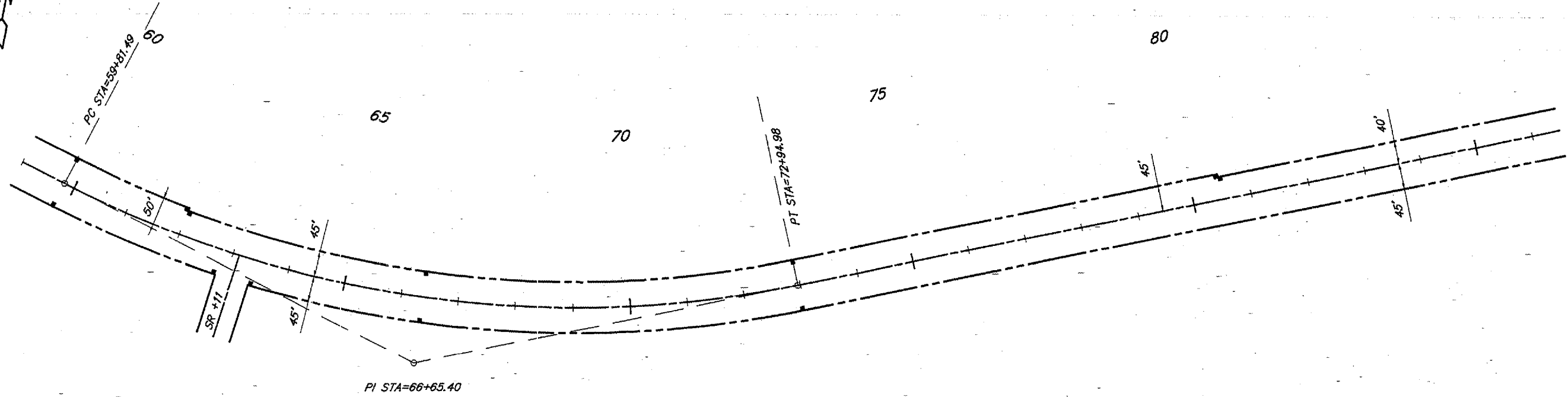

SCALES:
 1" = 200' HOR

CURVE DATA
 $\Delta = 18^{\circ}40'00''$ $T = 428.06'$
 $D = 2^{\circ}12'00''$ $L = 848.54'$
 $R = 2604.51'$ $E = 34.94'$
 $S.E. = 0.042'/ft.$
 Attain Sta. 95+52 to Sta. 97+02
 Remove Sta. 104+77 to Sta. 106+41

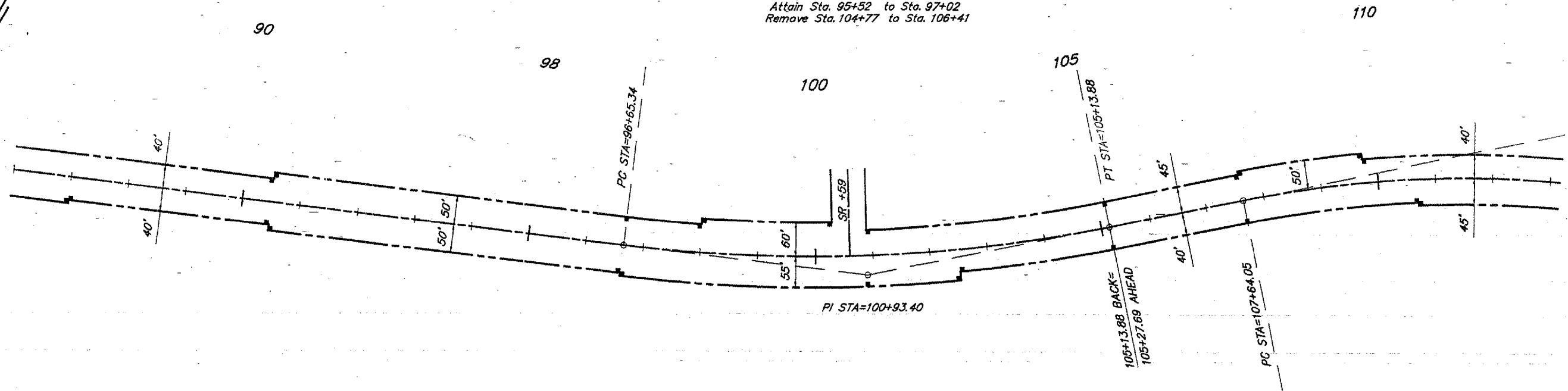

SCALES:
 1" = 200' HOR