



815 Commerce Drive Suite 200  
Oak Brook, Illinois 60523  
Telephone: 630.990.3800  
Fax: 630.990.3801



**CITY OF DIXON, ILLINOIS**  
Post Office Box 386  
Dixon, Illinois 61021  
Telephone: 815.288.1485

**DIXON MUNICIPAL AIRPORT  
CHARLES R. WALGREEN FIELD**

**OVERLAY TAXIWAYS A, A1, A2 AND C;  
REMOVE AND REPLACE TAXIWAY C1**

AIP PROJECT NO. 3-17-0036-B9  
IDA PROJECT NO. C73-3549

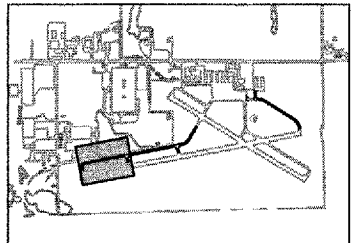

**KEY PLAN**

No.	Drawing Issue Description	Date	By

Date  
**MARCH 3, 2006**  
Sheet Title

**PAVEMENT MARKING AND  
REFLECTIVE MARKER PLAN  
TAXIWAYS A AND A1**

843-05B8009

Project Number	
LDH	11/21/05
Layout By	Date
LDH, KLK	11/21/05
Designed By	Date
RMH	02/03/06
Reviewed By	Date
LDH	
Drawn By	

Sheet No. **43**

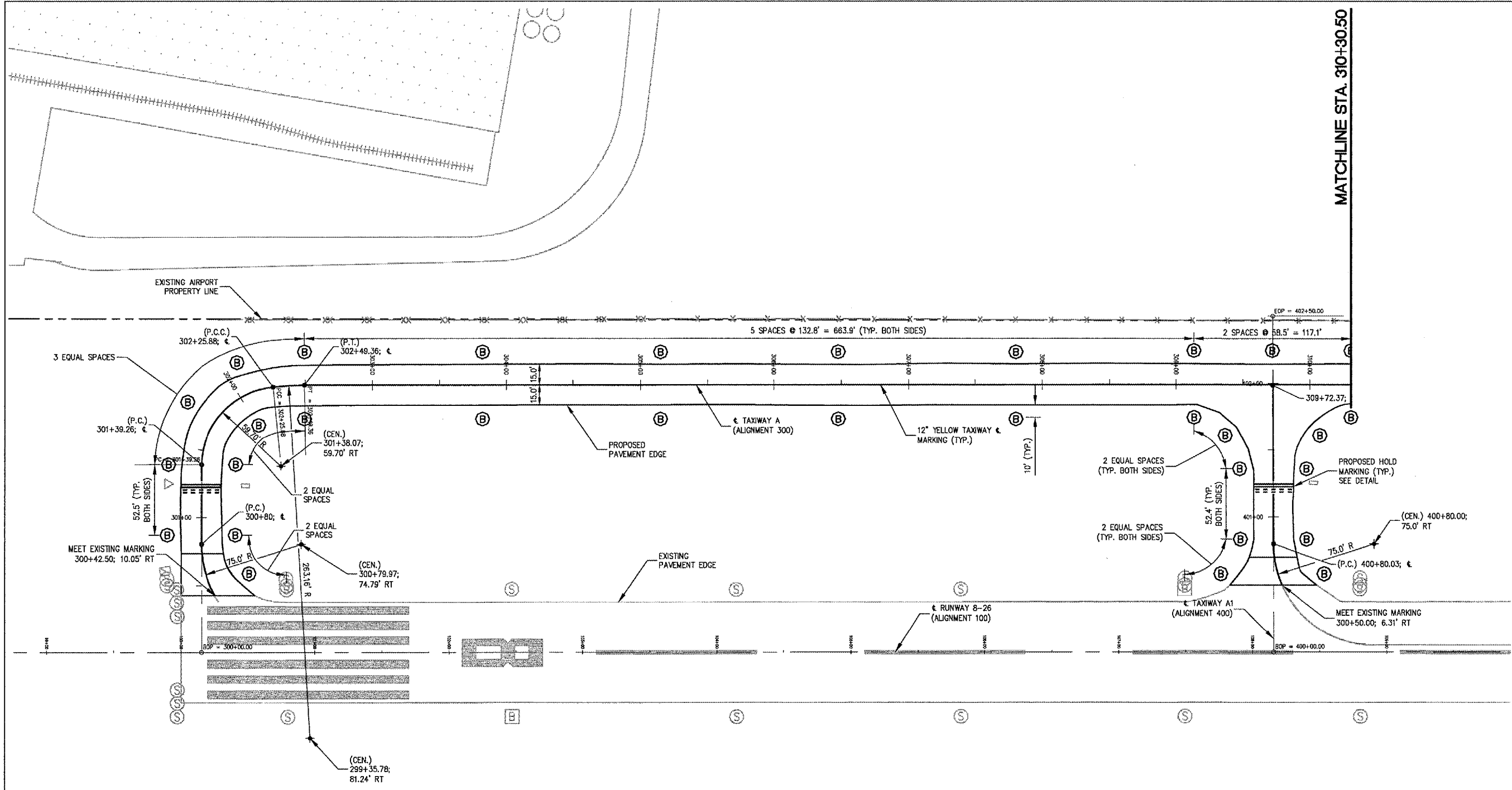

A:\05\0205\10064\050609\050609\050609\145-MARKING PLAN 300-1.DWG MAR 10, 2006 10:20AM KLK

**PAVEMENT MARKINGS**

TAXIWAY	YELLOW (ITEM AR620520)	BLACK (ITEM AR620525)
TAXIWAY A	2566 S.F.	300 S.F.
TAXIWAY A1	230 S.F.	150 S.F.
TAXIWAY A2	235 S.F.	150 S.F.
TAXIWAY C	1204 S.F.	150 S.F.
TAXIWAY C1	138 S.F.	0 S.F.
<b>TOTAL</b>	<b>4373 S.F.</b>	<b>750 S.F.</b>

- NOTES:**
- 1. ALL MARKINGS TO BE YELLOW AND BLACK WATERBORNE PAINT.
  - 2. ALL YELLOW MARKINGS TO INCLUDE REFLECTIVE GLASS SPHERES PER SPECIFICATIONS.
  - 3. HOLD MARKINGS TO HAVE A BLACK BORDER, SEE DETAIL. BLACK PAINT TO BE WATERBORNE PER SPECIAL PROVISIONS.

**REFLECTIVE MARKER**

TAXIWAY	QUANTITY (ITEM AR125100)
TAXIWAY A, A1, A2	67 EACH
TAXIWAY C, C1	41 EACH
<b>TOTAL</b>	<b>108 EACH</b>

**NOTE:**  
REFLECTIVE MARKERS AT CURVES TO BE LOCATED AT P.C.'S, P.T.'S AND EQUALLY SPACED BETWEEN THE RESPECTIVE P.C. AND P.T.

**LEGEND**

	EXISTING STAKE MOUNTED LIGHT
	EXISTING BASE MOUNTED LIGHT
	EXISTING GUIDANCE SIGN
	EXISTING REIL
	EXISTING HANDHOLE
	PROPOSED TAXIWAY REFLECTIVE MARKER
	PROPOSED 1' YELLOW MARKINGS (WATERBORNE)

