

LOCATION MAP #3
C.H. - 1 (HENNING RD.), FROM HUNGRY HOLLOW RD. TO
U.S. 136 AT HENNING
VERMILION COUNTY /RURAL 2-LANE

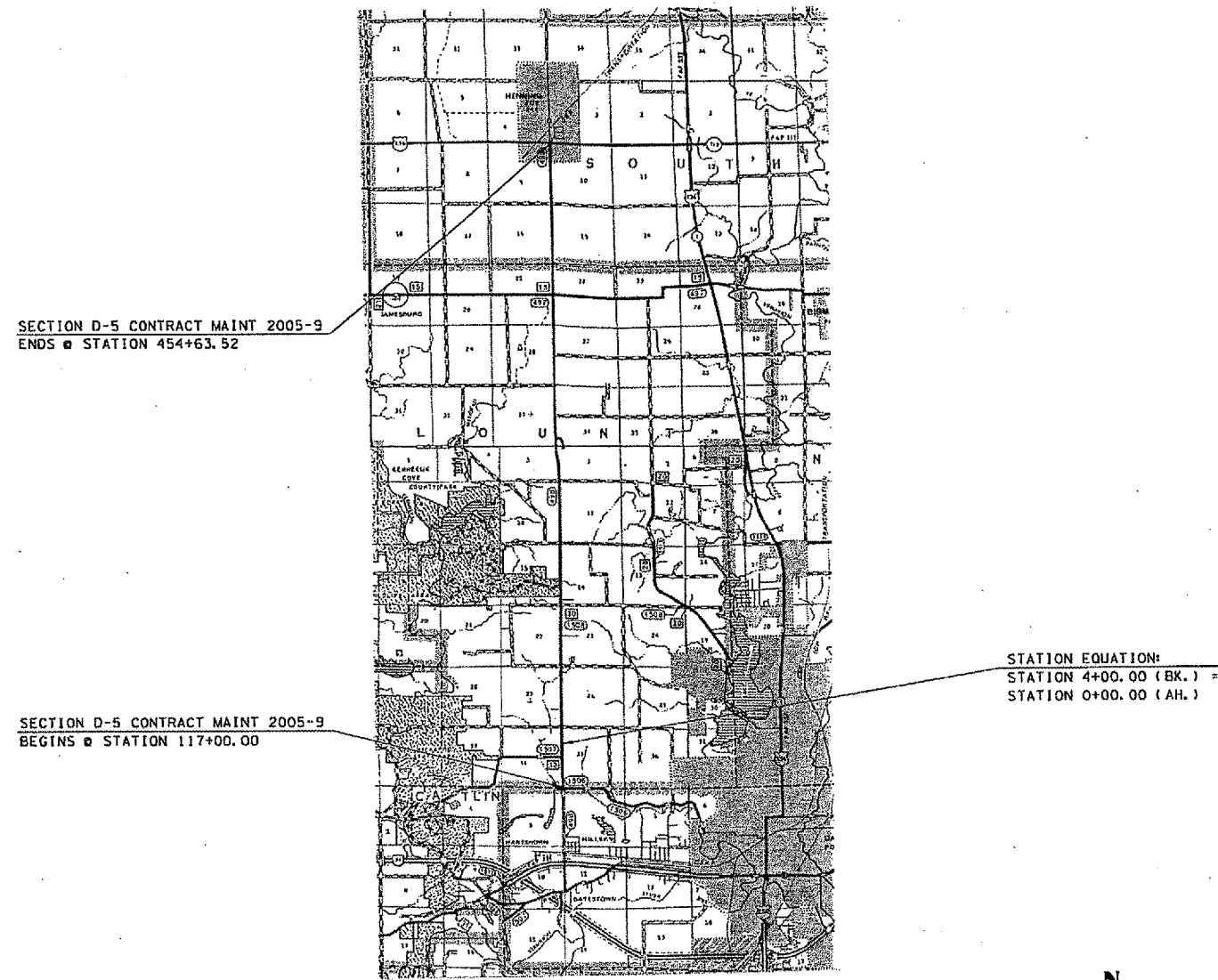

TOTAL LENGTH OF SECTION = 56,763.52 FT. = 10.751 MILES
 NET LENGTH OF SECTION = 56,763.52 FT. = 10.751 MILES

F.A. RTE.	SECTION	COUNTY	TOTAL SHEETS	SHEET NO.
VAR.	*	**	23	4

- D-5 CONTRACT MAINT 2005-9
- ** CHAMPAIGN & VERMILION CONTRACT NO. 70448

LOCATION MAP #4
IL 130 /U.S. 150, FROM PHILO NORTH TO
U.S. 150 INTERSECTION THEN WEST TO
UNIVERSITY AVENUE - URBANA
CHAMPAIGN COUNTY /RURAL 2-LANE, URBAN 2-3 LANE

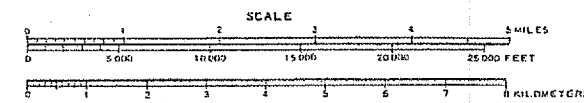
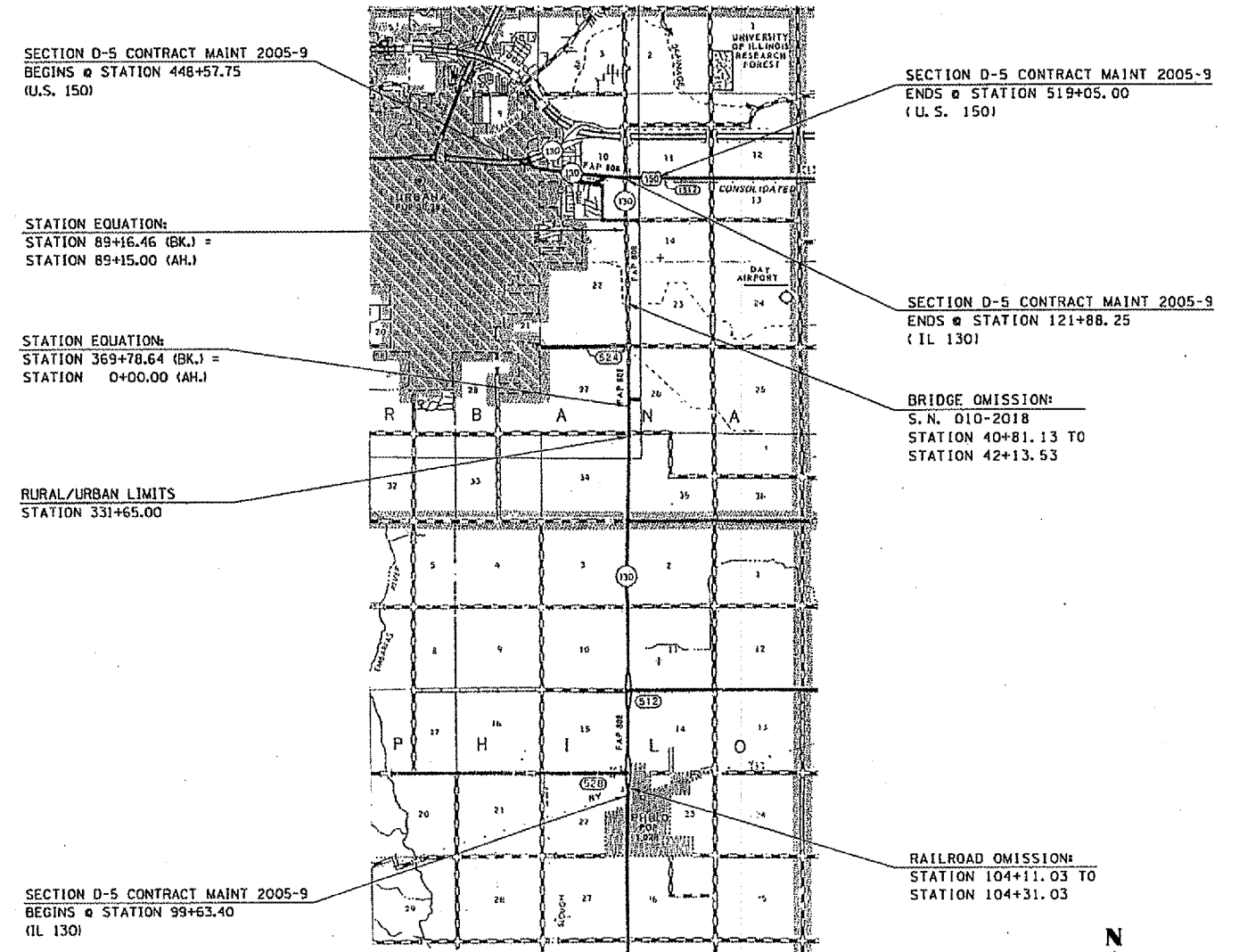

TOTAL LENGTH OF SECTION = 46,252.20 FT. = 8.760 MILES
 NET LENGTH OF SECTION = 46,099.80 FT. = 8.731 MILES