

DATE	
BY	
PLAN	
SURVEYED	
ALIGNMENT CHECKED	
NOTE BOOK NO.	
FIG. OF PLAN CHECKED	
FILE NAME	

DATE	
BY	
PROFILE	
SURVEYED	
GRADES CHECKED	
NOTE BOOK NO.	
FIG. OF PROFILE CHECKED	
FILE NAME	

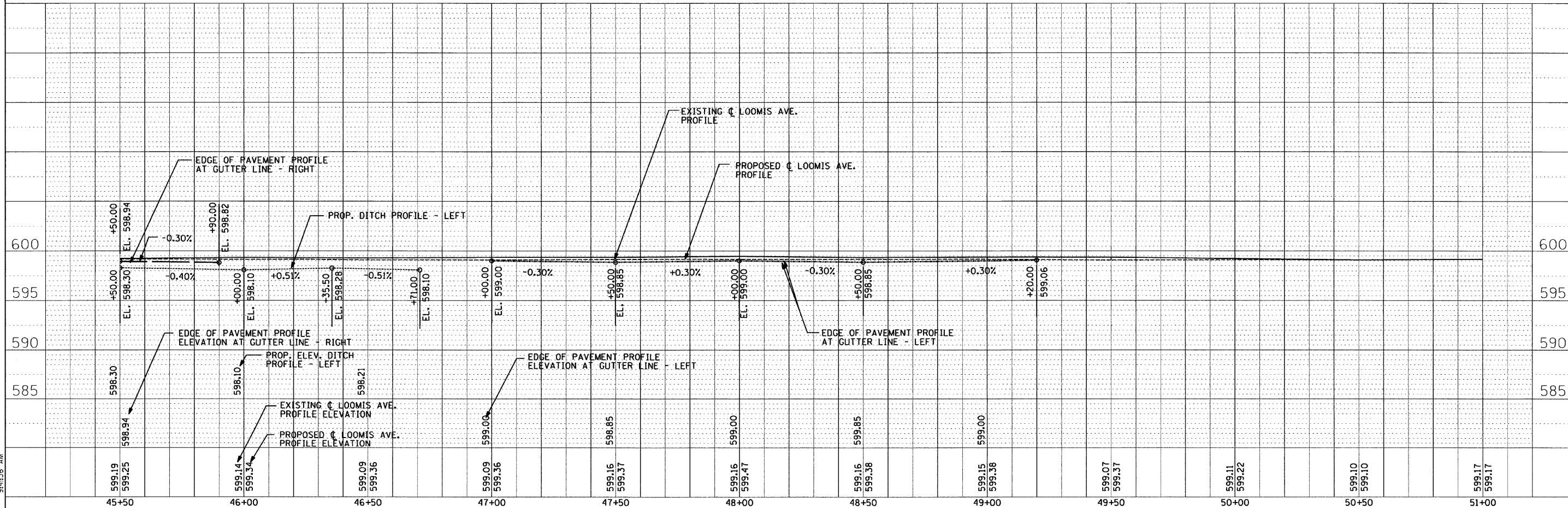
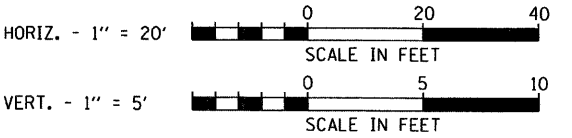
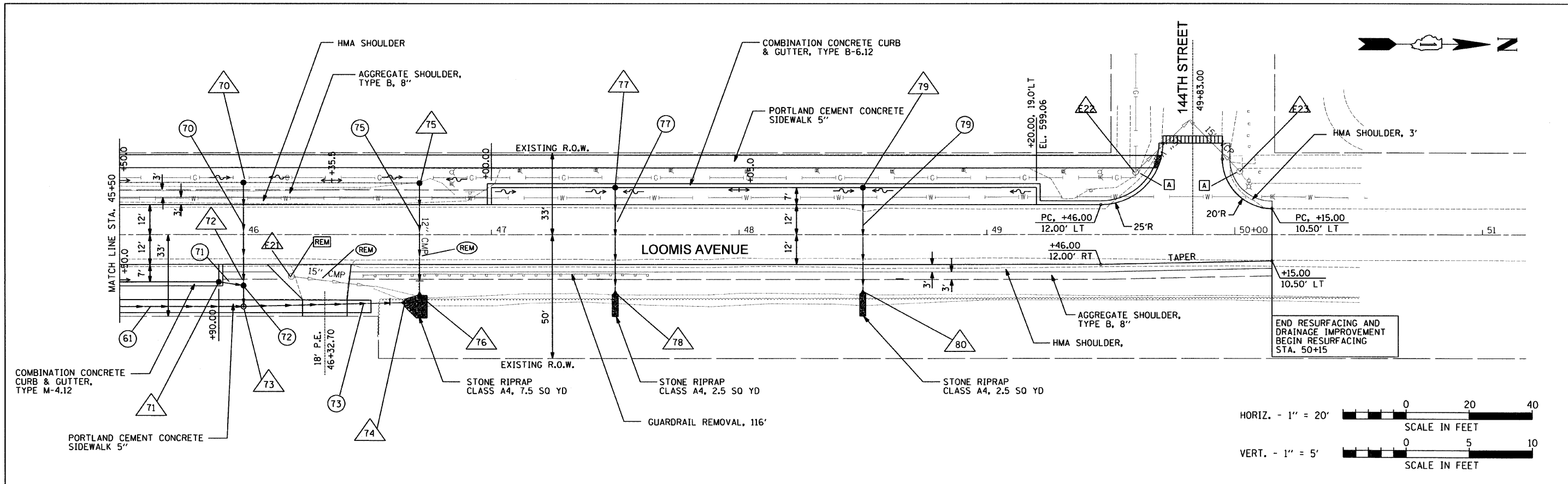

FILE NAME =	USER NAME = .USER.	DESIGNED - WS	REVISED -	STATE OF ILLINOIS DEPARTMENT OF TRANSPORTATION	LOOMIS AVENUE FROM THORNTON RD. TO 150TH ST. ROADWAY AND DRAINAGE IMPROVEMENTS	SBI RTE.	SECTION	COUNTY	TOTAL SHEETS	SHEET NO.	
#FILE#	PLOT SCALE = 20.0000' / IN.	DRAWN - WS	REVISED -			52	522 X-RS-1	COOK	44	18	
	PLOT DATE = 2/14/2011	CHECKED - RS	REVISED -			CONTRACT NO. 60K87					
		DATE - 01-21-2010	REVISED -			ILLINOIS FED. AID PROJECT					

H:\jbs2009\200903024-32\cod\site\dgn\00\0160487-sh1-plcnp1.dgn
 2/14/2011 9:41:35 AM