

STATE OF ILLINOIS
DEPARTMENT OF TRANSPORTATION
DIVISION OF HIGHWAYS

**PROPOSED
HIGHWAY PLANS**

FAS ROUTE 1531 & FAU 7533 (CISCO-MONTICELLO RD.)
SECTION (10,11) I
PAVEMENT PATCHING
PIATT COUNTY
600E TO BRIDGE ST IN MONTICELLO

C-95-054-10

F.A.S. RTE.	SECTION	COUNTY	TOTAL SHEETS	SHEET NO.
1531	(10,11) I	PIATT	12	1
		ILLINOIS	CONTRACT NO. 70877	

D-95-054-10

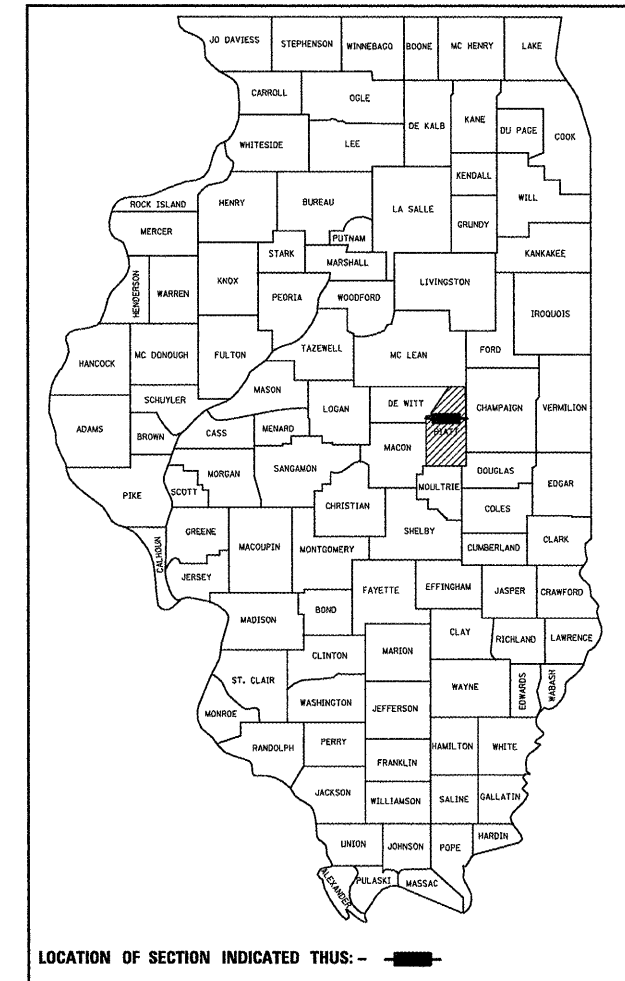

FOR INDEX OF SHEETS, SEE SHEET NO. 2
FOR SUMMARY OF QUANTITIES, SEE SHEET NO. 3

CURRENT ADT	
MAJOR COLLECTOR	
FAS 1531 (CISCO - MONTICELLO RD) = 2000 (2010)	
SU = 4.4%	MU = 0.7%

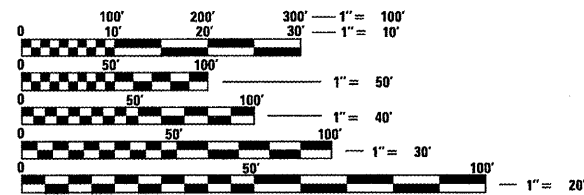

FULL SIZE PLANS HAVE BEEN PREPARED USING STANDARD ENGINEERING SCALES. REDUCED SIZED PLANS WILL NOT CONFORM TO STANDARD SCALES. IN MAKING MEASUREMENTS ON REDUCED PLANS, THE ABOVE SCALES MAY BE USED.

J.U.L.I.E.	
JOINT UTILITY LOCATION INFORMATION FOR EXCAVATION	
1-800-892-0123	TOWNSHIPS
OR 811	MONTICELLO

PROJECT ENGINEER: NANCY FASIG
SQUAD LEADER: STEVE COOMBES
(217) 465-4181
CONTRACT NO. 70877

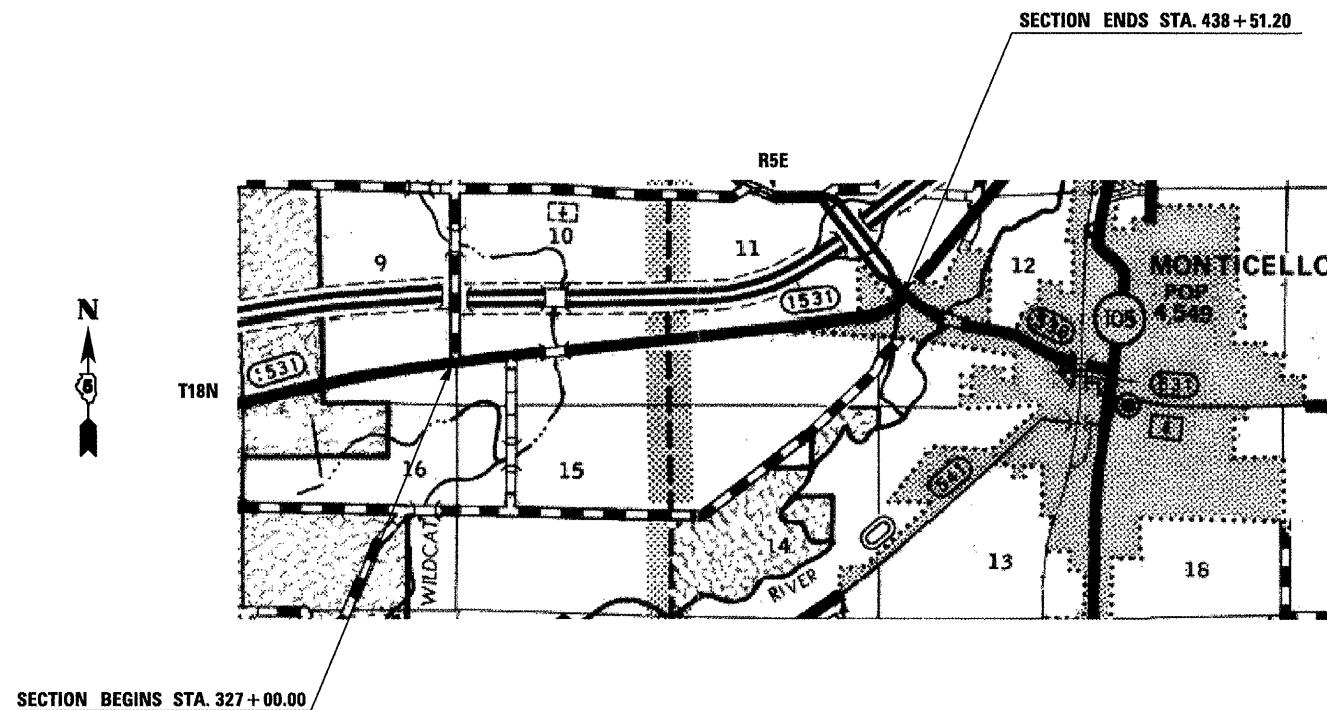

GROSS LENGTH = 11,151.2 FT. = 2.112 MILE
NET LENGTH = 11,151.2 FT. = 2.112 MILE

STATE OF ILLINOIS
DEPARTMENT OF TRANSPORTATION
DIVISION OF HIGHWAYS

SUBMITTED 4/18 20 11
Jessell A. Cowan
DEPUTY DIRECTOR OF HIGHWAYS, REGION ENGINEER

March 25 20 11
Scott E. Stett, P.E.
ACTING ENGINEER OF DESIGN AND ENVIRONMENT

March 25 20 11
Christine M. Reed
DIRECTOR OF HIGHWAYS, CHIEF ENGINEER

PRINTED BY THE AUTHORITY
OF THE STATE OF ILLINOIS

INDEX OF SHEETS

SHEET NO.	DESCRIPTION
1	COVER SHEET
2	INDEX OF SHEETS & LIST OF HIGHWAY STANDARDS
3	GENERAL NOTES
3	SUMMARY OF QUANTITIES
4	EXISTING TYPICAL CROSS SECTION
5 - 12	SCHEDULE OF QUANTITIES

LIST OF HIGHWAY STANDARDS

STANDARD NO.	DESCRIPTION
000001-06	STANDARD SYMBOLS, ABBREVIATIONS AND PATTERNS
001001-02	AREAS OF REINFORCEMENT BARS
001006	DECIMAL OF AN INCH AND OF A FOOT
420001-07	PAVEMENT JOINTS
442201-03	CLASS C AND D PATCHES
701201-04	LANE CLOSURE, 2L, 2W, DAY ONLY, FOR SPEEDS >= 45 M.P.H.
701301-04	LANE CLOSURE, 2L, 2W, SHORT TIME OPERATIONS
701901-01	TRAFFIC CONTROL DEVICES
701011-02	

GENERAL NOTES

G.N.-100
ENGLISH UNITS OF MEASUREMENT SHALL GOVERN OVER AND SUPERSEDE ANY METRIC UNITS SHOWN IN THIS CONTRACT. WHERE INCLUDED, METRIC UNITS ARE FOR INFORMATION ONLY.

G.N.-442B -- PATCHING SCHEDULES
THE PATCHING SCHEDULES INCLUDED IN THE PLANS REPRESENT THE BEST INFORMATION AVAILABLE AT THE TIME OF COMPLETION OF THE PLANS FOR LETTING. VARIATIONS IN LOCATION AND SIZES OF BOTH FULL-DEPTH AND PARTIAL-DEPTH PATCHES MAY OCCUR.

G.N.-1004.01
COARSE AGGREGATE GRADATION CA-10 MAY BE USED WHENEVER COARSE AGGREGATE CA-6 IS SPECIFIED IN THE STANDARD SPECIFICATIONS.

COMMITMENTS:
THERE ARE NO COMMITMENTS FOR THIS CONTRACT.

FILE NAME :	USER NAME : coombessf	DESIGNED -	REVISED -	STATE OF ILLINOIS DEPARTMENT OF TRANSPORTATION	INDEX OF SHEETS, HIGHWAY STANDARDS & GENERAL NOTES	F.A.S. RTE.	SECTION	COUNTY	TOTAL SHEETS	SHEET NO.
c:\pw_work\pwidot\coombessf\08243364\08243364.dgn	70877-shi-gennote.dgn	DRAWN -	REVISED -			1531	(10,111)	PIATT	12	2
PLOT SCALE : 40.0000 ' / IN.	CHECKED -	REVISED -	REVISED -			CONTRACT NO. 70877				
PLOT DATE : 1/7/2011	DATE -	REVISED -	REVISED -		SCALE:	SHEET NO.	OF	SHEETS	STA.	TO STA.
[ILLINOIS] FED. AID PROJECT										

SUMMARY OF QUANTITIES

LOCATION OF WORK:	PIATT CO. FAS 1531/ FAU 7533	PIATT CO. FAS 1531	PIATT CO. FAU 7533
	MONTICELLO - CISCO RD	MONTICELLO - CISCO RD 2 LANE RURAL STA. 327+00 TO STA. 380+80	MONTICELLO - CISCO RD 2 LANE URBAN STA. 380+80 TO STA. 438+51.2
FUNDING BREAKOUT:	100 % STATE	100 % STATE	100 % STATE
CONSTRUCTION TYPE CODE:		0005	0005

CODE NO.	DESCRIPTION	UNIT	TOTAL QUANTITY	QUANTITY	QUANTITY
44201337	CLASS C PATCHES, TYPE I, 9 INCH	SQ YD	388.0	161.0	227.0
44201341	CLASS C PATCHES, TYPE II, 9 INCH	SQ YD	1,203.0	410.0	793.0
44201345	CLASS C PATCHES, TYPE III, 9 INCH	SQ YD	295.0	150.0	145.0
44201347	CLASS C PATCHES, TYPE IV, 9 INCH	SQ YD	388.0	82.0	306.0
67100100	MOBILIZATION	L SUM	1.0	0.5	0.5
70100450	TRAFFIC CONTROL AND PROTECTION, STANDARD 701201	L SUM	1.0	0.5	0.5

FILE NAME :	USER NAME = coombessf	DESIGNED -	REVISED -	STATE OF ILLINOIS DEPARTMENT OF TRANSPORTATION	SUMMARY OF QUANTITIES	F.A.S. RTE.	SECTION	COUNTY	TOTAL SHEETS	SHEET NO.
ct:\pw\work\p\ridot\coombessf\d0243364\0570877-sh1-S00.dgn	DRAWN -	REVISED -				1531	(10,11)I	PIATT	12	3
PLOT SCALE = 40.0000' / IN.	CHECKED -	REVISED -				CONTRACT NO. 70877				
PLOT DATE = 1/13/2011	DATE -	REVISED -				SCALE:	SHEET NO. OF SHEETS	STA. TO STA.	ILLINOIS FED. AID PROJECT	

EXISTING TYPICAL CROSS SECTION 1

FAS 1531 (OLD IL 47)

STATION 327+00.00 TO STATION 424+36.60*

*S.E. ATTAINED STA. 422+52.60 TO STA. 424+36.60

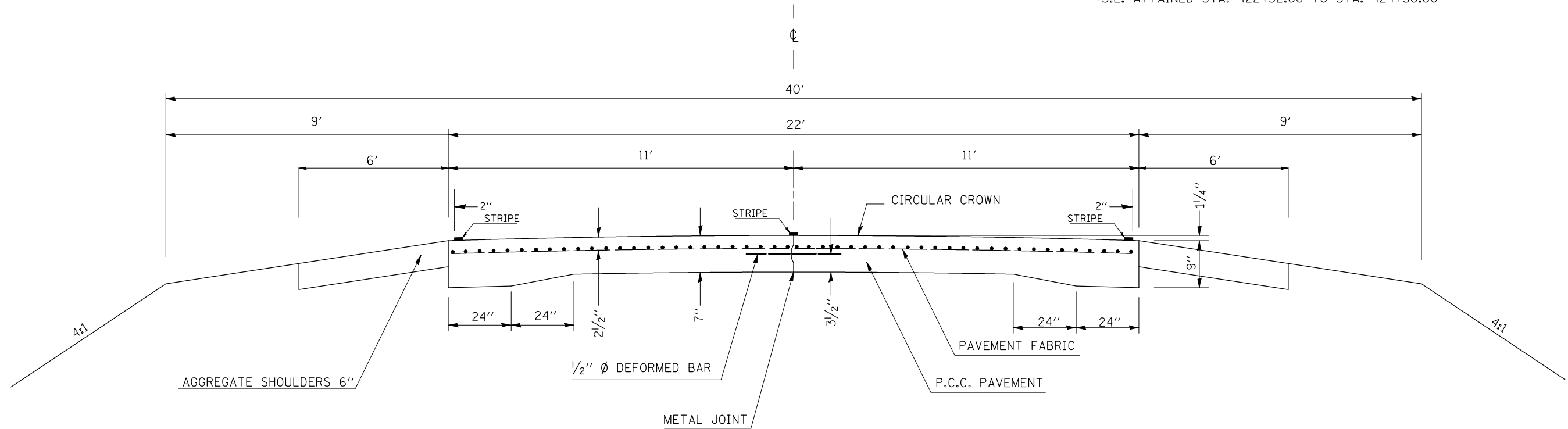

EXISTING TYPICAL CROSS SECTION 2

FAS 1531 (OLD IL 47)

STATION 424+36.60* TO STATION 438+51.20

*S.E. ATTAINED STA. 422+52.60 TO STA. 424+36.60

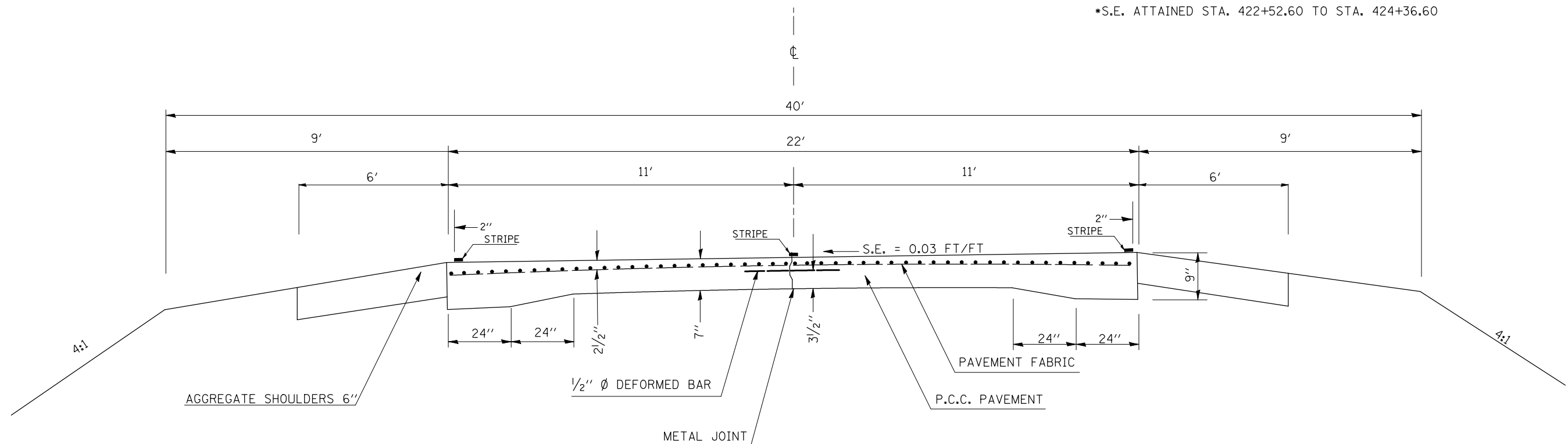

FILE NAME =	USER NAME = coombessf	DESIGNED -	REVISED -
ct:\pw\work\p\dot\coombessf\d0243364\0570877-sht-typical.dgn		DRAWN -	REVISED -
PLOT SCALE = 40.0000' / IN.		CHECKED -	REVISED -
PLOT DATE = 1/7/2011		DATE -	REVISED -

STATE OF ILLINOIS
DEPARTMENT OF TRANSPORTATION

TYPICAL CROSS SECTIONS

SCALE: SHEET NO. OF SHEETS STA. TO STA.

F.A.S. RTE.	SECTION	COUNTY	TOTAL SHEETS	SHEET NO.
1531	(10,11)	PIATT	12	4
CONTRACT NO. 70877				
ILLINOIS FED. AID PROJECT				

SCHEDULE OF QUANTITIES

PATCHING SCHEDULE

STATION	DIRECTION	LENGTH (FT)	WIDTH (FT)	44201337	44201341	44201345	44201347	TIE BARS FOR INFO ONLY NO PAYMENT (EACH)
				CLASS C PATCHES, TYPE I 9.0" (SQ YD)	CLASS C PATCHES, TYPE II 9.0" (SQ YD)	CLASS C PATCHES, TYPE III 9.0" (SQ YD)	CLASS C PATCHES, TYPE IV 9.0" (SQ YD)	
STATION 327+00.00 TO STATION 340+00.00				48.0	142.0	34.0	45.0	15.0
348+00.00	EB	6	11	0.0	7.3	0.0	0.0	0
350+00.00	EB	6	11	0.0	7.3	0.0	0.0	0
351+50.00	EB	6	11	0.0	7.3	0.0	0.0	0
351+50.00	WB	6	11	0.0	7.3	0.0	0.0	0
353+10.00	EB	15	11	0.0	0.0	18.3	0.0	0
353+10.00	WB	15	11	0.0	0.0	18.3	0.0	0
353+50.00	EB	4	11	4.9	0.0	0.0	0.0	0
353+60.00	WB	6	11	0.0	7.3	0.0	0.0	0
354+00.00	EB	10	11	0.0	12.2	0.0	0.0	0
354+00.00	WB	10	11	0.0	12.2	0.0	0.0	0
354+20.00	WB	8	11	0.0	9.8	0.0	0.0	0
355+00.00	WB	12	11	0.0	14.7	0.0	0.0	0
355+18.00	EB	4	11	4.9	0.0	0.0	0.0	0
355+18.00	WB	4	11	4.9	0.0	0.0	0.0	0
355+95.00	EB	6	11	0.0	7.3	0.0	0.0	0
355+95.00	WB	6	11	0.0	7.3	0.0	0.0	0
356+44.00	WB	12	6	0.0	8.0	0.0	0.0	0
356+93.00	WB	8	11	0.0	9.8	0.0	0.0	0
357+92.00	EB	8	6	0.0	5.3	0.0	0.0	0
357+92.00	WB	8	11	0.0	9.8	0.0	0.0	0
359+90.00	WB	10	11	0.0	12.2	0.0	0.0	0
362+43.00	EB	8	6	0.0	5.3	0.0	0.0	0
362+93.00	WB	12	11	0.0	14.7	0.0	0.0	0
364+91.00	EB	6	6	4.0	0.0	0.0	0.0	0
364+91.00	WB	6	6	4.0	0.0	0.0	0.0	0
365+41.00	EB	6	11	0.0	7.3	0.0	0.0	0
365+41.00	WB	6	11	0.0	7.3	0.0	0.0	0
365+91.00	EB	15	11	0.0	0.0	18.3	0.0	0
365+91.00	WB	30	11	0.0	0.0	0.0	36.7	15
366+30.00	EB	20	11	0.0	0.0	24.4	0.0	10
SUB TOTALS				70.7 (SQ YD)	322.0 (SQ YD)	113.4 (SQ YD)	81.7 (SQ YD)	40.0 (EACH)

*A PATCHING SURVEY WAS NOT CONDUCTED FROM STATION 327+00 TO STATION 340+00. QUANTITIES WERE ESTIMATED, BASED ON THE PERCENTAGE OF PATCHING THROUGHOUT THE REMAINDER OF THE SECTION.

SCHEDULE OF QUANTITIES

PATCHING SCHEDULE (CONTD)								
STATION	DIRECTION	LENGTH	WIDTH	44201337	44201341	44201345	44201347	TIE BARS FOR INFO ONLY NO PAYMENT (EACH)
				CLASS C PATCHES, TYPE I 9.0" (SQ YD)	CLASS C PATCHES, TYPE II 9.0" (SQ YD)	CLASS C PATCHES, TYPE III 9.0" (SQ YD)	CLASS C PATCHES, TYPE IV 9.0" (SQ YD)	
		(FT)	(FT)					
366+39.00	WB	8	11	0.0	9.8	0.0	0.0	0
366+93.00	EB	6	6	4.0	0.0	0.0	0.0	0
367+13.00	EB	10	6	0.0	6.7	0.0	0.0	0
367+67.00	WB	4	11	4.9	0.0	0.0	0.0	0
367+87.00	EB	4	11	4.9	0.0	0.0	0.0	0
367+87.00	WB	4	11	4.9	0.0	0.0	0.0	0
368+11.00	EB	15	11	0.0	0.0	18.3	0.0	0
368+11.00	WB	15	11	0.0	0.0	18.3	0.0	0
368+35.00	EB	6	11	0.0	7.3	0.0	0.0	0
368+35.00	WB	6	11	0.0	7.3	0.0	0.0	0
370+88.00	CL	8	6	0.0	5.3	0.0	0.0	0
371+37.00	EB	4	11	4.9	0.0	0.0	0.0	0
371+37.00	WB	4	11	4.9	0.0	0.0	0.0	0
372+51.00	EB	4	11	4.9	0.0	0.0	0.0	0
372+87.00	EB	4	11	4.9	0.0	0.0	0.0	0
372+87.00	WB	4	11	4.9	0.0	0.0	0.0	0
373+86.00	EB	6	11	0.0	7.3	0.0	0.0	0
374+85.00	WB	6	11	0.0	7.3	0.0	0.0	0
375+58.00	WB	4	11	4.9	0.0	0.0	0.0	0
375+84.00	EB	4	11	4.9	0.0	0.0	0.0	0
375+84.00	WB	4	11	4.9	0.0	0.0	0.0	0
376+13.00	EB	4	11	4.9	0.0	0.0	0.0	0
376+13.00	WB	4	11	4.9	0.0	0.0	0.0	0
376+31.00	EB	4	11	4.9	0.0	0.0	0.0	0
376+80.00	EB	6	11	0.0	7.3	0.0	0.0	0
376+80.00	WB	6	11	0.0	7.3	0.0	0.0	0
377+30.00	EB	6	11	0.0	7.3	0.0	0.0	0
377+30.00	WB	6	11	0.0	7.3	0.0	0.0	0
378+32.00	WB	6	6	4.0	0.0	0.0	0.0	0
378+83.00	EB	6	6	4.0	0.0	0.0	0.0	0
SUB TOTALS				80.4 (SQ YD)	80.4 (SQ YD)	36.7 (SQ YD)	0.0 (SQ YD)	0.0 (EACH)

SCHEDULE OF QUANTITIES

PATCHING SCHEDULE (CONT'D)

STATION	DIRECTION	LENGTH (FT)	WIDTH (FT)	44201337	44201341	44201345	44201347	TIE BARS FOR INFO ONLY NO PAYMENT (EACH)
				CLASS C	CLASS C	CLASS C	CLASS C	
				PATCHES, TYPE I 9.0"	PATCHES, TYPE II 9.0"	PATCHES, TYPE III 9.0"	PATCHES, TYPE IV 9.0"	
				(SQ YD)	(SQ YD)	(SQ YD)	(SQ YD)	
379+31.00	EB	4	11	4.9	0.0	0.0	0.0	0
379+31.00	WB	4	11	4.9	0.0	0.0	0.0	0
380+43.00	CL	6	11	0.0	7.3	0.0	0.0	0
380+92.00	EB	6	11	0.0	7.3	0.0	0.0	0
381+41.00	EB	6	11	0.0	7.3	0.0	0.0	0
381+41.00	WB	6	11	0.0	7.3	0.0	0.0	0
381+92.00	EB	6	11	0.0	7.3	0.0	0.0	0
381+92.00	WB	6	11	0.0	7.3	0.0	0.0	0
382+41.00	EB	6	11	0.0	7.3	0.0	0.0	0
382+91.00	EB	6	11	0.0	7.3	0.0	0.0	0
382+91.00	WB	6	11	0.0	7.3	0.0	0.0	0
383+92.00	EB	6	11	0.0	7.3	0.0	0.0	0
383+92.00	WB	6	11	0.0	7.3	0.0	0.0	0
384+91.00	WB	15	6	0.0	10.0	0.0	0.0	0
385+40.00	EB	6	11	0.0	7.3	0.0	0.0	0
385+40.00	WB	8	6	0.0	5.3	0.0	0.0	0
386+41.00	EB	8	11	0.0	9.8	0.0	0.0	0
386+41.00	WB	6	6	4.0	0.0	0.0	0.0	0
386+91.00	WB	6	6	4.0	0.0	0.0	0.0	0
387+43.00	EB	6	6	4.0	0.0	0.0	0.0	0
387+43.00	WB	6	6	4.0	0.0	0.0	0.0	0
387+91.00	EB	8	11	0.0	9.8	0.0	0.0	0
387+91.00	WB	8	11	0.0	9.8	0.0	0.0	0
390+50.00	EB	4	11	4.9	0.0	0.0	0.0	0
390+50.00	WB	4	11	4.9	0.0	0.0	0.0	0
391+01.00	EB	4	11	4.9	0.0	0.0	0.0	0
391+01.00	WB	4	11	4.9	0.0	0.0	0.0	0
394+47.00	EB	10	6	0.0	6.7	0.0	0.0	0
395+17.00	EB	15	11	0.0	0.0	18.3	0.0	0
395+17.00	WB	12	11	0.0	14.7	0.0	0.0	0
SUB TOTALS				45.3 (SQ YD)	154.0 (SQ YD)	18.3 (SQ YD)	0.0 (SQ YD)	0.0 (EACH)

↑
RURAL
↓
URBAN

SCHEDULE OF QUANTITIES

PATCHING SCHEDULE (CONT'D)								
STATION	DIRECTION	LENGTH	WIDTH	44201337	44201341	44201345	44201347	TIE BARS FOR INFO ONLY NO PAYMENT (EACH)
				CLASS C PATCHES, TYPE I 9.0" (SQ YD)	CLASS C PATCHES, TYPE II 9.0" (SQ YD)	CLASS C PATCHES, TYPE III 9.0" (SQ YD)	CLASS C PATCHES, TYPE IV 9.0" (SQ YD)	
		(FT)	(FT)					
395+44.00	EB	4	11	4.9	0.0	0.0	0.0	0
395+44.00	WB	4	11	4.9	0.0	0.0	0.0	0
396+95.00	EB	8	6	0.0	5.3	0.0	0.0	0
396+95.00	WB	8	6	0.0	5.3	0.0	0.0	0
398+48.00	EB	6	11	0.0	7.3	0.0	0.0	0
398+48.00	WB	12	11	0.0	14.7	0.0	0.0	0
399+99.00	EB	6	11	0.0	7.3	0.0	0.0	0
399+99.00	WB	6	11	0.0	7.3	0.0	0.0	0
400+48.00	EB	6	11	0.0	7.3	0.0	0.0	0
400+48.00	WB	6	11	0.0	7.3	0.0	0.0	0
402+49.00	EB	6	11	0.0	7.3	0.0	0.0	0
402+49.00	WB	6	11	0.0	7.3	0.0	0.0	0
403+48.00	EB	6	11	0.0	7.3	0.0	0.0	0
403+48.00	WB	6	11	0.0	7.3	0.0	0.0	0
404+30.00	EB	4	11	4.9	0.0	0.0	0.0	0
404+30.00	WB	4	11	4.9	0.0	0.0	0.0	0
404+48.00	EB	4	11	4.9	0.0	0.0	0.0	0
404+48.00	WB	4	11	4.9	0.0	0.0	0.0	0
404+61.00	EB	4	11	4.9	0.0	0.0	0.0	0
404+61.00	WB	4	11	4.9	0.0	0.0	0.0	0
404+98.00	EB	6	11	0.0	7.3	0.0	0.0	0
404+98.00	WB	6	11	0.0	7.3	0.0	0.0	0
405+46.00	EB	6	11	0.0	7.3	0.0	0.0	0
405+46.00	WB	6	11	0.0	7.3	0.0	0.0	0
405+98.00	EB	6	11	0.0	7.3	0.0	0.0	0
405+98.00	WB	6	11	0.0	7.3	0.0	0.0	0
				0.0	0.0	0.0	0.0	0
				0.0	0.0	0.0	0.0	0
				0.0	0.0	0.0	0.0	0
				0.0	0.0	0.0	0.0	0
SUB TOTALS				39.1 (SQ YD)	135.3 (SQ YD)	0.0 (SQ YD)	0.0 (SQ YD)	0.0 (EACH)

SCHEDULE OF QUANTITIES

PATCHING SCHEDULE (CONT'D)								
STATION	DIRECTION	LENGTH	WIDTH	44201337	44201341	44201345	44201347	TIE BARS FOR INFO ONLY NO PAYMENT (EACH)
				CLASS C PATCHES, TYPE I 9.0"	CLASS C PATCHES, TYPE II 9.0"	CLASS C PATCHES, TYPE III 9.0"	CLASS C PATCHES, TYPE IV 9.0"	
				(SQ YD)	(SQ YD)	(SQ YD)	(SQ YD)	
406+53.00	EB	8	11	0.0	9.8	0.0	0.0	0
406+53.00	WB	8	11	0.0	9.8	0.0	0.0	0
407+49.00	EB	4	11	4.9	0.0	0.0	0.0	0
407+49.00	WB	4	11	4.9	0.0	0.0	0.0	0
408+00.00	EB	4	11	4.9	0.0	0.0	0.0	0
408+00.00	WB	4	11	4.9	0.0	0.0	0.0	0
408+46.00	EB	8	11	0.0	9.8	0.0	0.0	0
408+46.00	WB	8	11	0.0	9.8	0.0	0.0	0
408+97.00	EB	8	11	0.0	9.8	0.0	0.0	0
408+97.00	WB	8	11	0.0	9.8	0.0	0.0	0
409+78.00	EB	8	11	0.0	9.8	0.0	0.0	0
410+46.00	EB	4	11	4.9	0.0	0.0	0.0	0
410+46.00	WB	4	11	4.9	0.0	0.0	0.0	0
411+00.00	WB	10	6	0.0	6.7	0.0	0.0	0
411+08.00	WB	15	6	0.0	10.0	0.0	0.0	0
411+44.00	EB	4	11	4.9	0.0	0.0	0.0	0
411+44.00	WB	4	11	4.9	0.0	0.0	0.0	0
411+96.00	EB	8	11	0.0	9.8	0.0	0.0	0
411+96.00	WB	8	11	0.0	9.8	0.0	0.0	0
413+00.00	EB	8	11	0.0	9.8	0.0	0.0	0
413+00.00	WB	8	11	0.0	9.8	0.0	0.0	0
413+54.00	EB	6	11	0.0	7.3	0.0	0.0	0
413+54.00	WB	6	11	0.0	7.3	0.0	0.0	0
413+80.00	EB	4	11	4.9	0.0	0.0	0.0	0
414+54.00	WB	4	11	4.9	0.0	0.0	0.0	0
415+03.00	EB	6	11	0.0	7.3	0.0	0.0	0
415+03.00	WB	6	11	0.0	7.3	0.0	0.0	0
415+51.00	EB	6	11	0.0	7.3	0.0	0.0	0
415+51.00	WB	6	11	0.0	7.3	0.0	0.0	0
416+00.00	EB	12	11	0.0	14.7	0.0	0.0	0
SUB TOTALS				48.9 (SQ YD)	182.9 (SQ YD)	0.0 (SQ YD)	0.0 (SQ YD)	0.0 (EACH)

SCHEDULE OF QUANTITIES

PATCHING SCHEDULE (CONT'D)								
STATION	DIRECTION	LENGTH	WIDTH	44201337	44201341	44201345	44201347	TIE BARS FOR INFO ONLY NO PAYMENT (EACH)
				CLASS C PATCHES, TYPE I 9.0" (SQ YD)	CLASS C PATCHES, TYPE II 9.0" (SQ YD)	CLASS C PATCHES, TYPE III 9.0" (SQ YD)	CLASS C PATCHES, TYPE IV 9.0" (SQ YD)	
		(FT)	(FT)					
416+51.00	EB	6	11	0.0	7.3	0.0	0.0	0
417+01.00	EB	6	11	0.0	7.3	0.0	0.0	0
417+01.00	WB	6	11	0.0	7.3	0.0	0.0	0
417+39.00	EB	12	11	0.0	14.7	0.0	0.0	0
417+39.00	WB	8	11	0.0	9.8	0.0	0.0	0
417+61.00	WB	6	11	0.0	7.3	0.0	0.0	0
417+75.00	EB	20	11	0.0	0.0	24.4	0.0	10
417+75.00	WB	20	11	0.0	0.0	24.4	0.0	10
418+19.00	EB	10	11	0.0	12.2	0.0	0.0	0
418+19.00	WB	10	11	0.0	12.2	0.0	0.0	0
418+71.00	EB	4	11	4.9	0.0	0.0	0.0	0
418+71.00	WB	4	11	4.9	0.0	0.0	0.0	0
419+22.00	EB	4	11	4.9	0.0	0.0	0.0	0
419+22.00	WB	6	11	0.0	7.3	0.0	0.0	0
420+52.00	WB	6	11	0.0	7.3	0.0	0.0	0
420+73.00	EB	6	11	0.0	7.3	0.0	0.0	0
420+73.00	WB	6	11	0.0	7.3	0.0	0.0	0
421+73.00	WB	4	11	4.9	0.0	0.0	0.0	0
422+74.00	EB	6	11	0.0	7.3	0.0	0.0	0
422+74.00	WB	6	11	0.0	7.3	0.0	0.0	0
423+21.00	EB	12	11	0.0	14.7	0.0	0.0	0
423+21.00	WB	6	11	0.0	7.3	0.0	0.0	0
423+41.00	EB	6	11	0.0	7.3	0.0	0.0	0
423+41.00	WB	6	11	0.0	7.3	0.0	0.0	0
423+72.00	EB	6	11	0.0	7.3	0.0	0.0	0
423+72.00	WB	15	11	0.0	0.0	18.3	0.0	0
424+22.00	EB	6	11	0.0	7.3	0.0	0.0	0
424+22.00	WB	8	11	0.0	9.8	0.0	0.0	0
424+53.00	EB	4	11	4.9	0.0	0.0	0.0	0
424+53.00	WB	4	11	4.9	0.0	0.0	0.0	0
SUB TOTALS				29.3 (SQ YD)	183.3 (SQ YD)	67.2 (SQ YD)	0.0 (SQ YD)	20.0 (EACH)

SCHEDULE OF QUANTITIES

PATCHING SCHEDULE (CONT'D)								
STATION	DIRECTION	LENGTH	WIDTH	44201337	44201341	44201345	44201347	TIE BARS FOR INFO ONLY NO PAYMENT (EACH)
				CLASS C PATCHES, TYPE I 9.0" (SQ YD)	CLASS C PATCHES, TYPE II 9.0" (SQ YD)	CLASS C PATCHES, TYPE III 9.0" (SQ YD)	CLASS C PATCHES, TYPE IV 9.0" (SQ YD)	
		(FT)	(FT)					
425+23.00	EB	6	11	0.0	7.3	0.0	0.0	0
425+23.00	WB	10	11	0.0	12.2	0.0	0.0	0
425+50.00	EB	4	11	4.9	0.0	0.0	0.0	0
425+50.00	WB	4	11	4.9	0.0	0.0	0.0	0
426+55.00	EB	4	11	4.9	0.0	0.0	0.0	0
426+55.00	WB	4	11	4.9	0.0	0.0	0.0	0
426+77.00	WB	8	6	0.0	5.3	0.0	0.0	0
426+87.00	EB	4	11	4.9	0.0	0.0	0.0	0
426+87.00	WB	6	11	0.0	7.3	0.0	0.0	0
427+85.00	EB	25	11	0.0	0.0	0.0	30.6	13
427+85.00	WB	50	11	0.0	0.0	0.0	61.1	25
428+47.00	EB	4	11	4.9	0.0	0.0	0.0	0
428+47.00	WB	4	11	4.9	0.0	0.0	0.0	0
429+25.00	EB	10	6	0.0	6.7	0.0	0.0	0
429+35.00	EB	12	11	0.0	14.7	0.0	0.0	0
430+35.00	EB	4	11	4.9	0.0	0.0	0.0	0
430+35.00	WB	8	11	0.0	9.8	0.0	0.0	0
430+52.00	WB	6	11	0.0	7.3	0.0	0.0	0
430+68.00	EB	12	11	0.0	14.7	0.0	0.0	0
431+57.00	EB	15	11	0.0	0.0	18.3	0.0	0
431+57.00	WB	4	11	4.9	0.0	0.0	0.0	0
431+72.00	EB	15	6	0.0	10.0	0.0	0.0	0
432+15.00	WB	12	6	0.0	8.0	0.0	0.0	0
432+27.00	WB	15	11	0.0	0.0	18.3	0.0	0
432+59.00	WB	10	11	0.0	12.2	0.0	0.0	0
433+15.00	WB	6	11	0.0	7.3	0.0	0.0	0
433+50.00	WB	4	11	4.9	0.0	0.0	0.0	0
434+05.00	WB	50	11	0.0	0.0	0.0	61.1	25
434+44.00	EB	40	11	0.0	0.0	0.0	48.9	20
434+44.00	WB	4	11	4.9	0.0	0.0	0.0	0
SUB TOTALS				53.8 (SQ YD)	122.9 (SQ YD)	36.7 (SQ YD)	201.7 (SQ YD)	83.0 (EACH)

SCHEDULE OF QUANTITIES

PATCHING SCHEDULE (CONT'D)								
STATION	DIRECTION	LENGTH	WIDTH	44201337	44201341	44201345	44201347	TIE BARS FOR INFO ONLY NO PAYMENT (EACH)
				CLASS C PATCHES, TYPE I 9.0"	CLASS C PATCHES, TYPE II 9.0"	CLASS C PATCHES, TYPE III 9.0"	CLASS C PATCHES, TYPE IV 9.0"	
				(SQ YD)	(SQ YD)	(SQ YD)	(SQ YD)	
434+98.00	WB	4	11	4.9	0.0	0.0	0.0	0
435+20.00	WB	18	11	0.0	0.0	22.0	0.0	0
435+50.00	EB	50	11	0.0	0.0	0.0	61.1	25
435+81.00	WB	4	11	4.9	0.0	0.0	0.0	0
435+93.00	WB	4	11	4.9	0.0	0.0	0.0	0
436+13.00	WB	6	11	0.0	7.3	0.0	0.0	0
436+47.00	EB	4	11	4.9	0.0	0.0	0.0	0
436+47.00	WB	35	11	0.0	0.0	0.0	42.8	18
436+97.00	EB	6	11	0.0	7.3	0.0	0.0	0
436+97.00	WB	6	11	0.0	7.3	0.0	0.0	0
SUB TOTALS				19.6 (SQ YD)	22.0 (SQ YD)	22.0 (SQ YD)	103.9 (SQ YD)	43.0 (EACH)

	44201337	44201341	44201345	44201347	TIE BARS FOR INFO ONLY NO PAYMENT (EACH)
	CLASS C PATCHES, TYPE I 9.0"	CLASS C PATCHES, TYPE II 9.0"	CLASS C PATCHES, TYPE III 9.0"	CLASS C PATCHES, TYPE IV 9.0"	
	(SQ YD)	(SQ YD)	(SQ YD)	(SQ YD)	
TOTAL=	387.2	1202.9	294.3	387.3	186.0
USE =	388.0	1203.0	295.0	388.0	186.0
	(SQ YD)	(SQ YD)	(SQ YD)	(SQ YD)	(EACH)