

EXIST. CURVE 328
 PI STA. = 328+92.68
 $\Delta = 2^\circ 07' 00''$ (LT)
 D = 0° 16' 00"
 R = 21,487.27'
 T = 396.95'
 L = 793.80'
 E = 3.67'
 $\theta =$ -----
 T.R. = -----
 S.E. RUN = -----
 P.C. STA. = 324+95.73
 P.T. STA. = 332+89.53

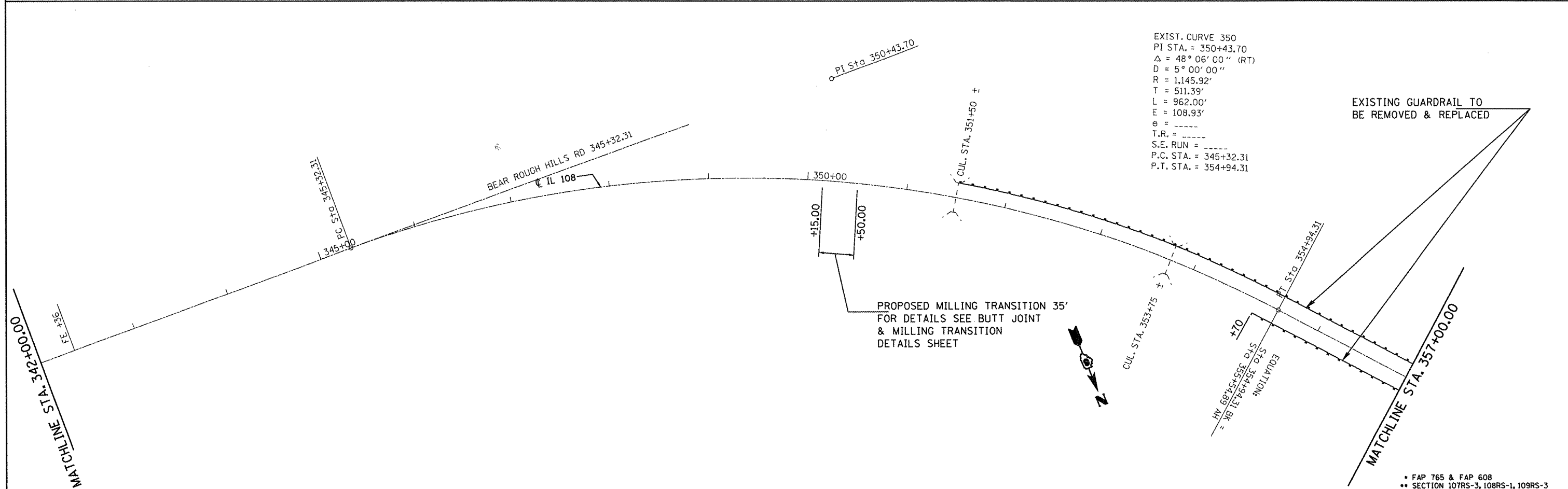

EXIST. CURVE 350
 PI STA. = 350+43.70
 $\Delta = 48^\circ 06' 00''$ (RT)
 D = 5° 00' 00"
 R = 1,145.92'
 T = 511.39'
 L = 962.00'
 E = 108.93'
 $\theta =$ -----
 T.R. = -----
 S.E. RUN = -----
 P.C. STA. = 345+32.31
 P.T. STA. = 354+94.31

PROPOSED MILLING TRANSITION 35'
 FOR DETAILS SEE BUTT JOINT
 & MILLING TRANSITION
 DETAILS SHEET

EXISTING GUARDRAIL TO
 BE REMOVED & REPLACED

FILE NAME =	USER NAME = laughlinr1	DESIGNED -	REVISED -	STATE OF ILLINOIS DEPARTMENT OF TRANSPORTATION	IL 108 PLAN			F.A.P. RTE.	SECTION	COUNTY	TOTAL SHEETS	SHEET NO.
ct:\pwork\pwidot\laughlinr1\0215448\06	C36-shr-plan-IL108south.dgn	DRAWN -	REVISED -					.	..	MACOUPIN	46	36
	PLOT SCALE = 100.0000' / in.	CHECKED -	REVISED -					SCALE: SHEET NO. OF SHEETS STA. 328+00.00 TO STA. 357+00.00			CONTRACT NO. 72C36	
	PLOT DATE = Dec-17-2010 01:59:13PM	DATE -	REVISED -					ILLINOIS FED. AID PROJECT				

FAP 765 & FAP 608
 SECTION 107RS-3, 108RS-1, 109RS-3