

DATE	
BY	
FINAL SURVEY	
SURVEYED	
PLOTTED	
REPLANE	
NOTE BOOK	
AREAS CHECKED	
NO.	

DATE	
BY	
ORIGINAL SURVEY	
SURVEYED	
PLOTTED	
REPLANE	
NOTE BOOK	
AREAS CHECKED	
NO.	

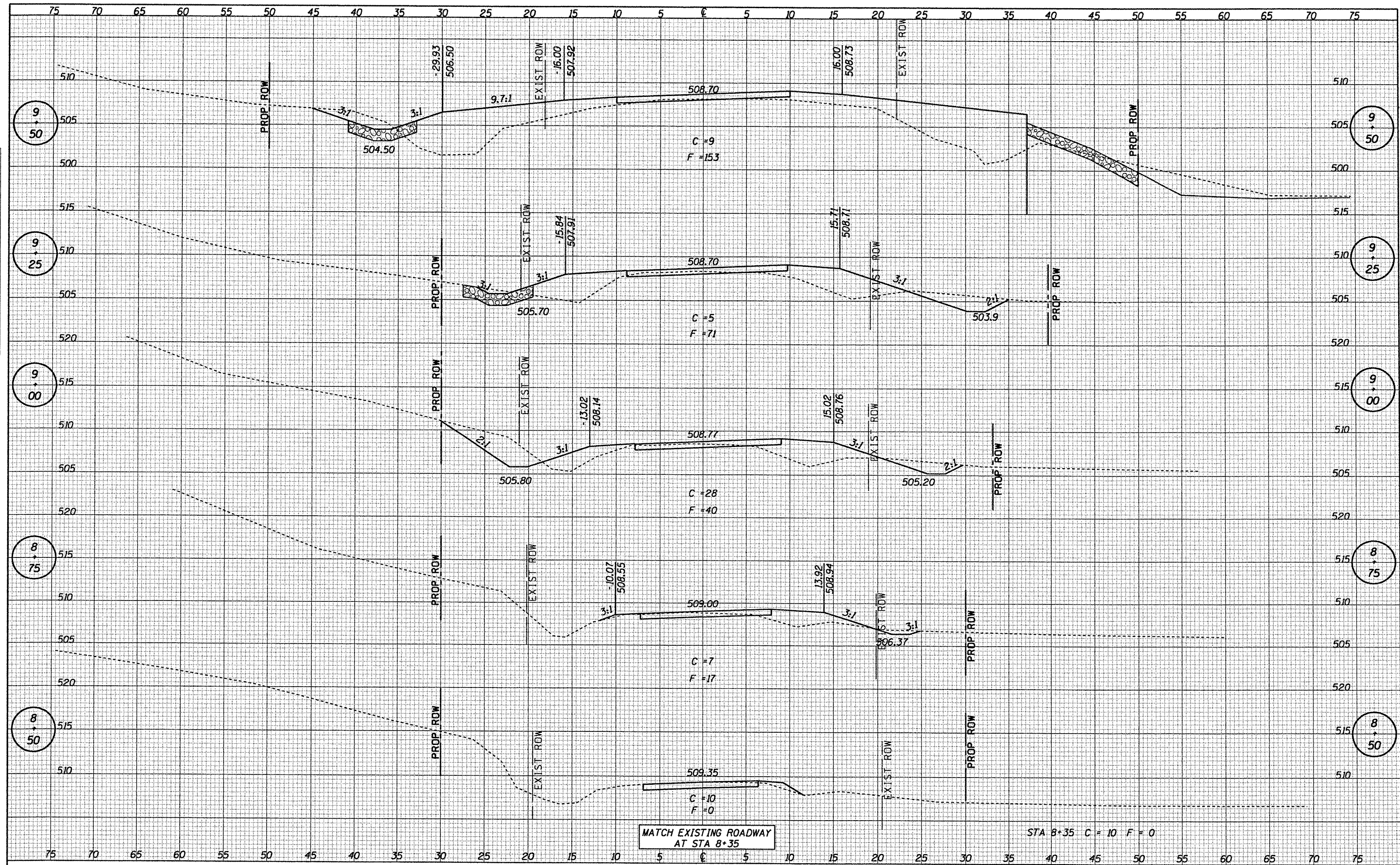

CEC Cummins Engineering Corporation
Civil and Structural Engineering

JOB = 2237
FILE NAME = 2237sec.dgn
PLOT SCALE = 10.00 Ft / IN.
PLOT DATE = 1/26/2011

DESIGNED -	NAK	REVISED -	
DRAWN -	AJH	REVISED -	
CHECKED -		REVISED -	
DATE -	1/26/2011	REVISED -	

**JERSEY COUNTY
TR 136 IMPROVEMENTS**

CROSS SECTIONS - TR 136

STA. TO STA.

TR	SECTION	COUNTY	TOTAL SHEETS	SHEET NO.
136	08-05117-00-BR	JERSEY	10	8
FED. ROAD DIST. NO.			ILLINOIS FED. AID PROJECT	
			CONTRACT NO. 97459	