

SEE SHEET NO. 65  
MATCH LINE STA 33+50

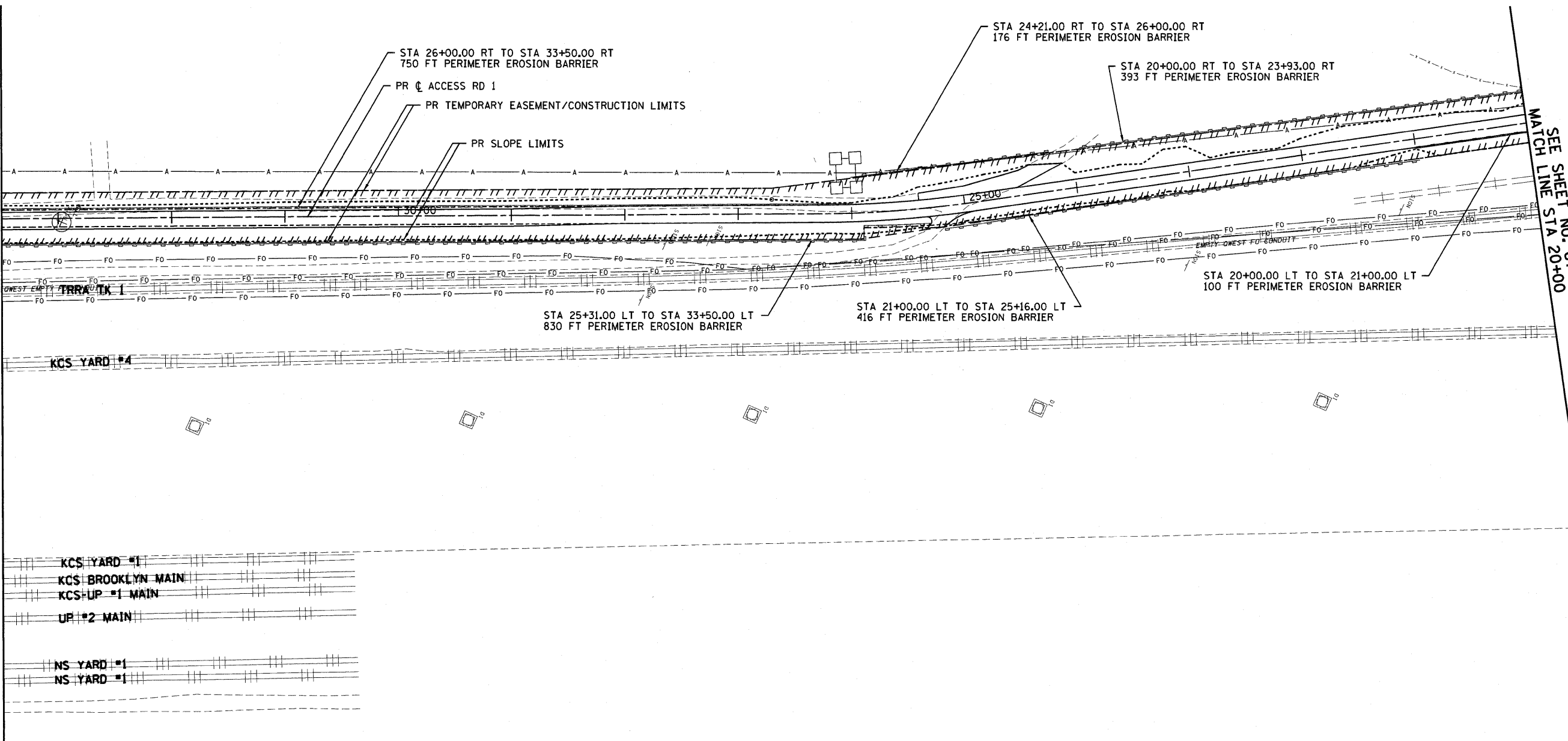

SEE SHEET NO. 67  
MATCH LINE STA 20+00

CONTRACT NO. 76D61	
F.A. ROUTE	SECTION
999	82-1B-2
FED. AID PROJECT ILLINOIS	
COUNTY	ST. CLAIR
USER NAME = John Keeven	
PLOT SCALE = 50.0000' / IN.	
PLOT DATE = 4/14/2010	
DESIGNED - HNTB	
CHECKED - CMT	
DRAWN - CMT / HNTB	
REVISED -	
REVISED -	
REVISED -	
REVISED -	

**EROSION AND SEDIMENT CONTROL PLANS**  
ILLINOIS APPROACH STRUCTURE FOR NEW I-70 MISSISSIPPI RIVER BRIDGE  
STA. 20 + 00 TO STA. 33 + 50

STATE OF ILLINOIS  
DEPARTMENT OF TRANSPORTATION  
MISSOURI HIGHWAYS AND TRANSPORTATION COMMISSION

**HNTB**  
715 KIRK DRIVE  
KANSAS CITY, MO 64105  
TELEPHONE (816) 472-1201  
CERTIFICATE OF AUTHORITY NO. 001270

**CMT**  
CRANFORD, MURPHY & TILLY, INC.  
2750 WEST WASHINGTON STREET  
SPRINGFIELD, IL 62702  
TELEPHONE (217) 787-8050  
ENGINEERING CORPORATION - 000631

SHEET 9 OF 10  
**ACCESS ROAD 1**  
**EROSION AND SEDIMENT CONTROL PLANS**

s:\Ito\090660\draw\_idot\CADD\_Sheets\D8066-sh1-eros.dgn