

F.A. ROUTE	SECTION
999	82-1B-2
FED. AID PROJECT	ILLINOIS
COUNTY	ST. CLAIR

USER NAME = Jjolliff
PLOT SCALE = #SCALE#
PLOT DATE = 4/14/2010
DESIGNED - HNTB
CHECKED - CMT
DRAWN - CMT / HNTB
REVISED -
REVISED -
REVISED -
REVISED -

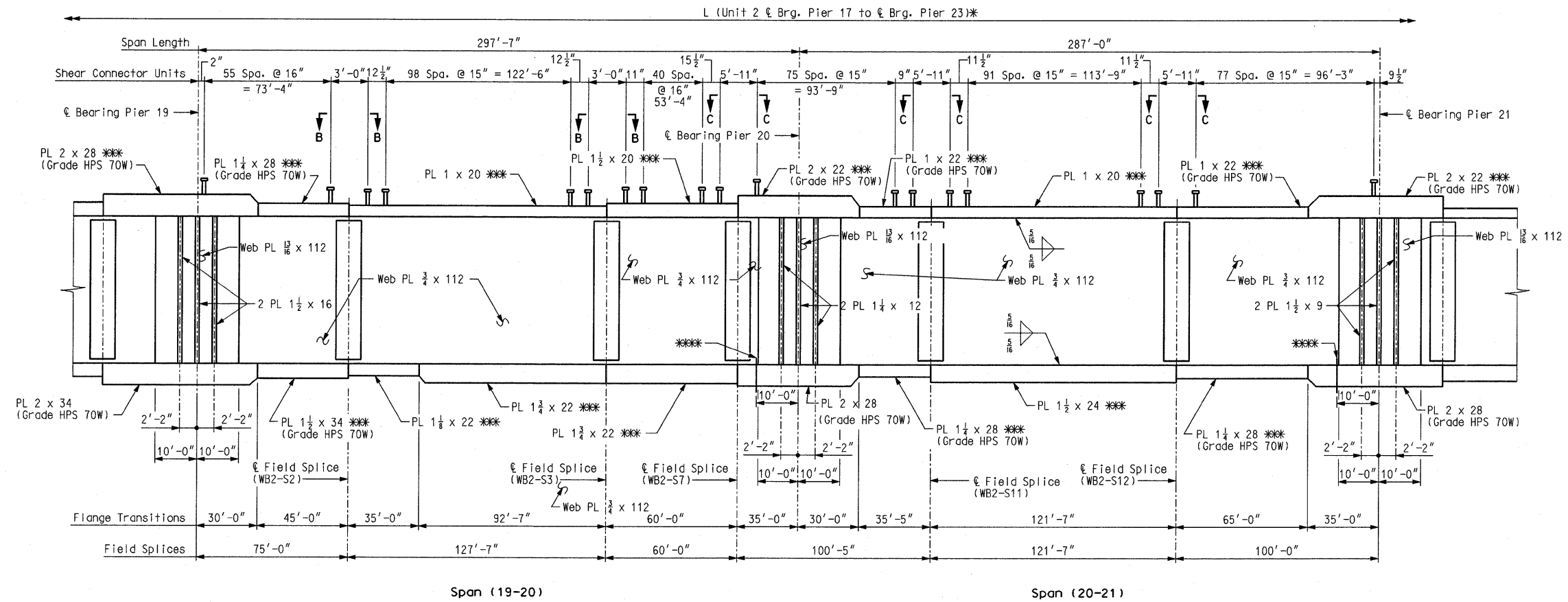

GIRDER ELEVATION
Spans (19-20) & (20-21)

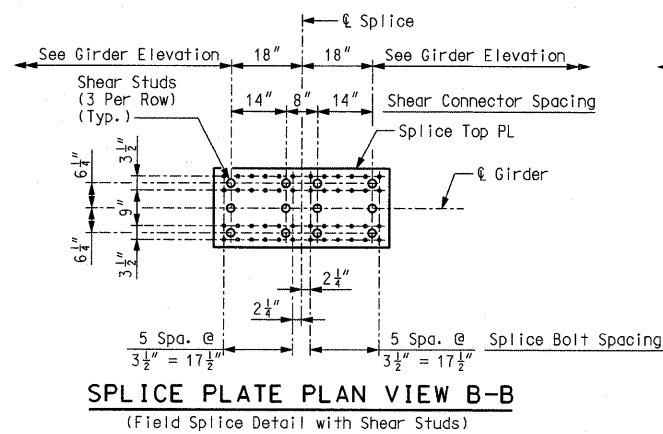

SPLICE PLATE PLAN VIEW B-B
(Field Splice Detail with Shear Studs)

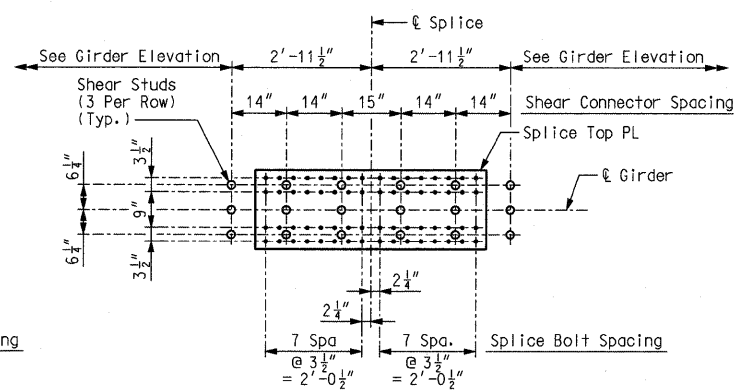

SPLICE PLATE PLAN VIEW C-C
(Field Splice Detail with Shear Studs)
(8 rows of Bolts Each Side of Splice Shown;
7 Row Configuration Similar)

Notes:
 * For table of girder dimensions, see Sheet No. 51.
 Plate girders shall be fabricated to be in accordance with the camber diagram shown on Sheet No. 71.
 *** Indicates flange plates subject to notch toughness requirements.
 All web plates shall be subject to notch toughness requirements.
 All flange and web splice plates except fill plates shall be subject to notch toughness requirements.
 Fabricated structural steel shall be ASTM A709 Grade 50W, except as noted.
 Longitudinal dimensions are horizontal from ℓ bearing to ℓ bearing.
 For Framing Plan, see Sheet No. 50.
 For location of slab drain attachment holes, see slab drain details on Sheet Nos. 127 thru 130.
 *** Drip plate, girder 1 only. See Sheet No. 88 for details.
 For details of shear connectors, see Sheet No. 88.

ILLINOIS APPROACH STRUCTURE
 FOR NEW I-70 MISSISSIPPI RIVER BRIDGE
 STATE OF ILLINOIS
 DEPARTMENT OF TRANSPORTATION
 MISSOURI HIGHWAYS
 AND TRANSPORTATION COMMISSION

HNTB
 715 KIRK DRIVE
 KANSAS CITY, MO 64105
 TELEPHONE (816) 472-1201
 CERTIFICATE OF AUTHORITY
 NO. 001270

CMT
 CRAWFORD, MURPHY & TILLY, INC.
 2750 WEST WASHINGTON STREET
 SPRINGFIELD, IL 62702
 TELEPHONE (217) 787-8050
 ENGINEERING CORPORATION - 000631