

CONTRACT NO.		TOTAL SHEETS	SHEET NO.
F.A.P. RTE.	SECTION	COUNTY	
307	541 RS-2	COOK	29
STA.		TO STA.	
FED. ROAD DIST. NO.		ILLINOIS FED. AID PROJECT	

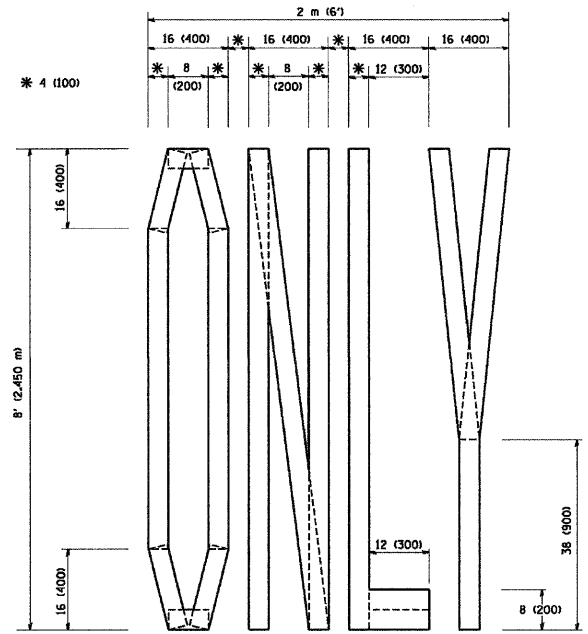

QUANTITY
4 (100) LINE = 64.1 ft. (19.7 m)
21.1 sq. ft. (1.97 sq. m)

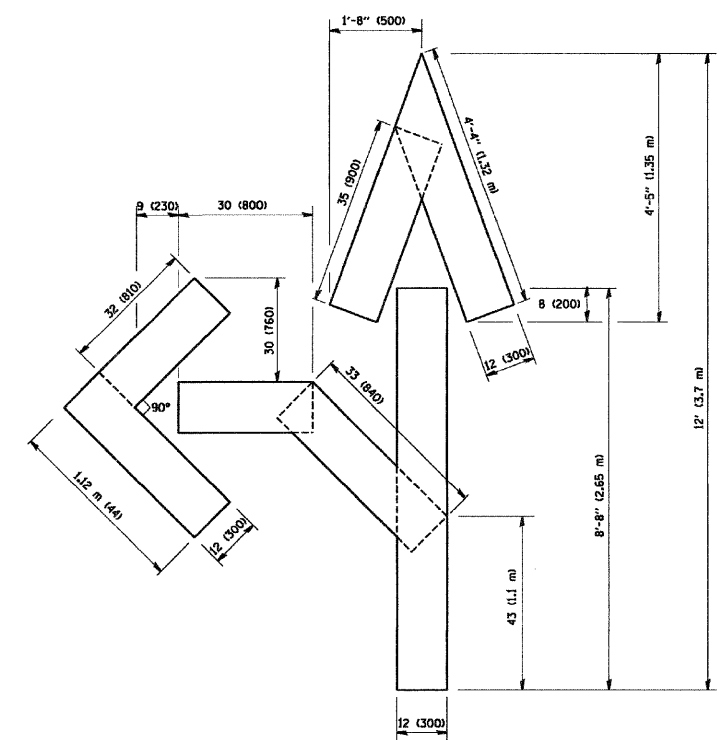

QUANTITY
4 (100) LINE = 82.5 ft. (25.3 m)
27.5 sq. ft. (2.53 sq. m)

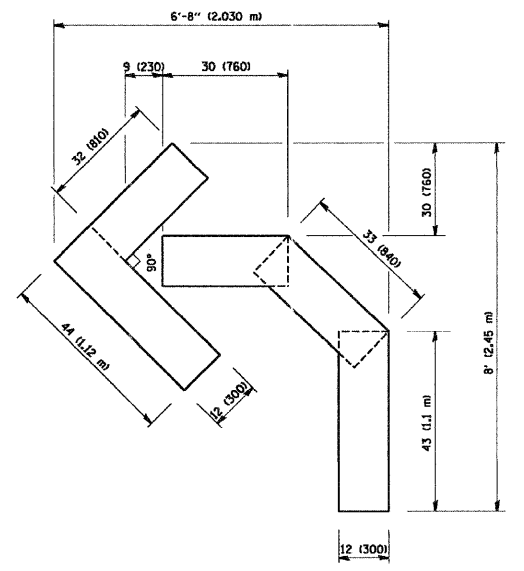

QUANTITY
4 (100) LINE = 45.5 ft. (13.9 m)
15.2 sq. ft. (1.39 sq. m)

All dimensions are in Inches (millimeters) unless otherwise shown.

REVISIONS	
NAME	DATE
T. RAMMACHER	09/18/94
J. OBERLE	06/01/96
T. RAMMACHER	06/05/96
T. RAMMACHER	11/04/97
T. RAMMACHER	03/02/98
E. COMEZ	08/28/00

ILLINOIS DEPARTMENT OF TRANSPORTATION
PAVEMENT MARKING LETTERS AND SYMBOLS FOR TRAFFIC STAGING
SCALE: NONE
DRAWN BY CADD
CHECKED BY TC-16

PLOT DATE = 4/17/2009
FILE NAME = ...In53309_Dist1_Det10.dgn
PLOT SCALE = 3/8" = 1' IN.
USER NAME = gthesse

FILE NAME = ...In53309_Dist1_Det10.dgn	USER NAME = gthesse	DESIGNED - AJP	REVISED -	STATE OF ILLINOIS DEPARTMENT OF TRANSPORTATION	PAVEMENT MARKING LETTERS AND SYMBOLS FOR TRAFFIC STAGING	F.A.P. RTE.	SECTION	COUNTY	TOTAL SHEETS	SHEET NO.
PLOT SCALE = N.T.S.	CHECKED - JNR	REVISED -	307			541 RS-2	COOK	29	26	
PLOT DATE = 4/17/2009	DATE - 4/16/2009	REVISED -	CONTRACT NO. 60G77							
			SCALE:			SHEET NO.	OF SHEETS	STA.	TO STA.	FED. ROAD DIST. NO. ILLINOIS FED. AID PROJECT