

SN: 001-2015 (EX)  
 DBL 10'x7.5' RCBC  
 OVER WALNUT FORK CREEK  
 @ STA. 138+31.00

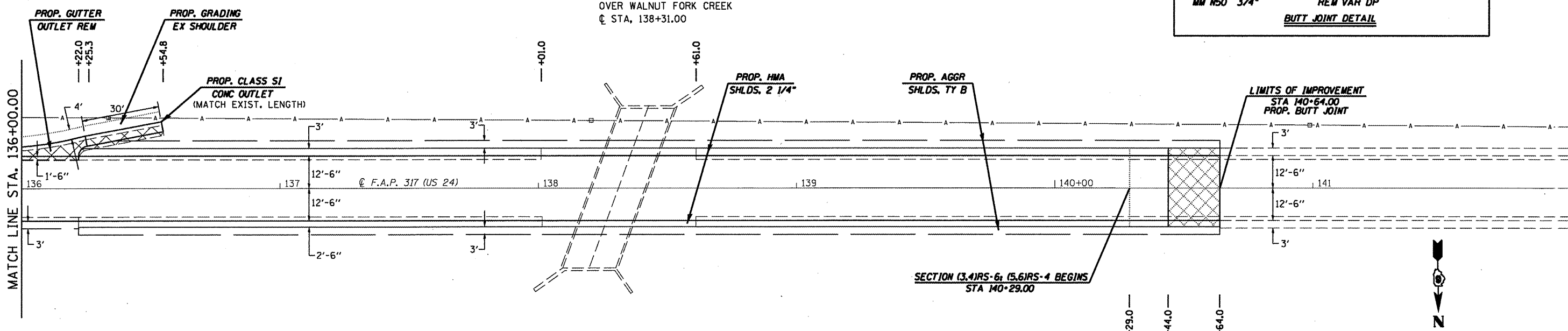

SECTION (3,4)RS-6; (5,6)RS-4 BEGINS  
 STA 140+29.00

FILE NAME =	USER NAME = cabrerers	DESIGNED - RSC	REVISED -	<b>STATE OF ILLINOIS DEPARTMENT OF TRANSPORTATION</b>	<b>PLAN SHEETS</b>			F.A.P. RTE. 317	SECTION (3,4)RS-6; (5,6)RS-4	COUNTY Adams	TOTAL SHEETS 30	SHEET NO. 27
ct:\pw\work\p1\dot\cabrerers\dms20567\sh	pl\en301.dgn	DRAWN - JWC	REVISED -		SCALE: 20	SHEET NO. 14 OF 14 SHEETS	STA. 130+50.00 TO STA. 142+00.00	CONTRACT NO. 72845				
	PLOT SCALE = 40,0000' / IN.	CHECKED - RSC	REVISED -		ILLINOIS FED. AID PROJECT							
	PLOT DATE = Apr-09-2009 12:53:19PM	DATE -	REVISED -									