

PROP. CURVE PRIL59-6
 PI STA. = 4003+93.75
 $\Delta = 1^\circ 46' 45''$ (LT)
 $D = 0^\circ 48' 45''$
 $R = 7,051.03'$
 $T = 109.48'$
 $L = 218.95'$
 $E = 0.85'$
 SE = NORMAL CROWN
 P.C. STA. = 4002+84.26
 P.T. STA. = 4005+03.21

ALIGNMENT DATA

116	N 865678.80	E 19141.98
117	N 865897.68	E 19146.76
118	N 868005.42	E 19159.97

STA. 4014+08.04 ILLINOIS ROUTE 59 =
 STA. 500+00.00 BRUCE LANE - BROOKDALE RD. =
 STA. 100+00.00 (PLAT OF HIGHWAYS)

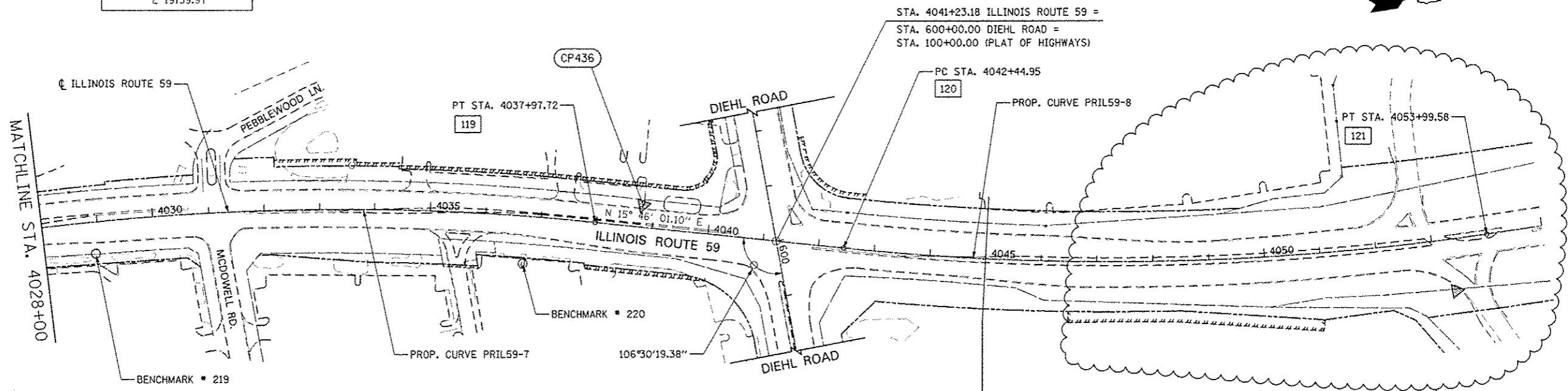

ALIGNMENT DATA

119	N 869176.88	E 19325.93
120	N 869607.28	E 19447.45
121	N 870746.07	E 19618.70

PROP. CURVE PRIL59-7
 PI STA. = 4032+07.95
 $\Delta = 15^\circ 24' 28''$ (RT)
 $D = 1^\circ 17' 54''$
 $R = 4,413.03'$
 $T = 596.97'$
 $L = 1,186.73'$
 $E = 40.19'$
 SE = NORMAL CROWN
 P.C. STA. = 4026+10.99
 P.T. STA. = 4037+97.72

PROP. CURVE PRIL59-8
 PI STA. = 4048+25.34
 $\Delta = 14^\circ 25' 49''$ (LT)
 $D = 1^\circ 14' 59''$
 $R = 4,584.55'$
 $T = 580.39'$
 $L = 1,154.64'$
 $E = 36.59'$
 SE = NORMAL CROWN
 P.C. STA. = 4042+44.95
 P.T. STA. = 4053+99.58

CONTRACT LIMITS
 STA 4045+00



DESIGNED <i>PJO</i>	REVISED - ADDENDUM A 02/22/2013	STATE OF ILLINOIS DEPARTMENT OF TRANSPORTATION	ALIGNMENT, BENCHMARKS, AND TIES		F.A.P. RTE.	SECTION	COUNTY	TOTAL SHEETS	SHEET NO.	
DRAWN <i>RES</i>	REVISED -		SCALE: AS SHOWN	SHEET NO. 2 OF 7 SHEETS	STA. 3974+00 TO STA. 4055+00	338	(112 & 113) WRS-6	DUPAGE	734	64
CHECKED <i>JCM</i>	REVISED -					CONTRACT NO. 60R31				
DATE <i>12/14/2012</i>	REVISED -					ILLINOIS FED. AID PROJECT				