

CONTROL POINT 424
 STA. 4016+51.90 24.20' RT
 CROSS (+) CUT 2' EAST OF EAST BACK OF CURB ON ROUTE 59, AT CENTER OF ENTRANCE TO BP GAS STATION.
 N 867046.2021
 E 19178.1610
 ELEV. = 712.03

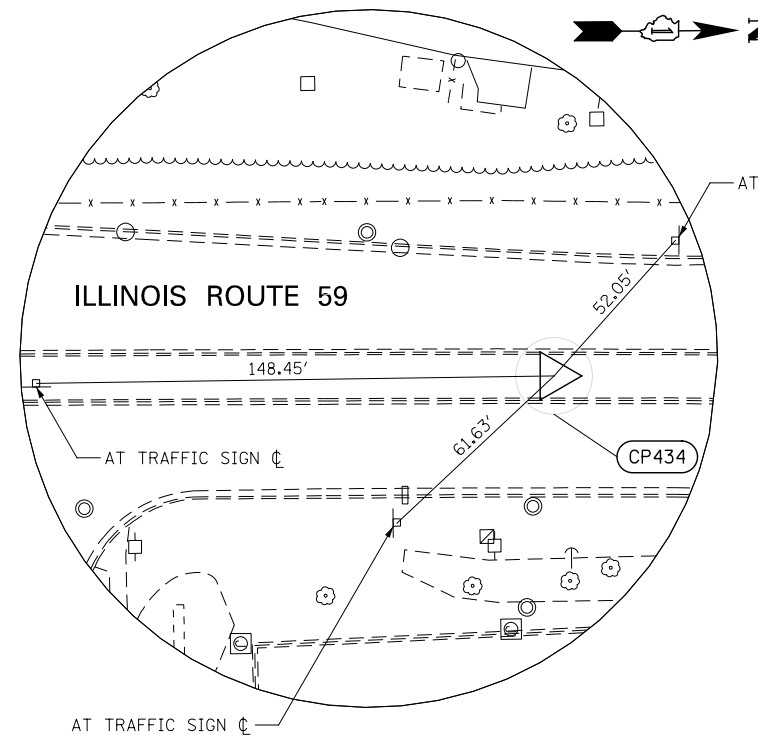

CONTROL POINT 434
 STA. 4025+14.88 13.01' LT
 BRASS DISC AT C OF ISLAND ON ROUTE 59, 150' NORTH OF C OF LASALLE AVE.
 N 867909.4021
 E 19146.3610
 ELEV. = 710.69

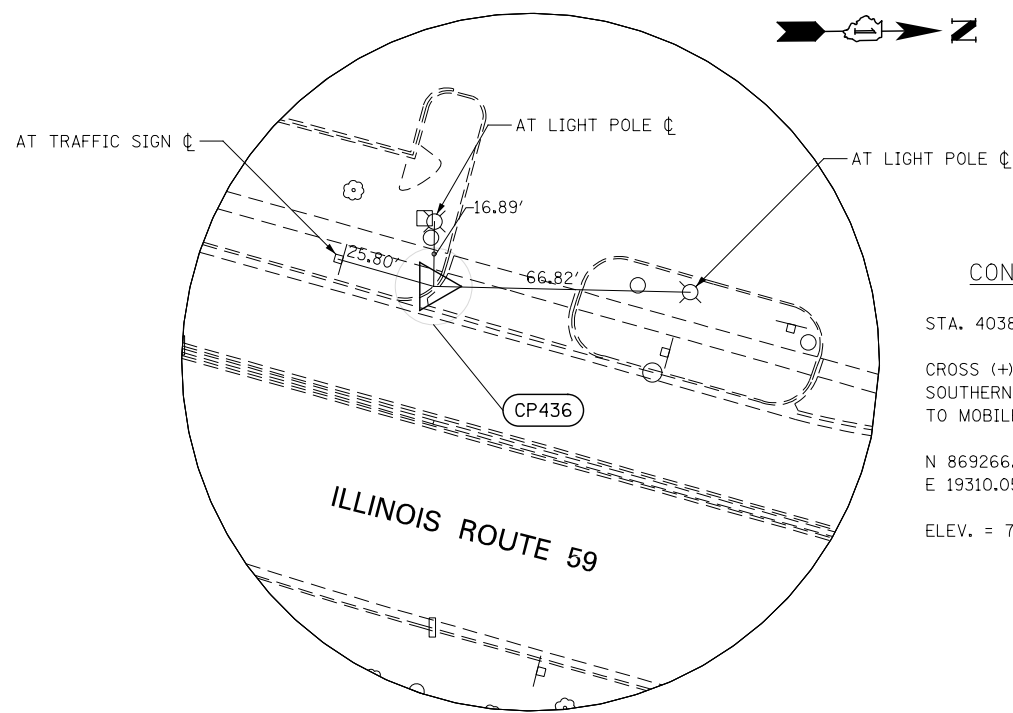

CONTROL POINT 436
 STA. 4038+79.94 39.71' LT
 CROSS (+) CUT ON TOP OF CURB AT MID-CURVE, SOUTHERN CURB RETURN AT ENTRANCE/EXIT TO MOBILE GAS STATION.
 N 869266.8021
 E 19310.0510
 ELEV. = 709.44

DESIGNED	PJO	REVISED	-
DRAWN	KES	REVISED	-
CHECKED	JCM	REVISED	-
DATE	12/14/2012	REVISED	-

**STATE OF ILLINOIS
 DEPARTMENT OF TRANSPORTATION**

ALIGNMENT, TIES, AND BENCHMARKS

SCALE: AS SHOWN SHEET NO. 6 OF 7 SHEETS STA. TO STA.

F.A.P. RTE.	SECTION	COUNTY	TOTAL SHEETS	SHEET NO.
338	(112 & 113) WRS-6	DUPAGE	734	68
				CONTRACT NO. 60R31
ILLINOIS FED. AID PROJECT				