

LEGEND:

-  PORTLAND CEMENT CONCRETE DRIVEWAY PAVEMENT, 8 INCH
SUBBASE GRANULAR MATERIAL, TYPE B 4"
-  HOT-MIX ASPHALT DRIVEWAY PAVEMENT, 10" (SEE NOTE 1)
SUBBASE GRANULAR MATERIAL, TYPE B 4"

NOTES:

1. FOR HOT-MIX ASPHALT DRIVEWAY PAVEMENT MIX INFORMATION,
SEE TABLE FOR HOT-MIX ASPHALT MIXTURE REQUIREMENT.

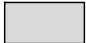
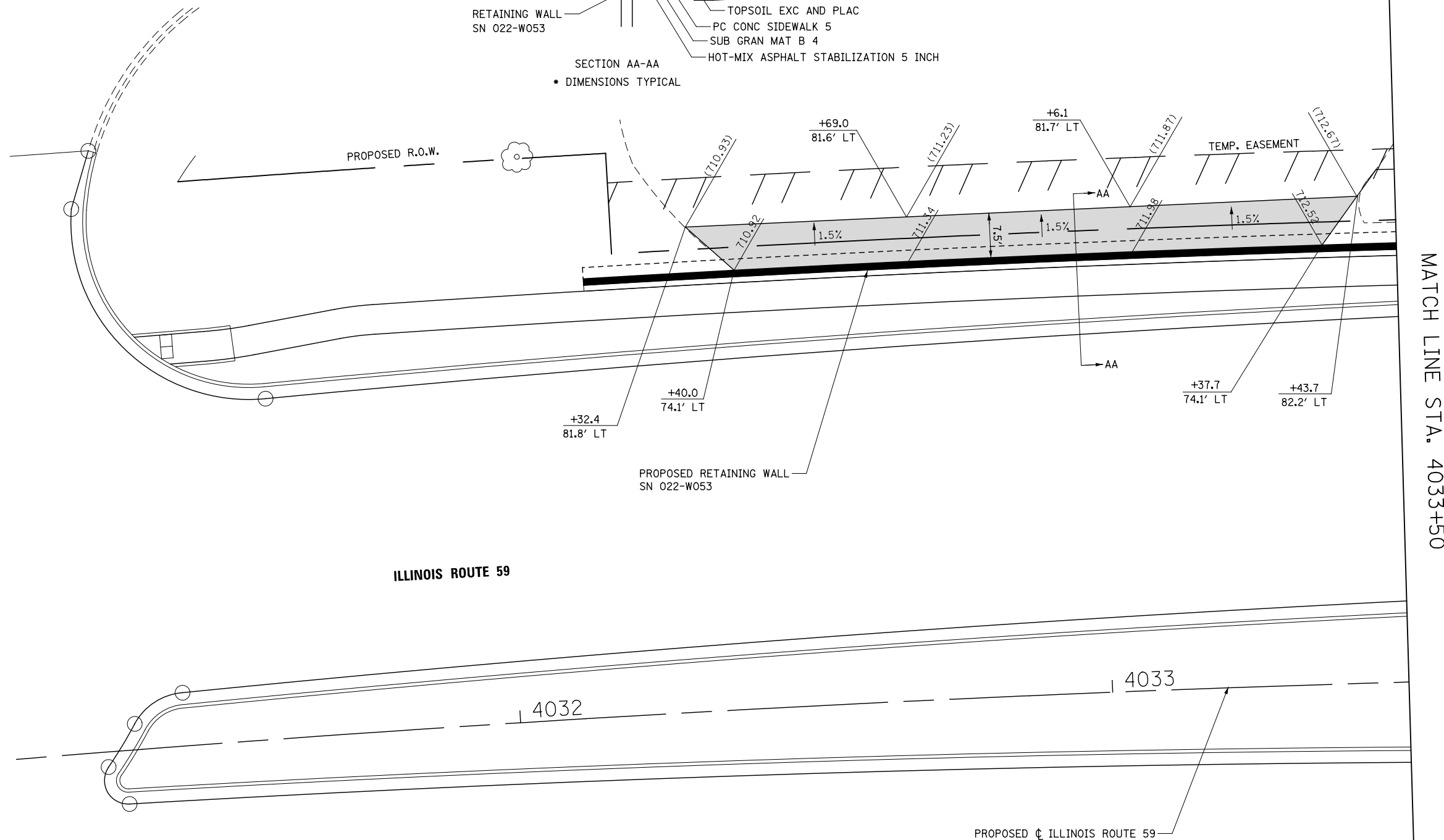
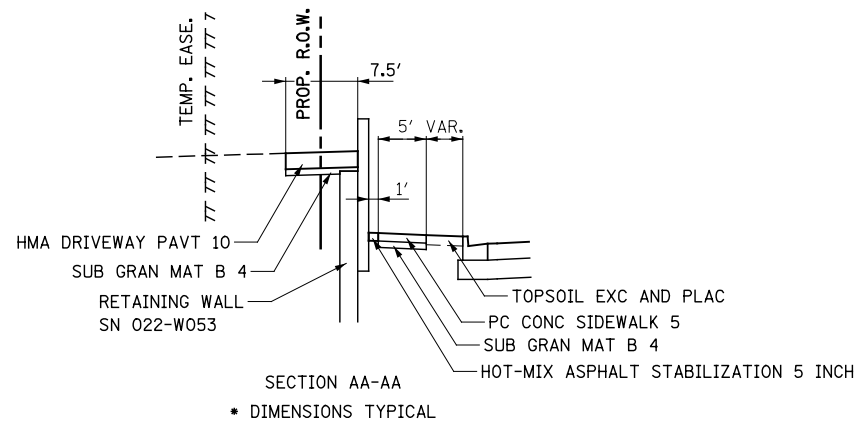

MATCH LINE STA. 4033+50

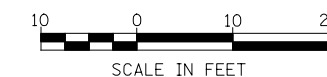

	DESIGNED <i>PJO</i>	REVISED -	STATE OF ILLINOIS DEPARTMENT OF TRANSPORTATION	DRIVEWAY DETAILS ILLINOIS ROUTE 59 - STA. 4034 + 67, 4037 + 38 AND 4039 + 00	F.A.P. RTE.	SECTION	COUNTY	TOTAL SHEETS	SHEET NO.	
	DRAWN <i>KES</i>	REVISED -			338	(112 & 113) WRS-6	DUPAGE	734	256	
	CHECKED <i>JCM</i>	REVISED -			CONTRACT NO. 60R31					
	DATE <i>12/14/2012</i>	REVISED -			ILLINOIS FED. AID PROJECT					
			SCALE: AS SHOWN		SHEET NO. 5 OF 16 SHEETS		STA. TO STA.			