

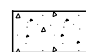

LEGEND:

-  PORTLAND CEMENT CONCRETE DRIVEWAY PAVEMENT, 8 INCH SUBBASE GRANULAR MATERIAL, TYPE B 4"
-  HOT-MIX ASPHALT DRIVEWAY PAVEMENT, 10" (SEE NOTE 1) SUBBASE GRANULAR MATERIAL, TYPE B 4"

XXX.XX EOP EDGE OF PAVEMENT ELEVATION

XXX.XX T/C TOP OF CURB ELEVATION

XXX.XX B/SW BACK OF SIDEWALK ELEVATION

XXX.XX T/RW TOP OF RETAINING WALL ELEVATION

NOTES:

1. FOR HOT-MIX ASPHALT DRIVEWAY PAVEMENT MIX INFORMATION, SEE TABLE FOR HOT-MIX ASPHALT MIXTURE REQUIREMENT.
2. COMBINATION CONCRETE CURB AND GUTTER TRANSITION, FROM TYPE B-6.24 TO TYPE B-6.12 SHALL BE PAID FOR AS "COMBINATION CONCRETE CURB AND GUTTER, TYPE B-6.24", AND NO ADDITIONAL COMPENSATION WILL BE MADE.
3. THIS COMBINATION CONCRETE CURB AND GUTTER HAS A VARYING HEIGHT FROM 6" TO A MAXIMUM OF 2'. CURB AND GUTTER WILL BE PAID FOR AS "COMBINATION CONCRETE CURB AND GUTTER, TYPE B-6.12 (VARIABLE CURB HEIGHT)" AND NO ADDITIONAL COMPENSATION WILL BE MADE.

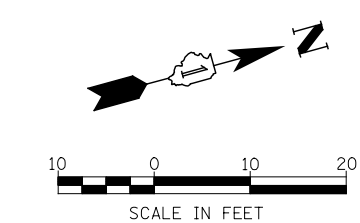
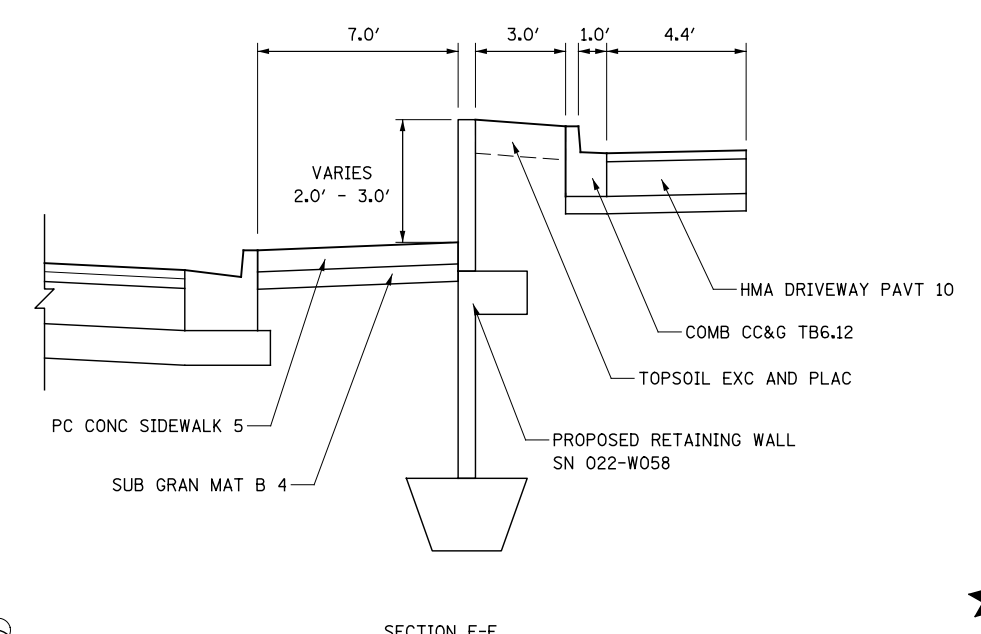
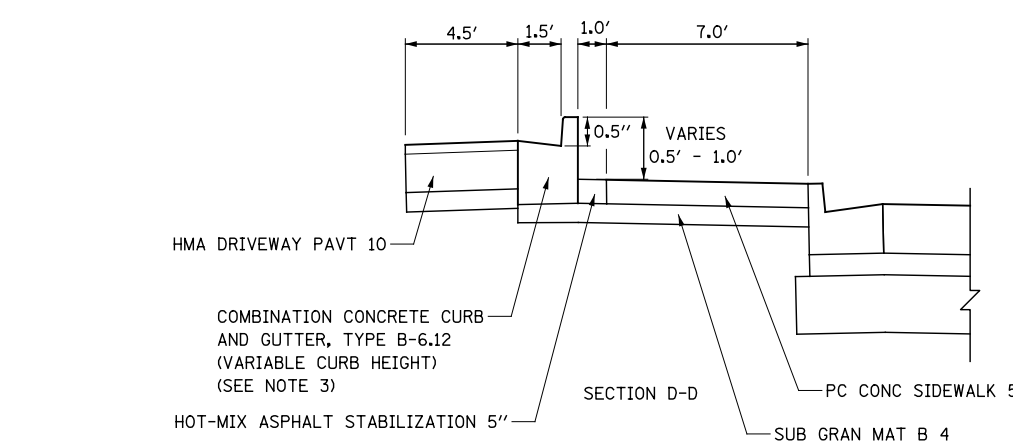
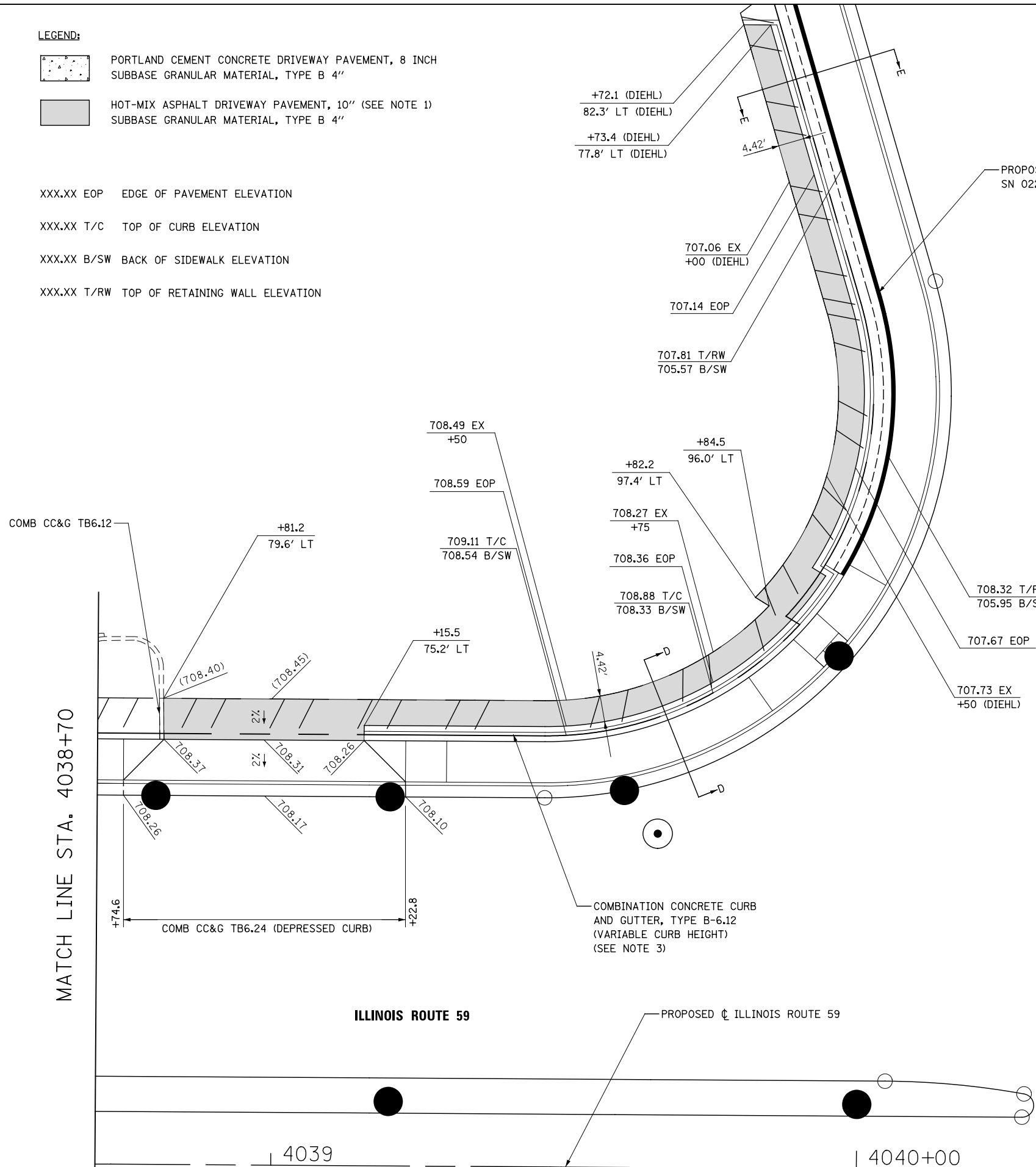

MATCH LINE STA. 4038+70

ILLINOIS ROUTE 59

4039

4040+00

DESIGNED	PJO	REVISED	-
DRAWN	KES	REVISED	-
CHECKED	JCM	REVISED	-
DATE	12/14/2012	REVISED	-

**STATE OF ILLINOIS
DEPARTMENT OF TRANSPORTATION**

**DRIVEWAY DETAILS
ILLINOIS ROUTE 59 STA. 4034 + 67, 4037 + 38 AND 4039 + 00**

SCALE: AS SHOWN SHEET NO. 8 OF 16 SHEETS STA. TO STA.

F.A.P. RTE.	SECTION	COUNTY	TOTAL SHEETS	SHEET NO.
338	(112 & 113) WRS-6	DUPAGE	734	259
CONTRACT NO. 60R31				
ILLINOIS FED. AID PROJECT				