

PLAN	DATE
DESIGNED	12/14/2012
DRAWN	KE'S
CHECKED	IRS
DATE	12/14/2012

PROFILE	DATE
DESIGNED	12/14/2012
DRAWN	KE'S
CHECKED	IRS
DATE	12/14/2012

MATCH LINE STA. 3996+50
SEE DRAWING DP-01A

MATCH LINE STA. 4010+00
SEE DRAWING DP-03

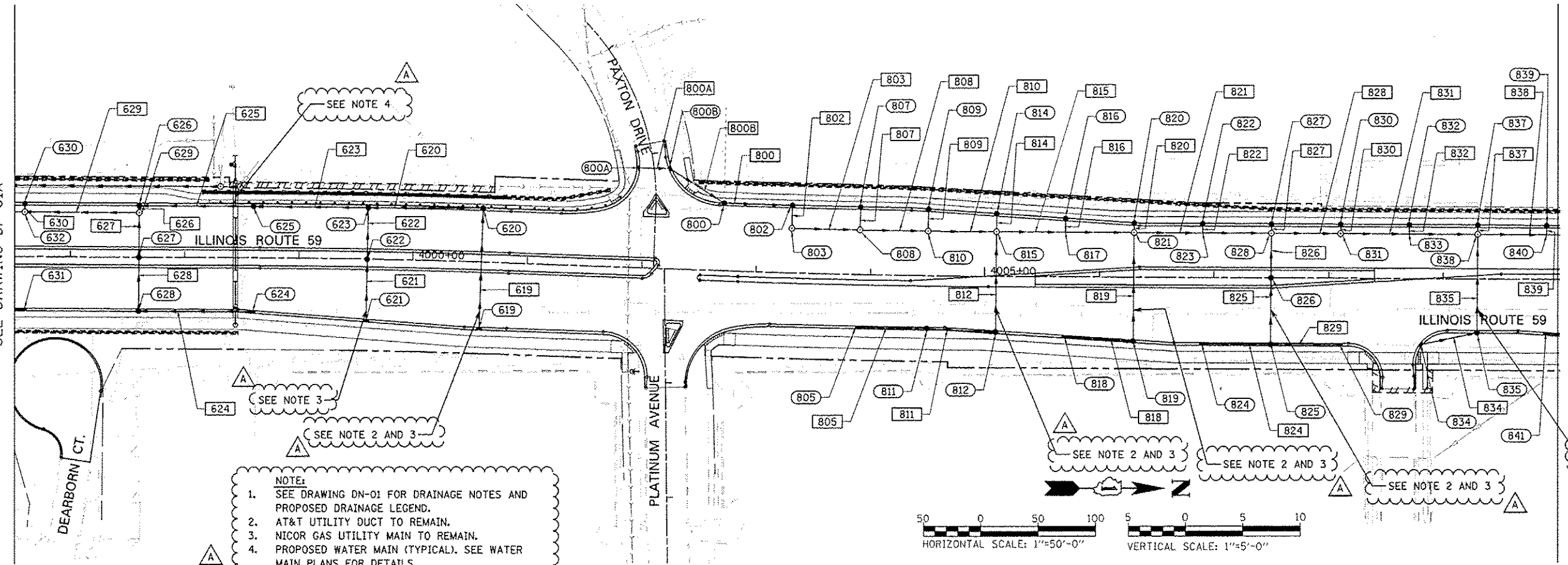

NOTE:
 1. SEE DRAWING DN-01 FOR DRAINAGE NOTES AND PROPOSED DRAINAGE LEGEND.
 2. AT&T UTILITY DUCT TO REMAIN.
 3. NICOR GAS UTILITY MAIN TO REMAIN.
 4. PROPOSED WATER MAIN (TYPICAL). SEE WATER MAIN PLANS FOR DETAILS.

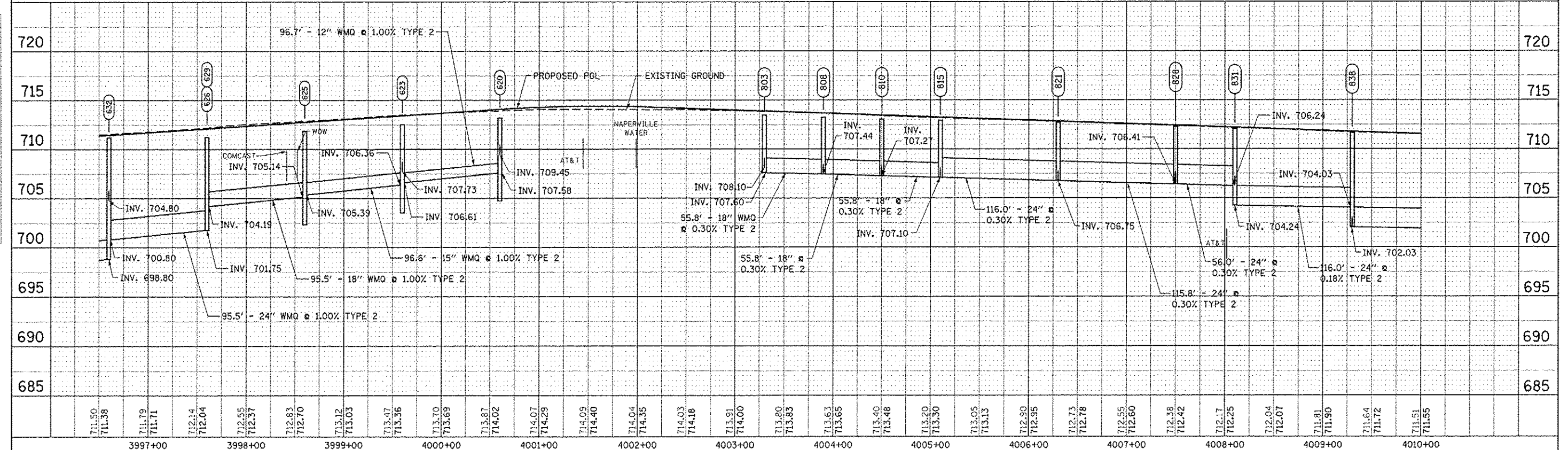

711.50 711.38	711.79 711.71	712.14 712.04	712.55 712.37	712.83 712.70	713.12 713.03	713.47 713.36	713.70 713.69	713.87 714.02	714.07 714.29	714.09 714.40	714.04 714.35	714.03 714.18	713.91 714.00	713.80 713.83	713.63 713.65	713.40 713.48	713.20 713.30	713.05 713.13	712.90 712.95	712.73 712.78	712.55 712.60	712.38 712.42	712.17 712.25	712.04 712.07	711.81 711.90	711.64 711.72	711.51 711.55		
3997+00		3998+00		3999+00		4000+00		4001+00		4002+00		4003+00		4004+00		4005+00		4006+00		4007+00		4008+00		4009+00		4010+00			
DESIGNED <i>JWM</i>		REVISOR -ADDENDUM A 02/22/2013		DRAWN <i>KE'S</i>		REVISOR -		CHECKED <i>IRS</i>		REVISOR -		DATE <i>12/14/2012</i>		REVISOR -		STATE OF ILLINOIS DEPARTMENT OF TRANSPORTATION PROPOSED DRAINAGE PLAN & PROFILE - ILLINOIS ROUTE 59 SCALE: 1"=50' SHEET NO. 3 OF 11 SHEETS STA. 3996+50 TO STA. 4010+00										F.A.P. RTE.	SECTION	COUNTY	TOTAL SHEET NO.
338	(112 & 113) WRS-7	DUPAGE	734	300																									
DP-02A	CONTRACT NO. 60R31	FED. ROAD DIST. NO.	ILLINOIS FED. AID PROJECT																										