

**WATER MAIN PIPE**

- WM2-1 2' D I WATER MAIN 12 TRENCH BACKFILL 2.7 CU YD
- WM2-2 3' D I WATER MAIN 12 TRENCH BACKFILL 3.9 CU YD
- WM2-3 9' D I WATER MAIN 12 TRENCH BACKFILL 11.6 CU YD
- WM2-4 (13') D I WATER MAIN 12 TRENCH BACKFILL (11.8) CU YD
- WM2-5 (29') D I WATER MAIN 12 TRENCH BACKFILL (16.2) CU YD
- WM2-6 18' D I WATER MAIN 12 TRENCH BACKFILL (9.8) CU YD
- WM2-7 116' D I WATER MAIN 12 TRENCH BACKFILL (70.8) CU YD

**WATER MAIN FITTINGS**

- WM2-8 17' D I WATER MAIN 6 TRENCH BACKFILL 20.4 CU YD
- WM2-9 (24') D I WATER MAIN 8 TRENCH BACKFILL (12.2) CU YD
- WM2-10 (16') D I WATER MAIN 8 TRENCH BACKFILL (4.3) CU YD
- WM2-11 NOT USED
- WM 2-12 45' DI WATER MAIN 8 TRENCH BACKFILL (21.0) CU YD

**WATER MAIN VALVES**

- V2-1 WATER VALVES 12 VV TA 4 DIA TIF CL 4017+38.0 49.7 RT, R 712.3, C 701.6 WITH 2 INCH COPPER WHIP (INCLUDED WITH COST OF VV)

**FIRE HYDRANTS**

- FH-055 SEE REMOVAL PLANS.
- FH2-2 FIRE HYD W/AUX V & VB 4017+81.6 53.2 RT, N 714.4, R 712.4, C 707.4

**CUT & CAP WATER MAIN**

- CC2-1 CUT & CAP EX 10 WM 4017+39.0 54.2 RT, R 712.5, C 701.6
- CC2-2 CUT & CAP EX 10 WM 4017+53.5 54.2 RT, R 712.4, C 701.6
- CC2-3 CUT & CAP EX 10 WM 4017+63.5 54.3 RT, R 712.5, C 701.6
- CC2-4 CUT & CAP EX 10 WM 4017+96.7 49.6 RT, R 712.3, C 700.6
- CC2-5 CUT & CAP EX 10 WM 4018+06.5 49.5 RT, R 712.1, C 700.5

**NOTES**

- DRILL THROUGH EXISTING MANHOLES. COST IS INCIDENTAL TO WATER MAIN PAY ITEMS. EXISTING VALVE & VAULT TO REMAIN. SEE REMOVAL PLANS.
- EXISTING RETAINING WALL SN 022-W052, CONSTRUCTED IN CONTRACT 60P42.
- MAKE NON-PRESSURE CONNECTION AT FITTING. ALL WORK INCLUDED WITH COST OF FITTING.

PLAN  
DATE: 12/14/2012  
DRAWN: CMW  
CHECKED: JCM  
DATE: 12/14/2012

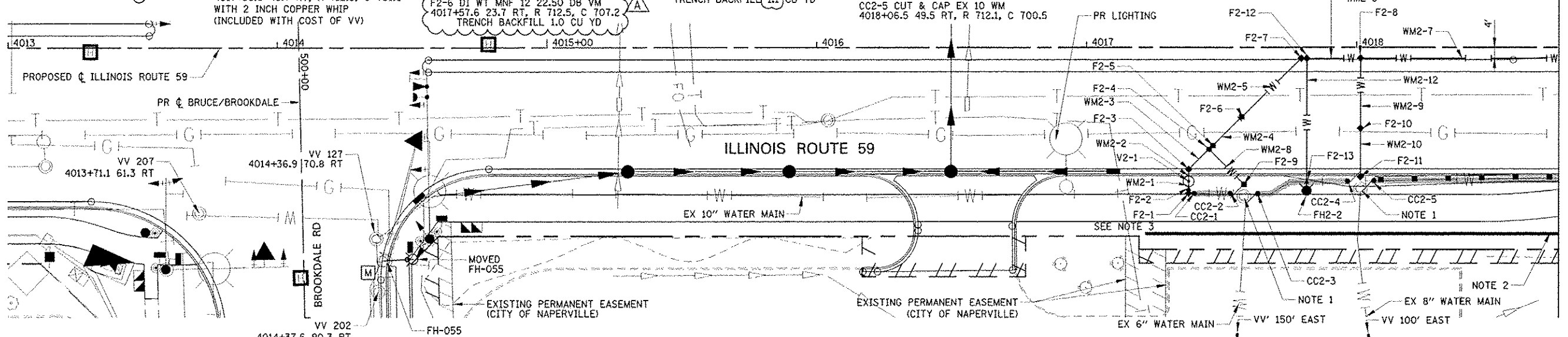

PROFILE  
DATE: 12/14/2012  
DRAWN: CMW  
CHECKED: JCM  
DATE: 12/14/2012

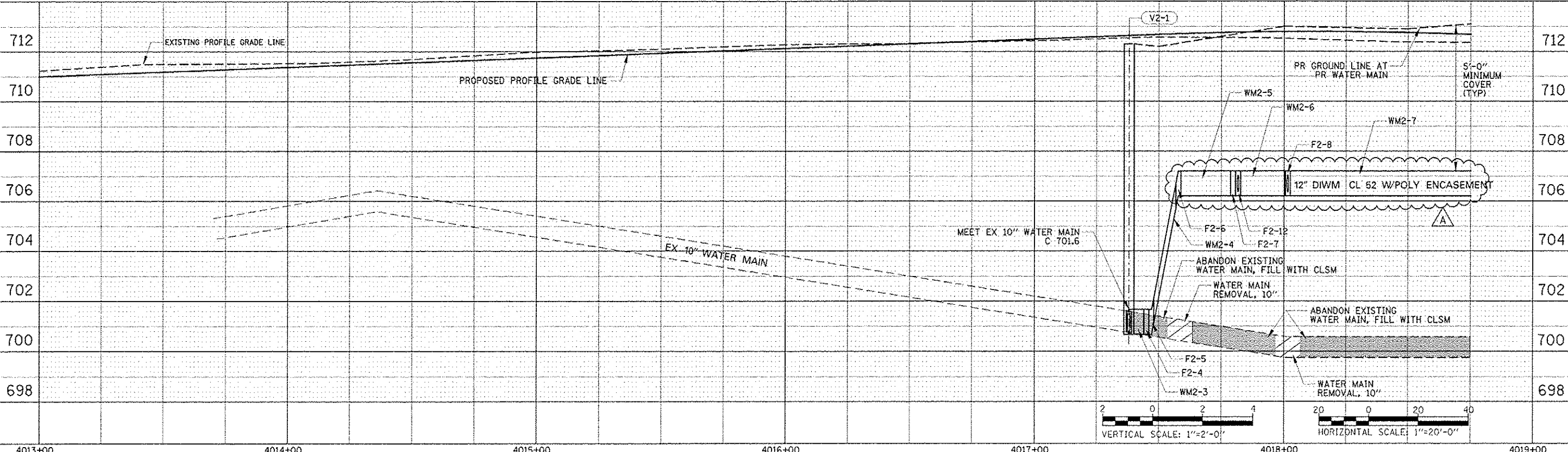

DESIGNED: <i>CEO</i>	REVISED - ADDENDUM A 02/22/2013	<b>STATE OF ILLINOIS</b> <b>DEPARTMENT OF TRANSPORTATION</b>	<b>WATER MAIN PLAN AND PROFILE</b>		F.A.P. RTE. 338	SECTION (112 & 113) WRS-6	COUNTY DUPAGE	TOTAL SHEETS 734	SHEET NO. 318
DRAWN: <i>CMW</i>	REVISED -				CONTRACT NO. 60R31 WAT PP-2 FED. ROAD DIST. NO. ILLINOIS FED. AID PROJECT				
CHECKED: <i>JCM</i>	REVISED -								
DATE: <i>12/14/2012</i>	REVISED -								