

EROSION CONTROL LEGEND

	TEMPORARY EROSION CONTROL SEEDING AND MULCH METHOD 2		TEMPORARY DITCH CHECK
	TEMPORARY EROSION CONTROL SEEDING AND TEMPORARY EROSION CONTROL BLANKET		TEMPORARY DITCH CHECK INSTALLED IN PREVIOUS STAGE
	PERMANENT SEEDING (SEE NOTE 3)		INLET & PIPE PROTECTION
	TEMPORARY EROSION CONTROL SEEDING OR PERMANENT SEEDING INSTALLED IN A PREVIOUS STAGE		INLET & PIPE PROTECTION INSTALLED IN PREVIOUS STAGE
	TEMPORARY PAVEMENT		FLOW DIRECTION (SEE NOTE 4)
	PERIMETER EROSION BARRIER (SEE NOTE 2)		PROPOSED STORM SEWER (SEE NOTE 1)
	PERIMETER EROSION BARRIER INSTALLED IN PREVIOUS STAGE		PROPOSED STORM SEWER INSTALLED IN PREVIOUS STAGE
	INLET FILTER		TEMPORARY PIPE CULVERT
	INLET FILTER INSTALLED IN PREVIOUS STAGE		PERMANENT DRAINAGE STRUCTURE NUMBER (SEE NOTE 1)

NOTES

1. SEE PROPOSED DRAINAGE PLANS FOR STORM SEWER INFORMATION.
2. PERIMETER EROSION BARRIER SHALL BE ERECTED ADJACENT TO R.O.W., EASEMENT, AND CONSTRUCTION LIMITS AND AS DIRECTED BY THE ENGINEER.
3. SEE LANDSCAPING PLANS FOR LANDSCAPING REQUIREMENTS.
4. SEE PRE-STAGE CROSS SECTIONS FOR GRADING INFORMATION.

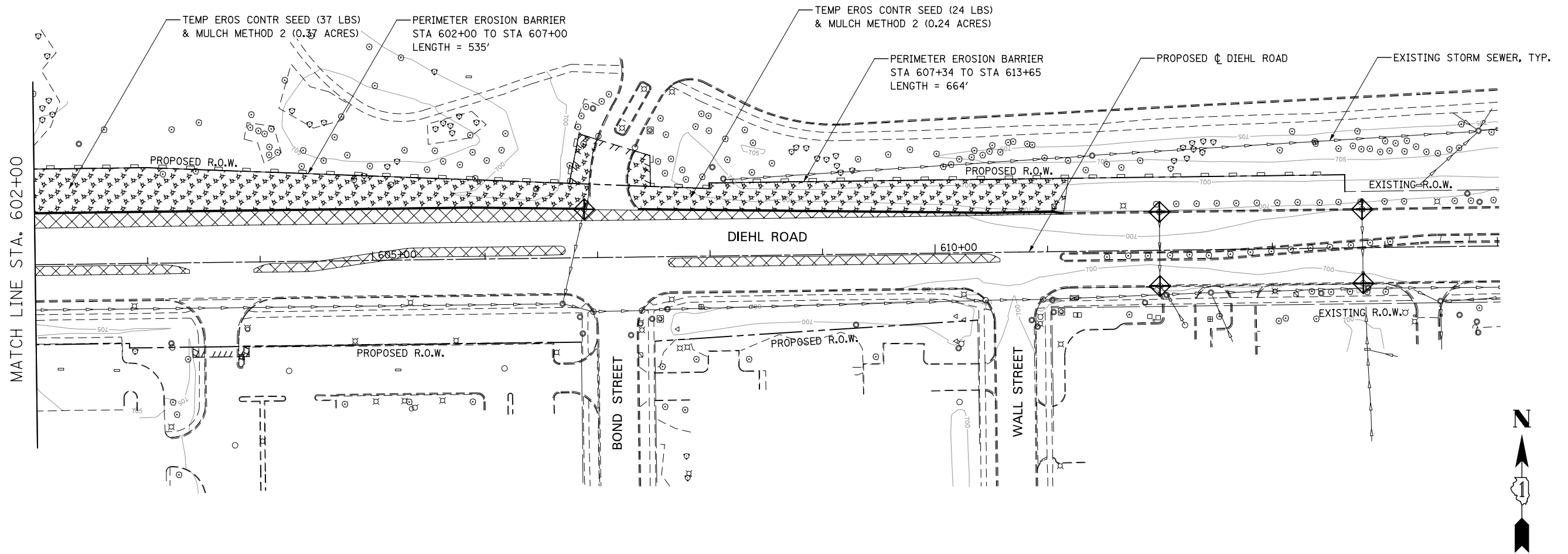

DESIGNED <i>PJO</i> DRAWN <i>KES</i> CHECKED <i>JCM</i> DATE <i>12/14/2012</i>	REVISED -	STATE OF ILLINOIS DEPARTMENT OF TRANSPORTATION	EROSION CONTROL - PRE STAGE 1, 1A AND 1B DIEHL ROAD		F.A.P. RTE.	SECTION	COUNTY	TOTAL SHEETS	SHEET NO.	
	REVISED -		SCALE: AS SHOWN	SHEET NO. 8 OF 40 SHEETS	STA. 602+00 TO STA. 615+00	338	(112 & 113) WRS-6	DUPAGE	734	433
	REVISED -		ILLINOIS FED. AID PROJECT							
	REVISED -		CONTRACT NO. 60R31							