

UNIT DUCT, 600V, 4-1C NO.6, 1/C NO.6 GROUND, (XLP-TYPE USE), 1 1/4" DIA. POLYETHYLENE SHALL BE RUN BACK TO CONTROLLER #018A FOR NORTH OF DIEHL RD LIGHTING. (APPROX. 550' EXTRA-RUN NOT SHOWN)

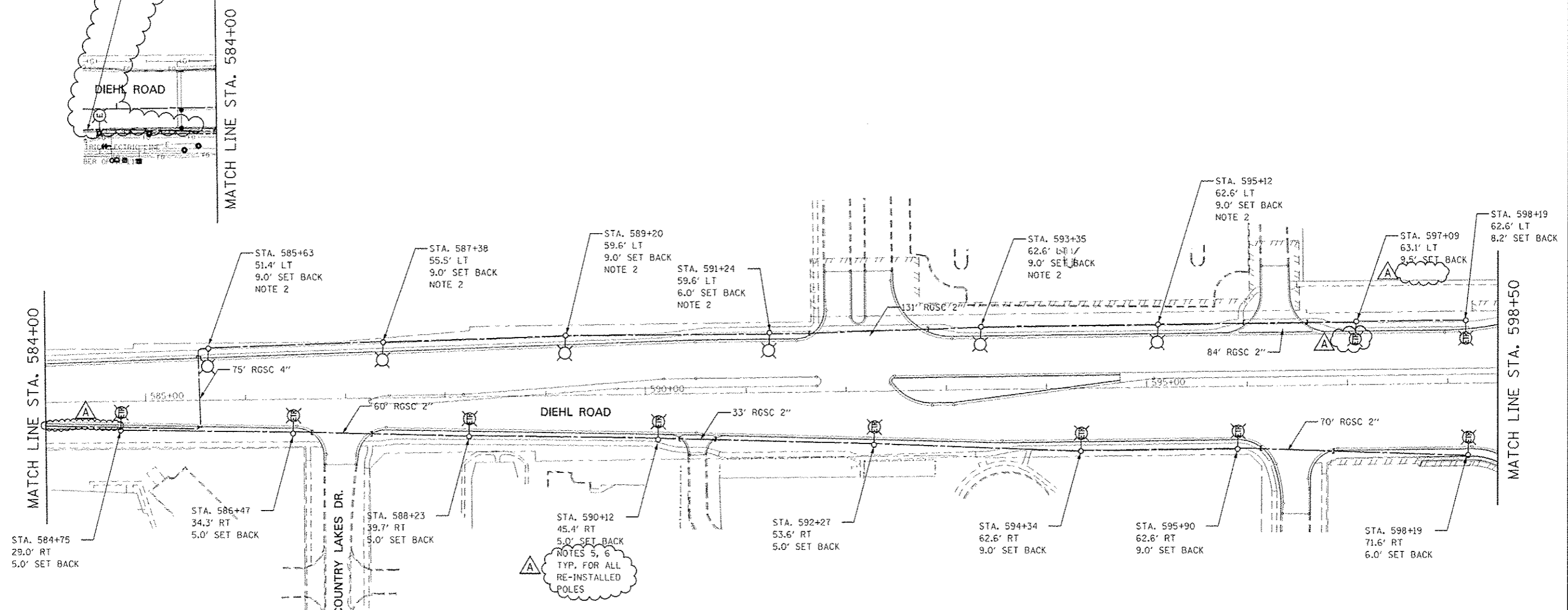

NOTES

1. FOR SYMBOL LIST AND ABBREVIATIONS, SEE SHEET LT-01.
2. LIGHT POLE WITH BREAKAWAY, MASTARM AND LUMINAIRE SHALL BE PROVIDED BY CITY OF NAPERVILLE (SALVAGED FROM CONTRACT 60R30).
3. ALL WIRING SHALL BE UNIT DUCT, 600V, 4-1C NO.6, 1/C NO.6 GROUND, (XLP-TYPE USE), 1 1/4" DIA. POLYETHYLENE.
4. POLE SET-BACK SHALL BE MEASURED FROM BACK OF THE CURB TO CENTER OF THE POLE/BASE.
5. POLES ON SOUTH SIDE OF DIEHL RD. SHALL BE WIRED TO EXISTING USED CIRCUITS IN CITY OF NAPERVILLE CONTROLLER #018A.
6. BOLT CIRCLE AND ANCHOR BOLTS NUMBER AND LAYOUT OF THE FOUNDATION SHALL MATCH THE RE-INSTALLED POLE.
7. POLES NORT SIDE OF DIEHL RD. SHALL BE WIRED TO 2 SPARE ALTERNATE (BLACK AND RED) CIRCUITS IN CITY OF NAPERVILLE CONTROLLER #018A.

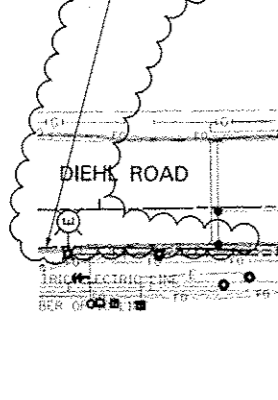
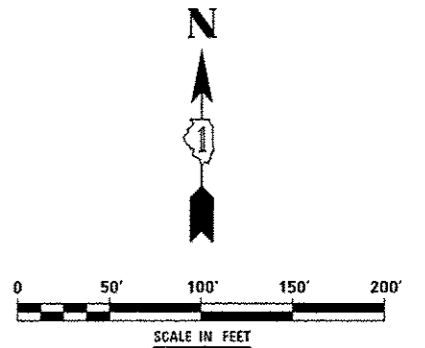

DESIGNED MCP	REVISED - ADDENDUM A 02/22/2013	STATE OF ILLINOIS DEPARTMENT OF TRANSPORTATION	LIGHTING PLANS - DIEHL ROAD		F.A.P. RTE. 336	SECTION (112 & 113) WRS-6	COUNTY DUPAGE	TOTAL SHEETS 734	SHEET NO. 483
DRAWN MLB	REVISED -		SCALE: AS SHOWN	SHEET NO. 7 OF 8 SHEETS	STA.	TO STA.	LT-12		CONTRACT NO. 60R31
CHECKED MCP	REVISED -		ILLINOIS FED. AID PROJECT						
DATE 09/01/2012	REVISED -								