

DEVELOPED ELEVATION

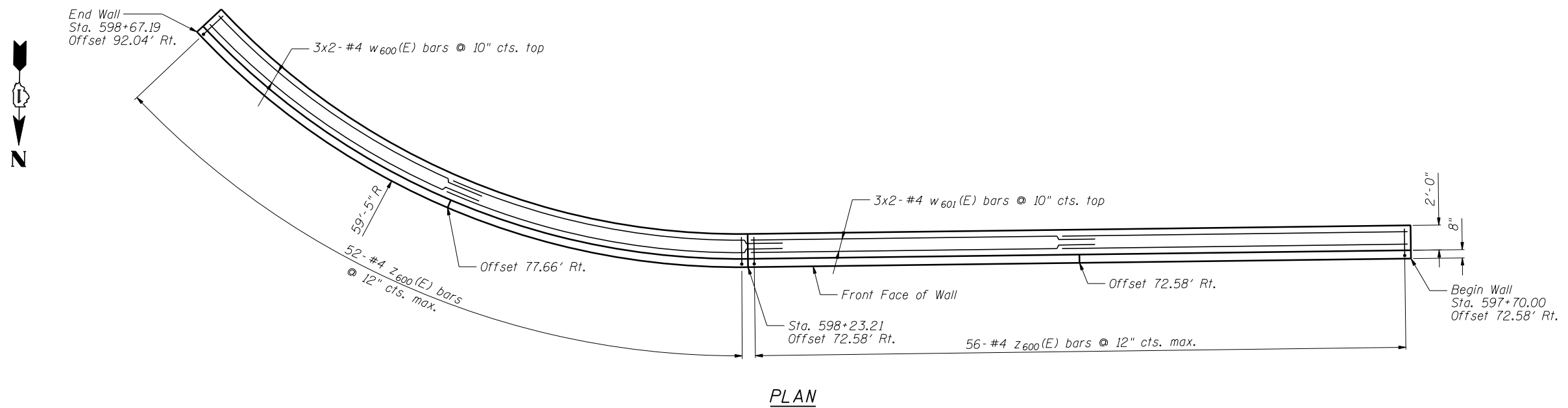

PLAN

Notes:
 Minimum lap for #4 bar is 2'-11".
 Bend h and w bars as required to fit curve.
 Bars indicated thus: 3x2-#4 etc. indicates 3 lines of bars with 2 lengths per line.
 See Sheet SF-3 for Section A-A, Details and Bill of Material.

FILE NAME = ...60R31-W058-002-WallPlanElev.dgn



Zroka Engineering, P.C.
 4216 North Hermitage
 Chicago, IL 60613

DESIGNED - LAS	REVISED -
CHECKED - DAZ	REVISED -
DRAWN - SAW	REVISED -
CHECKED - LAS	REVISED -

STATE OF ILLINOIS
 DEPARTMENT OF TRANSPORTATION

WALL PLAN AND ELEVATION
 STA. 597+70.00 TO STA. 598+67.19 SN 022-W058

F.A.P. RTE.	SECTION	COUNTY	TOTAL SHEETS	SHEET NO.
338	(112 & 113) WRS-6	DUPAGE	734	540
CONTRACT NO. 60R31				

SHEET NO. SF-2 OF SF-4 SHEETS

ILLINOIS FED. AID PROJECT