

DEVELOPED ELEVATION

MATCH LINE
STA. 4027+00

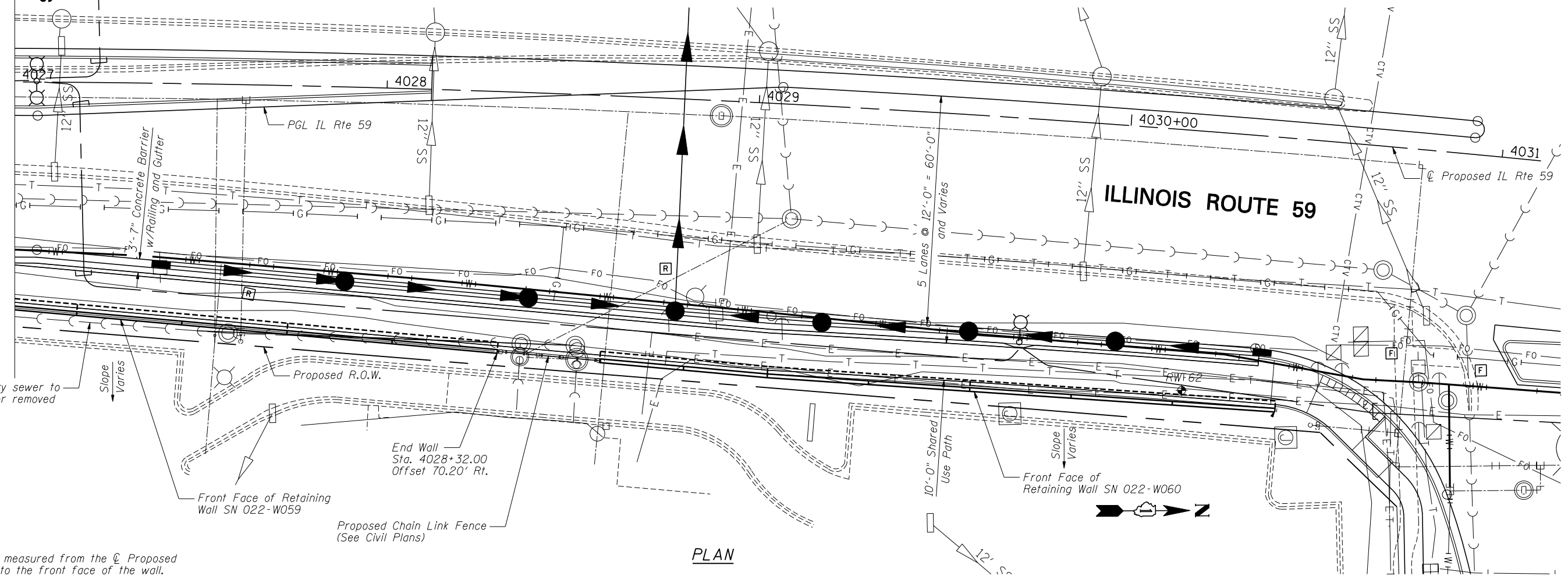

PLAN

Existing sanitary sewer to be abandoned or removed See Civil Plans

Note:
Offsets are measured from the \varnothing Proposed IL Rte. 59 to the front face of the wall.

FILE NAME = ...60R31-W059-002-GPE2.dgn

ZROKA engineering
Zroka Engineering, P.C.
4216 North Hermitage
Chicago, IL 60613

DESIGNED - LAS	REVISD -
CHECKED - DAZ	REVISD -
DRAWN - SAW	REVISD -
CHECKED - LAS	REVISD -

SCALE - NONE
DATE - 12/14/2012

STATE OF ILLINOIS
DEPARTMENT OF TRANSPORTATION

GENERAL PLAN AND ELEVATION 2
STA. 4024+24.83 TO STA. 4028+32.00 SN 022-W059

SHEET NO. SG-2 OF SG-9 SHEETS

F.A.P. RTE.	SECTION	COUNTY	TOTAL SHEETS	SHEET NO.
338	(112 & 113) WRS-6	DUPAGE	734	544
CONTRACT NO. 60R31				

ILLINOIS FED. AID PROJECT