

ELEVATION

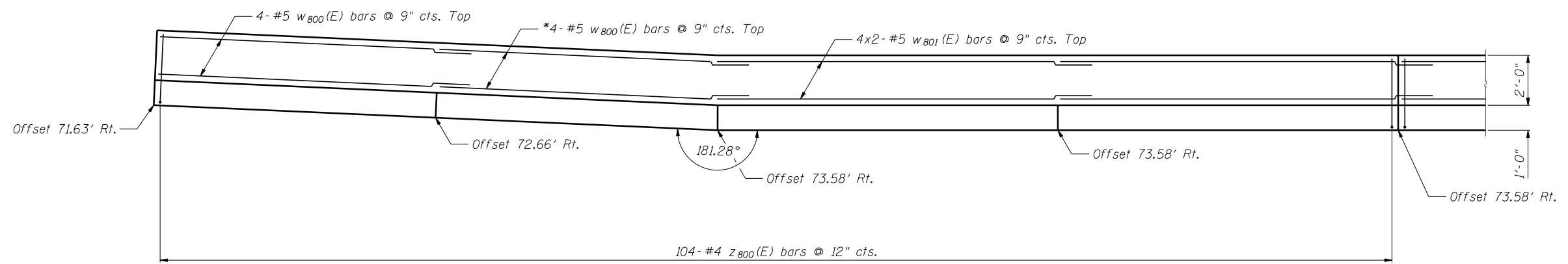

PLAN



Notes:

Minimum lap for #4 bar is 2'-11", #5 bar is 3'-8".

Bars indicated thus: 5x2-#4 etc. indicates 5 lines of bars with 2 lengths per line.

See Sheet SH-4 for Section A-A, Details and Bill of Material.

\* Bend bars in field to fit

FILE NAME = ...60R31-W060-002-WallPlanElev.dgn



DESIGNED - LAS	REVISED -
CHECKED - DAZ	REVISED -
DRAWN - SAW	REVISED -
CHECKED - LAS	REVISED -
SCALE - NONE	
DATE - 12/14/2012	

STATE OF ILLINOIS  
DEPARTMENT OF TRANSPORTATION

WALL PLAN AND ELEVATION 1  
STA. 4028 + 60.03 TO STA. 4030 + 44.81 SN 022-W060

SHEET NO. SH-2 OF SH-6 SHEETS

F.A.P. RTE.	SECTION	COUNTY	TOTAL SHEETS	SHEET NO.
338	(112 & 113) WRS-6	DUPAGE	734	553
CONTRACT NO. 60R31				

ILLINOIS FED. AID PROJECT