

FAP RTE.	SECTION	COUNTY	TOTAL SHEETS	SHEET NO.
*	**	BOONE	5	1

\*BELVIDERE MAINTENANCE YARD  
\*\*D2 MAINT YARD 2021-2

D-92-027-21



LOCATION OF SECTION INDICATED THUS: - [shaded box symbol]

INDEX OF SHEETS 06-11-2021 LETTING ITEM 018

- 1 COVER SHEET /INDEX
- 2 GENERAL NOTES
- 3 SOO
- 4 TYPICAL SECTION
- 5 PLAN SHEET

STATE OF ILLINOIS  
DEPARTMENT OF TRANSPORTATION  
DIVISION OF HIGHWAYS

**PROPOSED  
HIGHWAY PLANS**  
BELVIDERE MAINTENANCE YARD  
SECTION D2 MAINT YARD 2021-2  
BOONE COUNTY  
C-92-031-21

STATE STANDARDS  
701901-08 TRAFFIC CONTROL DEVICES

LOCATION OF PROJECT  
BELVIDERE MAINTENANCE YARD

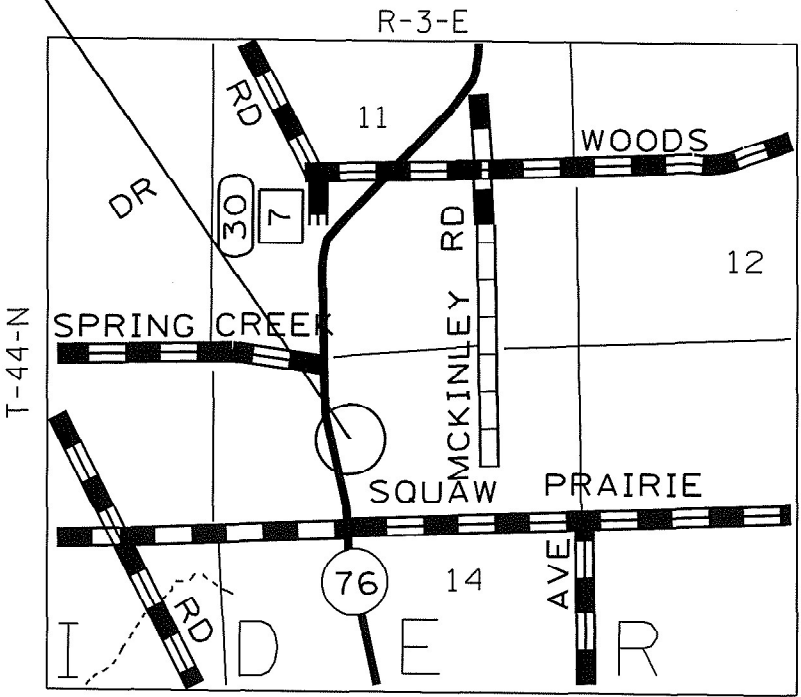

TOWNSHIP (SECTION):  
BELVIDERE (14)

J.U.L.I.E.  
JOINT UTILITY LOCATION INFORMATION FOR EXCAVATION  
1-800-892-0123

GROSS LENGTH OF PROJECT = N/A FT= N/A MILES  
NET LENGTH OF PROJECT = N/A FT= N/A MILES

CONTRACT NO. 64P87

STATE OF ILLINOIS  
DEPARTMENT OF TRANSPORTATION  
DIVISION OF HIGHWAYS

SUBMITTED       MARCH 5TH       20   21  

*[Signature]*  
REGION ENGINEER

May 7, 2021 *[Signature]*  
ENGINEER OF DESIGN AND ENVIRONMENT

May 7, 2021 *[Signature]*  
DIRECTOR OF HIGHWAYS PROJECT IMPLEMENTATION 13

PRINTED BY THE AUTHORITY  
OF THE STATE OF ILLINOIS

# GENERAL NOTES

The following Mixture Requirements are applicable for this project:

Location(s):	Surface		
Mixture Use(s):	Surface		
PG:	PG 58-28		
Design Air Voids:	4.0 @N50		
Mixture Composition (Mixture Gradation):	IL 9.5		
Friction Aggregate:	C		
Mixture Weight:	112 lbs/sy/in		
Quality Management Program:	QC/QA		
Sublot Size:			
Number of Roller Passes <sup>1)</sup> :			

1) When a number of roller passes is specified, the Contractor may opt to use intelligent compaction in lieu of density testing under the Quality Control for Performance (QCP) program.

IDOT is not a member of JULIE. If you are near any overhead lighting, intersection lighting or traffic signals, contact the IDOT Traffic Office at 815/284-5469 at least 48 hours prior to work.

The contractor shall have the option to either keep the millings or leave the millings at the yards. If the contractor chooses to keep the millings, they shall be hauled off site by the contractor. If the contractor chooses to leave the millings at the yard, IDOT shall provide the trucking for the millings. If the contractor is going to leave the millings at the yard, the contractor shall contact the OS1 or field engineer for the area one week prior to the milling operations begin.

Before work starts at the Belvidere yard, the contractor shall contact the OS1 or field engineer for Boone County two weeks before work shall begin to give the Belvidere yard time to prep areas to be surfaced.

The contractor shall place temporary ramps at locations as directed by the engineer. The millings shall be used to form the temporary ramps. Temporary ramps shall not be paid for separately but shall be included in the cost of HOT-MIX ASPHALT SURFACE REMOVAL of the thickness specified.

FILE NAME = 64P87.GN.DOCX	USER NAME =	DESIGNED - Engineering Systems	REVISED -	STATE OF ILLINOIS DEPARTMENT OF TRANSPORTATION	GENERAL NOTES	ROUTE	SECTION	COUNTY	TOTAL SHEETS	SHEET NO.	
	PLOT SCALE =	CHECKED -	REVISED -				Section D2 Maint. Yard 2021-2	Boone	5	1	
	PLOT DATE = 2/26/2021 1:56 PM	DATE - 2/24/2021 2:32 PM	REVISED -			CONTRACT NO. 64P87		ILLINOIS	FED. AID PROJECT		
						SCALE:	SHEET NO.	OF	SHEETS	STA.	TO STA.

**SUMMARY OF QUANTITIES**

Belvidere Maintenance Yard  
SECTION D2 Maint Yard 2021-2  
Boone COUNTY  
CONTRACT # 64P87  
SHEET 3 OF 5  
URBAN  
100% State  
0005

<b>CODE NO.</b>	<b>ITEM</b>	<b>UNIT</b>	<b>TOTAL QUANTITY</b>
40600290	BITUMINOUS MATERIALS (TACK COAT)	POUND	4985
40604050	HOT-MIX ASPHALT SURFACE COURSE, IL-9.5, MIX "C", N50	TON	1241
44000161	HOT-MIX ASPHALT SURFACE REMOVAL 3"	SQ YD	5260
44201747	CLASS D PATCHES, TYPE IV 8 INCH	SQ YD	300
67100100	MOBILIZATION	L SUM	1

REV. 4/7/21 REV. 4/1/21

# BELVIDERE YARD

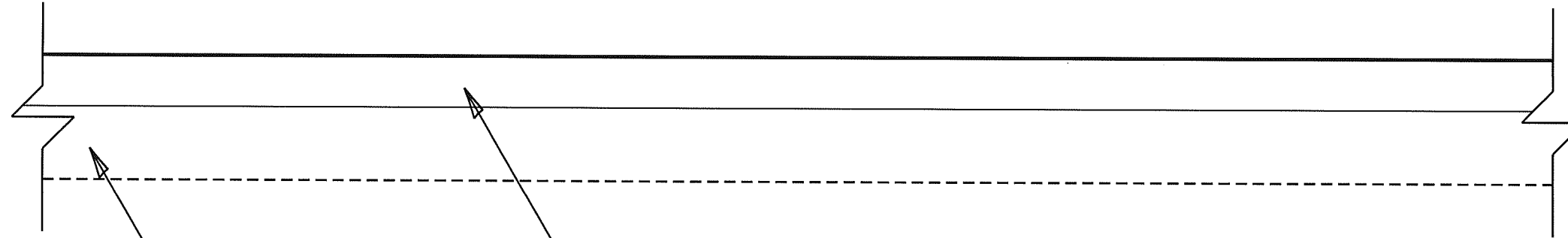

EXISTING HMA (2.5-3.8 INCH THICKNESS)

EXISTING AGGREGATE SUB-BASE  
(3-14 INCH THICKNESS)

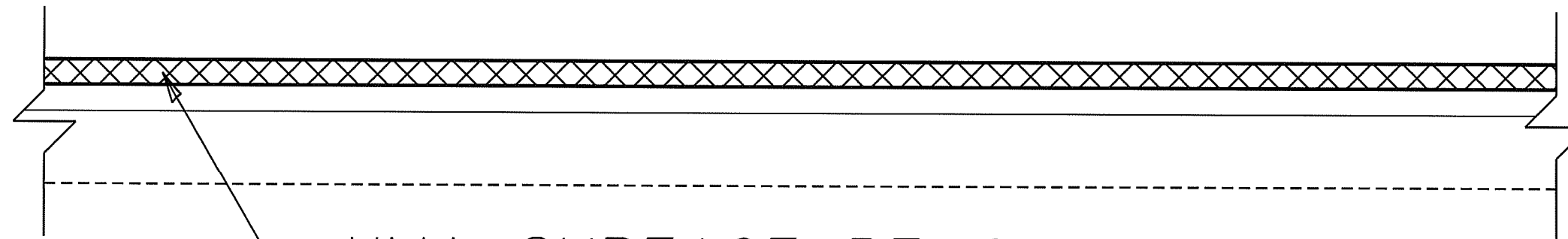

HMA SURFACE REMOVAL 3"  
3" HMA SURFACE COURSE, MIX "C" ,N50  
(PLACED IN TWO LIFTS)

MODEL: D:\dmit\scpl\micklaus\FY 21\JstDavid\Belvidere\Belvidere Maintenance Yard.dgn

USER NAME = Nicklaus	DESIGNED - _____	REVISED - _____
PLOT SCALE = 102.9963' / in.	DRAWN - _____	REVISED - _____
PLOT DATE = Feb-26-2021 01:57:25 PM	CHECKED - _____	REVISED - _____
	DATE - _____	REVISED - _____

STATE OF ILLINOIS  
DEPARTMENT OF TRANSPORTATION

SCALE: \_\_\_\_\_ SHEET \_\_\_\_\_ OF \_\_\_\_\_ SHEETS STA. \_\_\_\_\_ TO STA. \_\_\_\_\_

BELVIDERE MAINTENANCE YARD

RTE.	SECTION	COUNTY	TOTAL SHEETS	SHEET NO.
*	D2 MAINT YARD 2021-2	BOONE	5	4
			CONTRACT NO. 64P87	

ILLINOIS FED. AID PROJECT

# BELVIDERE YARD

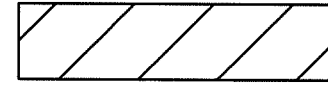
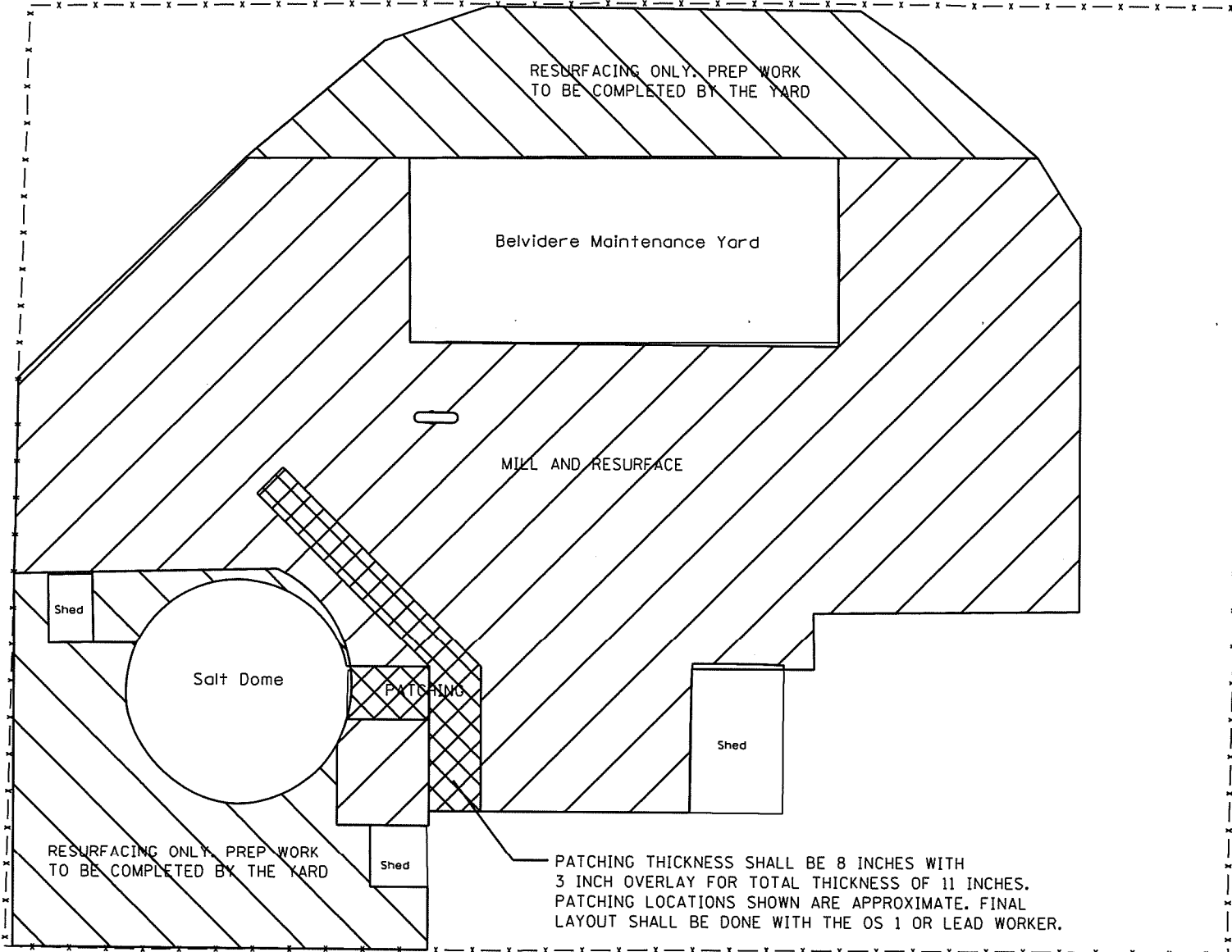

**AREA TO BE MILLED AND RESURFACED**

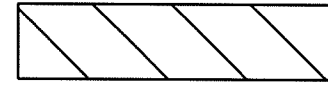

**AREA TO BE RESURFACED NO MILLING  
PREP WORK TO BE DONE BY THE YARD**

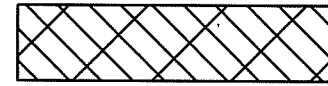

**AREA TO BE PATCHED. LOCATION IS  
APPROXIMATE. FINAL LAYOUT SHALL BE  
DONE IN THE FIELD WITH OS 1 OR  
LEAD WORKER.**

MODEL: Derwin  
 FILE NAME: S:\Nicklaus\FY 21\_Belvidere\Maintenance\_Yard.dwg

USER NAME = Nicklaus	DESIGNED - _____	REVISED - _____
	DRAWN - _____	REVISED - _____
PLOT SCALE = 102.9963' / in.	CHECKED - _____	REVISED - _____
PLOT DATE = Feb-26-2021 01:57:45 PM	DATE - _____	REVISED - _____

**STATE OF ILLINOIS  
DEPARTMENT OF TRANSPORTATION**

SCALE: _____	SHEET _____ OF _____ SHEETS	STA. _____ TO STA. _____
--------------	-----------------------------	--------------------------

*BELVIDERE MAINTENANCE YARD				
RTE.	SECTION	COUNTY	TOTAL SHEETS	SHEET NO.
*	D2 MAINT YARD 2021-2	BOONE	5	5
			CONTRACT NO. 64P87	
ILLINOIS FED. AID PROJECT				