

STATE OF ILLINOIS
DEPARTMENT OF TRANSPORTATION

F.A.I. RTE.	SECTION	COUNTY	TOTAL SHEETS	SHEET NO.
57	(10-32HB-3)TS	CHAMPAIGN	16	1
		ILLINOIS	CONTRACT NO. 70E69	

D95-019-20

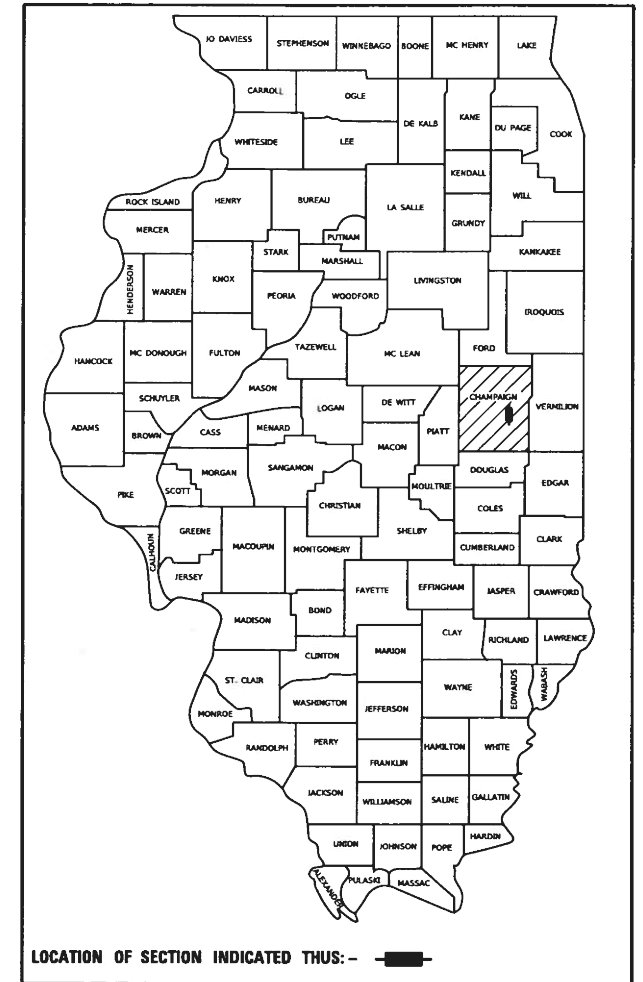

PROPOSED HIGHWAY PLANS

F.A.I. ROUTE 57
SECTION (10-32HB-3)TS
PROJECT NHPP-7DL3(935)
TRAFFIC SIGNAL INSTALLATION
AT I-57 NB & SB RAMPS
CHAMPAIGN COUNTY

C-95-079-20

FOR INDEX OF SHEETS, SEE SHEET NO. 2
FOR SUMMARY OF QUANTITIES, SEE SHEET NO. 3

I-57 NB & SB RAMPS
AT CURTIS RD

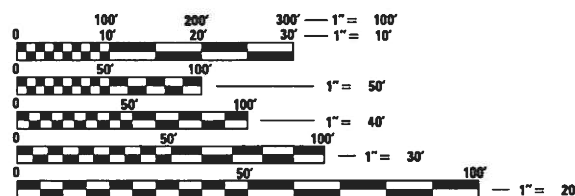

FULL SIZE PLANS HAVE BEEN PREPARED USING STANDARD ENGINEERING SCALES. REDUCED SIZED PLANS WILL NOT CONFORM TO STANDARD SCALES. IN MAKING MEASUREMENTS ON REDUCED PLANS, THE ABOVE SCALES MAY BE USED.

J.U.L.I.E.
JOINT UTILITY LOCATION INFORMATION FOR EXCAVATORS
1-800-892-0123
OR 811

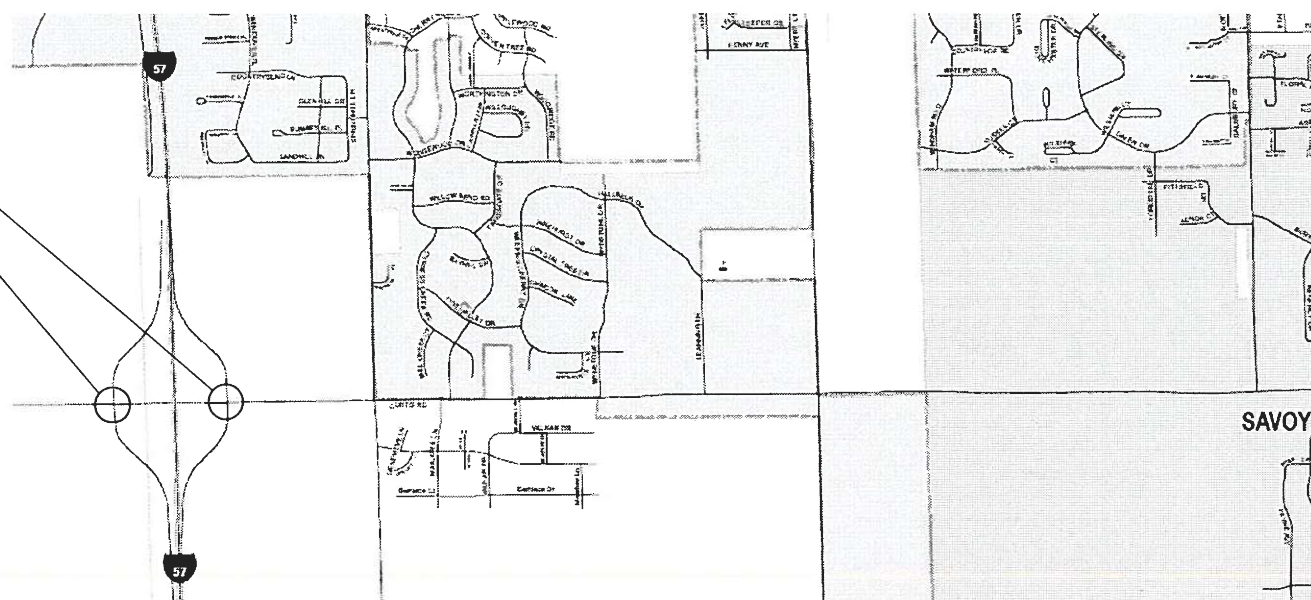

CHAMPAIGN TOWNSHIP



STATE OF ILLINOIS
DEPARTMENT OF TRANSPORTATION

SUBMITTED April 1 2020
[Signature]
REGIONAL ENGINEER

May 8, 2020 *[Signature]*
ENGINEER OF DESIGN AND ENVIRONMENT

May 8, 2020 *[Signature]*
DIRECTOR OF HIGHWAYS PROJECT IMPLEMENTATION

PRINTED BY THE AUTHORITY
OF THE STATE OF ILLINOIS

PROJECT ENGINEER: JEFF ALLEN
SQUAD LEADER: ROGER BIGGS
PHONE: (217)465-4181

CONTRACT NO. 70E69

GENERAL NOTES

GN 105.07C
 EXISTING STATE-OWNED AND MAINTAINED UNDERGROUND UTILITY FACILITIES EXIST WITHIN THE ROW. THE DEPARTMENT IS NOT A MEMBER OF JULIE AND DOES NOT LOCATE IT'S OWN FACILITIES. THE CONTRACTOR SHALL BE RESPONSIBLE AT THEIR OWN EXPENSE FOR SECURING AN APPROVED LOCATING FIRM TO LOCATE ALL EXISTING IDOT UNDERGROUND FACILITIES PRIOR TO COMMENCING ANY EXCAVATION, PER THE REQUIREMENTS OF ARTICLE 803 OF THE STANDARD SPECIFICATIONS. UTILITY LOCATES MAY ALSO BE REQUIRED OUTSIDE THE PROJECT LIMITS, SUCH AS FOR TRAFFIC CONTROL SIGNING AND OTHER ITEMS. THE CONTRACTOR MAY OBTAIN, ON REQUEST, PLANS OF EXISTING ELECTRICAL FACILITIES FROM THE DEPARTMENT. FOR FURTHER INFORMATION, THE CONTRACTOR MAY CONTACT THE DISTRICT TRAFFIC OPERATIONS ENGINEER, GARY SIMS, AT 217-251-4859.

INDEX OF SHEETS

1	COVER SHEET
2	INDEX OF SHEETS, HIGHWAY STANDARDS, & GENERAL NOTES
3 - 6	SUMMARY OF QUANTITIES
7	SOUTHBOUND RAMP TRAFFIC SIGNAL LAYOUT
8	SOUTHBOUND RAMP CONDUIT LAYOUT
9	SOUTHBOUND RAMP CABLE LAYOUT
10	SOUTHBOUND RAMP PHASE DESIGNATION, SCHEDULES, AND BILL OF MATERIALS
11	NORTHBOUND RAMP TRAFFIC SIGNAL LAYOUT
12	NORTHBOUND RAMP CONDUIT LAYOUT
13	NORTHBOUND RAMP CABLE LAYOUT
15	NORTHBOUND RAMP PHASE DESIGNATION, SCHEDULES, AND BILL OF MATERIALS
16	DETAILS

TRAFFIC SIGNAL GENERAL NOTES

- 1 THE ACTUAL LOCATION OF ALL SIGNAL FOUNDATIONS, HANDHOLES, AND TRAFFIC CONTROLLER WILL BE DETERMINED IN THE FIELD BY THE ENGINEER.
- 2 THE FINAL LOCATIONS OF ALL TRAFFIC CONTROL ITEMS SHALL BE VERIFIED BY THE ENGINEER IN THE FIELD.
- 3 POST MOUNTED SIGNALS SHALL BE INSTALLED SO THAT NO PART OF THE SIGNAL HEAD IS WITHIN 2 FT. OF THE FACE OF CURB.
- 4 ALL MAST ARM POLES SHALL BE A MINIMUM OF 6 FT. FROM THE CENTER OF THE POLE TO THE FACE OF CURB (ON THE MAST ARM SIDE) OR AS SHOWN ON THE PLANS.
- 5 COMBINATION MAST ARM ASSEMBLIES SHALL BE FURNISHED WITH 15' LUMINAIRE TRUSS ARMS WITH A MOUNTED LUMINAIRE HEIGHT OF 40 FT.
- 6 ALL TRAFFIC SIGNAL MAST ARMS MUST BE DESIGNED FOR THE LOADINGS SHOWN ON THE HIGHWAY STANDARDS OR THESE SIGNAL PLANS, WHICHEVER IS GREATER.
- 7 SIGNAL FACES FOR THE NORTH APPROACH ARE NOTED AS "A","B" FOR THE SOUTH APPROACH,"C" FOR THE WEST APPROACH, AND "D" FOR THE EAST APPROACH.
- 8 ALIGN ADJACENT RED INDICATIONS TO SAME HEIGHT ABOVE PAVEMENT.
- 9 THE BASE FOR A TRAFFIC SIGNAL POST SHALL BE SITUATED SUCH THAT THE HANDHOLE IS LOCATED ON A SIDE AWAY FROM A TRAVELED LANE.
- 10 PEDESTRIAN PUSHBUTTON SIGNAL SIGNS SHALL BE MOUNTED ABOVE THE APPROPRIATE PEDESTRIAN PUSHBUTTON.
- 11 ITEMS REMOVED WILL BECOME THE PROPERTY OF THE CONTRACTOR UNLESS OTHERWISE NOTED ON THE PLANS.
- 12 THE CONTRACTOR SHALL BE RESPONSIBLE FOR OBTAINING ELECTRICAL SERVICE FOR THE TRAFFIC SIGNALS. THE CONTRACTOR SHALL CONTACT THE UTILITY COMPANY PRIOR TO COMMENCEMENT OF WORK TO OBTAIN UTILITY COMPANY REQUIREMENTS FOR THE SERVICE INSTALLATION
- 13 THE CONTRACTOR SHALL SUPPLY AND MOUNT SUPPLEMENTAL SIGNS BY THE MASTARM MOUNTED FYA SIGNAL HEADS STATING "LEFT TURN YIELD ON FLASHING YELLOW ARROW" (R10-1109 AS SHOWN IN THE ILLINOIS STANDARD HIGHWAY SIGNS BOOK - JULY 1, 2014)

STANDARDS TO BE INCLUDED IN THE PLANS

- 000001-07 STANDARD SYMBOLS, ABBREVIATIONS AND PATTERNS
- 001001-02 AREAS OF REINFORCEMENT BARS
- 001006 DECIMAL OF AN INCH AND OF A FOOT
- 701101-05 OFF-ROAD OPERATIONS, MULTILANE, MORE THAN 15' (4.5 m) TO 24" (600 MM) FROM PAVMENT EDGE
- 701106-02 OFF-ROAD OPERATIONS, MULTILANE, 15' (4.5 m) TO 24" (600 MM) FROM PAVEMENT EDGE
- 701426-09 LAND CLOSURE, MULTILANE, INTERMITTENT OR MOVING OPERATION FOR SPEEDS \geq 45 MPH
- 701456-05 PARTIAL EXIT RAMP CLOSURE FREEWAY/ESPRESSWAY
- 701601-09 URBAN LANE CLOSURE, MULTILANE, 1W OR 2W WITH NONTRAVERSABLE MEDIAN
- 701701-10 URBAN LANE CLOSURE, MULTILANE INTERSECTION
- 701901-08 TRAFFIC CONTROL DEVICES
- 720016-04 MAST ARM MOUNTED STREET NAME SIGNS
- 805001-01 ELECTRICAL SERVICE INSTALLATION DETAILS
- 814001-03 HANDHOLES
- 814006-02 DOUBLE HANDHOLES
- 821101-02 LUMINAIRE WIRING IN POLE
- 857001-01 STANDARD PHASE DESIGNATION DIAGRAMS AND PHASE SEQUENCES
- 862001-01 UNINTERRUPTABLE POWER SUPPLY
- 873001-02 TRAFFIC SIGNAL GROUNDING & BONDING
- 877011-10 STEEL COMB. MAST ARM ASSEMBLY AND POLE 16' THROUGH 55'
- 878001-10 CONCRETE FOUNDATION DETAILS
- 880006-01 TRAFFIC SIGNAL MOUNTING DETAILS

MODEL: I:\MODEL\NAMES
 FILE: N:\names: p:\pub\mcomas\data\illinois\pwr\WIDOT\Documents\IDOT_Offices\District_5\Projects\0570669\CADDData\CAD\Sheet\0570669-eh-genernotes.dgn

USER NAME = biggsrd	DESIGNED -	REVISED -
	DRAWN -	REVISED -
PLOT SCALE = 40,0000 ' / in.	CHECKED -	REVISED -
PLOT DATE = 4/9/2020	DATE -	REVISED -

**STATE OF ILLINOIS
 DEPARTMENT OF TRANSPORTATION**

**GENERAL NOTES, INDEX OF SHEETS
 STANDARDS TO BE INCLUDED IN THE PLANS**

SCALE: SHEET OF SHEETS STA. TO STA.

F.A.I. RTE.	SECTION	COUNTY	TOTAL SHEETS	SHEET NO.
57	(10-32HB-3)TS	CHAMPAIGN	16	2
CONTRACT NO. 70E69				
		ILLINOIS	FED. AID PROJECT	

SUMMARY OF QUANTITIES

1 of 4

LOCATION OF WORK:

FAI 57
I-57 &
CURTIS RD.
SB RAMPS
CHAMPAIGN
90% FED
10% STATE
URBAN
0021

FAI 57
I-57 &
CURTIS RD.
NB RAMPS
CHAMPAIGN
90% FED
10% STATE
URBAN
0021

FAI 57
I-57 &
CURTIS RD.
INTERCONNECT
CHAMPAIGN
90% FED
10% STATE
URBAN
0021

FAI 57
I-57 &
CURTIS RD.
SB & NB RAMPS
CHAMPAIGN
100% CITY
URBAN
0021

COUNTY:

FUNDING BREAKOUT:

CONSTRUCTION TYPE CODE:

CODE NO.	ITEM	UNIT	TOTAL QUANTITY	QUANTITY	QUANTITY	QUANTITY	QUANTITY
67100100	MOBILIZATION	L SUM	1	.5		.5	
70100825	TRAFFIC CONTROL AND PROTECTION, STANDARD 701456	L SUM	1	.5		.5	
70102630	TRAFFIC CONTROL AND PROTECTION, STANDARD 701601	L SUM	1	.5		.5	
70102635	TRAFFIC CONTROL AND PROTECTION, STANDARD 701701	L SUM	1	.5		.5	
80500100	SERVICE INSTALLATION, TYPE A	EACH	2	1.0		1.0	
81028350	UNDERGROUND CONDUIT, PVC, 2" DIA.	FOOT	1653	325.0		459.0	869.0
81028360	UNDERGROUND CONDUIT, PVC, 2 1/2" DIA.	FOOT	202	102.0		100.0	
81028370	UNDERGROUND CONDUIT, PVC, 3" DIA.	FOOT	614	326.0		288.0	
81028400	UNDERGROUND CONDUIT, PVC, 5" DIA.	FOOT	8.0	4.0		4.0	
81400100	HANDHOLE	EACH	14.0	5.0		5.0	4.0
81400300	DOUBLE HANDHOLE	EACH	2	1.0		1.0	
81702110	ELECTRIC CABLE IN CONDUIT, 600V (XLP-TYPE USE) 1/C NO. 10	FOOT	4109	1,304.0		1,326.0	1,479.0
82110008	LUMINAIRE, LED, ROADWAY, OUTPUT DESIGNATION H	EACH	8	4.0		4.0	
84200500	REMOVAL OF LIGHTING UNIT, SALVAGE	EACH	2	1.0		1.0	

MODEL: \\MODELS\NAME
 FILE NAME: \\P\Urban\from.dwg
 ILLINOIS.GOV\PWIDOT\Documents\DOT_Offices\District_5\Projects\DS70E69\CAD\Drawn\CAD\Sheet\DS70E69.sht-500.dgn

USER NAME = biggsrd	DESIGNED -	REVISED -
	DRAWN -	REVISED -
PLOT SCALE = 40.0492' / in.	CHECKED -	REVISED -
PLOT DATE = 4/1/2020	DATE -	REVISED -

**STATE OF ILLINOIS
DEPARTMENT OF TRANSPORTATION**

SUMMARY OF QUANTITIES

SCALE: NONE SHEET 1 OF 4 SHEETS STA. TO STA.

F.A.I. RTE.	SECTION	COUNTY	TOTAL SHEETS	SHEET NO.
57	(10-32HB-3)TS	CHAMPAIGN	16	3
CONTRACT NO. 70E69				
ILLINOIS FED. AID PROJECT				

SUMMARY OF QUANTITIES

2 of 4

LOCATION OF WORK:

FAI 57
I-57 &
CURTIS RD.
SB RAMPS
CHAMPAIGN
90% FED
10% STATE
URBAN
0021

FAI 57
I-57 &
CURTIS RD.
NB RAMPS
CHAMPAIGN
90% FED
10% STATE
URBAN
0021

FAI 57
I-57 &
CURTIS RD.
INTERCONNECT
CHAMPAIGN
90% FED
10% STATE
URBAN
0021

FAI 57
I-57 &
CURTIS RD.
SB & NB RAMPS
CHAMPAIGN
100% CITY
URBAN
0021

COUNTY:

FUNDING BREAKOUT:

CONSTRUCTION TYPE CODE:

CODE NO.	ITEM	UNIT	TOTAL QUANTITY	QUANTITY	QUANTITY	QUANTITY	QUANTITY
84200804	REMOVAL OF POLE FOUNDATION	EACH	2.0	1.0	1.0		
85100500	PAINT NEW TRAFFIC SIGNAL POST	EACH	10.0				10.0
85100800	PAINT NEW COMBINATION MAST ARM AND POLE, UNDER 40 FOOT	EACH	2.0				2.0
85100901	PAINT NEW COMBINATION MAST ARM AND POLE, 40 FOOT AND OVER	EACH	4.0				4.0
85700300	FULL-ACTUATED CONTROLLER AND TYPE V CABINET	EACH	2.0	1.0	1.0		
86200200	UNINTERRUPTABLE POWER SUPPLY, STANDARD	EACH	2.0	1.0	1.0		
87300925	ELECTRIC CABLE IN CONDUIT, TRACER, NO. 14 1C	FOOT	1139.0			1,139.0	
87301245	ELECTRIC CABLE IN CONDUIT, SIGNAL NO. 14 5C	FOOT	3755.0	1,790.0	1,965.0		
87301255	ELECTRIC CABLE IN CONDUIT, SIGNAL NO. 14 7C	FOOT	828.0	336.0	492.0		
87301805	ELECTRIC CABLE IN CONDUIT, SERVICE, NO. 6 2 C	FOOT	532.0	231.0	301.0		
87301900	ELECTRIC CABLE IN CONDUIT, EQUIPMENT GROUNDING CONDUCTOR, NO. 6 1C	FOOT	1887.0	951.0	936.0		
87502660	TRAFFIC SIGNAL POST, ALUMINUM 12 FT.	EACH	10.0	5.0	5.0		
87702890	STEEL COMBINATION MAST ARM ASSEMBLY AND POLE 32 FT.	EACH	2.0	1.0	1.0		
87702970	STEEL COMBINATION MAST ARM ASSEMBLY AND POLE 48 FT.	EACH	2.0	1.0	1.0		

MODEL: \\MODELS\NAMES
FILE NAME: \\p:\urbanroom\dot\illinois.gov\PWIDOT\Documents\DOT_Offices\District_5\Projects\0370E69\CA\00\baal\CA00\sheet\0370E69-sh-500.dgn

USER NAME = biggsrd	DESIGNED -	REVISED -
	DRAWN -	REVISED -
PLOT SCALE = 40.0508' / in.	CHECKED -	REVISED -
PLOT DATE = 4/1/2020	DATE -	REVISED -

**STATE OF ILLINOIS
DEPARTMENT OF TRANSPORTATION**

SUMMARY OF QUANTITIES

SCALE: NONE SHEET 2 OF 4 SHEETS STA. TO STA.

F.A.I. RTE.	SECTION	COUNTY	TOTAL SHEETS	SHEET NO.
57	(10-32HB-3)TS	CHAMPAIGN	16	4
CONTRACT NO. 70E69				
ILLINOIS FED. AID PROJECT				

SUMMARY OF QUANTITIES

3 of 4

LOCATION OF WORK:

FAI 57
I-57 &
CURTIS RD.
SB RAMPS
CHAMPAIGN
90% FED
10% STATE
URBAN
0021

FAI 57
I-57 &
CURTIS RD.
NB RAMPS
CHAMPAIGN
90% FED
10% STATE
URBAN
0021

FAI 57
I-57 &
CURTIS RD.
INTERCONNECT
CHAMPAIGN
90% FED
10% STATE
URBAN
0021

FAI 57
I-57 &
CURTIS RD.
SB & NB RAMPS
CHAMPAIGN
100% CITY
URBAN
0021

COUNTY:

FUNDING BREAKOUT:

CONSTRUCTION TYPE CODE:

CODE NO.	ITEM	UNIT	TOTAL QUANTITY	QUANTITY	QUANTITY	QUANTITY	QUANTITY
87800100	CONCRETE FOUNDATION, TYPE A	FOOT	31.0	15.5		15.5	
87800150	CONCRETE FOUNDATION, TYPE C	FOOT	7.0	3.5		3.5	
87800415	CONCRETE FOUNDATION, TYPE E 36-INCH DIAMETER	FOOT	76.0	37.0		39.0	
87900200	DRILL EXISTING HANDHOLE	EACH	1.0			1.0	
88030020	SIGNAL HEAD, LED, 1-FACE, 3-SECTION, MAST-ARM MOUNTED	EACH	12.0	6.0		6.0	
88030050	SIGNAL HEAD, LED, 1-FACE, 3-SECTION, BRACKET MOUNTED	EACH	10.0	5.0		5.0	
88030080	SIGNAL HEAD, LED, 1-FACE, 4-SECTION, MAST ARM MOUNTED	EACH	2.0	1.0		1.0	
88030230	SIGNAL HEAD, LED, 2-FACE, 1-3 SECTION, 1-4 SECTION, BRACKET MOUNTED	EACH	2.0	1.0		1.0	
88200510	TRAFFIC SIGNAL BACKPLATE, RETROREFLECTIVE	EACH	28.0	14.0		14.0	
X0326266	ETHERNET SWITCH	EACH	2.0	1.0		1.0	
X0326812	CAT 5 ETHERNET CABLE	FOOT	1460.0	674.0		786.0	
X0326887	WOOD POLE, 25 FT, CLASS 4	EACH	2.0	1.0		1.0	
X1400006	FIBER OPTIC CABLE IN CONDUIT, 12 FIBERS, SINGLE MODE	FOOT	1739.0			1,739.0	
X1400353	STEEL COMBINATION MAST ARM ASSEMBLY AND POLE 48 FT. WITH DUAL 15 FT. LIGHTING ARM AT 40 FT. MOUNTING HEIGHT	EACH	1.0	1.0			

MODEL: \$MODELNAME\$ FILE NAME: \\pww\pww\com\dot\illinois\gov\pww\DOT\Documents\DOT_Offices\District_5\Projects\577569\CADD\Drawings\CAD\Sheet\577569_sht-500.dgn

USER NAME = biggsrd	DESIGNED -	REVISED -
	DRAWN -	REVISED -
PLOT SCALE = 40.0508' / in.	CHECKED -	REVISED -
PLOT DATE = 4/11/2020	DATE -	REVISED -

**STATE OF ILLINOIS
DEPARTMENT OF TRANSPORTATION**

SUMMARY OF QUANTITIES

SCALE: NONE SHEET 3 OF 4 SHEETS STA. TO STA.

F.A.I. RTE.	SECTION	COUNTY	TOTAL SHEETS	SHEET NO.
57	(10-32HB-3)TS	CHAMPAIGN	16	5
CONTRACT NO. 70E69				
ILLINOIS FED. AID PROJECT				

SUMMARY OF QUANTITIES

4 of 4

LOCATION OF WORK:

COUNTY:
FUNDING BREAKOUT:

CONSTRUCTION TYPE CODE:

FAI 57
I-57 &
CURTIS RD.
SB RAMPS
CHAMPAIGN
90% FED
10% STATE
URBAN
0021

FAI 57
I-57 &
CURTIS RD.
NB RAMPS
CHAMPAIGN
90% FED
10% STATE
URBAN
0021

FAI 57
I-57 &
CURTIS RD.
INTERCONNECT
CHAMPAIGN
90% FED
10% STATE
URBAN
0021

FAI 57
I-57 &
CURTIS RD.
SB & NB RAMPS
CHAMPAIGN
100% CITY
URBAN
0021

CODE NO.	ITEM	UNIT	TOTAL QUANTITY	QUANTITY	QUANTITY	QUANTITY	QUANTITY
X1400354	STEEL COMBINATION MAST ARM ASSEMBLY AND POLE 52 FT. WITH DUAL 15 FT. LIGHTING ARM AT 40 FT.	EACH	1.0		1.0		
X1400399	VIDEO DETECTION SYSTEM COMPLETE	EACH	2.0	1.0	1.0		
X8870300	EMERGENCY VEHICLE PRIORITY SYSTEM	EACH	2.0				2.0
X1400426	MODIFY EXISTING FIBER OPTIC CABINET	EACH	1.0			1.0	

MODEL: \\MODELS\NAMES
FILE NAME: \\P\wincom\dot\illinois.gov\RWIDOT\Documents\DOT_Offices\District_3\Projects\0370EB\CADD\03\0370EB-311-500.dgn

<small>USER NAME = biggsrd DESIGNED - DRAWN - CHECKED - PLOT SCALE = 40.1626 ' / in. PLOT DATE = 4/1/2020</small>	<small>REVISED - REVISED - REVISED - REVISED -</small>	STATE OF ILLINOIS DEPARTMENT OF TRANSPORTATION	SUMMARY OF QUANTITIES	<small>F.A.I. RTE. 57</small>	<small>SECTION (10-32HB-3)TS</small>	<small>COUNTY CHAMPAIGN</small>	<small>TOTAL SHEETS 16</small>	<small>SHEET NO. 6</small>
<small>SCALE: NONE SHEET 4 OF 4 SHEETS STA. TO STA.</small>				<small>ILLINOIS FED. AID PROJECT</small>				

TRAFFIC SIGNAL INSTALLATION

I-57 Southbound Ramps

&

FAP 807 (Curtis Rd.)

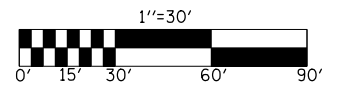

SIGNAL LAYOUT

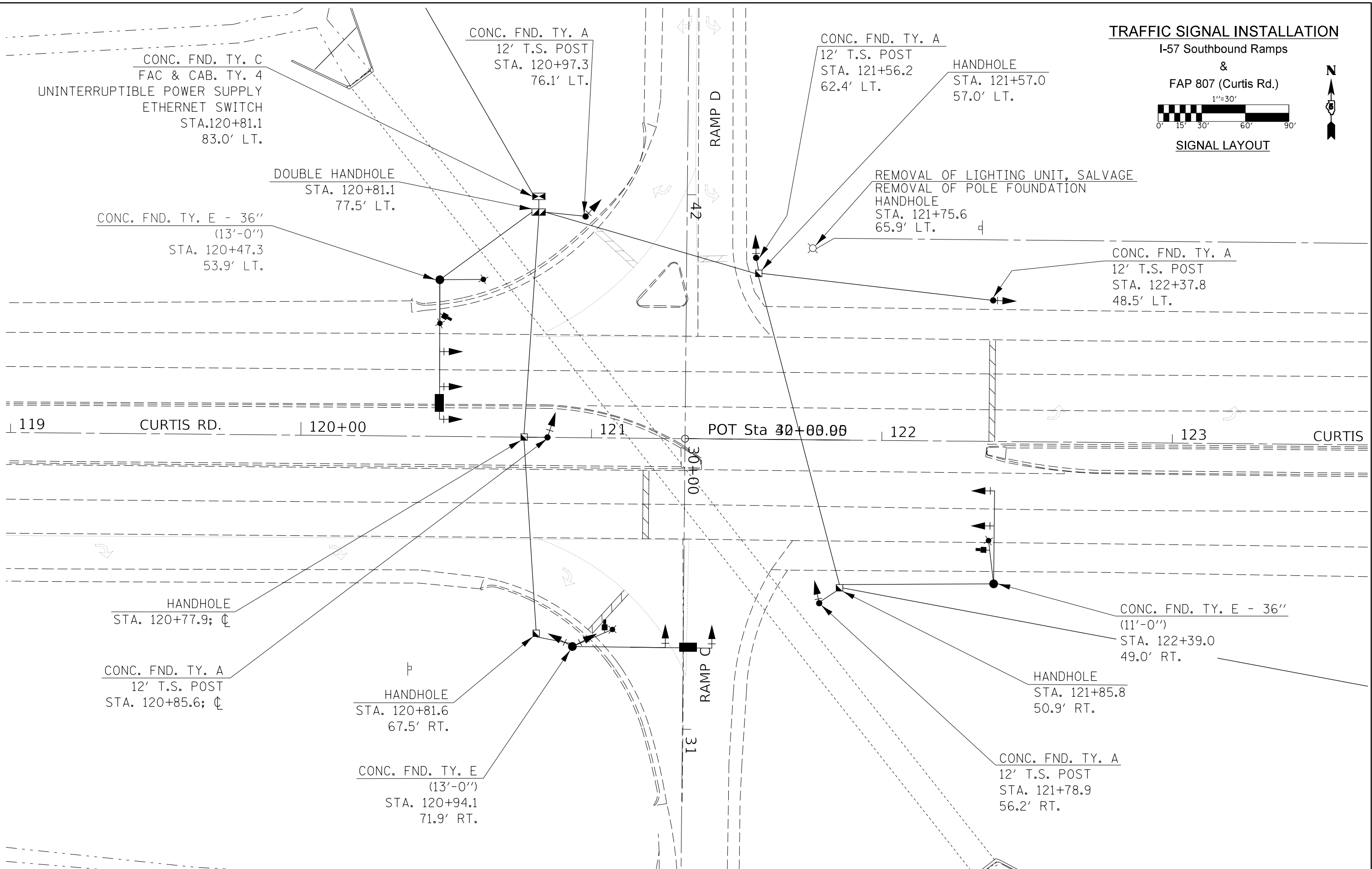

CONC. FND. TY. C
FAC & CAB. TY. 4
UNINTERRUPTIBLE POWER SUPPLY
ETHERNET SWITCH
STA. 120+81.1
83.0' LT.

CONC. FND. TY. A
12' T.S. POST
STA. 120+97.3
76.1' LT.

CONC. FND. TY. A
12' T.S. POST
STA. 121+56.2
62.4' LT.

HANDHOLE
STA. 121+57.0
57.0' LT.

DOUBLE HANDHOLE
STA. 120+81.1
77.5' LT.

CONC. FND. TY. E - 36"
(13'-0")
STA. 120+47.3
53.9' LT.

REMOVAL OF LIGHTING UNIT, SALVAGE
REMOVAL OF POLE FOUNDATION
HANDHOLE
STA. 121+75.6
65.9' LT.

CONC. FND. TY. A
12' T.S. POST
STA. 122+37.8
48.5' LT.

119 CURTIS RD. 120+00

POT Sta 30+00.00 122

123 CURTIS

HANDHOLE
STA. 120+77.9; □

CONC. FND. TY. A
12' T.S. POST
STA. 120+85.6; □

HANDHOLE
STA. 120+81.6
67.5' RT.

CONC. FND. TY. E
(13'-0")
STA. 120+94.1
71.9' RT.

CONC. FND. TY. E - 36"
(11'-0")
STA. 122+39.0
49.0' RT.

HANDHOLE
STA. 121+85.8
50.9' RT.

CONC. FND. TY. A
12' T.S. POST
STA. 121+78.9
56.2' RT.

MODEL: I:\MODELS\NAMES
FILE: I:\WORK\PROJECTS\DOT\OFFICE\CHAMPAIGN\DOT\Documents\DOT\I-57\SB Ramps Traffic Signal\I-57 SB Ramps Traffic Signal.dwg

USER NAME = biggsrd	DESIGNED - _____	REVISED - _____
PLOT SCALE = 30.0222 ' / in.	DRAWN - _____	REVISED - _____
PLOT DATE = 4/1/2020	CHECKED - _____	REVISED - _____
	DATE - _____	REVISED - _____

STATE OF ILLINOIS
DEPARTMENT OF TRANSPORTATION

I-57 RAMPS & CURTIS RD.
TRAFFIC SIGNAL LAYOUT
SCALE: 1" = 30' SHEET 1 OF 1 SHEETS STA. _____ TO STA. _____

F.A.I. RTE.	SECTION	COUNTY	TOTAL SHEETS	SHEET NO.
57	(10-32HB-3)TS	CHAMPAIGN	16	7
CONTRACT NO. 70E69				
ILLINOIS FED. AID PROJECT				

TRAFFIC SIGNAL INSTALLATION

I-57 Southbound Ramps
&
FAP 807 (Curtis Rd.)

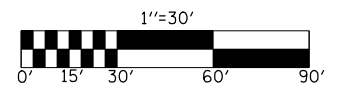

CONDUIT LAYOUT

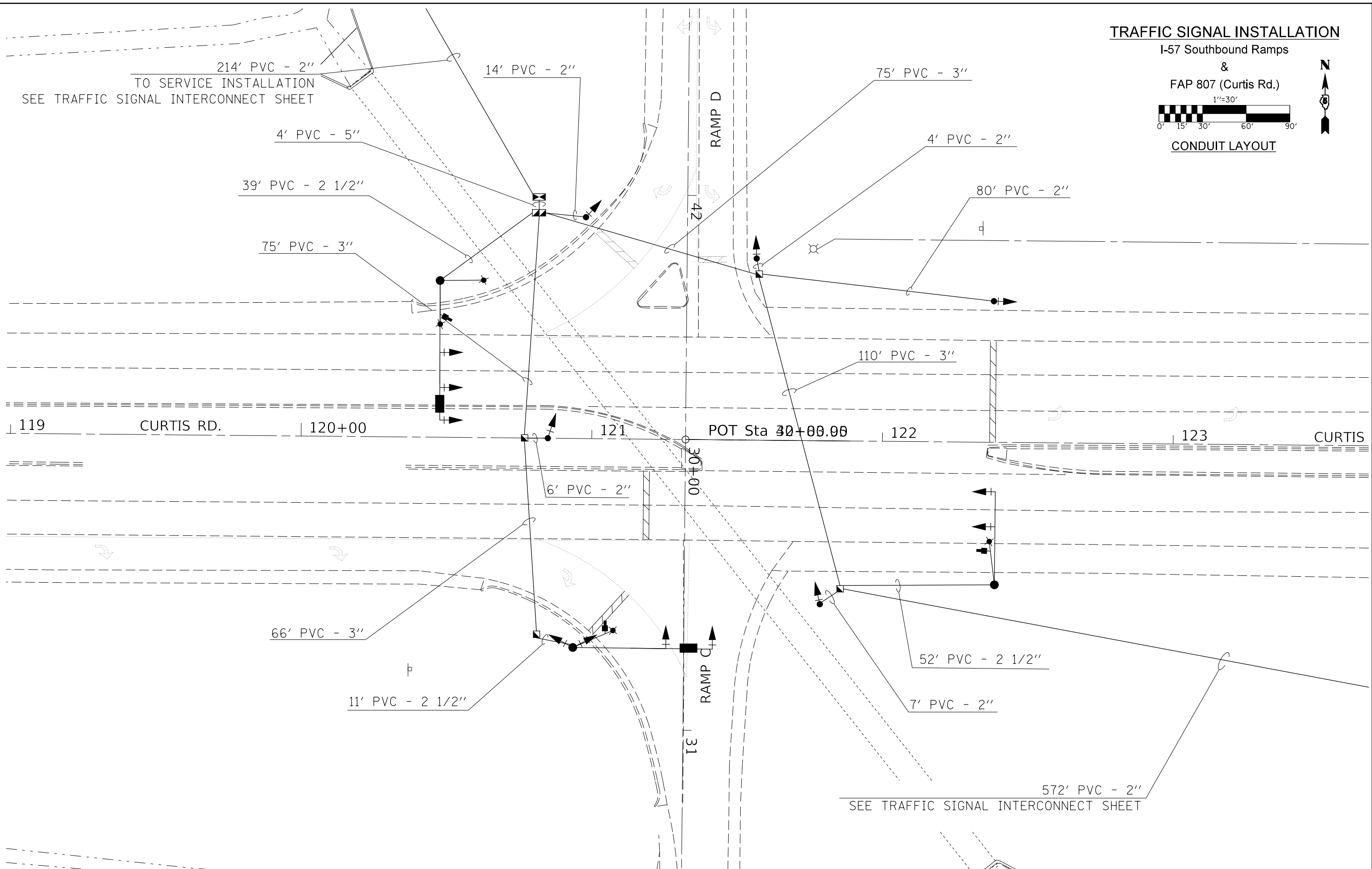

MODEL: \\MODELNAME
 FILE: \\NAME: \\path\to\file.dwg
 PROJECT: \\PROJECTNAME
 OFFICE: \\OFFICE
 DATE: 4/8/2020

USER NAME = biggsrd	DESIGNED - _____	REVISED - _____
DRAWN - _____	REVISOR - _____	REVISOR - _____
PLOT SCALE = 30.0000' / in.	CHECKED - _____	REVISOR - _____
PLOT DATE = 4/8/2020	DATE - _____	REVISOR - _____

**STATE OF ILLINOIS
DEPARTMENT OF TRANSPORTATION**

**I-57 SB RAMPS & CURTIS RD.
CONDUIT LAYOUT**

SCALE: 1" = 30' SHEET 1 OF 1 SHEETS STA. _____ TO STA. _____

F.A.I. RTE.	SECTION	COUNTY	TOTAL SHEETS	SHEET NO.
57	(10-32HB-3)TS	CHAMPAIGN	16	8
CONTRACT NO. 70E69			ILLINOIS FED. AID PROJECT	

TRAFFIC SIGNAL INSTALLATION

I-57 Southbound Ramps
&
FAP 807 (Curtis Rd.)

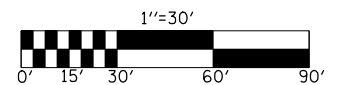

CABLE LAYOUT

1 No. 6 2C, Service; 1 No. 6 1C, Ground
See Traffic Signal Interconnect sheet

9 No. 14 5C, Signal; 2 No. 14 7C, Signal;
2 No. 10 1C, XLP; 3 Cat. 5 Ethernet;
1 No. 14 1C, Tracer; 1 No. 6 1C, XLP

1 No. 14 5C, Signal; 1 No. 14 7C, Signal;
2 No. 10 1C, XLP; 1 Cat. 5 Ethernet;
1 No. 6 1C, Ground

1 No. 14 5C, Signal; 1 No. 6 1C, Ground

4 No. 14 5C, Signal; 2 No. 10 1C, XLP;
1 Cat. 5 Ethernet; 1 No. 6 1C, Ground;
FO 12F SM; 1 No. 14 1C, Tracer

1 No. 14 5C, Signal; 1 No. 6 1C, Ground

1 No. 14 5C, Signal; 1 No. 6 1C, Ground

2 No. 14 5C, Signal; 2 No. 10 1C, XLP;
1 Cat. 5 Ethernet; 1 No. 6 1C, Ground;
FO 12F SM; 1 No. 14 1C, Tracer

119 CURTIS RD. 120+00 121 POT Sta 30+00.00 122 123 CURTIS

3 No. 14 5C, Signal; 1 No. 14 7C, Signal;
2 No. 10 1C, XLP; 1 Cat. 5 Ethernet;
1 No. 6 1C, Ground

2 No. 14 5C, Signal; 1 No. 14 7C, Signal;
2 No. 10 1C, XLP; 1 Cat. 5 Ethernet;
1 No. 6 1C, Ground

1 No. 14 5C, Signal; 2 No. 10 1C, XLP;
1 Cat. 5 Ethernet; 1 No. 6 1C, Ground

1 No. 14 5C, Signal; 1 No. 6 1C, Ground

2 No. 14 5C, Signal; 1 No. 14 7C, Signal;
2 No. 10 1C, XLP; 1 Cat. 5 Ethernet;
1 No. 6 1C, Ground

1 FO 12F SM; 1 No. 14 1C, Tracer;
2 No. 10 1C, XLP;
See Traffic Signal Interconnect sheet

MODEL: \\MODELNAME
FILE: \\NAME: \\path\name.dwg
PROJECT: \\PROJECTNAME
OFFICE: \\OFFICE
DATE: 4/8/2020

USER NAME = biggsrd	DESIGNED - _____	REVISED - _____
DRAWN - _____	REVISIONS - _____	REVISIONS - _____
PLOT SCALE = 30.0000' / in.	CHECKED - _____	REVISIONS - _____
PLOT DATE = 4/8/2020	DATE - _____	REVISIONS - _____

**STATE OF ILLINOIS
DEPARTMENT OF TRANSPORTATION**

**I-57 SB RAMPS & CURTIS RD.
CABLE LAYOUT**
SCALE: 1" = 30' SHEET 1 OF 1 SHEETS STA. _____ TO STA. _____

F.A.I. RTE.	SECTION	COUNTY	TOTAL SHEETS	SHEET NO.
57	(10-32HB-3)TS	CHAMPAIGN	16	9
CONTRACT NO. 70E69			ILLINOIS FED. AID PROJECT	

PHASE DESIGNATION DIAGRAM

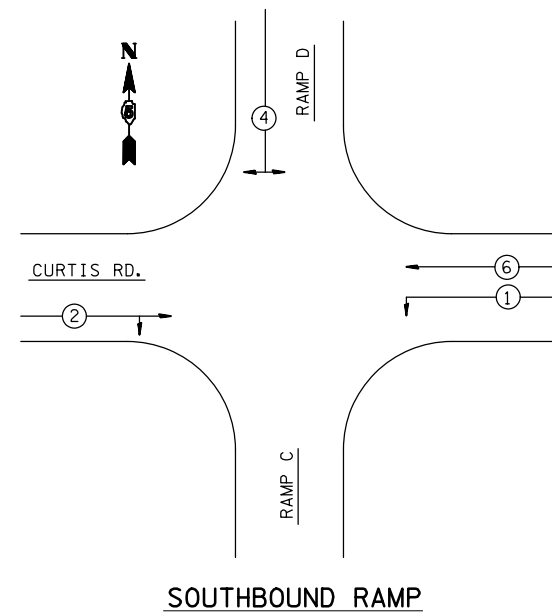

SCHEDULES - SB RAMPS

<u>81400100 HANDHOLE</u>	<u>87702890 STEEL COMBINATION MAST ARM ASSEMBLY AND POLE 32 FT.</u>
Sta. 120+77.9; CL 1.0 EACH	Sta. 121+78.9; 56.2' RT.
Sta. 120+81.6; 67.5' RT. 1.0 EACH	
Sta. 121+57.0; 57.0' LT. 1.0 EACH	<u>87702970 STEEL COMBINATION MAST ARM ASSEMBLY AND POLE 42 FT.</u>
Sta. 121+85.8; 50.9' RT. 1.0 EACH	Sta. 120+47.3; 53.9' LT.
Sta. 121+75.6; 65.9' LT. 1.0 EACH	Sta. 120+94.1; 71.9' RT.
Total = 5.0 EACH	
<u>87502660 TRAFFIC SIGNAL POST, ALUMINUM 12 FT.</u>	<u>X1400353 STEEL COMBINATION MAST ARM ASSEMBLY AND POLE 48 FT. WITH DUAL 15 FT. LIGHTING ARM AT 40 FT. MOUNTING HEIGHT</u>
<u>87800100 CONCRETE FOUNDATION, TY. A</u>	Sta. 120+47.3; 53.9' LT.
Sta. 120+85.6; CL 1.0 EACH	
Sta. 120+97.3; 75.1 LT. 1.0 EACH	<u>84200500 REMOVAL OF LIGHTING UNIT, SALVAGE</u>
Sta. 121+56.2; 62.4' LT. 1.0 EACH	<u>84200804 REMOVAL OF POLE FOUNDATION</u>
Sta. 121+78.9; 56.2' RT. 1.0 EACH	Sta. 121+75.6; 65.9' LT.
Sta. 122+37.8; 48.5' LT. 1.0 EACH	
Total = 5.0 EACH	
<u>87800415 CONCRETE FOUNDATION, TYPE E 36-INCH DIA.</u>	<u>87800150 CONCRETE FOUNDATION, TYPE C</u>
Sta. 120+47.3; 53.9' LT. 13.0 FEET	Sta. 120+81.1; 83.0' LT.
Sta. 120+94.1; 71.9' RT. 13.0 FEET	
Sta. 121+78.9; 56.2' RT. 11.0 FEET	
Total = 37.0 FEET	

BILL OF MATERIALS
I-57 SOUTHBOUND RAMPS & CURTIS RD.

ITEM	UNITS	QUANTITY
SERVICE INSTALLATION, TYPE A	EACH	1
UNDERGROUND CONDUIT, PVC, 2" DIA.	FOOT	325
UNDERGROUND CONDUIT, PVC, 2 1/2" DIA.	FOOT	102
UNDERGROUND CONDUIT, PVC, 3" DIA.	FOOT	326
UNDERGROUND CONDUIT, PVC, 5" DIA.	FOOT	4
HANDHOLE	EACH	4
DOUBLE HANDHOLE	EACH	1
ELECTRIC CABLE IN CONDUIT, 600V (XLP-TYPE USE) 1/C NO. 10	FOOT	1304
LUMINAIRE, LED, ROADWAY, OUTPUT DESIGNATION H	EACH	4
REMOVAL OF LIGHTING UNIT, SALVAGE	EACH	1
REMOVAL OF POLE FOUNDATION	EACH	1
PAINT NEW TRAFFIC SIGNAL POST	EACH	5
PAINT NEW COMBINATION MAST ARM AND POLE, UNDER 40 FOOT	EACH	1
PAINT NEW COMBINATION MAST ARM AND POLE, 40 FOOT AND OVER	EACH	2
FULL-ACTUATED CONTROLLER AND TYPE V CABINET	EACH	1
UNINTERRUPTABLE POWER SUPPLY, STANDARD	EACH	1
ELECTRIC CABLE IN CONDUIT, SIGNAL NO. 14 5C	FOOT	1790
ELECTRIC CABLE IN CONDUIT, SIGNAL NO. 14 7C	FOOT	336
ELECTRIC CABLE IN CONDUIT, SERVICE NO. 6 2C	FOOT	231
ELECTRIC CABLE IN CONDUIT, EQUIPMENT GROUNDING CONDUCTOR, NO. 6 1C	FOOT	951
TRAFFIC SIGNAL POST, ALUMINUM 12 FT.	EACH	5
STEEL COMBINATION MAST ARM ASSEMBLY AND POLE 32 FT.	EACH	1
STEEL COMBINATION MAST ARM ASSEMBLY AND POLE 48 FT.	EACH	1
CONCRETE FOUNDATION, TYPE A	FOOT	15.5
CONCRETE FOUNDATION, TYPE C	FOOT	3.5
CONCRETE FOUNDATION, TYPE E 36-INCH DIAMETER	FOOT	37
SIGNAL HEAD, LED, 1-FACE, 3-SECTION, MAST-ARM MOUNTED	EACH	6
SIGNAL HEAD, LED, 1-FACE, 3-SECTION, BRACKET MOUNTED	EACH	5
SIGNAL HEAD, LED, 1-FACE, 4-SECTION, MAST ARM MOUNTED	EACH	1
SIGNAL HEAD, LED, 2-FACE, 1-3 SECTION, 1-4 SECTION, BRACKET MOUNTED	EACH	1
TRAFFIC SIGNAL BACKPLATE, RETROREFLECTIVE	EACH	14
ETHERNET SWITCH	EACH	1
CAT 5 ETHERNET CABLE	FOOT	674
WOOD POLE, 25 FT, CLASS 4	EACH	1
STEEL COMBINATION MAST ARM ASSEMBLY AND POLE 48 FT. WITH DUAL 15 FT. LIGHTING ARM AT 40 FT. MOUNTING HEIGHT	EACH	1
VIDEO DETECTION SYSTEM COMPLETE	EACH	1
EMERGENCY VEHICLE PRIORITY SYSTEM	EACH	1

MODEL: I:\MODEL\NAME: FILE: NAME: P:\pub\mcom\mdata\illinois\pwr\pwr\DOT\Documents\DOT Office\Bldg\I-57\Projects\I-57\70E69\sb-rt-draw.dgn

STATE OF ILLINOIS
DEPARTMENT OF TRANSPORTATION

I-57 SB RAMPS & CURTIS RD.
PHASE DESIGNATION DIAGRAM, BILL OF MATERIALS, SCHEDULES

SCALE: SHEET 1 OF 1 SHEETS STA. TO STA.

F.A.I. RTE.	SECTION	COUNTY	TOTAL SHEETS	SHEET NO.
57	(10-32HB-3)TS	CHAMPAIGN	16	10
			CONTRACT NO. 70E69	
		ILLINOIS FED. AID PROJECT		

TRAFFIC SIGNAL INSTALLATION

I-57 Northbound Ramps
&
FAP 807 (Curtis Rd.)

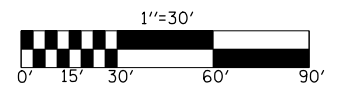

SIGNAL LAYOUT

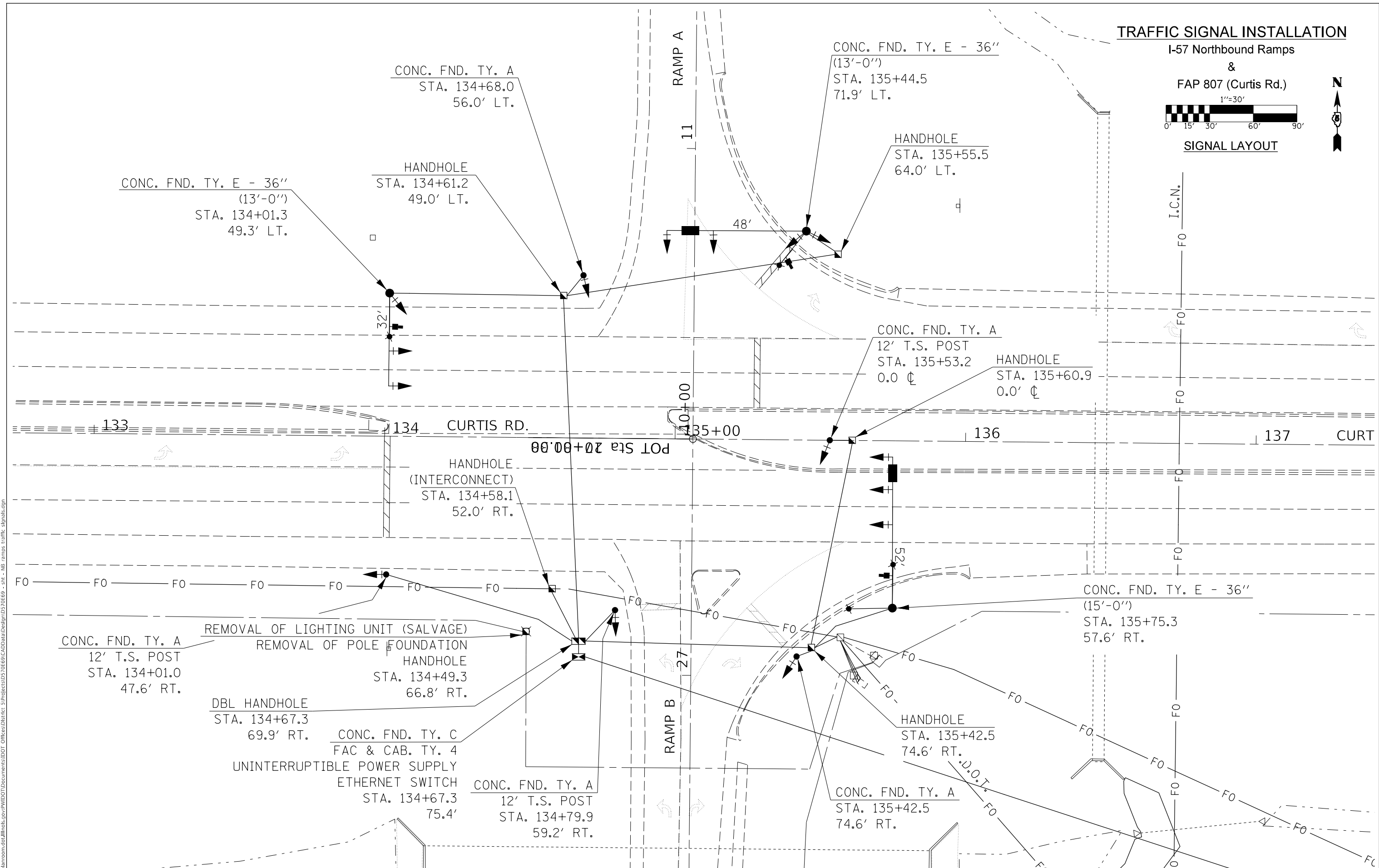

MODEL: \\MODELNAME
 FILE: \\NAME: \\path\to\file.dwg
 PROJECT: \\PROJECTNAME
 OFFICE: \\OFFICE
 DATE: 4/8/2020

USER NAME = biggsrd	DESIGNED - _____	REVISED - _____
	DRAWN - _____	REVISED - _____
PLOT SCALE = 30.0000 "/td> <td>CHECKED - _____</td> <td>REVISED - _____</td>	CHECKED - _____	REVISED - _____
PLOT DATE = 4/8/2020	DATE - _____	REVISED - _____

STATE OF ILLINOIS
DEPARTMENT OF TRANSPORTATION

I-57 NB RAMPS & CURTIS RD.
TRAFFIC SIGNAL LAYOUT

SCALE: 1" = 30' SHEET 1 OF 1 SHEETS STA. _____ TO STA. _____

F.A.I. RTE.	SECTION	COUNTY	TOTAL SHEETS	SHEET NO.
57	(10-32HB-3)TS	CHAMPAIGN	16	11
ILLINOIS FED. AID PROJECT			CONTRACT NO. 70E69	

TRAFFIC SIGNAL INSTALLATION

I-57 Northbound Ramps
&
FAP 807 (Curtis Rd.)

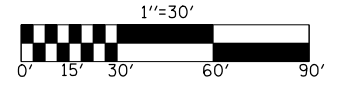

CONDUIT LAYOUT

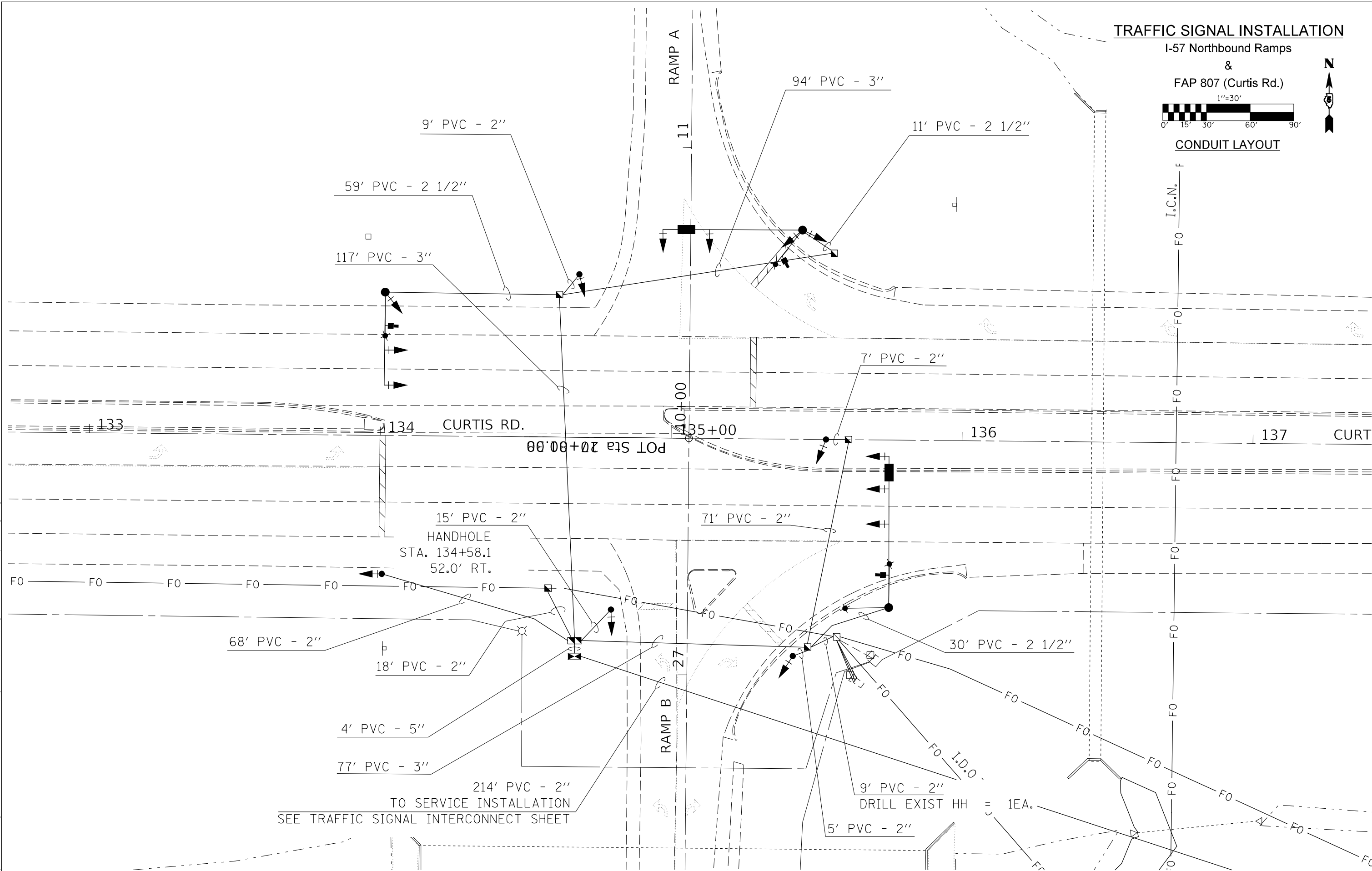

214' PVC - 2"
TO SERVICE INSTALLATION
SEE TRAFFIC SIGNAL INTERCONNECT SHEET

MODEL: s:\MODELNAME
 FILE: name.pwd\pwwdot\documents\dot_office\diagram\5\projects\0570669_sht_-_nb_ramps_traffic_signals.dgn

USER NAME = biggsrd	DESIGNED - _____	REVISED - _____
PLOT SCALE = 30.0000' / in.	DRAWN - _____	REVISED - _____
PLOT DATE = 4/8/2020	CHECKED - _____	REVISED - _____
	DATE - _____	REVISED - _____

STATE OF ILLINOIS
DEPARTMENT OF TRANSPORTATION

I-57 NB RAMPS & CURTIS RD.
CONDUIT LAYOUT

SCALE: 1" = 30' SHEET 1 OF 1 SHEETS STA. _____ TO STA. _____

F.A.I. RTE.	SECTION	COUNTY	TOTAL SHEETS	SHEET NO.
57	(10-32HB-3)TS	CHAMPAIGN	16	12
CONTRACT NO. 70E69				
ILLINOIS FED. AID PROJECT				

TRAFFIC SIGNAL INSTALLATION

I-57 Northbound Ramps
&
FAP 807 (Curtis Rd.)

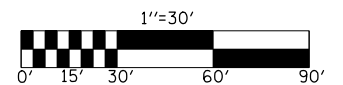

CABLE LAYOUT

2 No. 14 5C, Signal; 1 No. 14 7C, Signal;
2 No. 10 1C, XLP; Cat. 5 Ethernet;
1 No. 6 1C, Ground

1 No. 14 5C, Signal; 1 No. 6 1C, Ground

2 No. 14 5C, Signal; 2 No. 10 1C, XLP;
1 Cat. 5 Ethernet; 1 No. 6 1C, Ground

5 No. 14 5C, Signal; 1 No. 14 7C, Signal;
2 No. 10 1C, XLP; 2 Cat. 5 Ethernet;
1 No. 6 1C, Ground

2 No. 14 5C, Signal; 1 No. 14 7C, Signal;
2 No. 10 1C, XLP; Cat. 5 Ethernet;
1 No. 6 1C, Ground

1 No. 14 5C, Signal; 1 No. 6 1C, Ground

1 No. 14 5C, Signal; 1 No. 6 1C, Ground

1 No. 14 5C, Signal; 1 No. 6 1C, Ground

9 No. 14 5C, Signal; 2 No. 14 7C, Signal;
2 No. 10 1C, XLP; 3 Cat. 5 Ethernet;
1 No. 6 1C, Ground

1 No. 14 5C, Signal; 1 No. 14 7C, Signal;
2 No. 10 1C, XLP; 1 Cat. 5 Ethernet;
1 No. 6 1C, Ground

1 No. 14 5C, Signal; 1 No. 6 1C, Ground

2 No. 14 5C, Signal; 1 No. 14 7C, Signal;
2 No. 10 1C, XLP; 1 Cat. 5 Ethernet;
1 No. 6 1C, Ground

1 No. 6, Service 2C; 1 No. 6 Ground 1C

MODEL: \\MODELNAME
FILE: \\NAME; PROJECT: \\PROJECTNAME; OFFICE: \\OFFICE; DATE: 4/8/2020

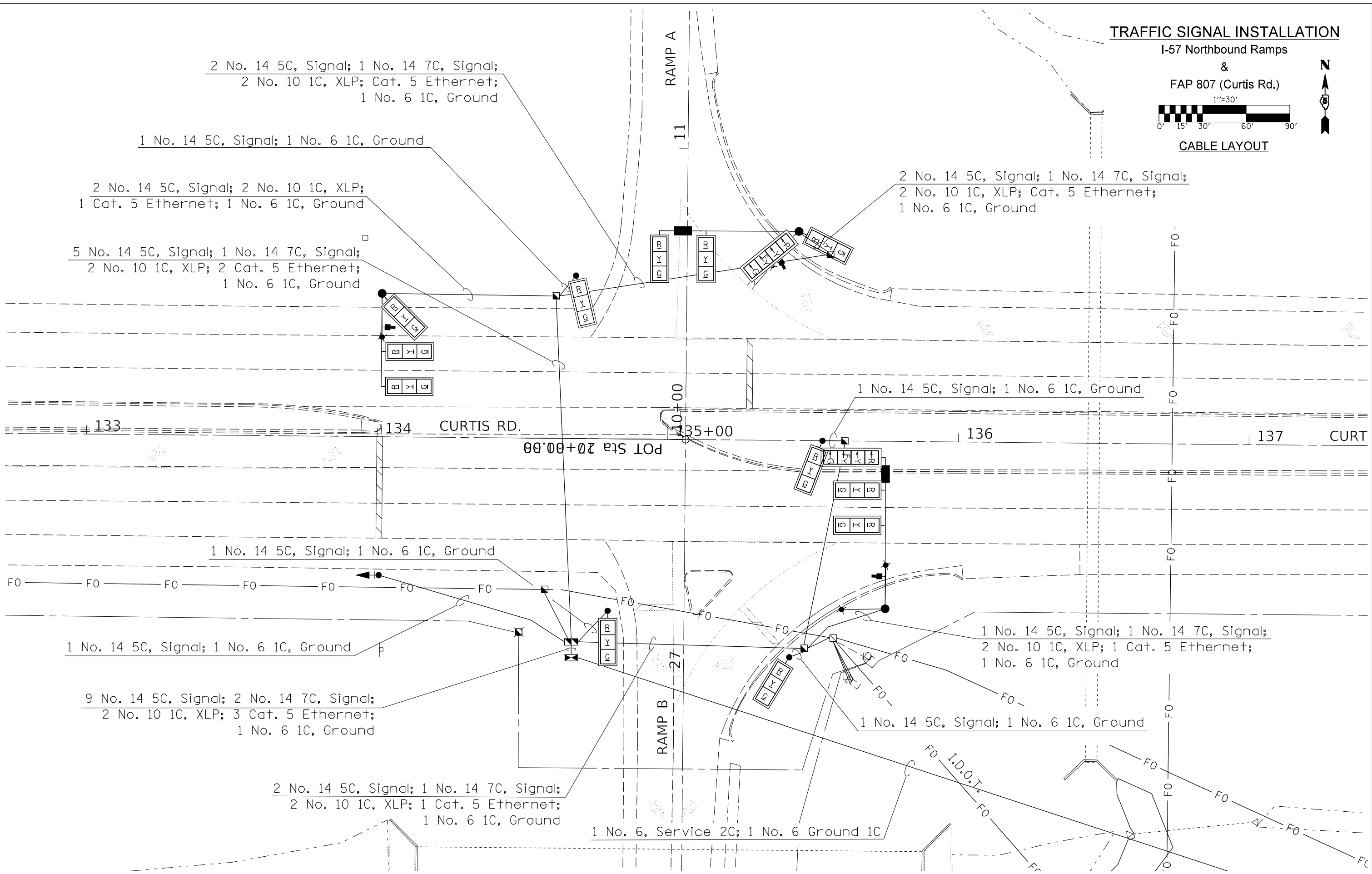

USER NAME = biggsrd	DESIGNED - _____	REVISED - _____
	DRAWN - _____	REVISED - _____
PLOT SCALE = 30,0000 ' / in.	CHECKED - _____	REVISED - _____
PLOT DATE = 4/8/2020	DATE - _____	REVISED - _____

**STATE OF ILLINOIS
DEPARTMENT OF TRANSPORTATION**

I-57 NB RAMPS & CURTIS RD. CABLE LAYOUT	
SCALE: _____	SHEET _____ OF _____ SHEETS
STA. _____	TO STA. _____

F.A.I. RTE.	SECTION	COUNTY	TOTAL SHEETS	SHEET NO.
57	(10-32HB-3)TS	CHAMPAIGN	16	13
CONTRACT NO. 70E69				
ILLINOIS FED. AID PROJECT				

PHASE DESIGNATION DIAGRAM

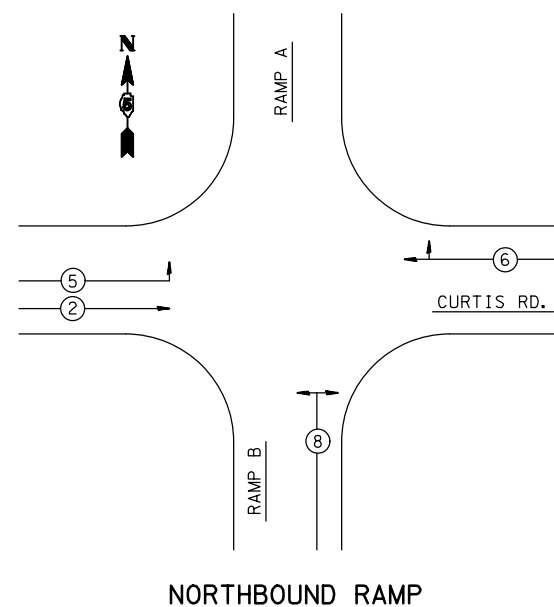

SCHEDULES - NB RAMPS

<u>81400100</u> HANDHOLE	<u>87702890</u> STEEL COMBINATION MAST ARM ASSEMBLY AND POLE 32 FT.
Sta. 134+61.2; 49.0' LT. 1.0 EACH	Sta. 134+01.3; 49.3' LT. 1.0 EACH
Sta. 135+42.5; 74.6' RT. 1.0 EACH	
Sta. 135+55.5; 64.0' LT. 1.0 EACH	<u>87702970</u> STEEL COMBINATION MAST ARM ASSEMBLY AND POLE 42 FT.
Sta. 135+60.9; 0.0 CL 1.0 EACH	Sta. 135+44.5; 71.9' LT. 1.0 EACH
Sta. 134+49.3; 66.8' RT. 1.0 EACH	
TOTAL = 5.0 EACH	
<u>87502660</u> TRAFFIC SIGNAL POST, ALUMINUM 12 FT.	STEEL COMBINATION MAST ARM ASSEMBLY AND POLE 52 FT. WITH DUAL
<u>87800100</u> CONCRETE FOUNDATION, TY. A	15 FT. LIGHTING ARM AT 40 FT. MOUNTING HEIGHT
Sta. 134+01.0; 47.6' RT. 1.0 EACH	Sta. 135+75.3; 57.6' RT.
Sta. 134+68.0; 56.0' LT. 1.0 EACH	
Sta. 134+79.9; 59.2' RT. 1.0 EACH	<u>84200500</u> REMOVAL OF LIGHTING UNIT, SALVAGE
Sta. 135+42.5; 74.5' RT. 1.0 EACH	<u>84200804</u> REMOVAL OF POLE FOUNDATION
Sta. 135+53.2; 0.0' CL 1.0 EACH	Sta. 134+49.3; 66.8' LT. 1.0 EACH
TOTAL = 5.0 EACH	
<u>87800415</u> CONCRETE FOUNDATION, TYPE E 36-INCH DIA.	<u>87800150</u> CONCRETE FOUNDATION, TYPE C
Sta. 134+01.3; 49.3' LT. 11.0 FEET	Sta. 134+67.3; 75.4' LT. 3.5' FEET
Sta. 135+44.5; 71.9' LT. 13.0 FEET	
Sta. 135+75.3; 57.6' RT. 15.0 FEET	
TOTAL = 39.0 FEET	

BILL OF MATERIALS

I-57 NORTHBOUND RAMPS & CURTIS RD.

ITEM	UNITS	QUANTITY
SERVICE INSTALLATION, TYPE A	EACH	1.0
UNDERGROUND CONDUIT, PVC, 2" DIA.	FOOT	459.0
UNDERGROUND CONDUIT, PVC, 2 1/2" DIA.	FOOT	100.0
UNDERGROUND CONDUIT, PVC, 3" DIA.	FOOT	288.0
UNDERGROUND CONDUIT, PVC, 5" DIA.	FOOT	4.0
HANDHOLE	EACH	5.0
DOUBLE HANDHOLE	EACH	1.0
ELECTRIC CABLE IN CONDUIT, 600V (XLP-TYPE USE) 1/C NO. 10	FOOT	1326.0
LUMINAIRE, LED, ROADWAY, OUTPUT DESIGNATION H	EACH	4.0
REMOVAL OF LIGHTING UNIT, SALVAGE	EACH	1.0
REMOVAL OF POLE FOUNDATION	EACH	1.0
PAINT NEW TRAFFIC SIGNAL POST	EACH	5.0
PAINT NEW COMBINATION MAST ARM AND POLE, UNDER 40 FOOT	EACH	1.0
PAINT NEW COMBINATION MAST ARM AND POLE, 40 FOOT AND OVER	EACH	2.0
FULL-ACTUATED CONTROLLER AND TYPE V CABINET	EACH	1.0
UNINTERRUPTABLE POWER SUPPLY, STANDARD	EACH	1.0
ELECTRIC CABLE IN CONDUIT, SIGNAL NO. 14 5C	FOOT	1965.0
ELECTRIC CABLE IN CONDUIT, SIGNAL NO. 14 7C	FOOT	492.0
ELECTRIC CABLE IN CONDUIT, SERVICE, NO. 6 2 C	FOOT	301.0
ELECTRIC CABLE IN CONDUIT, EQUIPMENT GROUNDING CONDUCTOR, NO. 6 1C	FOOT	936.0
TRAFFIC SIGNAL POST, ALUMINUM 12 FT.	EACH	5.0
STEEL COMBINATION MAST ARM ASSEMBLY AND POLE 32 FT.	EACH	1.0
STEEL COMBINATION MAST ARM ASSEMBLY AND POLE 48 FT.	EACH	1.0
CONCRETE FOUNDATION, TYPE A	FOOT	15.5
CONCRETE FOUNDATION, TYPE C	FOOT	3.5
CONCRETE FOUNDATION, TYPE E 36-INCH DIAMETER	FOOT	39.0
DRILL EXISTING HANDHOLE	EACH	1.0
SIGNAL HEAD, LED, 1-FACE, 3-SECTION, MAST-ARM MOUNTED	EACH	6.0
SIGNAL HEAD, LED, 1-FACE, 3-SECTION, BRACKET MOUNTED	EACH	5.0
SIGNAL HEAD, LED, 1-FACE, 4-SECTION, MAST ARM MOUNTED	EACH	1.0
SIGNAL HEAD, LED, 2-FACE, 1-3 SECTION, 1-4 SECTION, BRACKET MOUNTED	EACH	1.0
TRAFFIC SIGNAL BACKPLATE, RETROREFLECTIVE	EACH	14.0
ETHERNET SWITCH	EACH	1.0
CAT 5 ETHERNET CABLE	FOOT	786.0
WOOD POLE, 25 FT, CLASS 4	EACH	1.0
STEEL COMBINATION MAST ARM ASSEMBLY AND POLE 52 FT. WITH DUAL	EACH	1.0
15 FT. LIGHTING ARM AT 40 FT. MOUNTING HEIGHT		
VIDEO DETECTION SYSTEM COMPLETE	EACH	1.0
EMERGENCY VEHICLE PRIORITY SYSTEM	EACH	1.0

STATE OF ILLINOIS
DEPARTMENT OF TRANSPORTATION

I-57 NB RAMPS & CURTIS RD.
PHASE DESIGNATION DIAGRAM, BILL OF MATERIALS, SCHEDULES

F.A.I. RTE.	SECTION	COUNTY	TOTAL SHEETS	SHEET NO.
57	(10-32HB-3)TS	CHAMPAIGN	16	14
CONTRACT NO. 70E69				
ILLINOIS		FED. AID PROJECT		

SCALE: SHEET OF SHEETS STA. TO STA.

MODEL: I:\MODEL\MHFS
FILE: MHFS_Plan\I57NB\I57NB.dwg
PROJECT: I57 NB RAMP
DATE: 4/8/2020

USER NAME = biggsrd	DESIGNED -	REVISED -
PLOT SCALE = 40,0000 ' / in.	DRAWN -	REVISED -
PLOT DATE = 4/8/2020	CHECKED -	REVISED -
	DATE -	REVISED -

TRAFFIC SIGNAL INTERCONNECT

I-57 NB & SB Ramps

@

FAP 807 (Curtis Rd.)

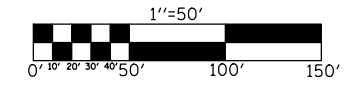

CONDUIT & CABLE LAYOUT

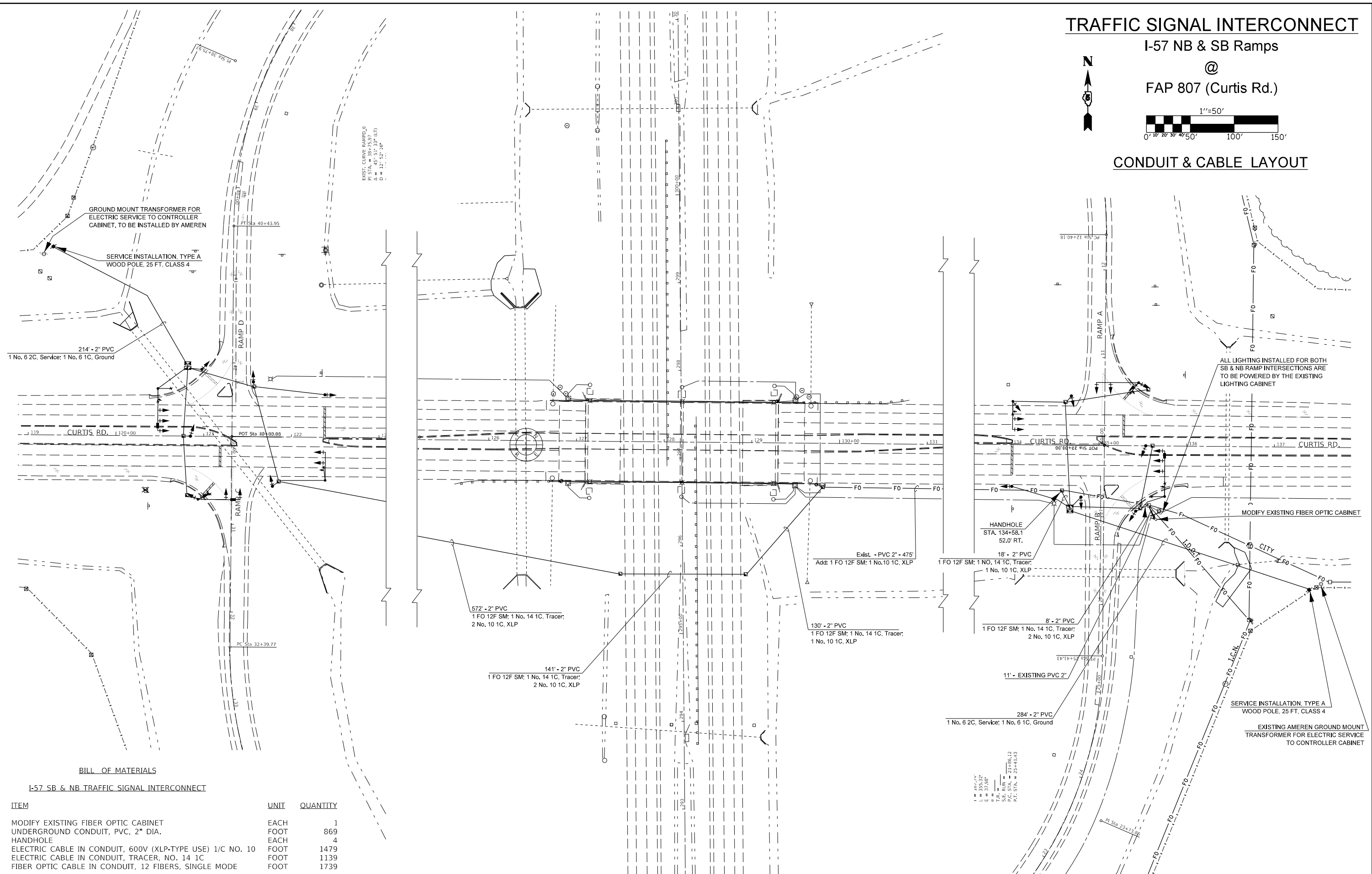

BILL OF MATERIALS

I-57 SB & NB TRAFFIC SIGNAL INTERCONNECT

ITEM	UNIT	QUANTITY
MODIFY EXISTING FIBER OPTIC CABINET	EACH	1
UNDERGROUND CONDUIT, PVC, 2" DIA.	FOOT	869
HANDHOLE	EACH	4
ELECTRIC CABLE IN CONDUIT, 600V (XLP-TYPE USE) 1/C NO. 10	FOOT	1479
ELECTRIC CABLE IN CONDUIT, TRACER, NO. 14 1C	FOOT	1139
FIBER OPTIC CABLE IN CONDUIT, 12 FIBERS, SINGLE MODE	FOOT	1739

MODEL: \\MODELNAME
 FILE NAME: \\path\to\file.dwg
 PROJECT: I-57 SB & NB TRAFFIC SIGNAL INTERCONNECT

USER NAME = biggsrd	DESIGNED -	REVISED -
	DRAWN -	REVISED -
PLOT SCALE = 100.0000' / in.	CHECKED -	REVISED -
PLOT DATE = 4/8/2020	DATE -	REVISED -

**STATE OF ILLINOIS
DEPARTMENT OF TRANSPORTATION**

I-57 SB & NB RAMPS AT CURTIS RD. TRAFFIC SIGNAL INTERCONNECT			
SCALE: 1" = 50'	SHEET 1	OF 1 SHEETS	STA. _____ TO STA. _____

F.A.I. RTE.	SECTION	COUNTY	TOTAL SHEETS	SHEET NO.
57	(10-32HB-3)T5	CHAMPAIGN	16	15
ILLINOIS FED. AID PROJECT			CONTRACT NO. 70E69	

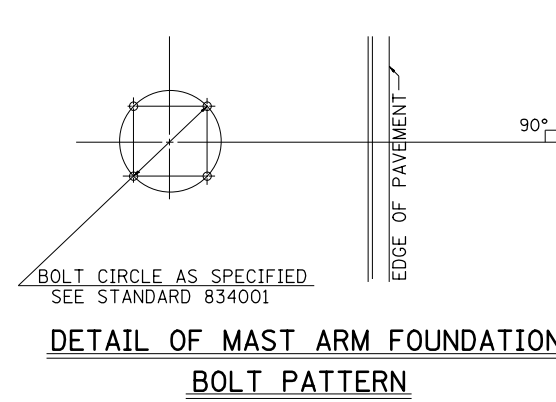

VIDEO CAMERA MOUNTING DETAIL

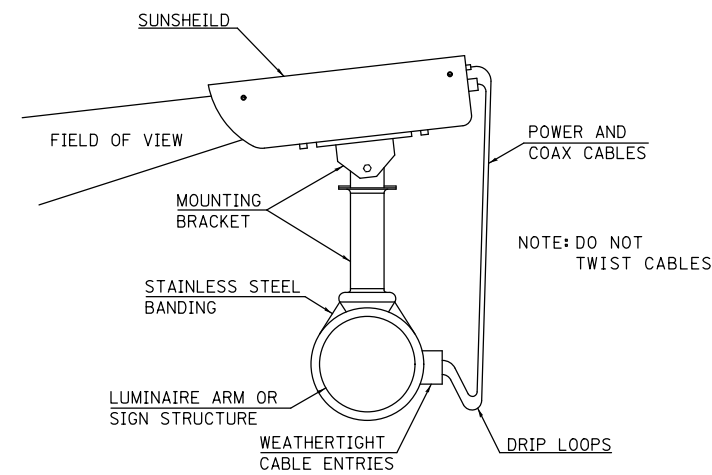

MAST ARM DAMPENING DEVICE MOUNTING DETAIL

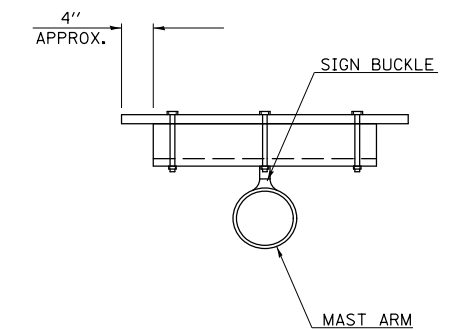
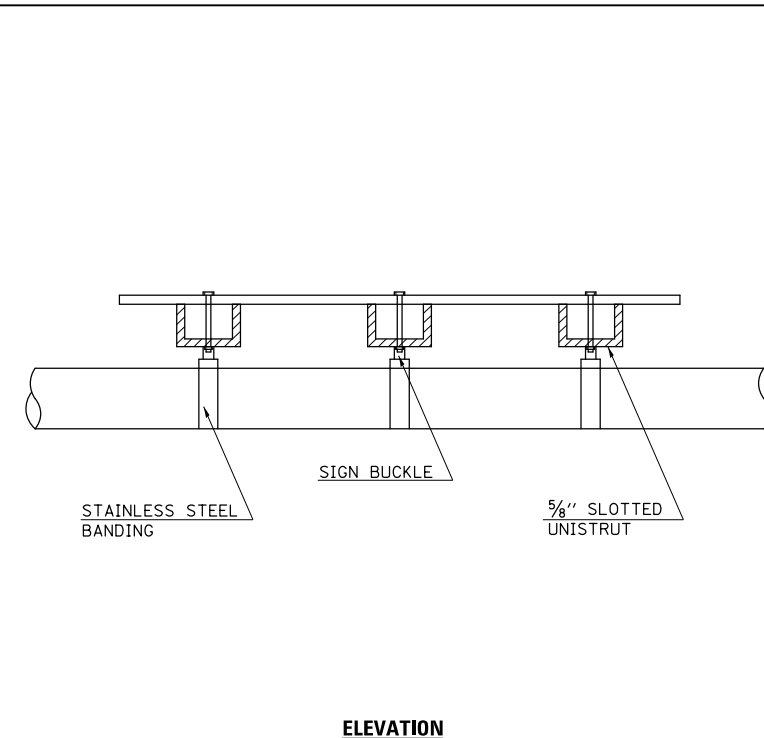
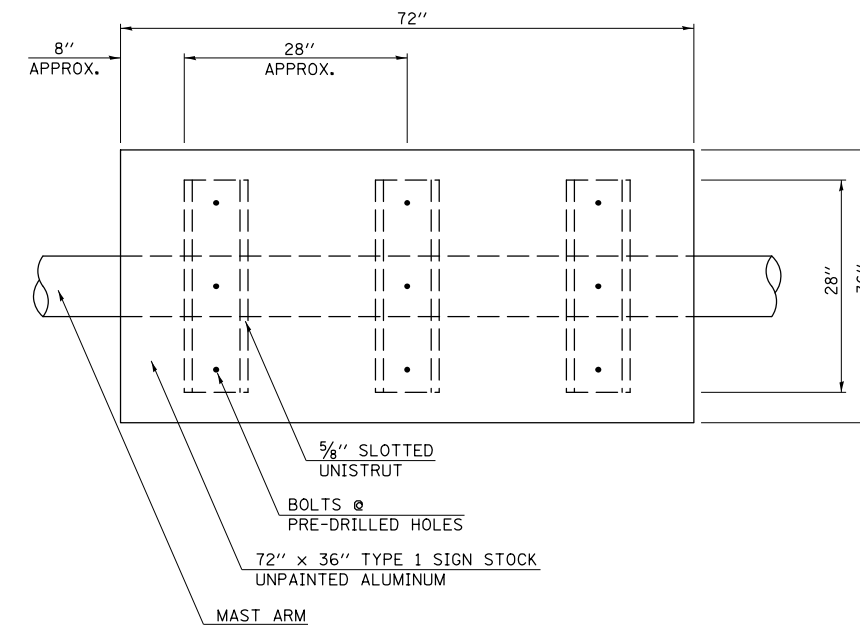

NOTE: PAINT ENDS OF UNISTRUT WITH SPRAY ON GALVANIZED PAINT

MODEL: \$MODEL\$
 FILE NAME: p:\3\blabroom\ad\illmat\pwp\p\DDOT\Documents\DOT_Offices\District_5\Projects\DS70E69\CADD\CAD\Drawings\DS70E69-ah-Detail.dwg

USER NAME = biggsrd	DESIGNED -	REVISED -
	DRAWN -	REVISED -
PLOT SCALE = 40.1767 ' / In.	CHECKED -	REVISED -
PLOT DATE = 4/1/2020	DATE -	REVISED -

**STATE OF ILLINOIS
DEPARTMENT OF TRANSPORTATION**

DETAILS				
SCALE: NONE	SHEET	OF	SHEETS	STA. TO STA.

F.A.I. RTE. 57	SECTION (10-32HB-3)TS	COUNTY CHAMPAIGN	TOTAL SHEETS 16	SHEET NO. 16
CONTRACT NO. 70E69				
ILLINOIS FED. AID PROJECT				