

| CODE NO. | ITEM | UNIT | TOTAL QUANTITY | CONSTRUCTION CODE | | |
|----------|--|-------|----------------|-------------------|------------|--|
| | | | | 80 / 20 | 50 / 50 | |
| | | | | FED/STATE | CITY/STATE | |
| | | | | ROADWAY | ROADWAY | |
| | | | | 0005 | 0005 | |
| | | | | RURAL | RURAL | |
| 20300100 | CHANNEL EXCAVATION | CU YD | 20 | 20 | | |
| 20800150 | TRENCH BACKFILL | CU YD | 364 | 364 | | |
| 28100109 | STONE RIPRAP, CLASS A5 | SQ YD | 677 | 677 | | |
| 28200200 | FILTER FABRIC | SQ YD | 833 | 833 | | |
| 31100910 | SUBBASE GRANULAR MATERIAL, TYPE A 12" | SQ YD | 264 | 264 | | |
| 31101000 | SUBBASE GRANULAR MATERIAL, TYPE B | TON | 15 | 15 | | |
| 40600275 | BITUMINOUS MATERIALS (PRIME COAT) | POUND | 594 | 594 | | |
| 40600290 | BITUMINOUS MATERIALS (TACK COAT) | POUND | 110166 | 108298 | 1868 | |
| 40600982 | HOT-MIX ASPHALT SURFACE REMOVAL - BUTT JOINT | SQ YD | 98 | 98 | | |
| 40600985 | PORTLAND CEMENT CONCRETE SURFACE REMOVAL - BUTT JOINT | SQ YD | 5 | 5 | | |
| 40600990 | TEMPORARY RAMP | SQ YD | 1007 | 1007 | | |
| 40603085 | HOT-MIX ASPHALT BINDER COURSE, IL-19.0, N70 | TON | 13479 | 13479 | | |
| 40604062 | HOT-MIX ASPHALT SURFACE COURSE, IL-9.5, MIX "D", N70 | TON | 7817 | 7352 | 465 | |
| 40604162 | POLYMERIZED HOT-MIX ASPHALT SURFACE COURSE, IL-9.5, MIX "D", N70 | TON | 1732 | 1732 | | |

| CODE NO. | ITEM | UNIT | TOTAL QUANTITY | CONSTRUCTION CODE | | |
|----------|---|-------|----------------|-------------------|------------|--|
| | | | | 80 / 20 | 50 / 50 | |
| | | | | FED/STATE | CITY/STATE | |
| | | | | ROADWAY | ROADWAY | |
| | | | | 0005 | 0005 | |
| | | | | RURAL | RURAL | |
| 40700100 | BITUMINOUS MATERIALS (TACK COAT) | POUND | 119 | 119 | | |
| 40701841 | HOT-MIX ASPHALT PAVEMENT (FULL-DEPTH), 8" | SQ YD | 264 | 264 | | |
| 42000400 | PORTLAND CEMENT CONCRETE PAVEMENT 9" | SQ YD | 64 | 64 | | |
| 42400100 | PORTLAND CEMENT CONCRETE SIDEWALK 4 INCH | SQ FT | 2204 | 2204 | | |
| 42400800 | DETECTABLE WARNINGS | SQ FT | 402 | 402 | | |
| 44000100 | PAVEMENT REMOVAL | SQ YD | 356 | 356 | | |
| 44000157 | HOT-MIX ASPHALT SURFACE REMOVAL, 2" | SQ YD | 4313 | 160 | 4153 | |
| 44000164 | HOT-MIX ASPHALT SURFACE REMOVAL, 3 3/4" | SQ YD | 158113 | 158113 | | |
| 44000200 | DRIVEWAY PAVEMENT REMOVAL | SQ YD | 17 | 17 | | |
| 44000300 | CURB REMOVAL | FOOT | 47 | 47 | | |
| 44000500 | COMBINATION CURB AND GUTTER REMOVAL | FOOT | 1105 | 1105 | | |
| 44000600 | SIDEWALK REMOVAL | SQ FT | 6523 | 6523 | | |
| 44003100 | MEDIAN REMOVAL | SQ FT | 710 | 710 | | |
| 44004250 | PAVED SHOULDER REMOVAL | SQ YD | 806.2 | 806.2 | | |

REV. 5-29-2020

| | | | |
|--|------------------------------|------------|-----------|
| FILE NAME = | USER NAME = FREIMUTHPD | DESIGNED - | REVISED - |
| 4:\plnroom.dot\illinois.gov\PIDOT\Documents\DOT Offices\District 8\Projects\0876J71\Drawings\CADsheets\0876J71-sh1-500.dgn | | REVISED - | REVISED - |
| | PLOT SCALE = 100.0000' / in. | CHECKED - | REVISED - |
| | PLOT DATE = 1/28/2020 | DATE - | REVISED - |

STATE OF ILLINOIS
DEPARTMENT OF TRANSPORTATION

SUMMARY OF QUANTITIES

SCALE: SHEET 1 OF 6 SHEETS STA. TO STA.

| | | | | |
|---------------------------|----------------|----------|--------------------|-----------|
| F.A.P. RTE. | SECTION | COUNTY | TOTAL SHEETS | SHEET NO. |
| 312 | (70,71,72)RS-4 | RANDOLPH | 102 | 3 |
| ILLINOIS FED. AID PROJECT | | | CONTRACT NO. 76J71 | |

| CODE NO. | ITEM | UNIT | TOTAL QUANTITY | CONSTRUCTION CODE | | |
|---------------------|--------------------------------------|------------------|----------------|-------------------|------------|--|
| | | | | 80 / 20 | 50 / 50 | |
| | | | | FED/STATE | CITY/STATE | |
| | | | | ROADWAY | ROADWAY | |
| | | | | 0005 | 0005 | |
| | | | | RURAL | RURAL | |
| 44200176 | PAVEMENT PATCHING, TYPE I, 15 INCH | SQ YD | 52.8 | 52.8 | | |
| 44200180 | PAVEMENT PATCHING, TYPE II, 15 INCH | SQ YD | 528 | 528 | | |
| 44200184 | PAVEMENT PATCHING, TYPE III, 15 INCH | SQ YD | 410.7 | 410.7 | | |
| 44200186 | PAVEMENT PATCHING, TYPE IV, 15 INCH | SQ YD | 781.3 | 781.3 | | |
| 48102100 | AGGREGATE WEDGE SHOULDER, TYPE B | TON | 2444 | 2444 | | |
| 48203029 | HOT-MIX ASPHALT SHOULDERS, 8" | SQ YD | 806.2 | 806.2 | | |
| 48203100 | HOT-MIX ASPHALT SHOULDERS | TON | 11108 | 11108 | | |
| 50100300 | REMOVAL OF EXISTING STRUCTURES NO. 1 | EACH | 1 | 1 | | |
| 50100400 | REMOVAL OF EXISTING STRUCTURES NO. 2 | EACH | 1 | 1 | | |
| 50100500 | REMOVAL OF EXISTING STRUCTURES NO. 3 | EACH | 1 | 1 | | |
| 50200100 | STRUCTURE EXCAVATION | CU YD | 399 | 399 | | |
| 50300225 | CONCRETE STRUCTURES | CU YD | 67 | 67 | | |
| 50800105 | REINFORCEMENT BARS | POUND | 120 | 120 | | |
| 50800205 | REINFORCEMENT BARS, EPOXY COATED | POUND | 4850 | 4850 | | |

| CODE NO. | ITEM | UNIT | TOTAL QUANTITY | CONSTRUCTION CODE | | |
|----------|---|-------|----------------|-------------------|------------|--|
| | | | | 80 / 20 | 50 / 50 | |
| | | | | FED/STATE | CITY/STATE | |
| | | | | ROADWAY | ROADWAY | |
| | | | | 0005 | 0005 | |
| | | | | RURAL | RURAL | |
| 50900805 | PEDESTRIAN RAILING | FOOT | 21 | 21 | | |
| 50901760 | PIPE HANDRAIL | FOOT | 131 | 131 | | |
| 52200900 | CONCRETE STRUCTURES (RETAINING WALL) | CU YD | 67 | 67 | | |
| 54213657 | PRECAST REINFORCED CONCRETE FLARED END SECTIONS 12" | EACH | 1 | 1 | | |
| 54248510 | CONCRETE COLLAR | CU YD | 1.5 | 1.5 | | |
| 550A0050 | STORM SEWERS, CLASS A, TYPE 1 12" | FOOT | 124.9 | 124.9 | | |
| 550A0090 | STORM SEWERS, CLASS A, TYPE 1 18" | FOOT | 43.8 | 43.8 | | |
| 550A0120 | STORM SEWERS, CLASS A, TYPE 1 24" | FOOT | 22.4 | 22.4 | | |
| 55100400 | STORM SEWER REMOVAL 10" | FOOT | 82 | 82 | | |
| 55100500 | STORM SEWER REMOVAL 12" | FOOT | 20 | 20 | | |
| 58600101 | GRANULAR BACKFILL FOR STRUCTURES | CU YD | 27.3 | 27.3 | | |
| 58700300 | CONCRETE SEALER | SQ FT | 662 | 662 | | |
| 59100100 | GEOCOMPOSITE WALL DRAIN | SQ YD | 10.7 | 10.7 | | |
| 60218400 | MANHOLES, TYPE A, 4'-DIAMETER, TYPE 1 FRAME, CLOSED LID | EACH | 1 | 1 | | |
| 60219200 | MANHOLES, TYPE A, 4'-DIAMETER, TYPE 10 FRAME AND GRATE | EACH | 1 | 1 | | |

| | | | |
|--|------------------------------|------------|-----------|
| FILE NAME = | USER NAME = FREIMUTHPD | DESIGNED - | REVISED - |
| p:\plnroom.dot\illinois.gov\IDOT\Documents\IDOT Offices\District 8\Projects\0876J71\Drawings\CADsheets\0876J71-sh1-500.dgn | | REVISOR - | REVISOR - |
| | PLOT SCALE = 100.0000' / in. | CHECKED - | REVISED - |
| | PLOT DATE = 1/28/2020 | DATE - | REVISED - |

**STATE OF ILLINOIS
DEPARTMENT OF TRANSPORTATION**

SUMMARY OF QUANTITIES

SCALE: SHEET 2 OF 6 SHEETS STA. TO STA.

| | | | | |
|---------------------------|----------------|----------|--------------------|-----------|
| F.A.P. RTE. | SECTION | COUNTY | TOTAL SHEETS | SHEET NO. |
| 312 | (70,71,72)RS-4 | RANDOLPH | 102 | 4 |
| ILLINOIS FED. AID PROJECT | | | CONTRACT NO. 76J71 | |

REV. 5-29-2020

| CODE NO. | ITEM | UNIT | TOTAL QUANTITY | CONSTRUCTION CODE | | |
|------------|---|-------|----------------|-------------------|------------|--|
| | | | | 80 / 20 | 50 / 50 | |
| | | | | FED/STATE | CITY/STATE | |
| | | | | ROADWAY | ROADWAY | |
| | | | | 0005 | 0005 | |
| | | | | RURAL | RURAL | |
| * 78200005 | GUARDRAIL REFLECTORS, TYPE A | EACH | 8 | 8 | | |
| * 78200020 | CURB REFLECTORS | EACH | 13 | 13 | | |
| 78300200 | RAISED REFLECTIVE PAVEMENT MARKER REMOVAL | EACH | 702 | 702 | | |
| X0324058 | OUTLET SPECIAL | EACH | 2 | 2 | | |
| X0324450 | SEGMENTAL CONCRETE BLOCK WALL, SPECIAL | SQ FT | 18 | 18 | | |
| X0325299 | INLET MODIFICATION | EACH | 1 | 1 | | |
| X0326351 | CONCRETE APRON FOR MEDIAN INLET | EACH | 1 | 1 | | |
| X4240420 | PORTLAND CEMENT CONCRETE SIDEWALK 4 INCH, SPECIAL | SQ FT | 4608 | 4608 | | |
| X4240440 | PORTLAND CEMENT CONCRETE SIDEWALK 6 INCH, SPECIAL | SQ FT | 34 | 34 | | |
| X4400100 | PORTLAND CEMENT CONCRETE SURFACE REMOVAL (VARIABLE DEPTH) | SQ YD | 7 | 7 | | |
| X4401198 | HOT-MIX ASPHALT SURFACE REMOVAL, VARIABLE DEPTH | SQ YD | 2371 | 2371 | | |
| X5430100 | INSERTION CULVERT LINER (SPECIAL) | FOOT | 60 | 60 | | |
| X6060068 | COMBINATION CONCRETE CURB AND GUTTER, TYPE B (SPECIAL) (ABUTTING EXISTING PAVEMENT) | FOOT | 395 | 395 | | |
| * X6330725 | STEEL PLATE BEAM GUARDRAIL (SHORT RADIUS) | FOOT | 26 | 26 | | |

| CODE NO. | ITEM | UNIT | TOTAL QUANTITY | CONSTRUCTION CODE | | |
|------------|---|-------|----------------|-------------------|------------|--|
| | | | | 80 / 20 | 50 / 50 | |
| | | | | FED/STATE | CITY/STATE | |
| | | | | ROADWAY | ROADWAY | |
| | | | | 0005 | 0005 | |
| | | | | RURAL | RURAL | |
| X6660445 | RIGHT OF WAY AND PROPERTY CORNERS | EACH | 49 | 49 | | |
| X7011800 | TRAFFIC CONTROL AND PROTECTION, STANDARD BLR 21 | L SUM | 1 | 1 | | |
| X7030005 | TEMPORARY PAVEMENT MARKING REMOVAL | SQ FT | 40311 | 40311 | | |
| * X7800100 | PAINT PAVEMENT MARKING - RAISED MEDIAN | SQ FT | 64 | 64 | | |
| * X7800200 | PAINT PAVEMENT MARKING CURB | FOOT | 69 | 69 | | |
| Z0007430 | TEMPORARY SIDEWALK | SQ FT | 976 | 976 | | |
| Z0012450 | CONCRETE STEPS | CU YD | 0.3 | 0.3 | | |
| Z0013798 | CONSTRUCTION LAYOUT | L SUM | 1 | 1 | | |
| Z0016702 | DETOUR SIGNING | L SUM | 1 | 1 | | |
| Z0033700 | LONGITUDINAL JOINT SEALANT | FOOT | 41266 | 41266 | | |
| Z0034105 | MATERIAL TRANSFER DEVICE | TON | 23028 | 23028 | | |
| Z0056612 | STORM SEWER (WATER MAIN REQUIREMENTS) 18 INCH | FOOT | 31.9 | 31.9 | | |
| Z0056620 | STORM SEWER (WATER MAIN REQUIREMENTS) 30 INCH | FOOT | 125.6 | 125.6 | | |
| Z0056622 | STORM SEWER (WATER MAIN REQUIREMENTS) 36 INCH | FOOT | 33.8 | 33.8 | | |
| Z0056624 | STORM SEWER (WATER MAIN REQUIREMENTS) 42 INCH | FOOT | 4.5 | 4.5 | | |

* SPECIALTY ITEM

REV. 5-29-2020

| | | | | | | | | | | | |
|--|------------------------|------------|-----------|---|------------------------------|-------------|--------------------|---------------------|--------------|-----------|---------------------------|
| FILE NAME = | USER NAME = FREIMUTHPD | DESIGNED - | REVISED - | STATE OF ILLINOIS DEPARTMENT OF TRANSPORTATION | SUMMARY OF QUANTITIES | F.A.P. RTE. | SECTION | COUNTY | TOTAL SHEETS | SHEET NO. | |
| p:\planroom\dot.illinois.gov\PIDOT\Documents\IDOT Offices\District 8\Projects\0876J71\Drawings\CADsheets\0876J71-sh1-500.dgn | | | | | | REVISED - | 312 | (70,71,72)RS-4 | RANDOLPH | 102 | 7 |
| PLOT SCALE = 100.0000' / in. | | | | | | CHECKED - | CONTRACT NO. 76J71 | | | | |
| PLOT DATE = 1/28/2020 | | | | | | DATE - | SCALE: | SHEET 5 OF 6 SHEETS | STA. | TO STA. | ILLINOIS FED. AID PROJECT |

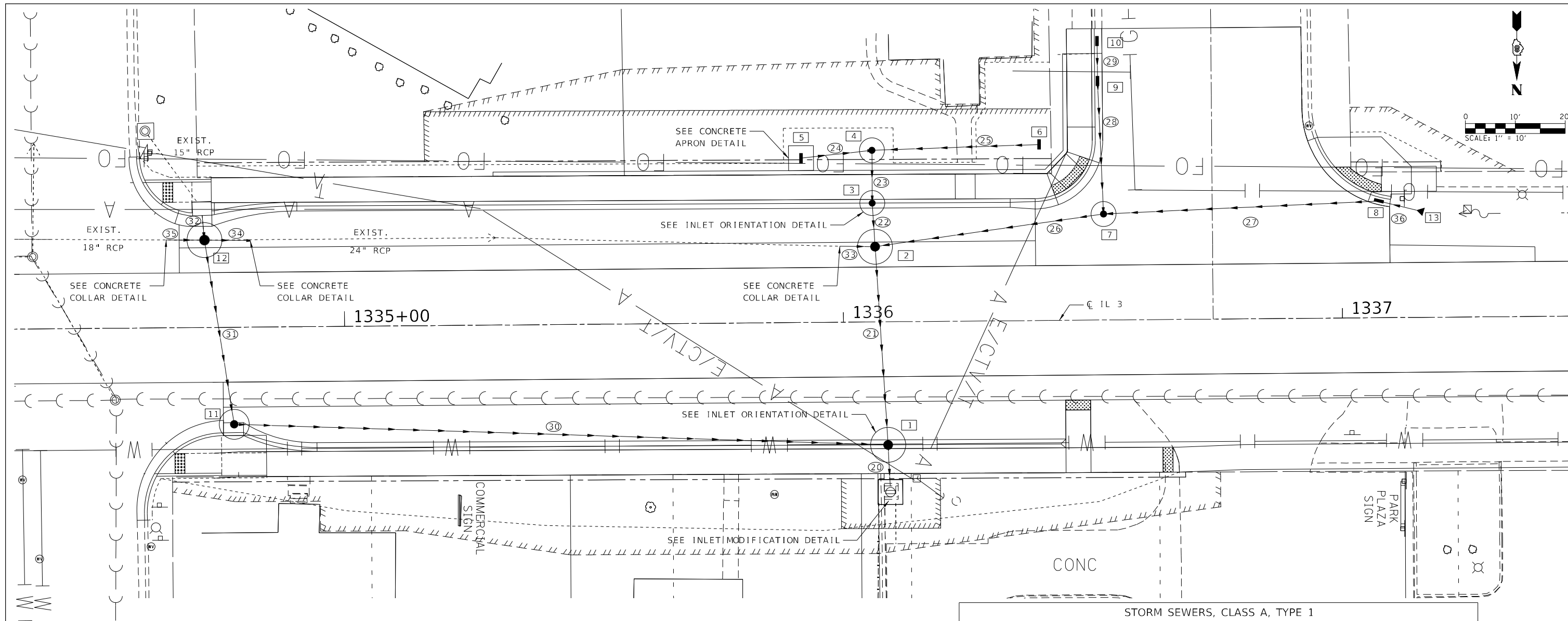

| DRAINAGE STRUCTURES | | | | | | | | |
|---------------------|-----------|----------|--|---------------|----------------|----------------|---------------|---------------|
| STRUCTURE NUMBER | STATION | OFFSET | TYPE | RIM ELEVATION | INVERT (NORTH) | INVERT (SOUTH) | INVERT (EAST) | INVERT (WEST) |
| 1 | 1336+08.8 | 24.7' RT | MANHOLE TYPE A, 6' DIAMETER, TYPE 10 FRAME AND GRATE | 86.61 | 79.65 | 80.25 | 80.50 | ----- |
| 2 | 1336+06.5 | 15.1' LT | MANHOLE TYPE A, 6' DIAMETER, TYPE 1 FRAME, CLOSED LID | 88.80 | 80.42 | 80.43 | 82.04 | 81.25 |
| 3 | 1336+06.0 | 23.8' LT | MANHOLE TYPE A, 4' DIAMETER W/ FRAME AND GRATE TYPE 10 | 87.48 | 80.51 | 80.52 | ----- | ----- |
| 4 | 1336+06.0 | 34.4' LT | MANHOLE TYPE A, 4' DIAMETER, TYPE 1 FRAME, CLOSED LID | 86.02 | 80.59 | ----- | 80.60 | 80.60 |
| 5 | 1335+91.8 | 33.0' LT | INLETS, TYPE A, WITH MEDIAN INLET (604101) | 83.50 | ----- | ----- | ----- | 80.71 |
| 6 | 1336+39.5 | 35.3' LT | INLETS, TYPE A, WITH MEDIAN INLET (604101) | 86.90 | ----- | ----- | 83.04 | ----- |
| 7 | 1336+52.3 | 21.3' LT | MANHOLE TYPE A, 6' DIAMETER, TYPE 1 FRAME, CLOSED LID | 88.55 | ----- | 82.24 | 82.24 | 82.24 |
| 8 | 1337+07.5 | 23.4' LT | INLETS, TYPE B, TYPE 3 FRAME AND GRATE | 88.60 | ----- | ----- | 85.00 | 85.75 |
| 9 | 1336+51.3 | 47.9' LT | INLETS, TYPE B, TYPE 3 FRAME AND GRATE | 87.65 | 82.49 | 82.50 | ----- | ----- |
| 10 | 1336+51.3 | 55.9' LT | INLETS, TYPE A, TYPE 3 FRAME AND GRATE | 87.37 | 82.56 | ----- | ----- | ----- |
| 11 | 1334+77.7 | 19.5' RT | MANHOLES, TYPE A, 5'-DIAMETER, TYPE 3 FRAME AND GRATE | 88.74 | ----- | 83.10 | ----- | 83.00 |
| 12 | 1334+72.1 | 17.5' LT | MANHOLE TYPE A, 6' DIAMETER, TYPE 1 FRAME, CLOSED LID | 89.99 | 83.77 | 85.50 | 85.00 | 85.00 |
| 13 | 1337+16.3 | 21.2' LT | PRECAST REINFORCED CONCRETE FLARED END SECTIONS 12" | 87.28 | ----- | ----- | ----- | 87.28 |
| EX 5'X5' BOX | 1336+09.1 | 34.1' RT | EXISTING 5'X5' CONC. BOX | 85.50 | 78.30 | 79.63 | ----- | ----- |
| EX INLET | 1334+71.6 | 23.8' LT | EXISTING CURB INLET | 88.83 | 85.65 | UNKNOWN | ----- | ----- |

| STORM SEWERS, CLASS A, TYPE 1 | | | | | | | |
|-------------------------------|--------------------|-----------------|------------------|----------------------|----------------|-------------------------|-------------------------|
| PIPE NUMBER | REACH (FROM) | REACH (TO) | PIPE SIZE (INCH) | APPROX LENGTH (FEET) | SLOPE (%) | WATER MAIN REQUIREMENTS | TRENCH BACKFILL (CU YD) |
| 20 | EX 5'X5' CONC. BOX | 1 | 42 | 4.5 | 0.44% | YES | 7.1 |
| 21 | 1 | 2 | 36 | 33.8 | 0.50% | YES | 56.3 |
| 22 | 2 | 3 | 24 | 3.8 | 2.11% | | 5.3 |
| 23 | 3 | 4 | 24 | 6.6 | 1.06% | | 7.3 |
| 24 | 4 | 5 | 12 | 11.3 | 0.97% | | 0.0 |
| 25 | 4 | 6 | 12 | 30.5 | 8.00% | | 0.0 |
| 26 | 2 | 7 | 18 | 41.3 | 2.40% | | 42.6 |
| 27 | 7 | 8 | 12 | 51.7 | 5.34% | | 32.9 |
| 28 | 7 | 9 | 12 | 23.7 | 1.05% | | 18.0 |
| 29 | 9 | 10 | 12 | 6.0 | 1.00% | | 3.8 |
| 30 | 1 | 11 | 30 | 125.6 | 1.99% | YES | 148.0 |
| 31 | 11 | 12 | 18 | 31.9 | 2.10% | YES | 29.4 |
| 32 | 12 | EX CURB INLET | 18 | 2.5 | 6.00% | | 1.3 |
| 33 | 2 | CONCRETE COLLAR | 24 | 4.0 | MATCH EXISTING | | 4.9 |
| 34 | CONCRETE COLLAR | 12 | 24 | 4.0 | MATCH EXISTING | | 3.4 |
| 35 | 12 | CONCRETE COLLAR | 24 | 4.0 | MATCH EXISTING | | 3.4 |
| 36 | 8 | 13 | 12 | 1.7 | 29.42% | | 0.1 |

REV. 5-29-2020

* - RIM ELEVATION IS AT THE FLOWLINE OF THE GRATE

| | | | |
|---|-----------------------|------------|----------------------------|
| FILE NAME = | USER NAME = frcimthpd | DESIGNED - | REVISED - 5/28/2020 P.D.F. |
| pw:\planning\dot.illinois.gov\PWIDOT\Documents\1007 Offices\District 8\Projects\0876J71\Drawings\CAD\Sheets\0876J71-sh-1-drainage.dwg | | CHECKED - | REVISED - |
| | | DATE - | REVISED - |

**STATE OF ILLINOIS
DEPARTMENT OF TRANSPORTATION**

| | | | |
|---|-------|-----------|--------------|
| DRAINAGE AND UTILITY PLAN (SPRING STREET TO ROCK STREET) | | | |
| SCALE: | SHEET | OF SHEETS | STA. TO STA. |

| | | | | |
|--------------------|----------------|----------|---------------------------|-----------|
| F.A.P. RTE. | SECTION | COUNTY | TOTAL SHEETS | SHEET NO. |
| 312 | (70,71,72)RS-4 | RANDOLPH | 102 | 26 |
| CONTRACT NO. 76J71 | | | ILLINOIS FED. AID PROJECT | |

| | | | |
|------|-------------------|----|------|
| PLAN | SURVEYED | BY | DATE |
| | PLOTTED | | |
| | ALIGNMENT CHECKED | | |
| | NOTE BOOK | | |
| | NO. | | |
| | FILE NAME | | |

| | | | |
|---------|----------------|----|------|
| PROFILE | SURVEYED | BY | DATE |
| | PLOTTED | | |
| | GRADES CHECKED | | |
| | NOTE BOOK | | |
| | NO. | | |
| | FILE NAME | | |

MODEL: \$MODEL\$
 FILE NAME: p:\data\room\04\illinois\gov\p\w\DOT\Documents\DOT - Offices\District - 8\projects\876717\CAD\DWG\876717-1-st-1-drainage.dwg

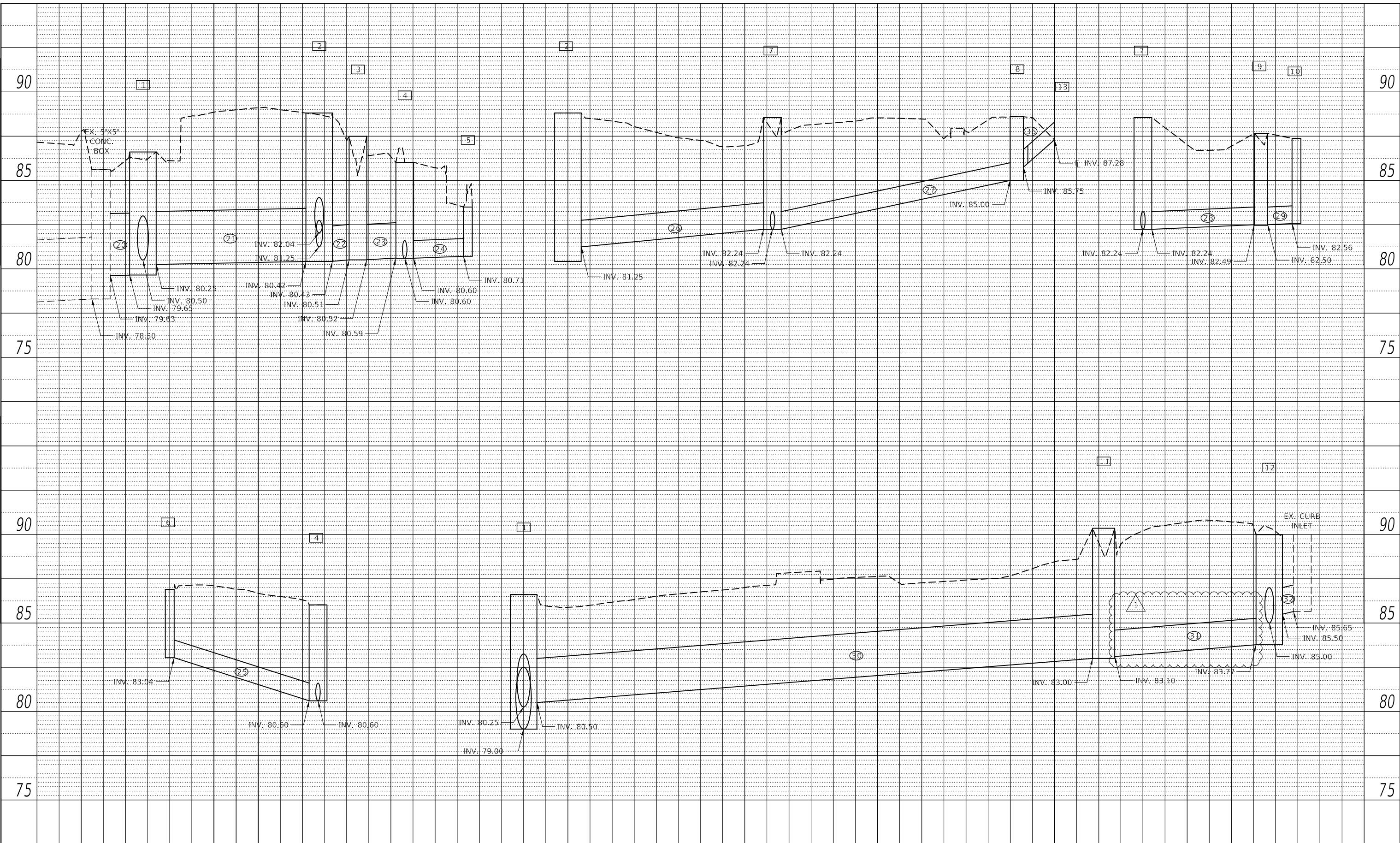

| | | | | | |
|--------------|-----------------|------------|--|-----------|------------------|
| USER NAME = | freimuchod | DESIGNED - | | REVISED - | 5/28/2020 P.D.F. |
| | | DRAWN - | | REVISED - | |
| PLOT SCALE = | 20,0000 * / in. | CHECKED - | | REVISED - | |
| PLOT DATE = | 5/28/2020 | DATE - | | REVISED - | |

**STATE OF ILLINOIS
 DEPARTMENT OF TRANSPORTATION**

**STORM SEWER PROFILES
 (SPRING STREET TO ROCK STREET)**

SCALE: SHEET OF SHEETS STA. TO STA.

| | | | | |
|---------------------------|----------------|----------|--------------|-----------|
| F.A.P. RTE. | SECTION | COUNTY | TOTAL SHEETS | SHEET NO. |
| 312 | (70,71,72)RS-4 | RANDOLPH | 102 | 27 |
| CONTRACT NO. 76J71 | | | | |
| ILLINOIS FED. AID PROJECT | | | | |

REV. 5-29-2020