

EXIST. CURVE E-58-2
 PI STA. = 109+31.56
 $\Delta = 25^\circ 29' 19''$ (LT)
 $D = 2^\circ 29' 28''$
 $R = 2,300.00'$
 $T = 520.20'$
 $L = 1,023.18'$
 $E = 58.09'$
 $\theta = \dots$
 T.R. = \dots
 S.E. RUN = \dots
 P.C. STA. = 104+11.36
 P.T. STA. = 114+34.54

PROP. HMA SURFACE REMOVAL, 2 1/2"
 PROP. POLY. HMA SURFACE COURSE, MIX "F", N90 1 3/4"
 PROP. POLY. LEVELING BINDER, IL-4.75, N50, 3/4"

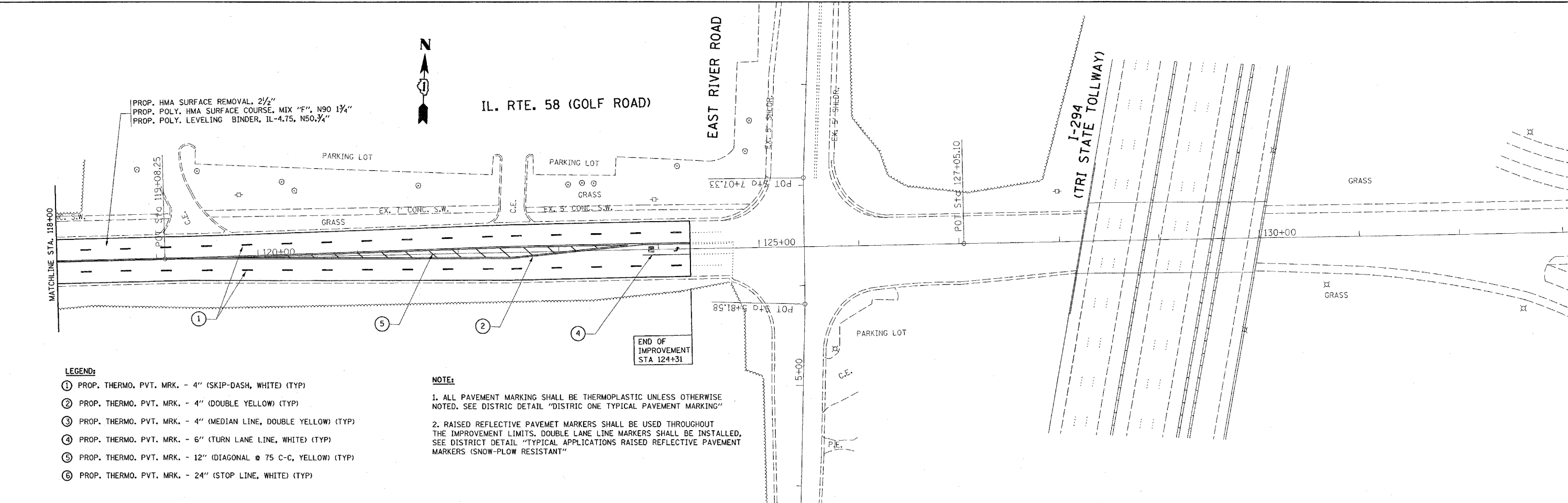

PROP. HMA SURFACE REMOVAL, 2 1/2"
 PROP. POLY. HMA SURFACE COURSE, MIX "F", N90 1 3/4"
 PROP. POLY. LEVELING BINDER, IL-4.75, N50, 3/4"

IL. RTE. 58 (GOLF ROAD)

EAST RIVER ROAD

I-294
 (TRI STATE TOLLWAY)

- LEGEND:**
- ① PROP. THERMO. PVT. MK. - 4" (SKIP-DASH, WHITE) (TYP)
 - ② PROP. THERMO. PVT. MK. - 4" (DOUBLE YELLOW) (TYP)
 - ③ PROP. THERMO. PVT. MK. - 4" (MEDIAN LINE, DOUBLE YELLOW) (TYP)
 - ④ PROP. THERMO. PVT. MK. - 6" (TURN LANE LINE, WHITE) (TYP)
 - ⑤ PROP. THERMO. PVT. MK. - 12" (DIAGONAL @ 75 C-C, YELLOW) (TYP)
 - ⑥ PROP. THERMO. PVT. MK. - 24" (STOP LINE, WHITE) (TYP)

- NOTE:**
1. ALL PAVEMENT MARKING SHALL BE THERMOPLASTIC UNLESS OTHERWISE NOTED. SEE DISTRIC DETAIL "DISTRIC ONE TYPICAL PAVEMENT MARKING"
 2. RAISED REFLECTIVE PAVEMET MARKERS SHALL BE USED THROUGHOUT THE IMPROVEMENT LIMITS. DOUBLE LANE LINE MARKERS SHALL BE INSTALLED. SEE DISTRIC DETAIL "TYPICAL APPLICATIONS RAISED REFLECTIVE PAVEMENT MARKERS (SNOW-PLOW RESISTANT)"

END OF IMPROVEMENT STA 124+31

FILE NAME = ca:\projects\dl25807\sh_rdw_00.dgn	USER NAME = osmanhm	DESIGNED -	REVISED -	STATE OF ILLINOIS DEPARTMENT OF TRANSPORTATION	IL. RTE. 58 (GOLF ROAD) (WOLF ROAD TO EAST RIVER ROAD) EXISTING AND PROPOSED PAVEMENT MARKING PLAN	F.A.P. RTE. 339	SECTION 2007-017RS	COUNTY COOK	TOTAL SHEETS 33	SHEET NO. 13	
PLOT SCALE = 50.0000' / IN.	CHECKED -	REVISED -	SCALE: 1"= 50'			SHEET NO. OF SHEETS	STA. 103+00.00 TO STA. 133+00.00	FED. ROAD DIST. NO. 1 [ILLINOIS] FED. AID PROJECT			
PLOT DATE = 4/15/2008	DATE -	REVISED -									
CONTRACT NO. 60C72											