

F.A.P. RTE.	SECTION	COUNTY	TOTAL SHEETS	SHEET NO.
345	8R-1-N-1	COOK	196	121
STA. 85+00.00		TO STA. 92+46.15		
FED. ROAD DIST. NO.	ILLINOIS	FED. AID PROJECT		

CONTRACT NO. 62617

GENERAL NOTES:

- Plan Dimensions and Details relative to Existing Plans are subject to routine variations. The Contractor shall field verify existing Dimensions and Details affecting new Construction and make necessary approved adjustments prior to Construction or ordering of Materials. Such variations shall not be cause for additional Compensation for a change in the scope of work; however, the Contractor will be paid for the quantity actually furnished at the Unit Price for the work.
 - The Contractor is responsible for the Design and Performance of the Lagging using no less than a 3 in. nominal rough-sawn thickness and Timber with a minimum allowable bending stress of 1000 psi.
 - Pipe Underdrain Outlet Pipes shall drain into Concrete Headwalls. See Article 601.05 of The Standard Specifications and see Highway Standard 601101.
 - Reinforcement Bars shall conform to the requirements of ASTM A706, GR. 60 (IL. Modified). See Special Provisions.
 - All Exposed Concrete edges shall be chamfered 3/4" unless otherwise noted.
 - Reinforcement Bars designated (E) shall be Epoxy Coated.
7. Prior to the Interim Completion Date, Retaining Wall Backfill shall be placed to a minimum elevation of 1 Foot below the top of Wall and sloped properly to drain surface water away from the Wall and to avoid standing water.

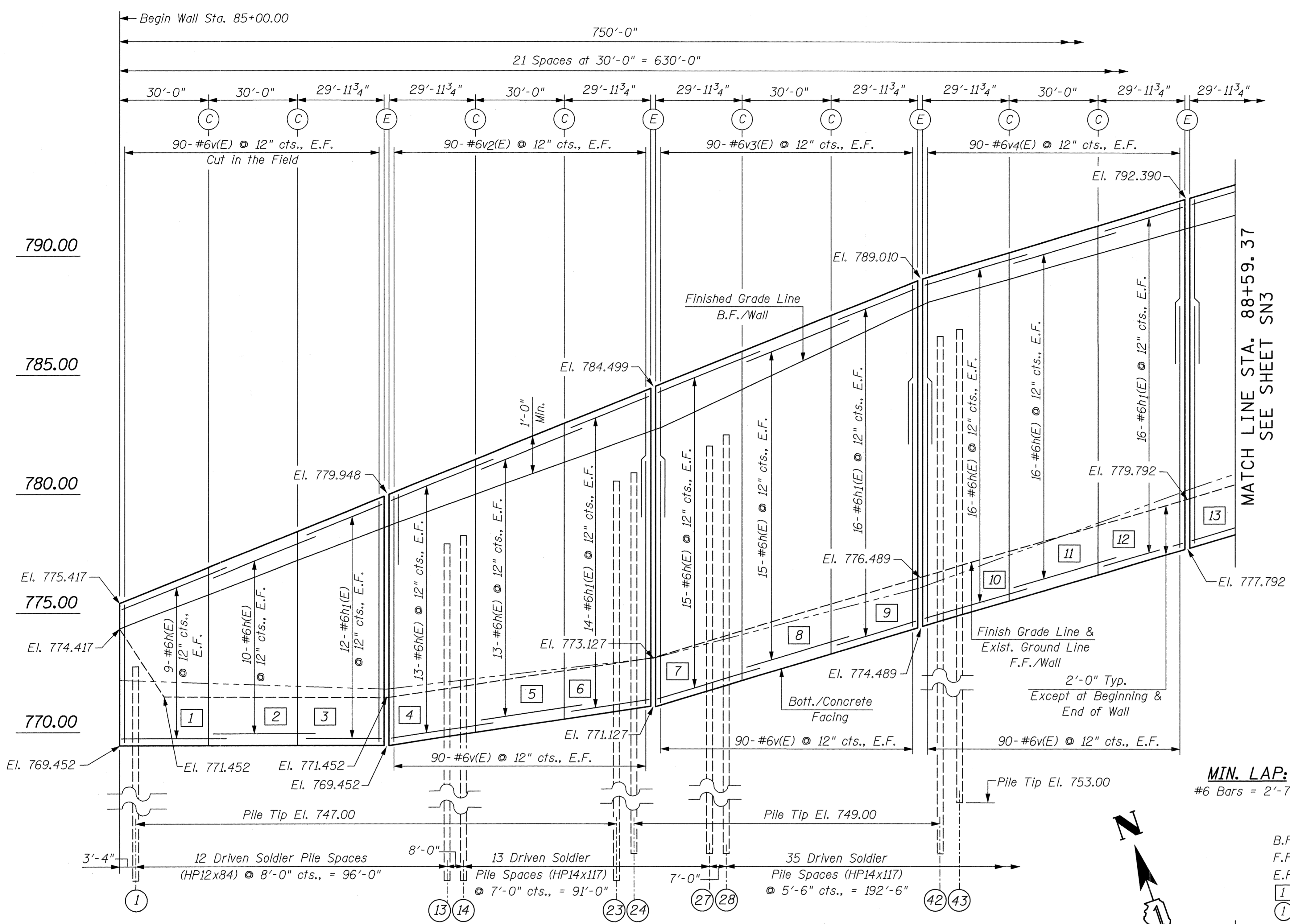

MIN. LAP:
#6 Bars = 2'-7"

- LEGEND:**
- B.F. = Back Face
 - F.F. = Front Face
 - E.F. = Each Face
 - 1 = Panel Numbers
 - 1 = Pile Numbers

TOTAL BILL OF MATERIAL

DESCRIPTION	UNIT	QUANTITY
Concrete Structures	Cu. Yd.	376.4
Pipe Underdrains for Structures 4"	Foot	758
Stud Shear Connectors	Each	7,862
Furnishing Soldier Piles (HP Section)	Foot	5,150
Driving Soldier Piles	Foot	5,150
Reinforcement Bars, Epoxy Coated	Lb.	72,610
Structure Excavation	Cu. Yd.	307
Untreated Timber Lagging	Sq. Ft.	8,662
Geocomposite Wall Drain	Sq. Yd.	722

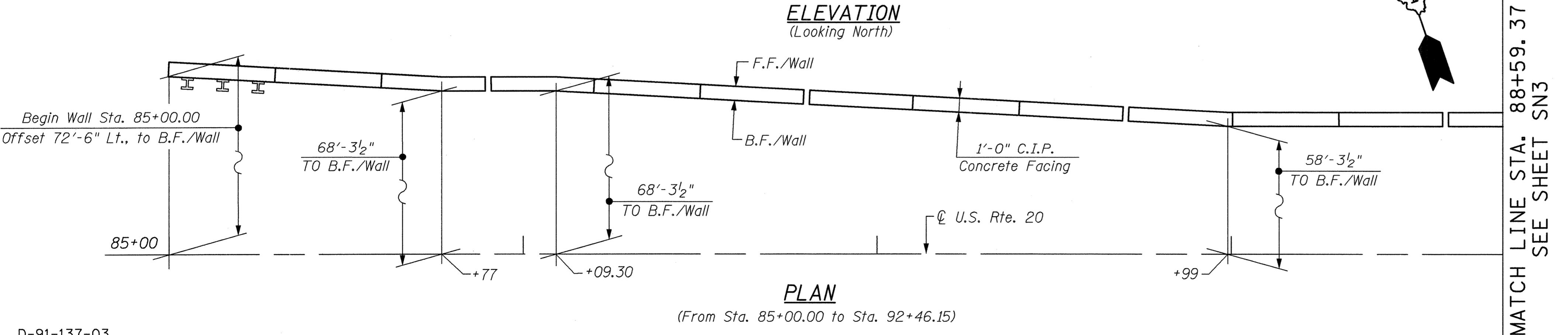

D-91-137-03

REVISIONS	
NAME	DATE
ADDENDUM 1	5-22-08

ILLINOIS DEPARTMENT OF TRANSPORTATION

GENERAL PLAN & ELEVATION
U.S. RTE. 20
AT BLUFF CITY / SHALES PARKWAY
NORTH SOLDIER PILE RETAINING WALL
F.A.P. 345 SECTION: 8R-1-N-1
COOK COUNTY
STRUCTURE NO. 016-W969

SCALE: NONE
DATE: FEBRUARY, 2008
DRAWN BY: D.L./F.M.
CHECKED BY: B.N.S./J.C.N.

CHRISTIAN-ROGE & ASSOC., INC.
CHICAGO ILLINOIS

MATCH LINE STA. 88+59.37
SEE SHEET SN3