

BILL OF MATERIAL

Bar	No.	Size	Length	Shape
h(E)	410	#6	32'-6"	
h1(E)	214	#6	29'-9"	
h2(E)	68	#6	26'-11"	
h3(E)	34	#6	24'-2"	
h4(E)	34	#6	23'-9"	
h5(E)	28	#6	23'-0"	
v(E)	1,408	#6	10'-2"	
v1(E)	96	#6	9'-6"	
v2(E)	180	#6	5'-6"	
v3(E)	180	#6	6'-8"	
v4(E)	360	#6	6'-9"	
v5(E)	180	#6	7'-3"	
v6(E)	328	#6	7'-11"	
v7(E)	96	#6	8'-4"	
Reinforcement Bars, Epoxy Coated			Lb.	72,610

DRIVEN SOLDIER PILE TYPICAL WALL SECTION

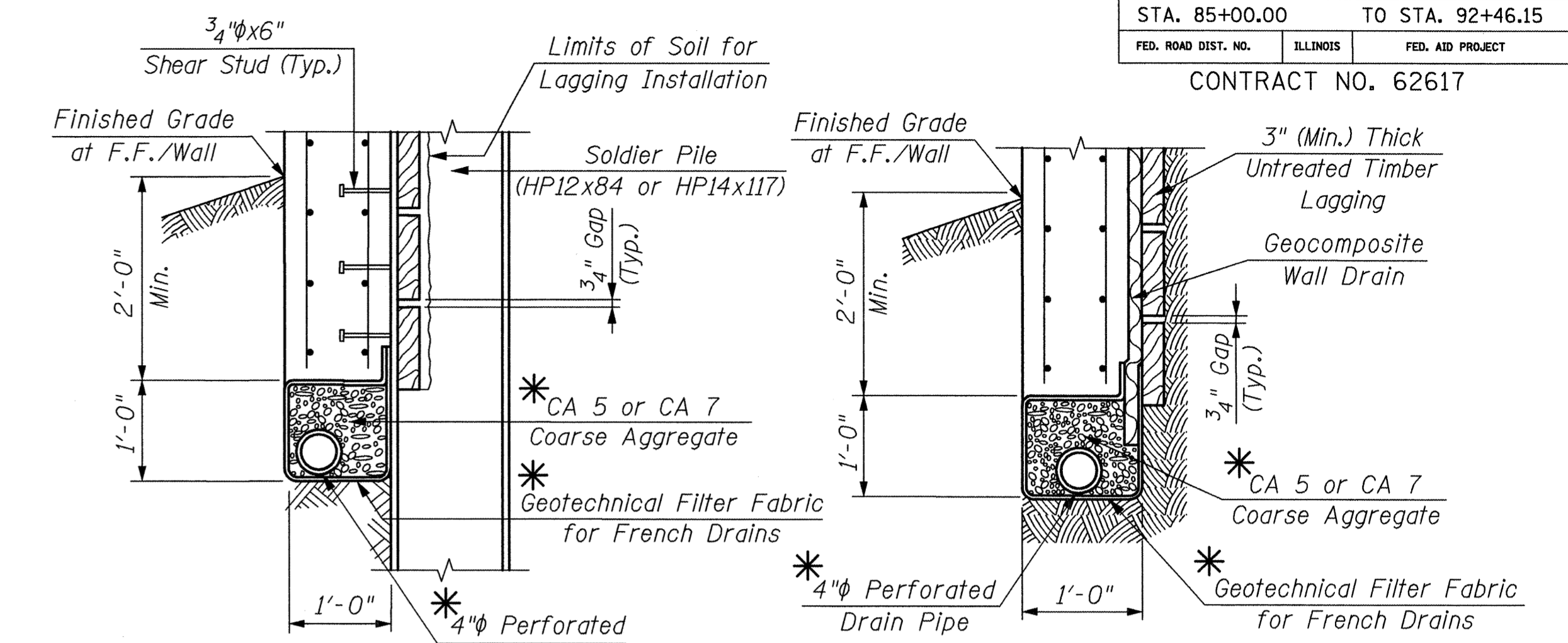

PIPE UNDERDRAIN DETAIL AT SOLDIER PILES
PIPE UNDERDRAIN DETAIL BETWEEN SOLDIER PILES

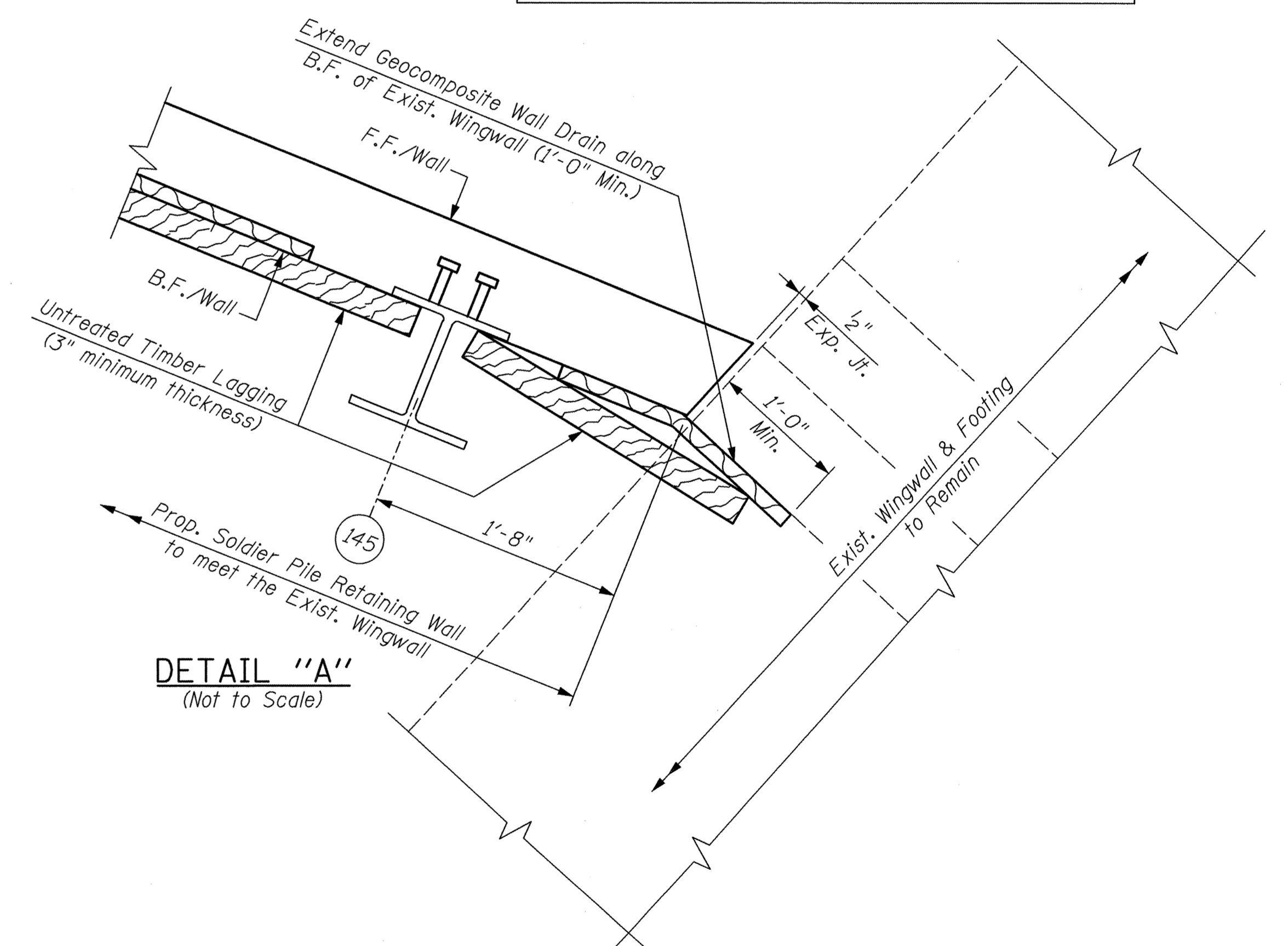

DETAIL "A"
(Not to Scale)

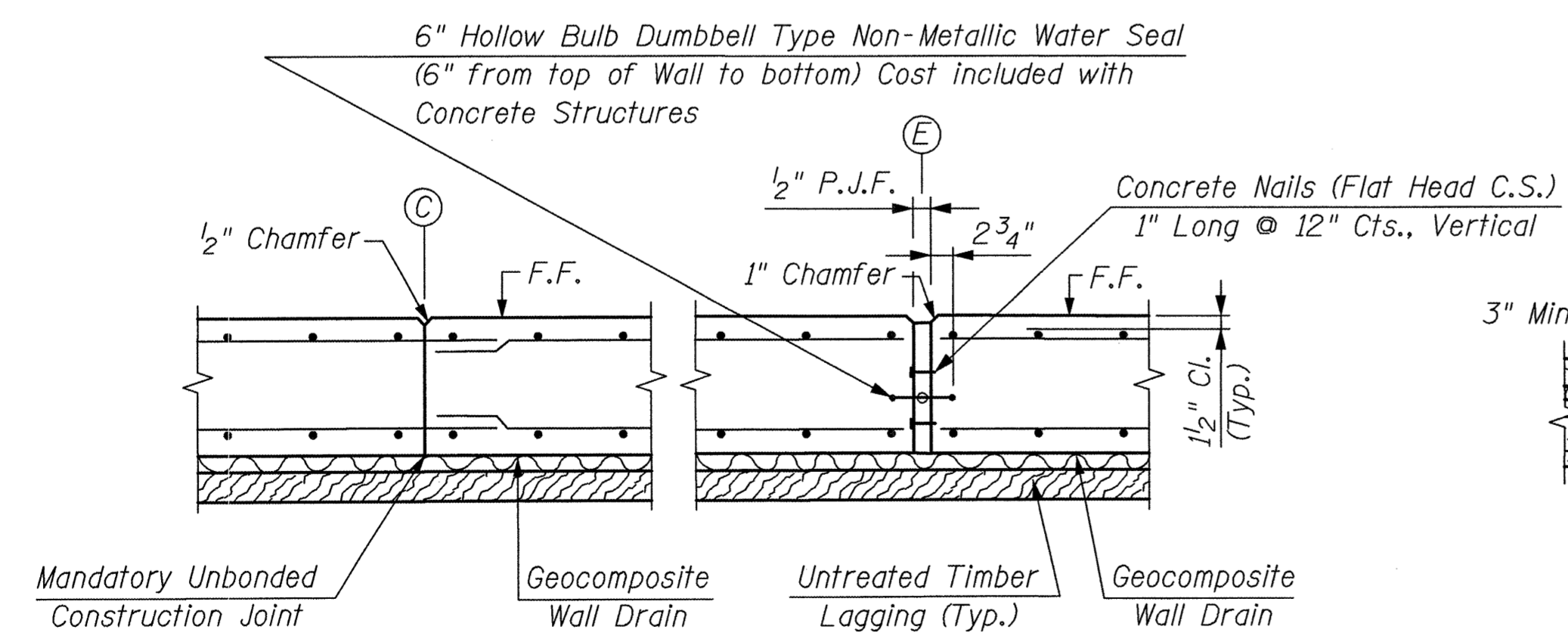

CONSTRUCTION JOINT EXPANSION JOINT
END OF PANEL DETAILS

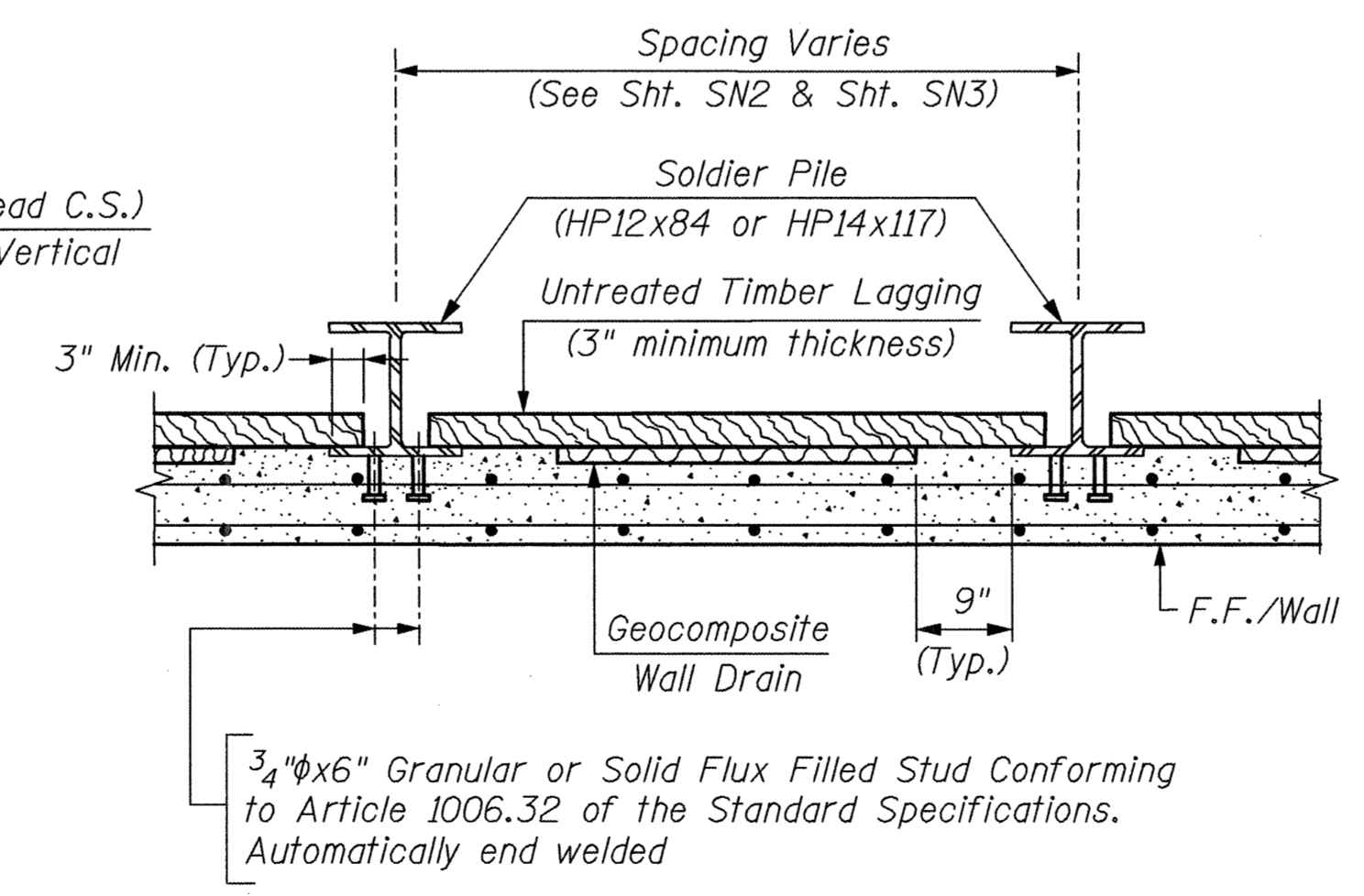

TYPICAL SECTION THRU SOLDIER PILE WALL

REVISIONS	
NAME	DATE
ADDENDUM 1	5-22-08

ILLINOIS DEPARTMENT OF TRANSPORTATION
SECTION & RETAINING WALL DETAILS
U.S. RTE. 20
AT BLUFF CITY / SHALES PARKWAY
NORTH SOLDIER PILE RETAINING WALL
F.A.P. 345 SECTION: 8R-1-N-1
COOK COUNTY
STRUCTURE NO. 016-W969

SCALE: NONE
DATE: FEBRUARY, 2008
DRAWN BY: D.L./F.M.
CHECKED BY: B.N.S./J.C.N.
CHRISTIAN-ROGE & ASSOC., INC.
CHICAGO ILLINOIS