

IL. ROUTE 50

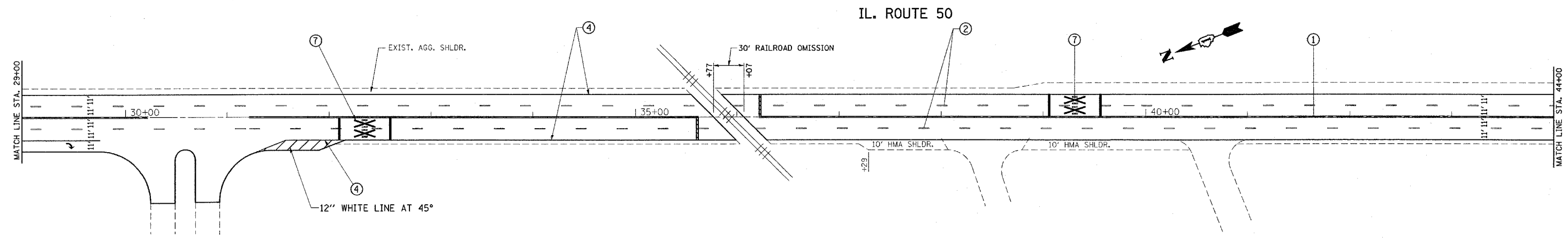
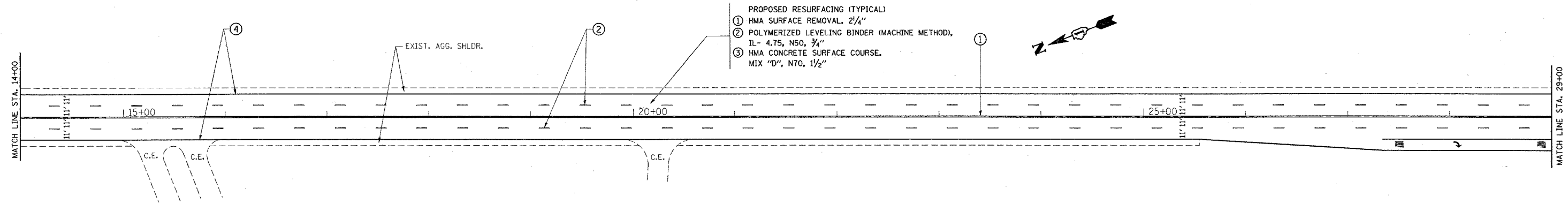
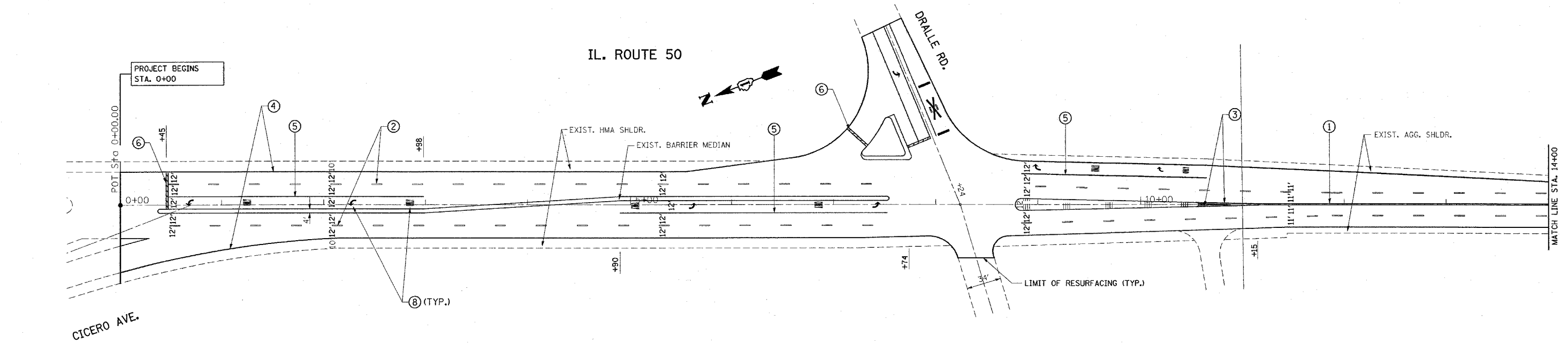

LEGEND

- ① PROPOSED THERMOPLASTIC PAVEMENT MARKING, 4" DOUBLE SOLID YELLOW LINE AT 11" C-C (TYP.)
- ② PROPOSED THERMOPLASTIC PAVEMENT MARKING, 4" LINE SKIP DASH (10' DASH, 30' SKIP) WHITE
- ③ PROPOSED THERMOPLASTIC PAVEMENT MARKING, 4" YELLOW LINE (TYP.)
- ④ PROPOSED THERMOPLASTIC PAVEMENT MARKING, 4" WHITE EDGE LINE (TYP.)
- ⑤ PROPOSED THERMOPLASTIC PAVEMENT MARKING, 6" WHITE LINE

- ⑥ PROPOSED THERMOPLASTIC PAVEMENT MARKING, 24" WHITE LINE, STOP BAR (TYP.)
- ⑦ PROPOSED THERMOPLASTIC PAVEMENT MARKING, RAILROAD CROSSING
- ⑧ PROPOSED THERMOPLASTIC PAVEMENT MARKING, LETTERS AND SYMBOLS (TYP.)

\* NOTE:  
RAISED REFLECTIVE PAVEMENT MARKERS AS PER DISTRICT ONE DETAILS (SEE SHEET \*12)

\* NOTE:  
FOR HMA SHOULDER RESURFACING AND AGGREGATE SHOULDER REPAIRS ON TYPICAL CROSS SECTIONS.

FILE NAME =  
es:\projects\0122404\ah\_rdw.dgn

USER NAME = ouky  
PLOT SCALE = 50.0000' / IN.  
PLOT DATE = 4/23/2008

DESIGNED -  
DRAWN -  
CHECKED -  
DATE -

REVISED -  
REVISED -  
REVISED -  
REVISED -

STATE OF ILLINOIS  
DEPARTMENT OF TRANSPORTATION

IL. RTE. 50 (CICERO AVENUE TO WILSON ST.)  
ROADWAY AND PAVEMENT MARKING PLAN

SCALE: 1" = 50' SHEET NO. OF SHEETS STA. TO STA.

F.A.P. RTE.	SECTION	COUNTY	TOTAL SHEETS	SHEET NO.
*	143RS-4	WILL	16	6
*350 & 840			CONTRACT NO. 62762	
FED. ROAD DIST. NO. 1 (ILLINOIS) FED. AID PROJECT				