

DATE: _____ BY: _____
 SURVEYED: _____ CHECKED: _____
 PLOTTED: _____ REVISIONS: _____
 NOTE BOOK NO. _____
 CADD FILE NAME: _____

DATE: _____ BY: _____
 SURVEYED: _____ CHECKED: _____
 PLOTTED: _____ REVISIONS: _____
 NOTE BOOK NO. _____
 CADD FILE NAME: _____

CHRISTOPHER B. BURKE ENGINEERING LTD.
 9575 West Higgins Road, Suite 600
 Rosemont, Illinois 60018
 (847) 823-0500

TRAFFIC SIGNAL LEGEND

PROPOSED	EXISTING	PROPOSED	EXISTING

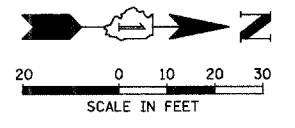

- CONSTRUCTION NOTES:**
- 1 REPLACE EXISTING CONTROLLER AND CONFLICT MONITOR.
 - 2 INSTALL ETHERNET KIT.
 - 3 INSTALL UPS UNIT IN SIDE MOUNTED CABINET ATTACHED TO EXISTING TRAFFIC SIGNAL CABINET.
 - 4 INSTALL PTZ CAMERA ON THE COMBINATION MAST ARM POLE IN THE NORTHWEST CORNER.

**MATCH LINE STA. 142+64
(SEE SHEET NO. 34)**

**MATCH LINE STA. 136+79
(SEE SHEET NO. 34)**

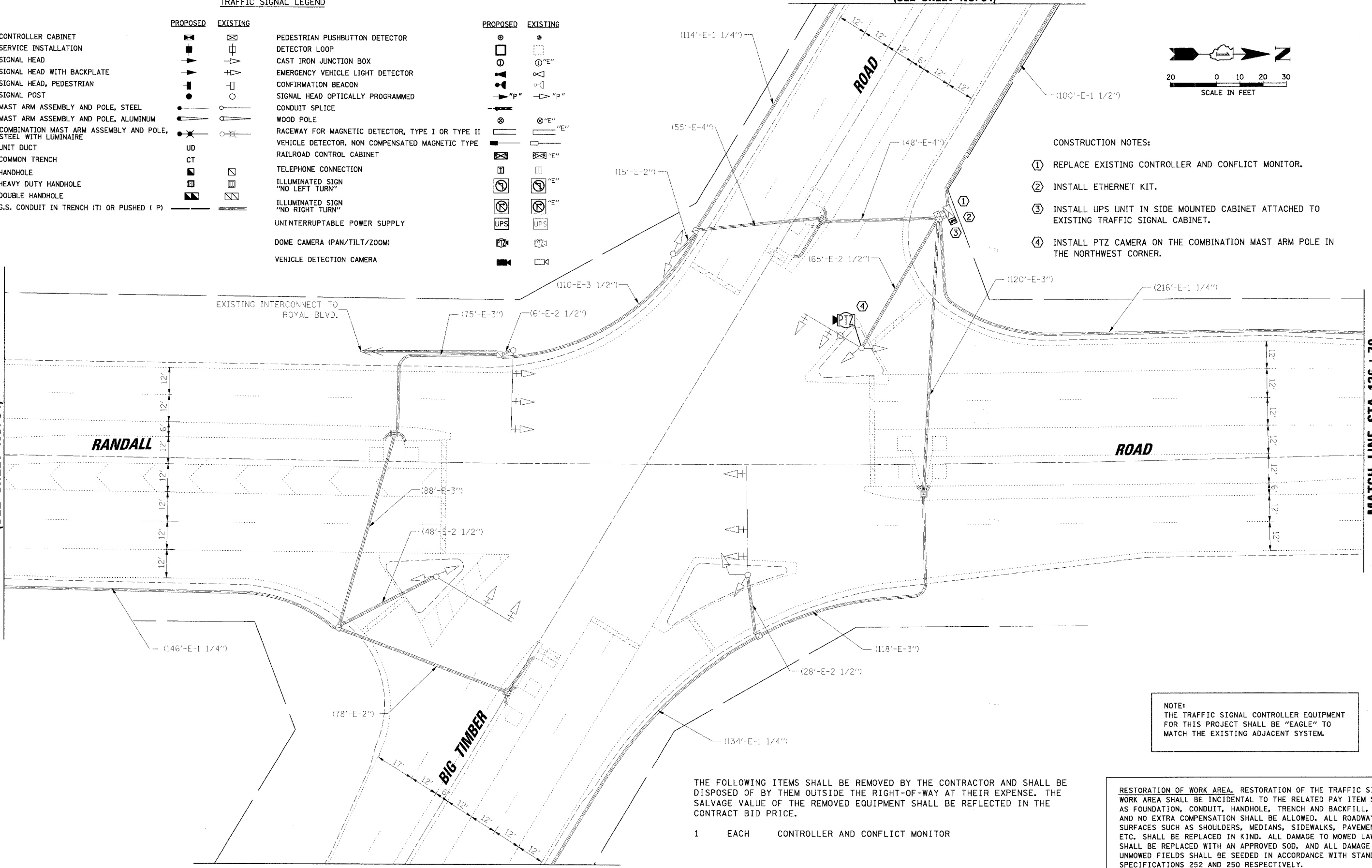

NOTE:
 THE TRAFFIC SIGNAL CONTROLLER EQUIPMENT FOR THIS PROJECT SHALL BE "EAGLE" TO MATCH THE EXISTING ADJACENT SYSTEM.

THE FOLLOWING ITEMS SHALL BE REMOVED BY THE CONTRACTOR AND SHALL BE DISPOSED OF BY THEM OUTSIDE THE RIGHT-OF-WAY AT THEIR EXPENSE. THE SALVAGE VALUE OF THE REMOVED EQUIPMENT SHALL BE REFLECTED IN THE CONTRACT BID PRICE.

- 1 EACH CONTROLLER AND CONFLICT MONITOR

RESTORATION OF WORK AREA. RESTORATION OF THE TRAFFIC SIGNAL WORK AREA SHALL BE INCIDENTAL TO THE RELATED PAY ITEM SUCH AS FOUNDATION, CONDUIT, HANDHOLE, TRENCH AND BACKFILL, ETC., AND NO EXTRA COMPENSATION SHALL BE ALLOWED. ALL ROADWAY SURFACES SUCH AS SHOULDERS, MEDIANS, SIDEWALKS, PAVEMENT, ETC. SHALL BE REPLACED IN KIND. ALL DAMAGE TO MOWED LAWNS SHALL BE REPLACED WITH AN APPROVED SOD, AND ALL DAMAGE TO UNMOWED FIELDS SHALL BE SEEDED IN ACCORDANCE WITH STANDARD SPECIFICATIONS 252 AND 250 RESPECTIVELY.

**MATCH LINE STA. 206+91
(SEE SHEET NO. 34)**

FILE NAME = N:\kane\county\873616\Traffic\MO301_BigTimber.dwg	USER NAME = MWJ.LIAM	DESIGNED -	REVISED -	STATE OF ILLINOIS DEPARTMENT OF TRANSPORTATION	TRAFFIC SIGNAL MODIFICATION PLAN RANDALL ROAD AT BIG TIMBER ROAD	F.A.P. RTE. 336	SECTION 06-00346-00-TL	COUNTY KANE	TOTAL SHEET SHEETS: NO. 69 33
PLOT SCALE = 20'	CHECKED -	REVISED -	CONTRACT NO. 63011						
PLOT DATE = 1/28/2020	DATE -	REVISED -	FED. ROAD DIST. NO. ILLINOIS FED. AID PROJECT						