

DATE	
BY	
REVISIONS	
PLAN	
NO.	
NOTE BOOK	
NO.	
ALIGNMENT CHECKED	
PLOTTED	
FILE NAME	
CARD FILE NAME	

DAVID HINTZSCHE

PR R.O.W.

JAMES & VALERIE MALECEK
 RONALD & ELIZABETH EDDINGTON
 ROBERT & MARGARET LANCASTER
 OTIS & IRMA MORGAN

2 CENTERED CURVE
 50'R - 300'R
 10' OFFSET
 PROPOSED 15" CMP
 PROPOSED 4' HMA SHOULDER
 ADDITIONAL EASEMENT OBTAINED BY WORK PERMIT
 IMPROVEMENT ENDS STA 14+75

TEMP EASE
 CONST. LIMITS
 TREE TRUNK PROTECTION
 PROPOSED 15" CMP
 EXISTING R.O.W.

10+00 12' 12' 15+00
 WALNUT GROVE DR
 EXISTING R.O.W.

HMA SURFACE COURSE, SPECIAL
 STA 10+29.87 - 14+75

PROPOSED 4' HMA SHOULDER
 PROPOSED 15" CMP

2 CENTERED CURVE
 50'R - 300'R
 10' OFFSET
 PROPOSED 4' HMA SHOULDER
 PROPOSED 15" CMP

ROBERT & CHERYL McDOWELL
 JAMES & MICHELE PEARSON
 MERLE & BONNIE SCHULTZ

STA 1146+78.45
 (PROPOSED IL RTE 76 B)=
 STA 9+91.66
 (PROPOSED WALNUT GROVE DR)
 STA 146+78.40
 (EXISTING IL RTE 76 C)=
 STA 10+00
 (EXISTING WALNUT GROVE DR)

CRAIG & BETH CONKLING



X = TREE REMOVAL

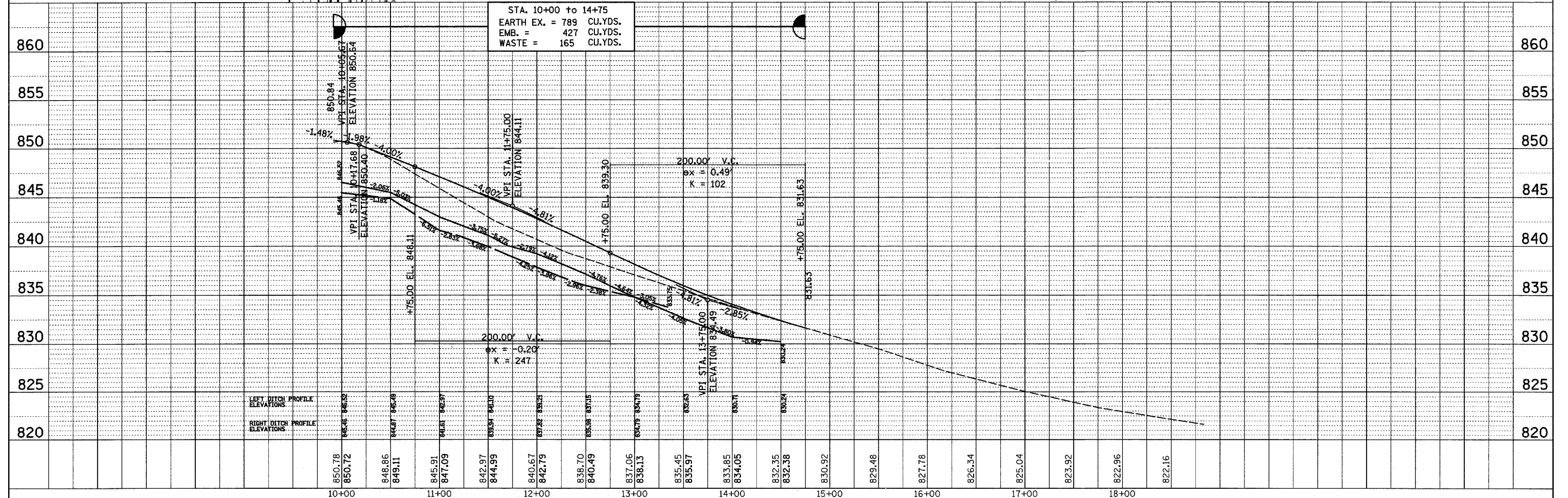
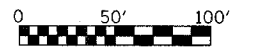

FILE NAME =	USER NAME = polzinej	DESIGNED -	REVISED -	STATE OF ILLINOIS DEPARTMENT OF TRANSPORTATION	WALNUT GROVE DR			F.A.P. RTE. 754	SECTION 101M	COUNTY BOONE	TOTAL SHEETS 49	SHEET NO. 15
at\proj\p20\9604\d09604pl.mxd		DRAWN -	REVISED -		SCALE: 1" = 50'	SHEET NO.	OF SHEETS	STA. 9+91.66 TO STA. 18+00	CONTRACT NO. 64A45			
		CHECKED -	REVISED -		ILLINOIS FED. AID PROJECT							
		DATE -	REVISED -									