

FAI/FAP RTE.	SECTION	COUNTY	TOTAL SHEETS	SHEET NO.
57/796	(46-3HBR)BP & (106BR)BP	KANKAKEE/FORD	14	1
FED. ROAD DIST. NO.	ILLINOIS	CONTRACT NO. 66846		

**INDEX OF SHEETS**

1. COVER SHEET
2. GENERAL NOTES
3. SUMMARY OF QUANTITIES
4. TYPICAL SECTIONS
5. TRAFFIC CONTROL AND PROTECTION, STANDARD 701400 (MODIFIED)
6. TRAFFIC CONTROL AND PROTECTION, STANDARD 701402 (SPECIAL)
7. STAGE I DETAILS - BRIDGE LOCATION 1 SN 046-0113
8. STAGE II DETAILS - BRIDGE LOCATION 1 SN 046-0113
- 9 - 11. EXISTING STRUCTURE PLANS - BRIDGE LOCATION 1 SN 046-0113
- 12 - 14. EXISTING STRUCTURE PLANS - BRIDGE LOCATION 2 SN 027-0071

**STANDARDS**

- |           |   |
|-----------|---|
| 000001-05 | STANDARD SYMBOLS, ABBREVIATIONS AND PATTERNS                                  |
| 635011-01 | REFLECTOR MARKER AND MOUNTING DETAILS   |
| 701011-01 | OFF-ROAD MOVING OPERATIONS 2L, 2W, DAY ONLY                                   |
| 701101-01 | OFF-ROAD OPERATIONS MULTILANE, 4.5 m (15') TO 600 mm (24") FROM PAVEMENT EDGE |
| 701301-02 | LANE CLOSURE, 2L, 2W, SHORT TIME OPERATIONS                                   |
| 701400-02 | APPROACH TO LANE CLOSURE, FREEWAY/EXPRESSWAY                                  |
| 701402-06 | LANE CLOSURE, FREEWAY/EXPRESSWAY, WITH BARRIER                                |
| 701901    | TRAFFIC CONTROL DEVICES   |
| 704001-04 | TEMPORARY CONCRETE BARRIER  |

**STATE OF ILLINOIS**  
**DEPARTMENT OF TRANSPORTATION**  
**DIVISION OF HIGHWAYS**  
**PROPOSED**  
**HIGHWAY PLANS**

**FAI ROUTE (I-57) & FAP 796 (IL 115)**  
**SECTION (46-3HBR)BP & (106BR)BP**

**KANKAKEE & FORD COUNTIES**  
**C-93-119-08**  
**BRIDGE PAINTING**

**D-93-082-08**

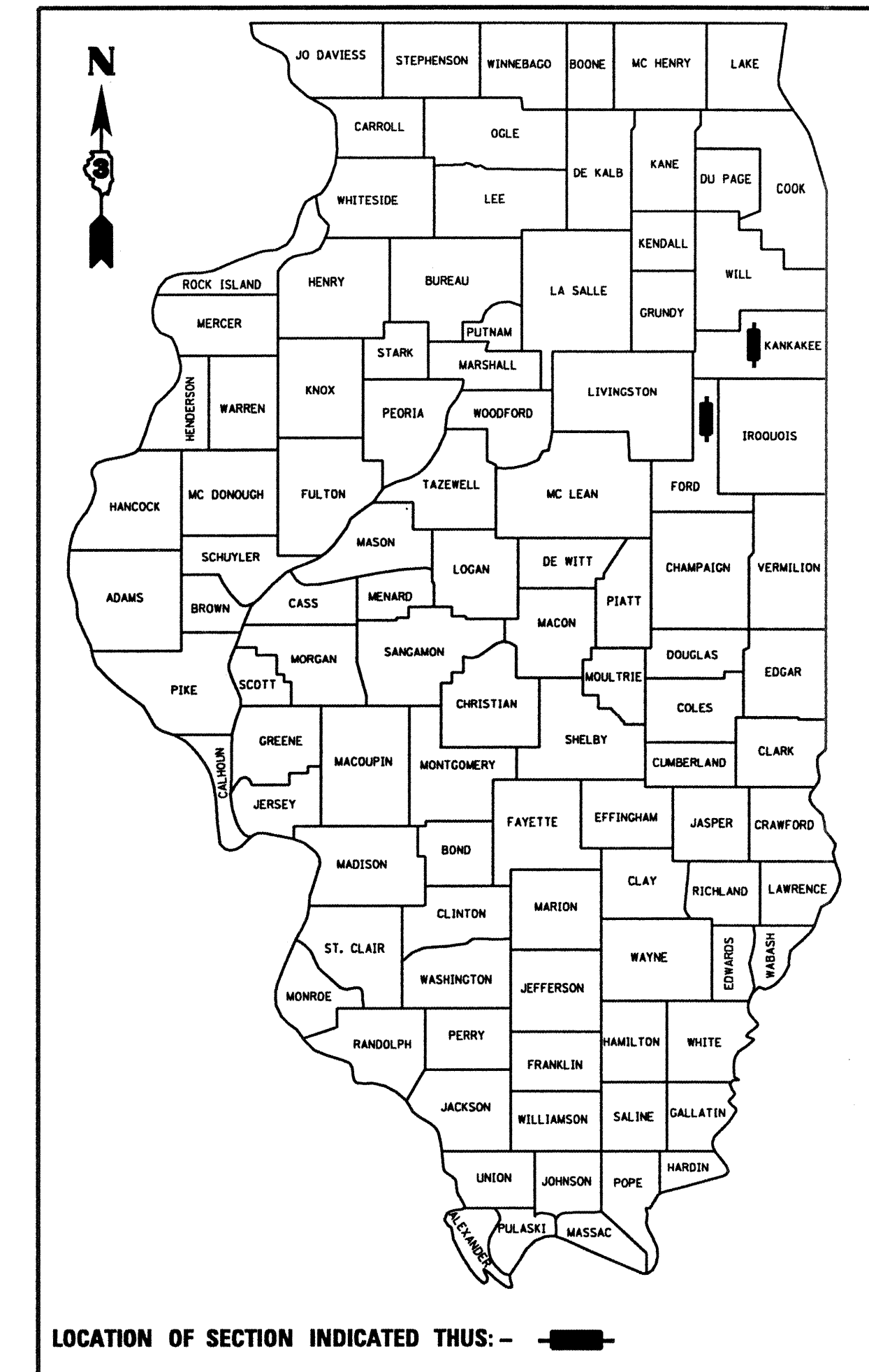

**BRIDGE LOCATION 1**  
**SN 046-0113**  
 SECTION (46-3HBR)  
 RIVER RD. OVER FAI 57  
 2.3 MI. NORTH OF US 45/52

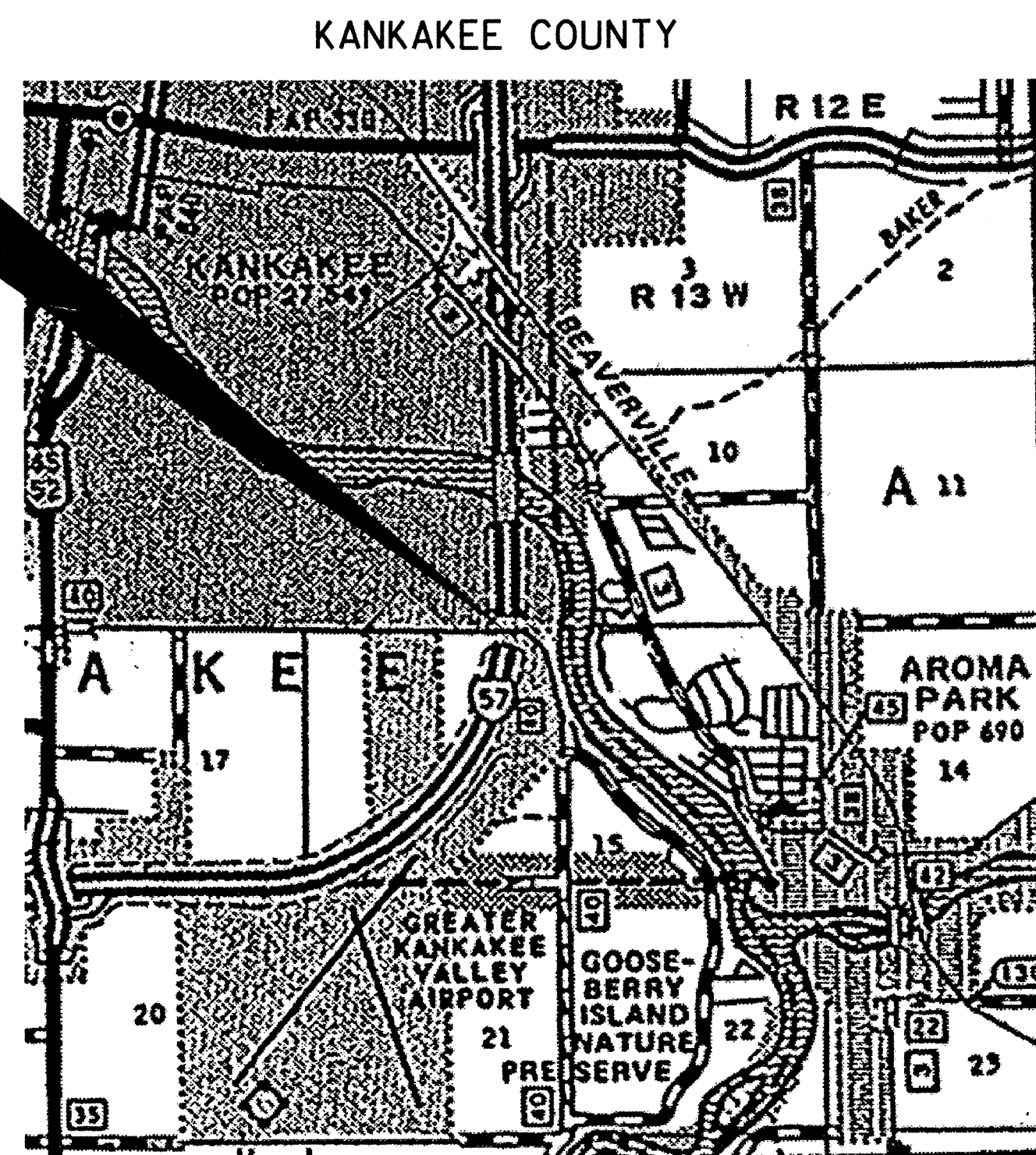

MICROFILMED \_\_\_\_\_  
 REEL NUMBER \_\_\_\_\_  
 AWARDED \_\_\_\_\_  
 RESIDENT ENGINEER \_\_\_\_\_  
 AS BUILT CHANGES WERE MADE  
 ON THE FOLLOWING SHEETS \_\_\_\_\_

J.U.L.I.E.  
 JOINT UTILITY LOCATION INFORMATION FOR EXCAVATION  
 1-800-892-0123

**DISTRICT NO. 3 815-434-6131**

**PROJECT ENGINEER: JOE KANNEL**  
**UNIT CHIEF: RON WOODSHANK**

**CONTRACT NO. 66846**

**LOCATION MAP**  
 NOT TO SCALE  
 POINT LOCATION

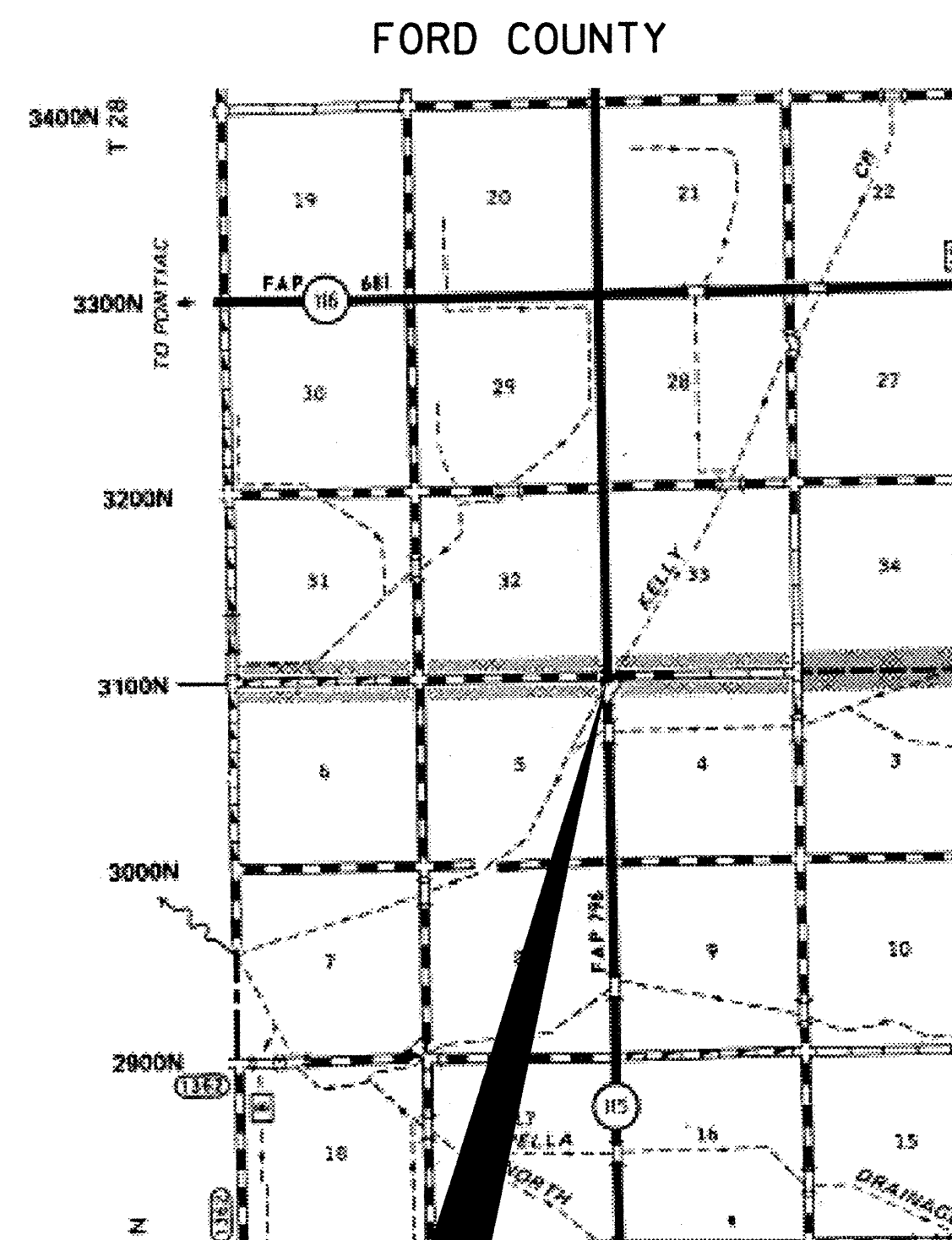

**BRIDGE LOCATION 2**  
**SN 027-0071**

SECTION (106BR)  
 IL 115 OVER CREEK  
 2.03 MI. SOUTH OF IL 116

I-57 - RURAL INTERSTATE  
 2007 ADT = 23,000  
 P.V = 69.9% M.U. = 20.4% S.U. = 5.4%  
 IL 115 - MINOR ARTERIAL  
 2007 ADT = 500  
 P.V = 92.0% M.U. = 6.0% S.U. = 2.0%

STATE OF ILLINOIS  
 DEPARTMENT OF TRANSPORTATION  
 DIVISION OF HIGHWAYS

SUBMITTED 4/28 2008  
*[Signature]*  
 DEPUTY DIRECTOR OF HIGHWAYS, REGION ENGINEER  
May 9 20 08  
*[Signature]*  
 ERIC E. HARM, JR.  
 ENGINEER OF DESIGN AND ENVIRONMENT  
May 9 20 08  
*[Signature]*  
 CHRISTINE M. REED  
 DIRECTOR OF HIGHWAYS, CHIEF ENGINEER

**PRINTED BY THE AUTHORITY**  
**OF THE STATE OF ILLINOIS**