

PLAN	SURVEYED	DATE
	ALIGNED	
	CHECKED	
	BY	
	NO. OF SHEETS	
	NO. OF SHEETS CHECKED	
	NO. OF SHEETS	
	NO. OF SHEETS	

PROFILE	SURVEYED	DATE
	ALIGNED	
	CHECKED	
	BY	
	NO. OF SHEETS	
	NO. OF SHEETS CHECKED	
	NO. OF SHEETS	
	NO. OF SHEETS	

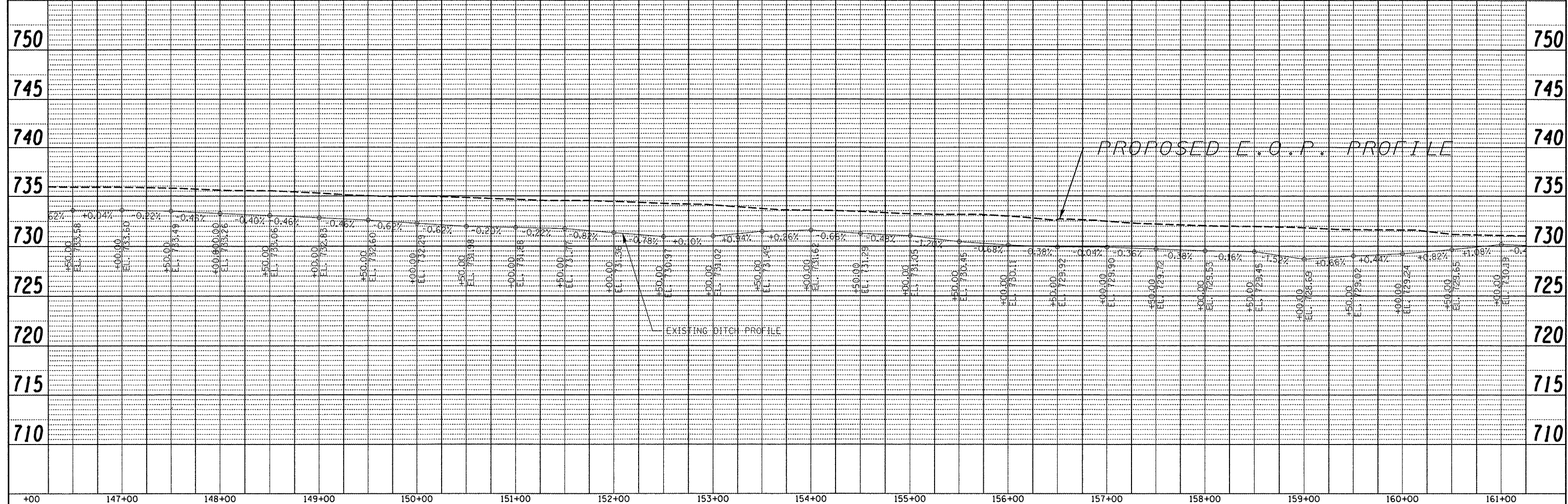
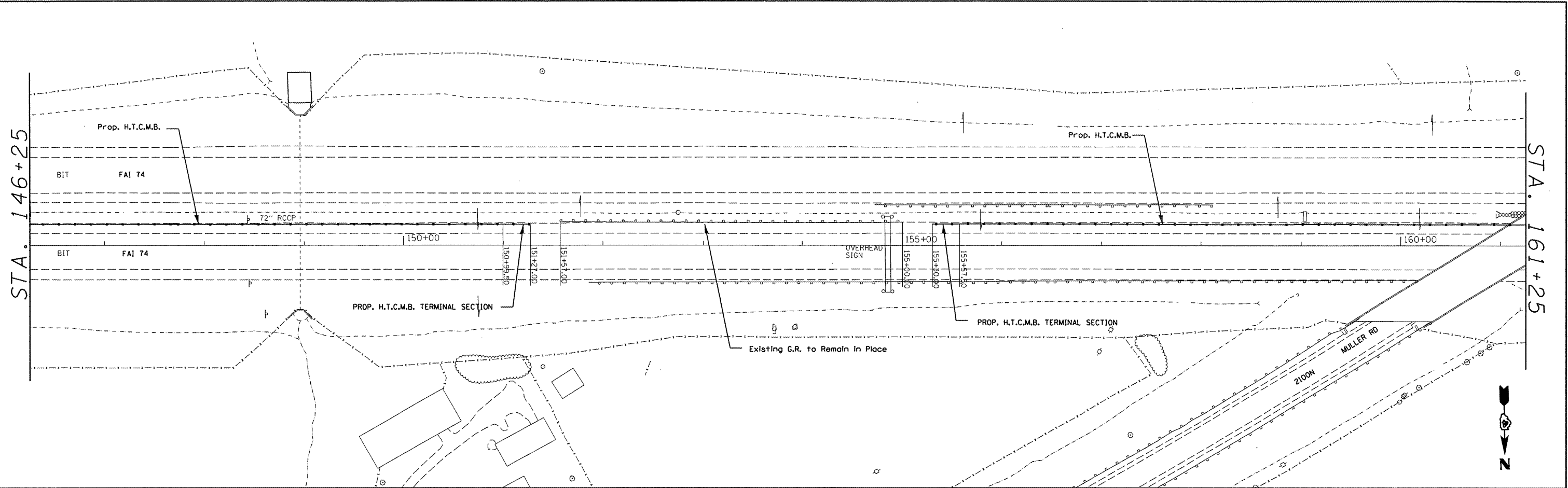

FILE NAME = C:\Projects\safety\174morton\PPSHEETS.dgn	USER NAME = brucebm	DESIGNED -	REVISED -	<b>STATE OF ILLINOIS DEPARTMENT OF TRANSPORTATION</b>	<b>Cable Rail Plan View - Section A Morton to I-474</b>	F.A.I. RTE. 74	SECTION 90-15J	COUNTY TAZEWELL	TOTAL SHEETS 192	SHEET NO. 20		
PLOT SCALE = 100.0000 / IN.	DATE = 3/21/2008	DRAWN -	REVISED -			SCALE:	SHEET NO. 7 OF 18 SHEETS	STA. 146+25	TO STA. 161+25	CONTRACT NO. 68724		
		CHECKED -	REVISED -			FED. ROAD DIST. NO. ILLINOIS FED. AID PROJECT						
		DATE -	REVISED -									