

GRADING & SHAPING DITCHES

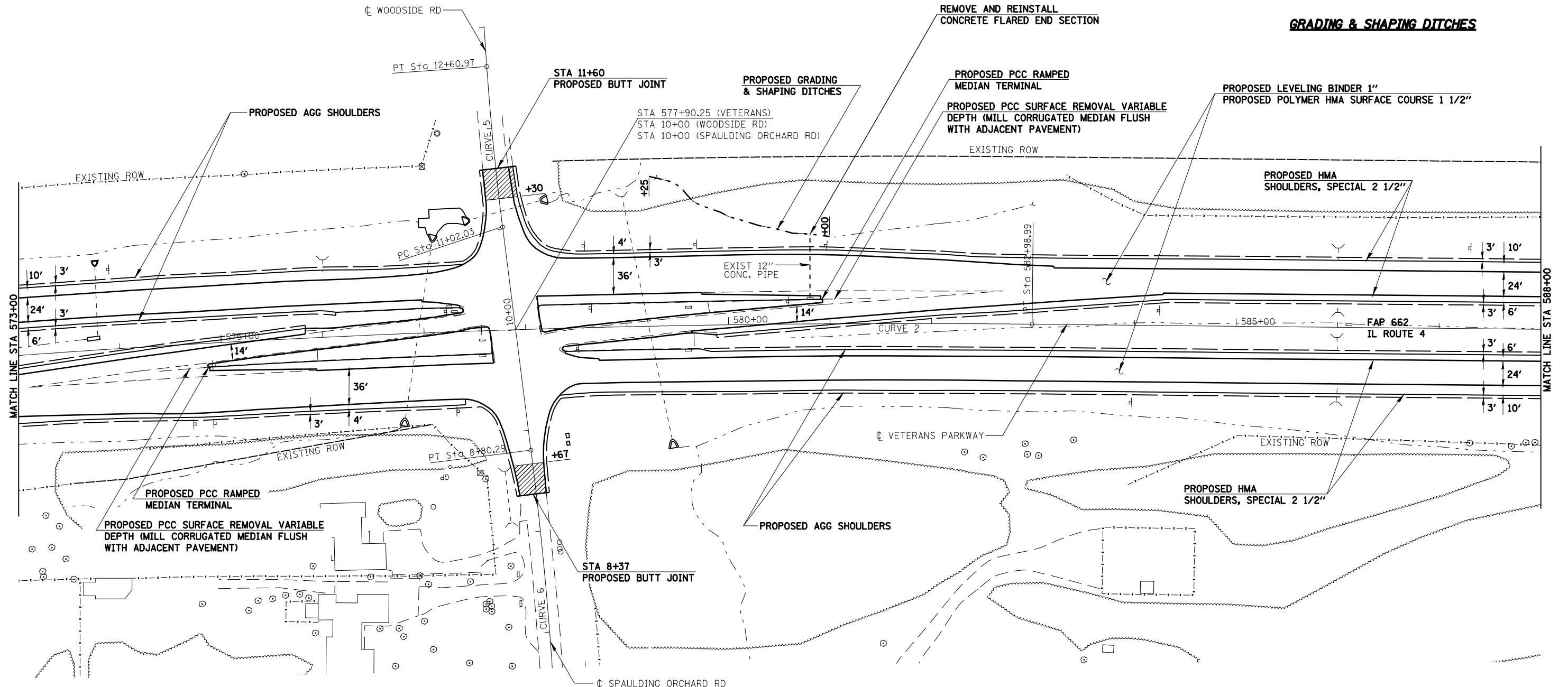

EXIST. CURVE 2
 PI STA. = 575+53.84
 $\Delta = 7^\circ 02' 22''$ (RT)
 $D = 0^\circ 28' 18''$
 $R = 12,145.22'$
 $T = 747.03'$
 $L = 1,492.18'$
 $E = 22.91'$
 P.C. STA. = 568+06.81
 P.T. STA. = 582+98.99
 $SE = 1.56\%$

EXIST. CURVE 6
 PI STA. = 6+56.84
 $\Delta = 6^\circ 54' 02''$ (LT)
 $D = 1^\circ 32' 32''$
 $R = 3,715.25'$
 $T = 224.00'$
 $L = 447.45'$
 $E = 6.75'$
 P.C. STA. = 4+32.84
 P.T. STA. = 8+80.29

EXIST. CURVE 5
 PI STA. = 11+81.52
 $\Delta = 3^\circ 14' 44''$ (RT)
 $D = 2^\circ 02' 31''$
 $R = 2,805.96'$
 $T = 79.49'$
 $L = 158.94'$
 $E = 1.13'$
 P.C. STA. = 11+02.03
 P.T. STA. = 12+60.97

① INLET TO BE ADJUSTED W/ NEW TYPE 24 FRAME & GRATE

CUMMINS ENGINEERING CORPORATION

JOB	- 2200
FILE	- sht-plan3.dgn

FILE NAME =	USER NAME = laughlinr1	DESIGNED -	NAK	REVISED -	
C:\Projects\d652204\cummins_final\d67289-sht-plan3.dgn		DRAWN -	AJH	REVISED -	
	PLOT SCALE = 100.0000' / IN.	CHECKED -	NAK	REVISED -	
	PLOT DATE = Mar-18-2008 11:39:57AM	DATE -	3/15/2008	REVISED -	

**STATE OF ILLINOIS
 DEPARTMENT OF TRANSPORTATION**

PLAN VETERANS PARKWAY

SCALE:	SHEET NO.	OF	SHEETS	STA. 573+00	TO STA. 588+00
--------	-----------	----	--------	-------------	----------------

F.A.P. RTE.	SECTION	COUNTY	TOTAL SHEETS	SHEET NO.
662	2-2(RS) & 3-1, 2(RS-10, TS-5)	SANGAMON	181	64
CONTRACT NO. 72889				
FED. ROAD DIST. NO. ILLINOIS FED. AID PROJECT				