

PLAN	SURVEYED	BY	DATE
	PLOTTED		
	CHECKED		
	FILE NAME		
	NO.		

PROFILE	SURVEYED	BY	DATE
	PLOTTED		
	CHECKED		
	NOTATION		
	NO.		

EXIST. CURVE 57
 PI STA. = 183+02.65
 $\Delta = 15^\circ 47' 02''$ (L.T)
 $D = 0^\circ 30' 00''$
 $R = 11,458.84'$
 $T = 1,588.39'$
 $L = 3,156.66'$
 $E = 109.57'$
 $e = 1.56\%$
 $T.R. = \text{-----}$
 $S.E. \text{ RUN} = \text{-----}$
 $P.C. \text{ STA.} = 167+14.26$
 $P.T. \text{ STA.} = 198+70.93$

PR DIP CORRECTION AREA

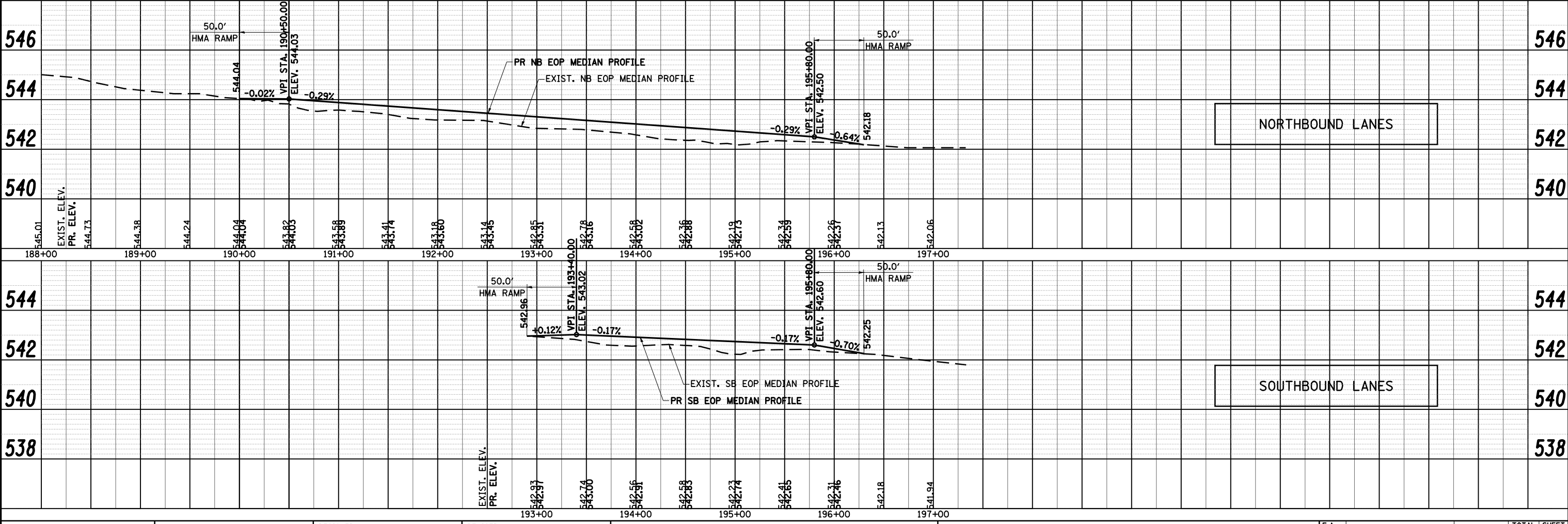
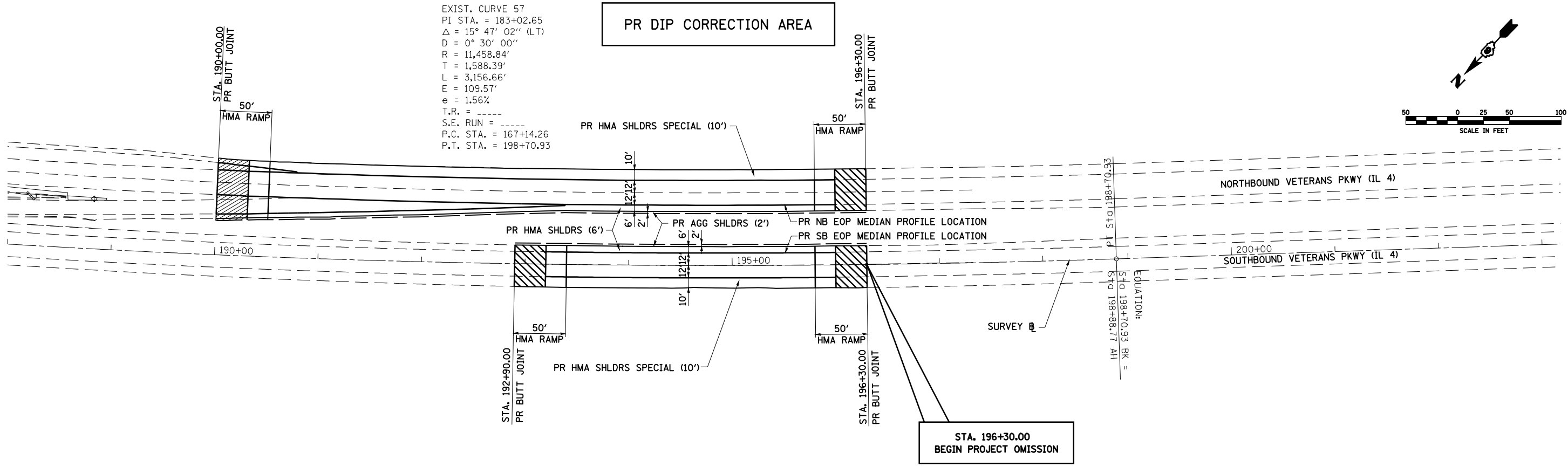
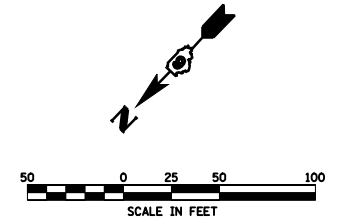

FILE NAME =	USER NAME = laughlinr1	DESIGNED -	REVISED -	STATE OF ILLINOIS DEPARTMENT OF TRANSPORTATION	VETERANS PKWY (IL 4) DIP CORRECTION	F.A. RTE.	SECTION	COUNTY	TOTAL SHEETS	SHEET NO.	
C:\Projects\d652204\cummins_f\in\1\d652204\shp\plnprf21.dgn		CHECKED -	REVISED -			662	2-2(RS&3-1,2(RS-10,TS-5)	SANGAMON	181	70	
PLOT SCALE = 100.0000' / IN.		DRAWN -	REVISED -			CONTRACT NO. 72889					
PLOT DATE = Mar-18-2008 11:40:18AM		CHECKED -	REVISED -			FED. ROAD DIST. NO. ILLINOIS FED. AID PROJECT					