

TRAFFIC SIGNAL QUANTITIES

LOCATION: SIXTH AND LINTON

QUANTITY	UNIT	ITEM
95.0	SQ FT	CONCRETE MEDIAN SURFACE, 4"
95.0	SQ FT	CONCRETE MEDIAN SURFACE REMOVAL
38.0	SQ FT	SIGN PANEL, TYPE 2
118.0	FOOT	CONDUIT IN TRENCH, 2" DIA., PVC
258.0	FOOT	CONDUIT, AUGERED, 2" DIA., PVC
118.0	FOOT	TRENCH AND BACKFILL FOR ELECTRICAL WORK
1	EACH	MAINTENANCE OF EXISTING TRAFFIC SIGNAL INSTALLATION
153.5	FOOT	ELECTRIC CABLE IN CONDUIT, SIGNAL, NO. 14, 3/C
1175.0	FOOT	ELECTRIC CABLE IN CONDUIT, SIGNAL, NO. 14, 5/C
330.0	FOOT	ELECTRIC CABLE IN CONDUIT, SIGNAL, NO. 14, 7/C
263.0	FOOT	ELECTRIC CABLE IN CONDUIT, SIGNAL, NO. 14, 9/C
153.5	FOOT	ELECTRIC CABLE IN CONDUIT, SIGNAL, NO. 14, 12/C
2	EACH	TRAFFIC SIGNAL POST, ALUMINUM, 14 FT.
2	EACH	TRAFFIC SIGNAL POST, ALUMINUM, 16 FT.
1	EACH	STEEL MAST ARM ASSEMBLY AND POLE, 16 FT.
1	EACH	STEEL MAST ARM ASSEMBLY AND POLE, 34 FT.

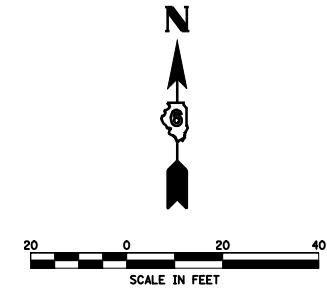
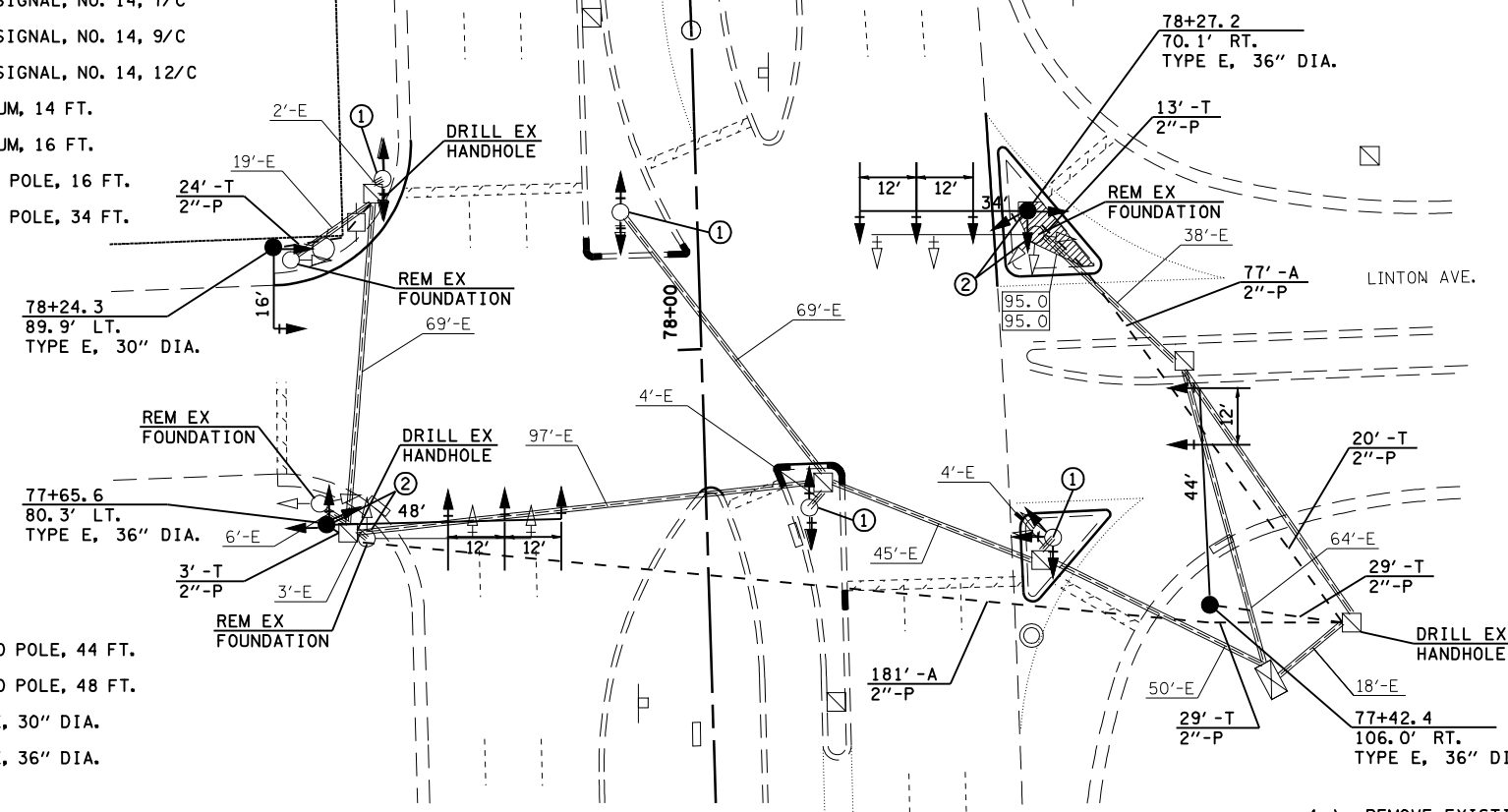

1	EACH	STEEL MAST ARM ASSEMBLY AND POLE, 44 FT.
1	EACH	STEEL MAST ARM ASSEMBLY AND POLE, 48 FT.
10.0	FOOT	CONCRETE FOUNDATION, TYPE E, 30" DIA.
37.0	FOOT	CONCRETE FOUNDATION, TYPE E, 36" DIA.
3	EACH	DRILL EXISTING HANDHOLE
7	EACH	SIGNAL HEAD, POLYCARBONATE, LED, 1-FACE, 3-SECTION, MAST ARM MOUNTED
2	EACH	SIGNAL HEAD, POLYCARBONATE, LED, 1-FACE, 4-SECTION, MAST ARM MOUNTED
1	EACH	SIGNAL HEAD, POLYCARBONATE, LED, 1-FACE, 5-SECTION, BRACKET MOUNTED
3	EACH	SIGNAL HEAD, POLYCARBONATE, LED, 2-FACE, 3-SECTION, BRACKET MOUNTED
1	EACH	SIGNAL HEAD, POLYCARBONATE, LED, 3-FACE, 3-SECTION, BRACKET MOUNTED
1	EACH	SIGNAL HEAD, POLYCARBONATE, LED, 3-FACE, 2-3 SECTION, 1-4 SECTION, BRACKET MOUNTED
1	EACH	SIGNAL HEAD, POLYCARBONATE, LED, 3-FACE, 1-3 SECTION, 1-4 SECTION, 1-5 SECTION, BRACKET MOUNTED
18	EACH	TRAFFIC SIGNAL BACKPLATE
1	EACH	MODIFY EXISTING CONTROLLER
1	EACH	REMOVE EXISTING TRAFFIC SIGNAL EQUIPMENT
4	EACH	REMOVE EXISTING CONCRETE FOUNDATION
6	EACH	GEOMETRICALLY PROGRAMMED LOUVER
565.5	FOOT	ELECTRIC CABLE IN CONDUIT, GROUND, #6 1/C (GREEN)

- 1.) REMOVE EXISTING TRAFFIC SIGNAL POST AND SIGNAL HEAD ASSEMBLY. INSTALL PROPOSED TRAFFIC SIGNAL POST ON EXISTING TYPE A FOUNDATION
- 2.) PROPOSED MAST ARMS SHALL BE INSTALLED AND OPERATIONAL PRIOR TO REMOVAL OF EXISTING MAST ARMS.
- 3.) TRAFFIC SIGNAL MAST ARM ASSEMBLIES SHALL BE DESIGNED FOR THE LOADINGS SHOWN ON THE HIGHWAY STANDARDS OR THESE SIGNAL PLANS WHICHEVER IS GREATER.
- 4.) GEOMETRICALLY PROGRAMMED LOUVERS SHALL BE SUPPLIED BY IDOT DIST. 6. SEE SPECIAL PROVISION.