

FOR INDEX OF SHEETS AND HIGHWAY  
STANDARDS, SEE SHEET 2.

STATE OF ILLINOIS  
DEPARTMENT OF TRANSPORTATION  
DIVISION OF HIGHWAYS

**PLANS FOR PROPOSED  
CONTRACT MAINTENANCE  
FAP ROUTE 745 (IL 104)  
SECTION 103I-2, 104I-1  
ADAMS COUNTY  
C96-028-08 / D96-028-08**

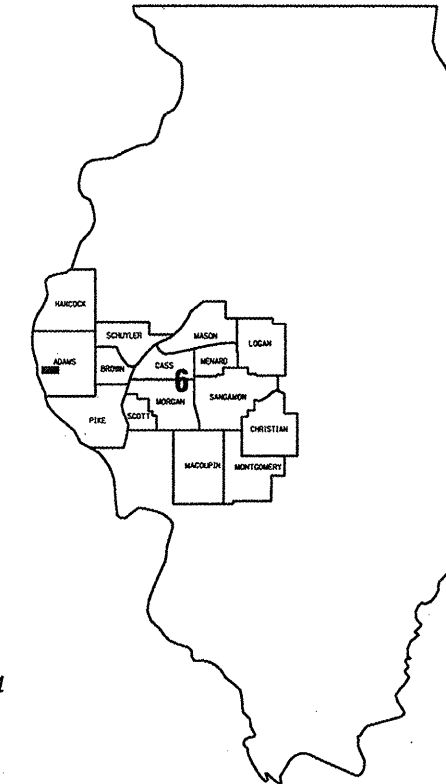

LOCATION OF SECTION INDICATED THUS: ■■■

BEGIN PROJECT  
STA. 135+00

OMISSION  
STA. 191+08 TO  
STA. 527+27.82

END PROJECT  
STA. 534+38.54

OMISSION  
STA. 157+00 TO  
STA. 189+33

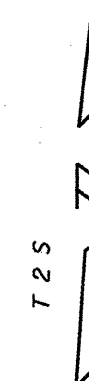
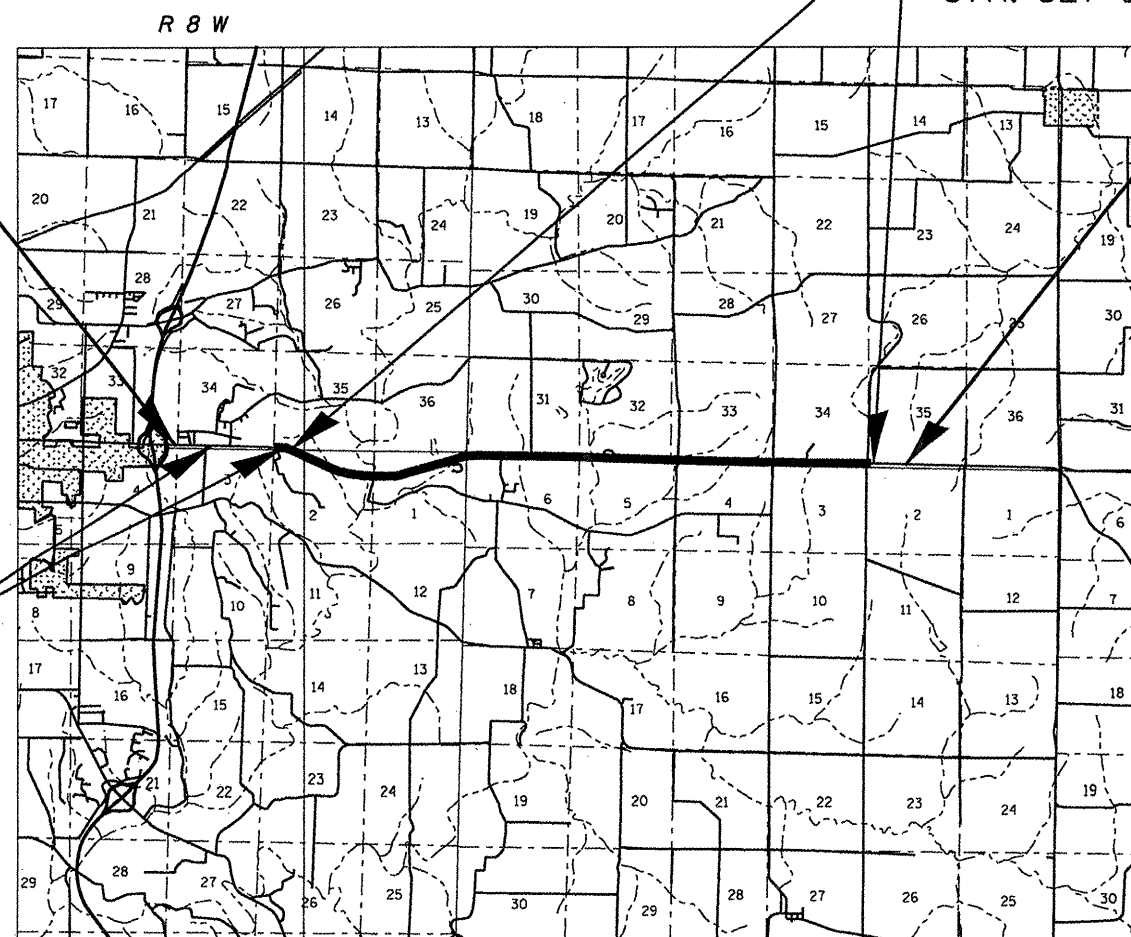

**J. U. L. I. E.**  
JOINT UTILITY LOCATION INFORMATION FOR EXCAVATION  
1-800-892-0123

PLANS & CONTRACT TECHNICIAN: TIMOTHY SHARP  
PHONE: (217) 782-7743

GROSS LTH OF SEC 40,434.25 FT = 7.658 MILES

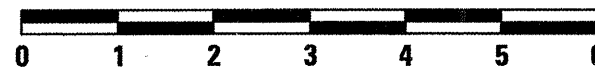

SCALE: 1" = 2 MILES

STATE OF ILLINOIS  
DEPARTMENT OF TRANSPORTATION  
DIVISION OF HIGHWAYS

SUBMITTED Jan 9 2008  
[Signature]  
DEPUTY DIRECTOR OF HIGHWAYS, REGION FOUR ENGINEER

May 9, 2008  
[Signature]  
Interim ENGINEER OF DESIGN AND ENVIRONMENT

May 9, 2008  
[Signature]  
DIRECTOR, DIVISION OF HIGHWAYS



**CONTRACT NO. 72B68**

**INDEX**

1 COVER  
2 INDEX/STANDARDS/SIGNATURES  
3-4 QUANTITIES  
5 LOCATION MAP  
6-8 TYPICAL SECTIONS  
9-15 PLAN  
16-22 PAVEMENT MARKING  
23 BUTT JOINT DETAIL

**STANDARDS**

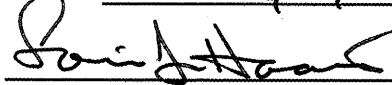
- 701101-01  
701400-02  
701406-04  
701421-01  
701426-02  
701602-03  
701606-05  
701701-05  
701901  
780001-02  
781001-02

<b>STATE OF ILLINOIS DEPARTMENT OF TRANSPORTATION DIVISION OF HIGHWAYS DISTRICT 6</b>	
EXAMINED	<u>January 7</u> 20 <u>08</u>  ENGINEER OF OPERATIONS
EXAMINED	<u>Dec 20</u> 20 <u>07</u>  ENGINEER OF PROGRAM IMPLEMENTATION
EXAMINED	<u>Jan 4</u> 20 <u>08</u>  ENGINEER OF PROGRAM DEVELOPMENT

<b>MIXTURE REQUIREMENTS</b>	
THE FOLLOWING MIXTURE REQUIREMENTS ARE APPLICABLE FOR THIS PROJECT	
MIXTURE USE(S):	H.M.A. S.C., MIX D, N70
AC/PG	SBS PG 64-22
DESIGN AIR VOIDS:	4.0% @ N DESIGN = 70
MIXTURE COMP:	IL 9.5 OR 12.5
FRICTION AGG:	MIX "D"

INDEX/STANDARDS/SIGNATURES  
FAP 745 (IL 104)  
SECTION 103I-2, 104I-1  
ADAMS COUNTY

Rev.

SUMMARY OF QUANTITIES

CODE NO.	ITEM	UNIT	100% STATE
			I000
			TOTAL QTY
40600200	BITUMINOUS MATERIALS (PRIME COAT)	TON	7.9
40600300	AGGREGATE (PRIME COAT)	TON	41.4
40600895	CONSTRUCTING TEST STRIP	EACH	1
40600990	TEMPORARY RAMP	SQ YD	136
40603540	<i>POLYMERIZED</i> HOT-MIX ASPHALT SURFACE COURSE, MIX "D", N70	TON	1,739
44000155	HOT-MIX ASPHALT SURFACE REMOVAL, 1 1/2"	SQ YD	20,698
67100100	MOBILIZATION	L SUM	1
70100310	TRAFFIC CONTROL AND PROTECTION, STANDARD 701421	L SUM	1
70100450	TRAFFIC CONTROL AND PROTECTION, STANDARD 701201	L SUM	1
70100700	TRAFFIC CONTROL AND PROTECTION, STANDARD 701406	L SUM	1
70100460	TRAFFIC CONTROL AND PROTECTION, STANDARD 701306	L SUM	1
70102625	TRAFFIC CONTROL AND PROTECTION, STANDARD 701606	L SUM	1
70102632	TRAFFIC CONTROL AND PROTECTION, STANDARD 701602	L SUM	1
70102635	TRAFFIC CONTROL AND PROTECTION, STANDARD 701701	L SUM	1
70300100	SHORT-TERM PAVEMENT MARKING	FOOT	2,672
70300210	TEMPORARY PAVMENT MARKING - LETTERS AND SYMBOLS	SQ FT	219

Rev.

QUANTITIES  
FAP 745 (IL 104)  
SECTION 103I-2, 104I-1  
ADAMS COUNTY

S U M M A R Y O F Q U A N T I T I E S

CODE NO.	ITEM	UNIT	100% STATE
			I 000
			TOTAL QTY
70300230	TEMPORARY PAVEMENT MARKING - LINE 5"	FOOT	12,465
70300240	TEMPORARY PAVEMENT MARKING - LINE 6"	FOOT	360
70300260	TEMPORARY PAVEMENT MARKING - LINE 12"	FOOT	510
70300280	TEMPORARY PAVEMENT MARKING - LINE 24"	FOOT	50
70301000	WORK ZONE PAVEMENT MARKING REMOVAL	SQ FT	445
78001100	PAINT PAVEMENT MARKING - LETTERS AND SYMBOLS	SQ FT	219
78001120	PAINT PAVEMENT MARKING - LINE 5"	FOOT	12,465
78001130	PAINT PAVEMENT MARKING - LINE 6"	FOOT	360
78001150	PAINT PAVEMENT MARKING - LINE 12"	FOOT	510
78001180	PAINT PAVEMENT MARKING - LINE 24"	FOOT	50
78100100	RAISED REFLECTIVE PAVEMENT MARKER	EACH	219
78300200	RAISED REFLECTIVE PAVEMENT MARKER REMOVAL	EACH	219

\* SPECIALTY ITEMS

QUANTITIES  
FAP 745 (IL 104)  
SECTION 103I-2, 104I-1  
ADAMS COUNTY

END OMISSION  
STA. 189+33

BEGIN OMISSION  
STA. 157+00

BEGIN PROJECT  
STA. 135+00

BEGIN OMISSION  
STA. 191+08

END OMISSION  
STA. 527+27.82

END PROJECT  
STA. 534+38.54

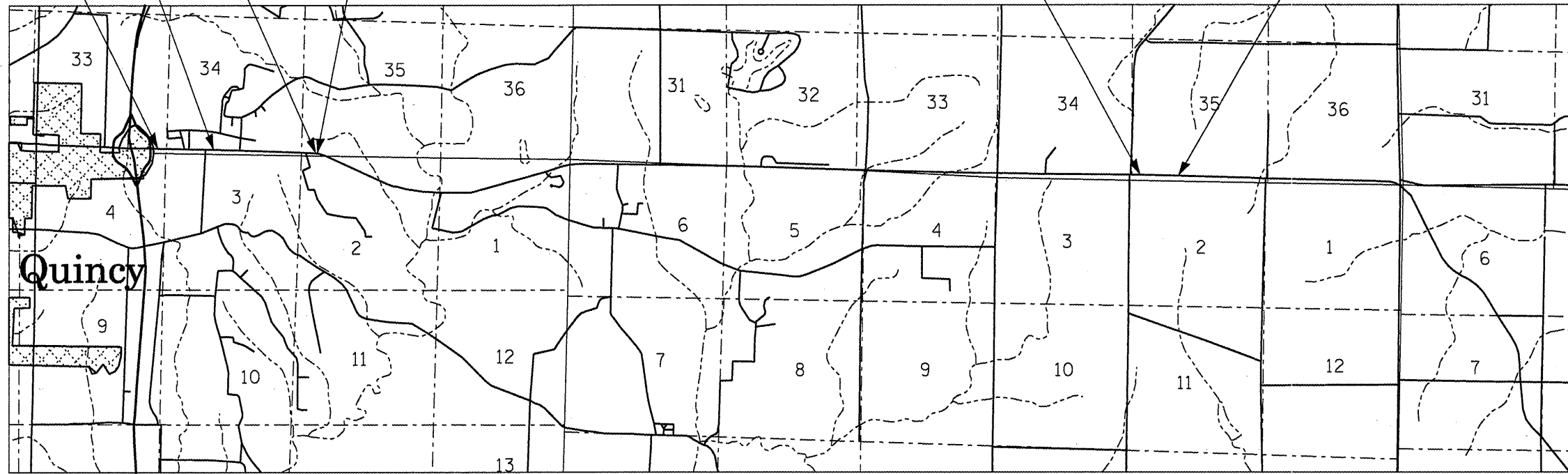

LOCATION MAP  
FAP 745 (IL 104)  
SECTION 103I-2, 104I-1  
ADAMS COUNTY

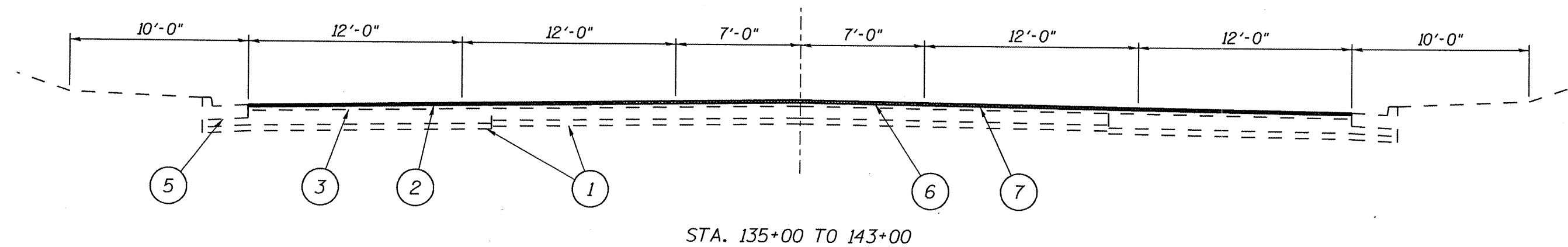

STA. 135+00 TO 143+00

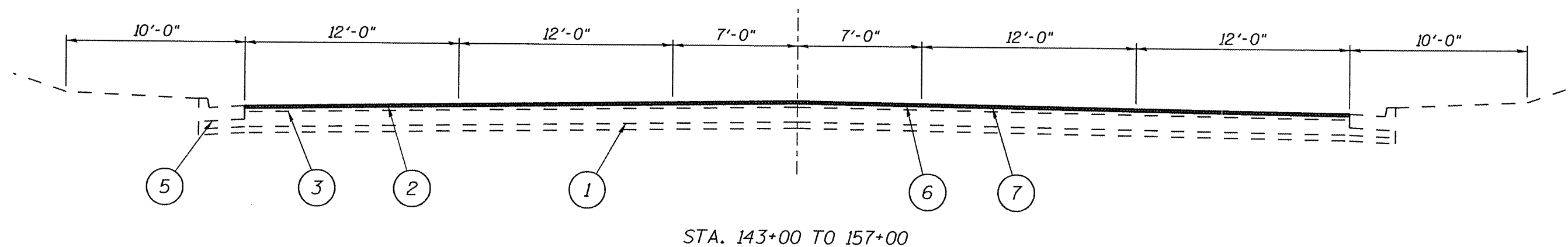

STA. 143+00 TO 157+00

LEGEND

- 1 - EXIST. PAVEMENT
- 2 - EXIST. H.M.A. SURFACE COURSE 1 1/2"
- 3 - EXIST. H.M.A. BINDER COURSE 2 1/2"
- 4 - EXIST. H.M.A. SHOULDER
- 5 - EXIST. CURB AND GUTTER, TYPE B-6.24
- 6 - PROP. H.M.A. SURFACE REMOVAL 1 1/2"
- 7 - PROP. POLY. H.M.A. SURFACE COURSE, MIX D, N70 1 1/2"

TYPICALS  
FAP 745 (IL 104)  
SECTION 103I-2, 104I-1  
ADAMS COUNTY

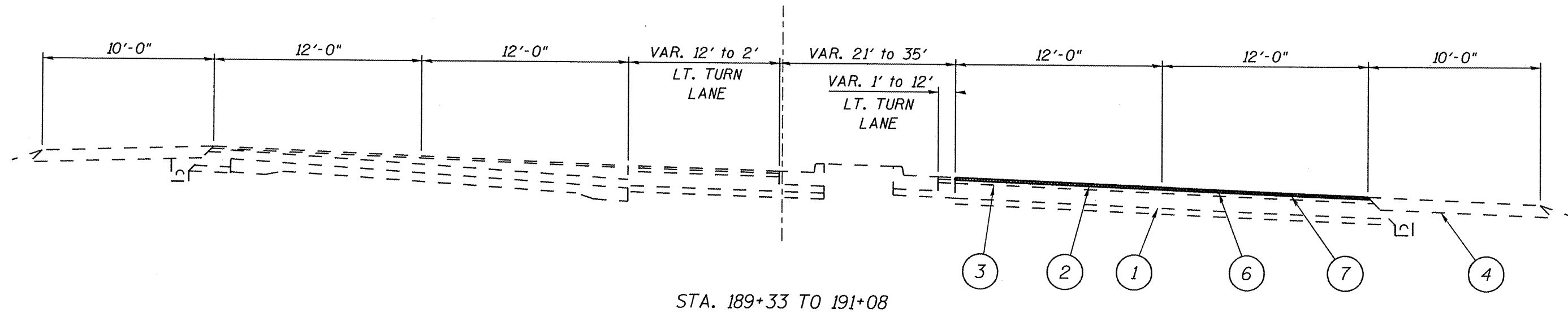

LEGEND

- 1 - EXIST. PAVEMENT
- 2 - EXIST. H.M.A. SURFACE COURSE 1 1/2"
- 3 - EXIST. H.M.A. BINDER COURSE 2 1/2"
- 4 - EXIST. H.M.A. SHOULDER
- 5 - EXIST. CURB AND GUTTER, TYPE B-6.24
- 6 - PROP. H.M.A. SURFACE REMOVAL 1 1/2"
- 7 - PROP. POLY. H.M.A. SURFACE COURSE, MIX D, N70 1 1/2"

TYPICALS  
FAP 745 (IL 104)  
SECTION 1031-2, 1041-1  
ADAMS COUNTY

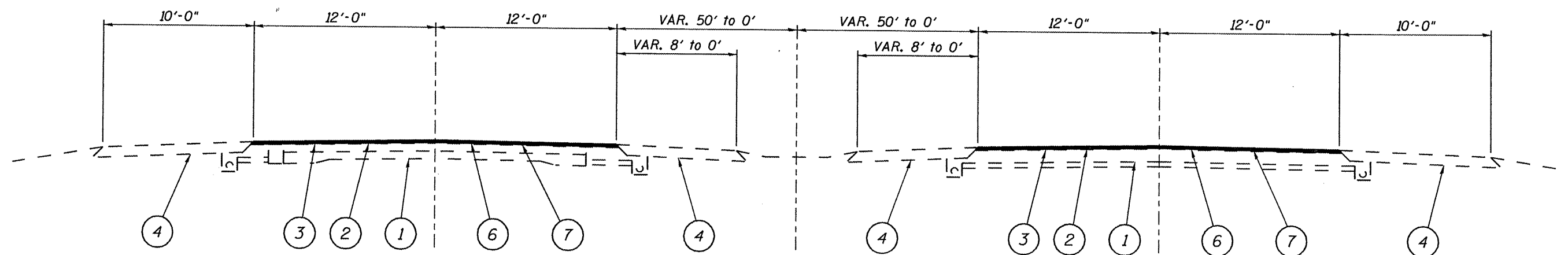

STA. 527+27.82 TO 527+99.82  
STA. EQ. 527+99.82bk = 0+00.00ah  
STA. 0+00 TO 6+78.9

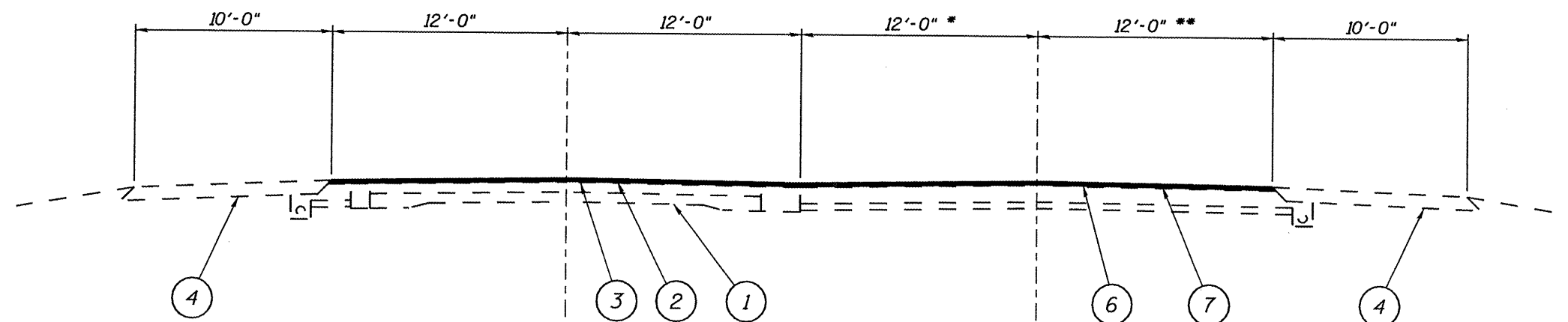

STA. 6+78.9 TO 534+38.54  
STA. EQ. 11+07.58bk = 534+08.54ah  
STA. 534+08.54 TO 534+38.54

\* VARIES FROM 12' WIDE AT STA. 6+78.9 TO 0' WIDE AT STA. 8+05

\*\* 12' WIDE AT STA. 6+78.9 TO STA 8+05 AND VARIES FROM 12' WIDE AT STA. 8+05 TO 0' WIDE AT STA. 11+07.58

LEGEND

- 1 - EXIST. PAVEMENT
- 2 - EXIST. H.M.A. SURFACE COURSE 1 1/2"
- 3 - EXIST. H.M.A. BINDER COURSE 2 1/2"
- 4 - EXIST. H.M.A. SHOULDER
- 5 - EXIST. CURB AND GUTTER, TYPE B-6.24
- 6 - PROP. H.M.A. SURFACE REMOVAL 1 1/2"
- 7 - PROP. POLY. H.M.A. SURFACE COURSE, MIX D, N70 1 1/2"

TYPICALS  
FAP 745 (IL 104)  
SECTION 1031-2, 1041-1  
ADAMS COUNTY



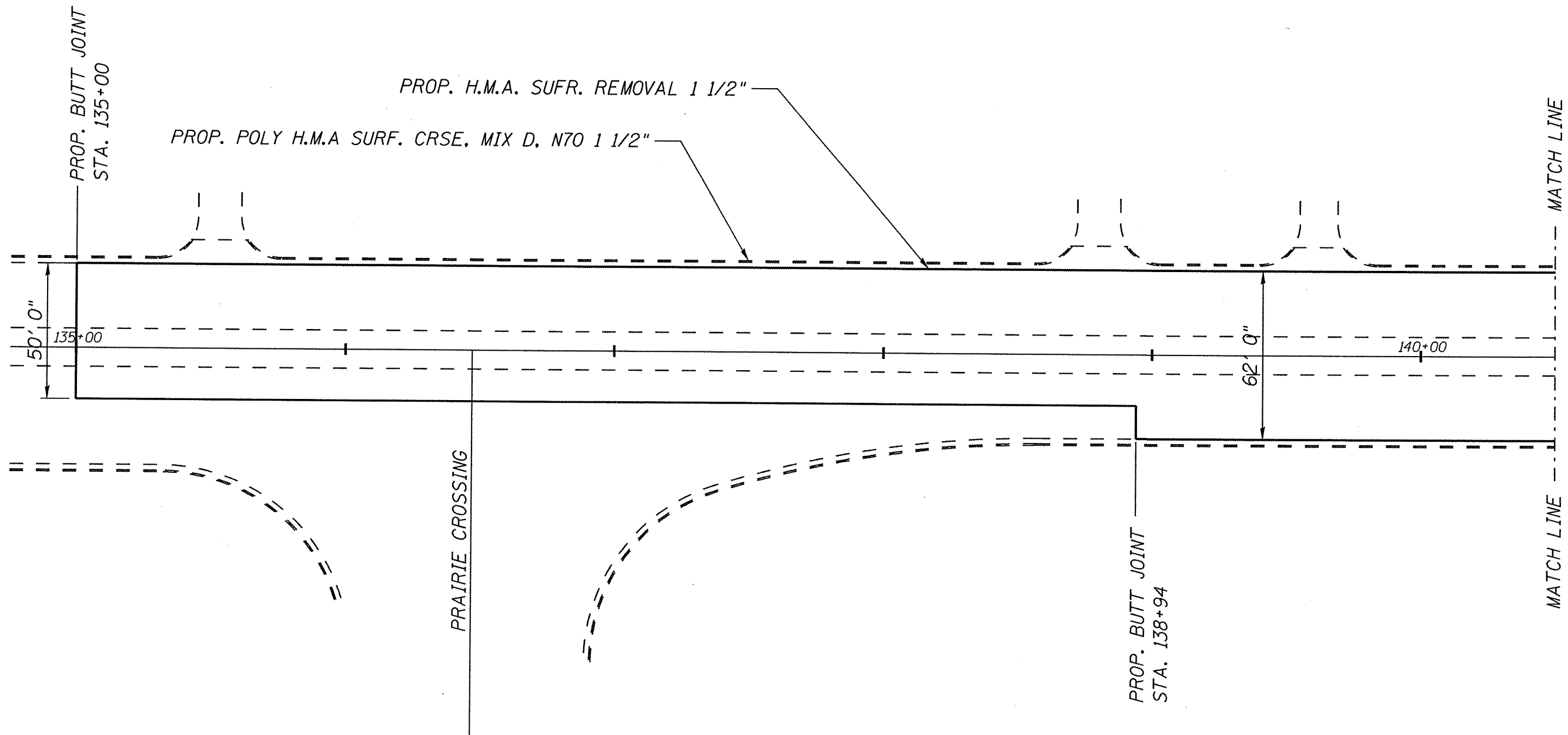

PLAN  
FAP 745 (IL 104)  
SECTION 1031-2, 1041-1  
ADAMS COUNTY

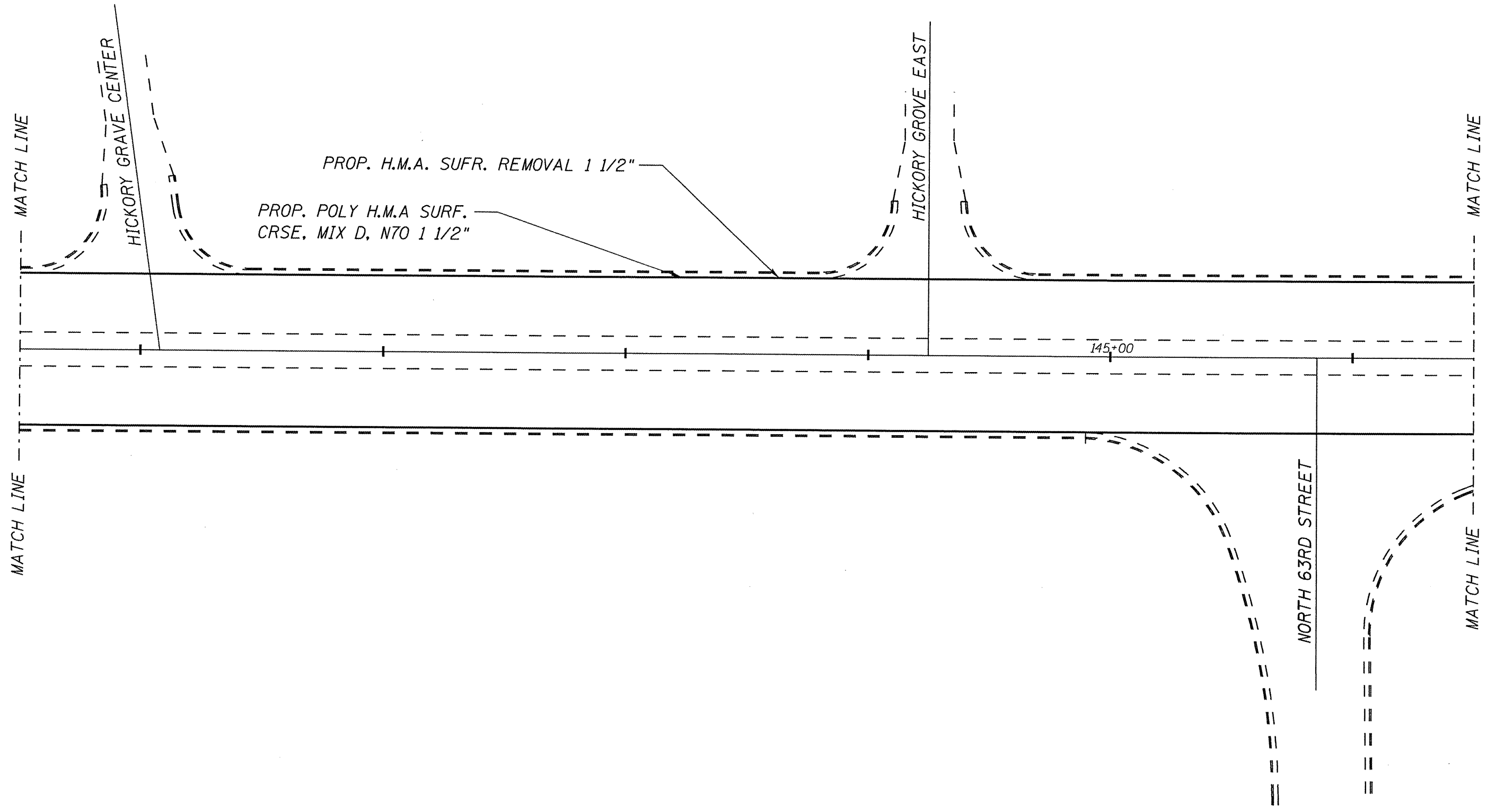

PLAN  
FAP 745 (IL 104)  
SECTION 1031-2, 1041-1  
ADAMS COUNTY

MATCH LINE

MATCH LINE

PROP. H.M.A. SUFR. REMOVAL 1 1/2"  
PROP. POLY H.M.A SURF.  
CRSE, MIX D, N70 1 1/2"

150+00

MATCH LINE

MATCH LINE

PLAN  
FAP 745 (IL 104)  
SECTION 1031-2, 1041-1  
ADAMS COUNTY

MATCH LINE

MATCH LINE

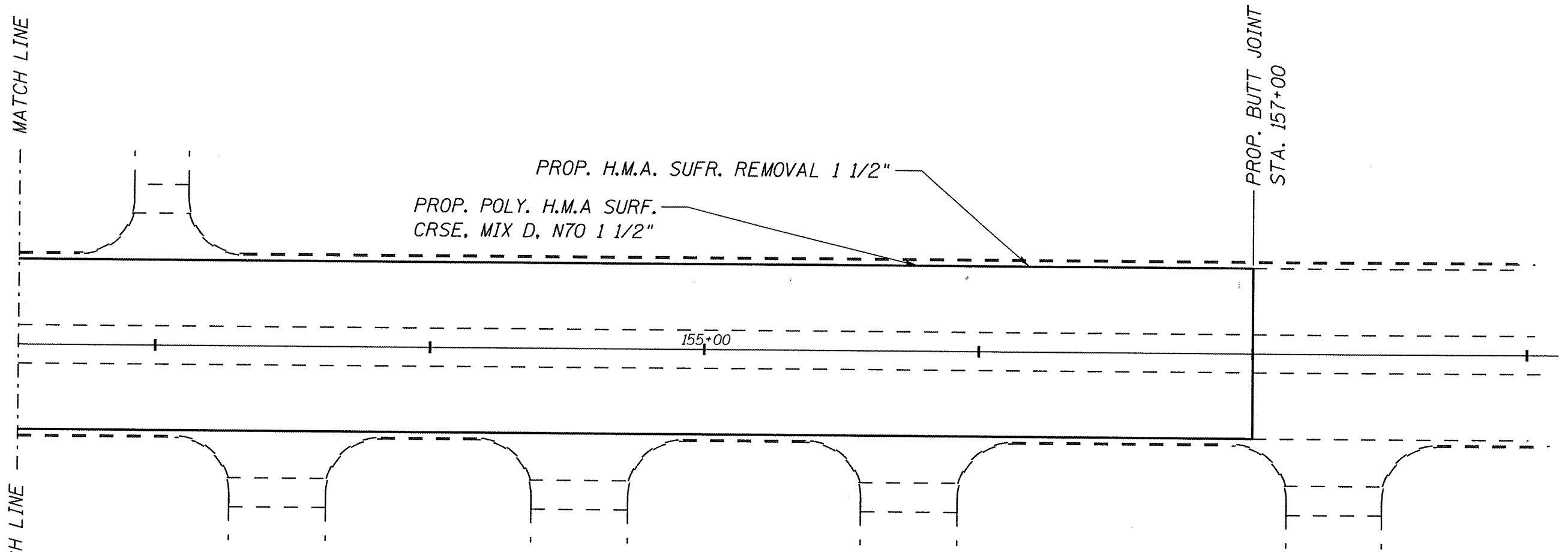

PLAN  
FAP 745 (IL 104)  
SECTION 1031-2, 1041-1  
ADAMS COUNTY

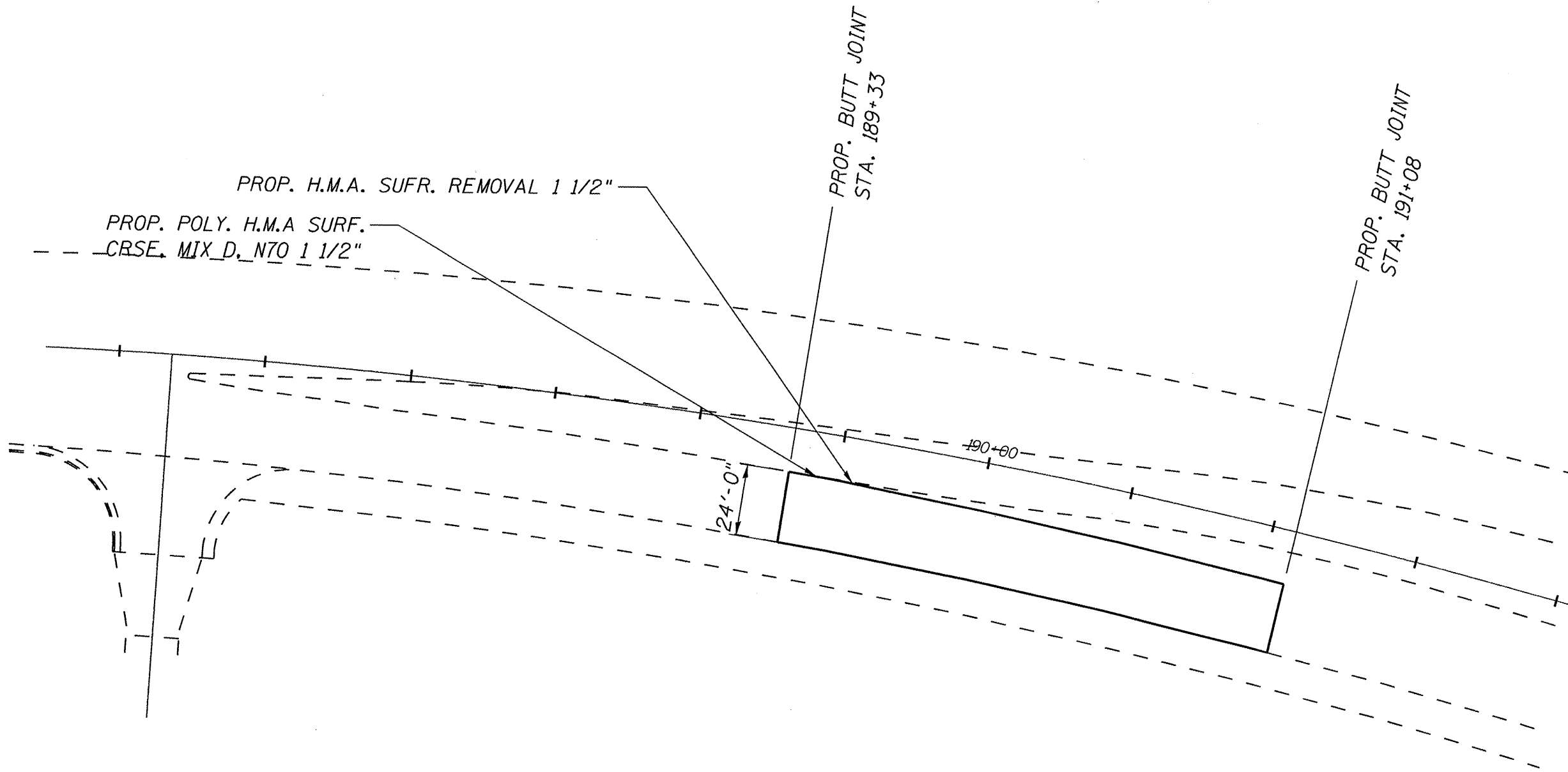

PLAN  
FAP 745 (IL 104)  
SECTION 1031-2, 1041-1  
ADAMS COUNTY

PROP. BUTT JOINT  
527+27.82

PROP. H.M.A. SURF. REMOVAL 1 1/2"  
PROP. POLY. H.M.A SURF.  
CRSE, MIX D, N70 1 1/2"

MATCH LINE

530+00

0+00 CROSSOVER  
STA. 527+99.82 M.L.  
END TAPER RT.

P.O.C. 3+03  
CROSSOVER

MATCH LINE

PLAN  
FAP 745 (IL 104)  
SECTION 1031-2, 1041-1  
ADAMS COUNTY

MATCH LINE

PROP. H.M.A. SURF. REMOVAL 1 1/2"  
PROP. POLY. H.M.A SURF.  
CRSE, MIX D, N70 1 1/2"

STA. EQ. 539+04.26bk  
= 534+08.54ch  
PROP. BUTT JOINT  
STA. 534+38.54

535+00

P.O.C. 8+05  
CROSSOVER

P.T. 11+07.58 CROSSOVER  
= 539+04.28 M.L.

PLAN  
FAP 745 (IL 104)  
SECTION 1031-2, 1041-1  
ADAMS COUNTY

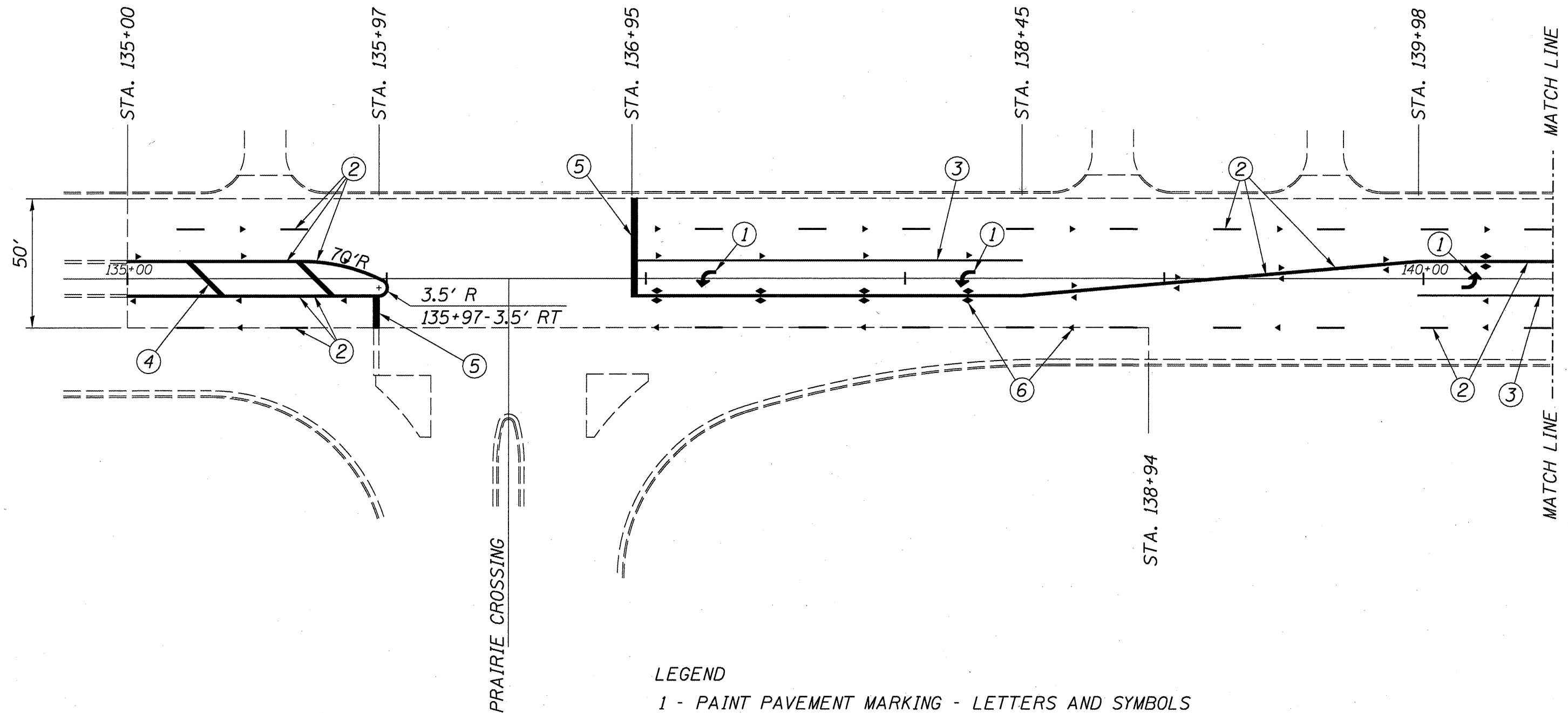

LEGEND

- 1 - PAINT PAVEMENT MARKING - LETTERS AND SYMBOLS
- 2 - PAINT PAVEMENT MARKING - LINE 5"
- 3 - PAINT PAVEMENT MARKING - LINE 6"
- 4 - PAINT PAVEMENT MARKING - LINE 12"
- 5 - PAINT PAVEMENT MARKING - LINE 24"
- 6 - RAISED REFLECTIVE PAVEMENT MARKER

PAVEMENT MARKINGS  
FAP 745 (IL 104)  
SECTION 103I-2, 104I-1  
ADAMS COUNTY



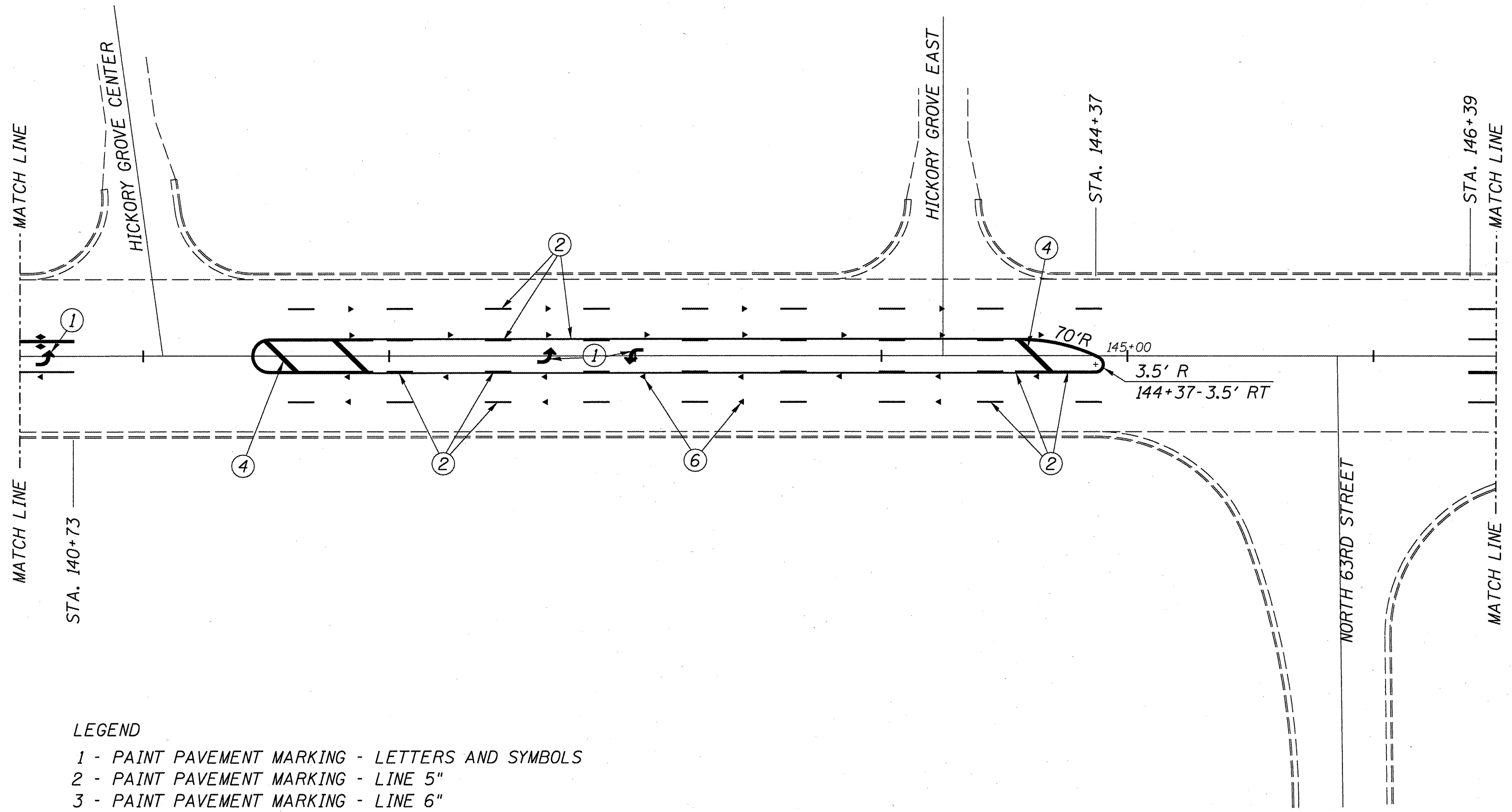

LEGEND

- 1 - PAINT PAVEMENT MARKING - LETTERS AND SYMBOLS
- 2 - PAINT PAVEMENT MARKING - LINE 5"
- 3 - PAINT PAVEMENT MARKING - LINE 6"
- 4 - PAINT PAVEMENT MARKING - LINE 12"
- 5 - PAINT PAVEMENT MARKING - LINE 24"
- 6 - RAISED REFLECTIVE PAVEMENT MARKER

PAVEMENT MARKINGS  
FAP 745 (IL 104)  
SECTION 103I-2, 104I-1  
ADAMS COUNTY

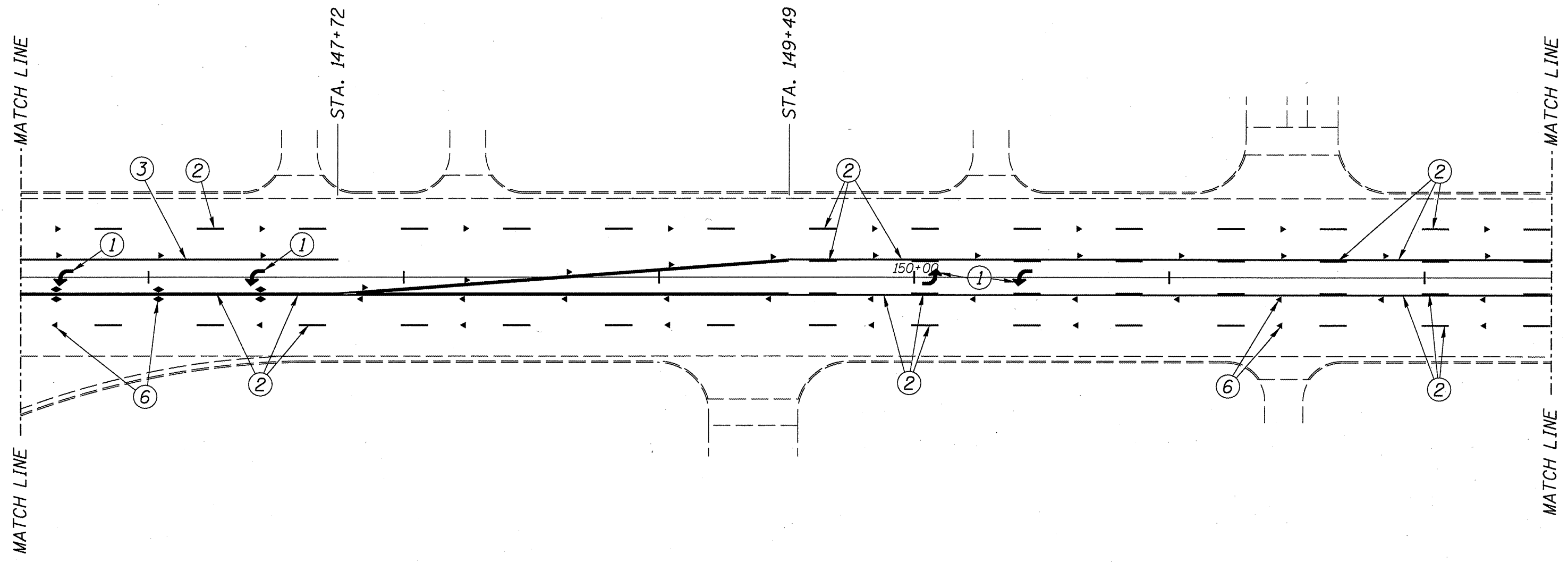

LEGEND

- 1 - PAINT PAVEMENT MARKING - LETTERS AND SYMBOLS
- 2 - PAINT PAVEMENT MARKING - LINE 5"
- 3 - PAINT PAVEMENT MARKING - LINE 6"
- 4 - PAINT PAVEMENT MARKING - LINE 12"
- 5 - PAINT PAVEMENT MARKING - LINE 24"
- 6 - RAISED REFLECTIVE PAVEMENT MARKER

PAVEMENT MARKINGS  
FAP 745 (IL 104)  
SECTION 103I-2, 104I-1  
ADAMS COUNTY

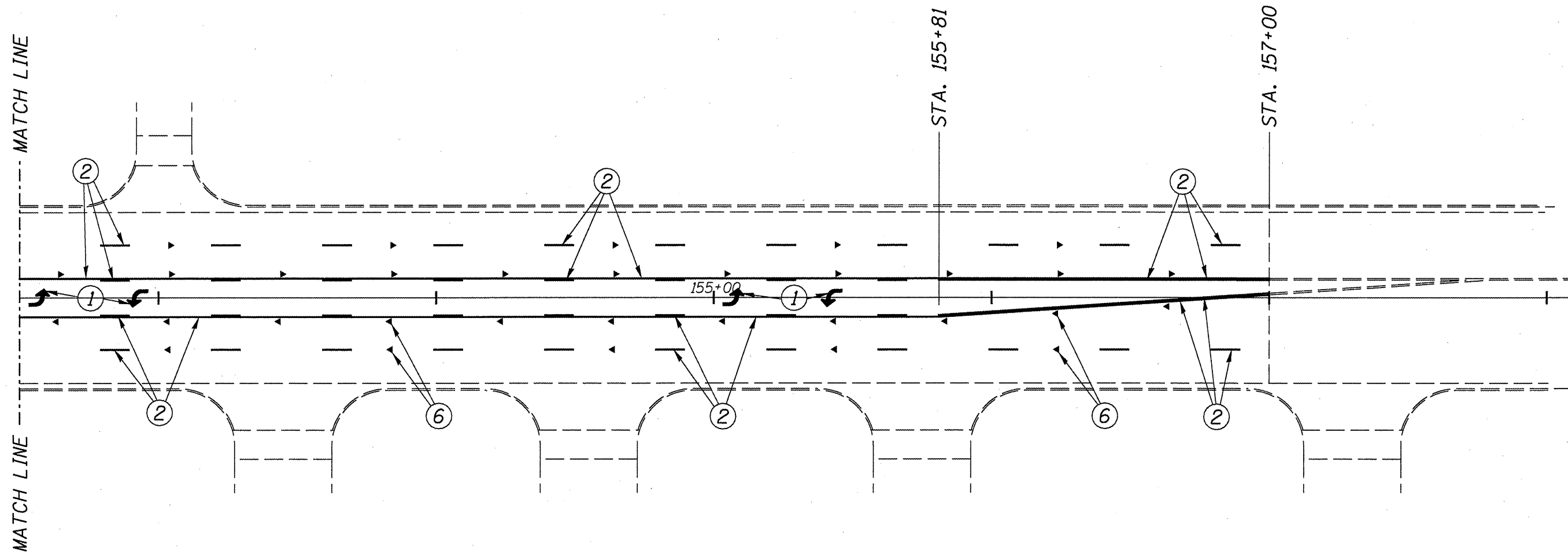

LEGEND

- 1 - PAINT PAVEMENT MARKING - LETTERS AND SYMBOLS
- 2 - PAINT PAVEMENT MARKING - LINE 5"
- 3 - PAINT PAVEMENT MARKING - LINE 6"
- 4 - PAINT PAVEMENT MARKING - LINE 12"
- 5 - PAINT PAVEMENT MARKING - LINE 24"
- 6 - RAISED REFLECTIVE PAVEMENT MARKER

PAVEMENT MARKINGS  
FAP 745 (IL 104)  
SECTION 103I-2, 104I-1  
ADAMS COUNTY

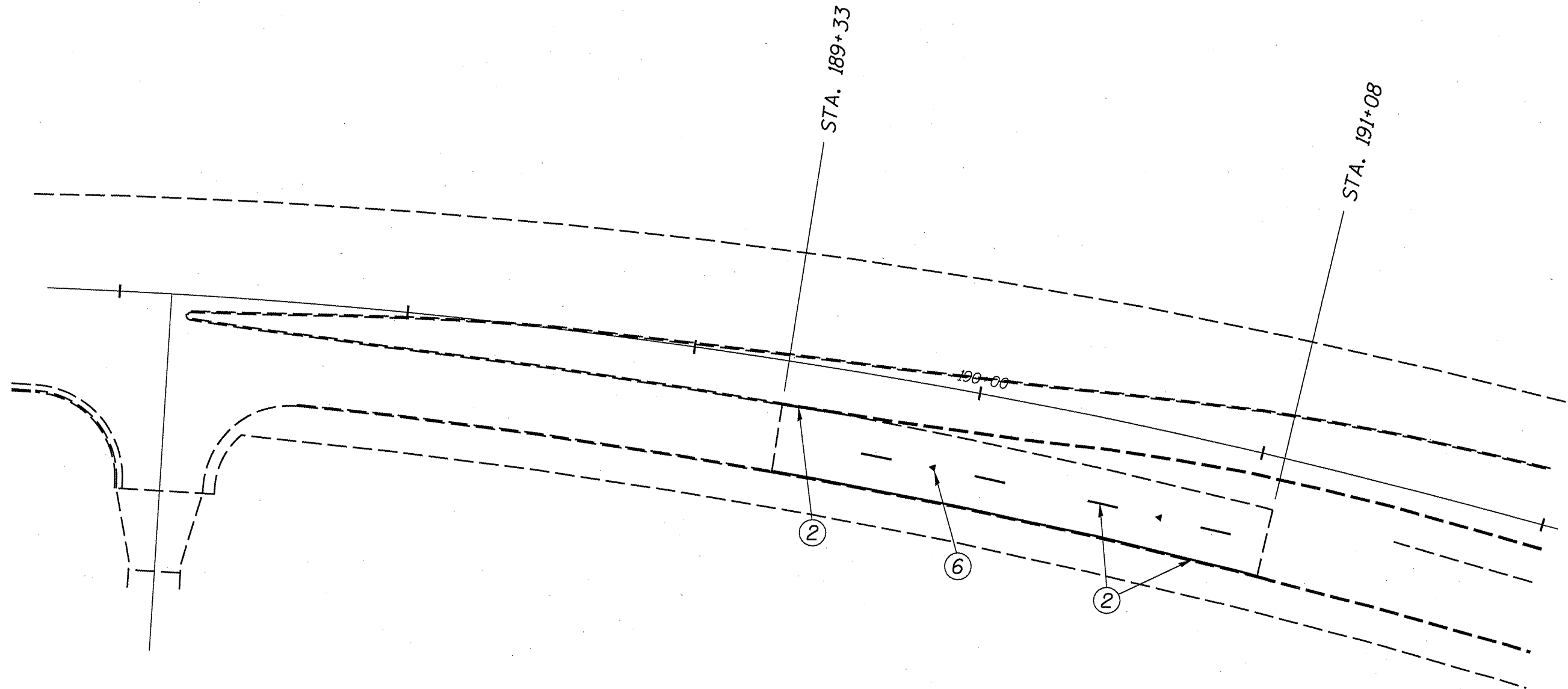

LEGEND

- 1 - PAINT PAVEMENT MARKING - LETTERS AND SYMBOLS
- 2 - PAINT PAVEMENT MARKING - LINE 5"
- 3 - PAINT PAVEMENT MARKING - LINE 6"
- 4 - PAINT PAVEMENT MARKING - LINE 12"
- 5 - PAINT PAVEMENT MARKING - LINE 24"
- 6 - RAISED REFLECTIVE PAVEMENT MARKER

PAVEMENT MARKINGS  
FAP 745 (IL 104)  
SECTION 103I-2, 104I-1  
ADAMS COUNTY

527+27.82

MATCH LINE

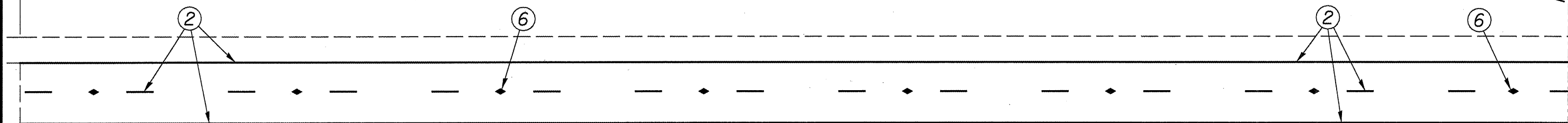

530+00

MATCH LINE

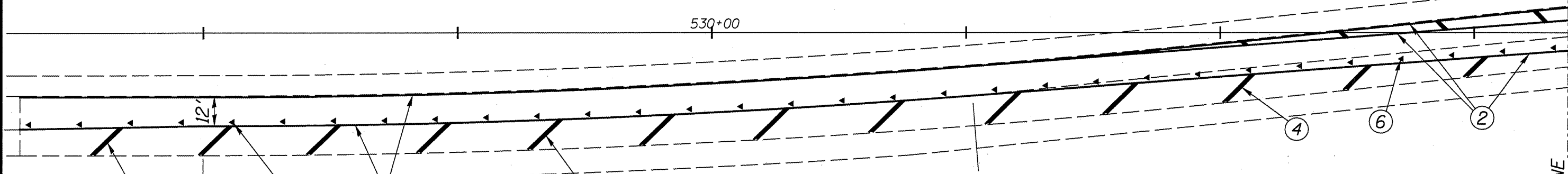

0+00 CROSSOVER  
STA. 527+99.82 M.L.  
END TAPER RT.

P.O.C. 3+03  
CROSSOVER

LEGEND

- 1 - PAINT PAVEMENT MARKING - LETTERS AND SYMBOLS
- 2 - PAINT PAVEMENT MARKING - LINE 5"
- 3 - PAINT PAVEMENT MARKING - LINE 6"
- 4 - PAINT PAVEMENT MARKING - LINE 12"
- 5 - PAINT PAVEMENT MARKING - LINE 24"
- 6 - RAISED REFLECTIVE PAVEMENT MARKER

PAVEMENT MARKINGS  
FAP 745 (IL 104)  
SECTION 103I-2, 104I-1  
ADAMS COUNTY

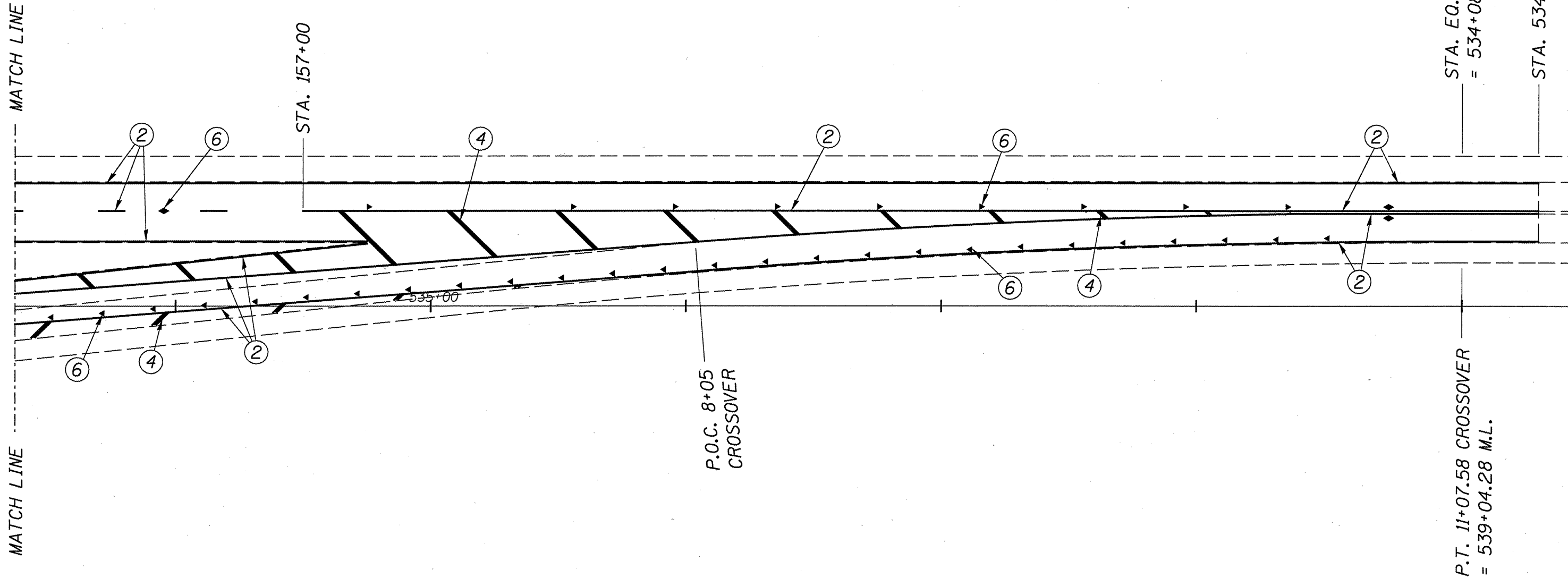

LEGEND

- 1 - PAINT PAVEMENT MARKING - LETTERS AND SYMBOLS
- 2 - PAINT PAVEMENT MARKING - LINE 5"
- 3 - PAINT PAVEMENT MARKING - LINE 6"
- 4 - PAINT PAVEMENT MARKING - LINE 12"
- 5 - PAINT PAVEMENT MARKING - LINE 24"
- 6 - RAISED REFLECTIVE PAVEMENT MARKER

PAVEMENT MARKINGS  
FAP 745 (IL 104)  
SECTION 103I-2, 104I-1  
ADAMS COUNTY

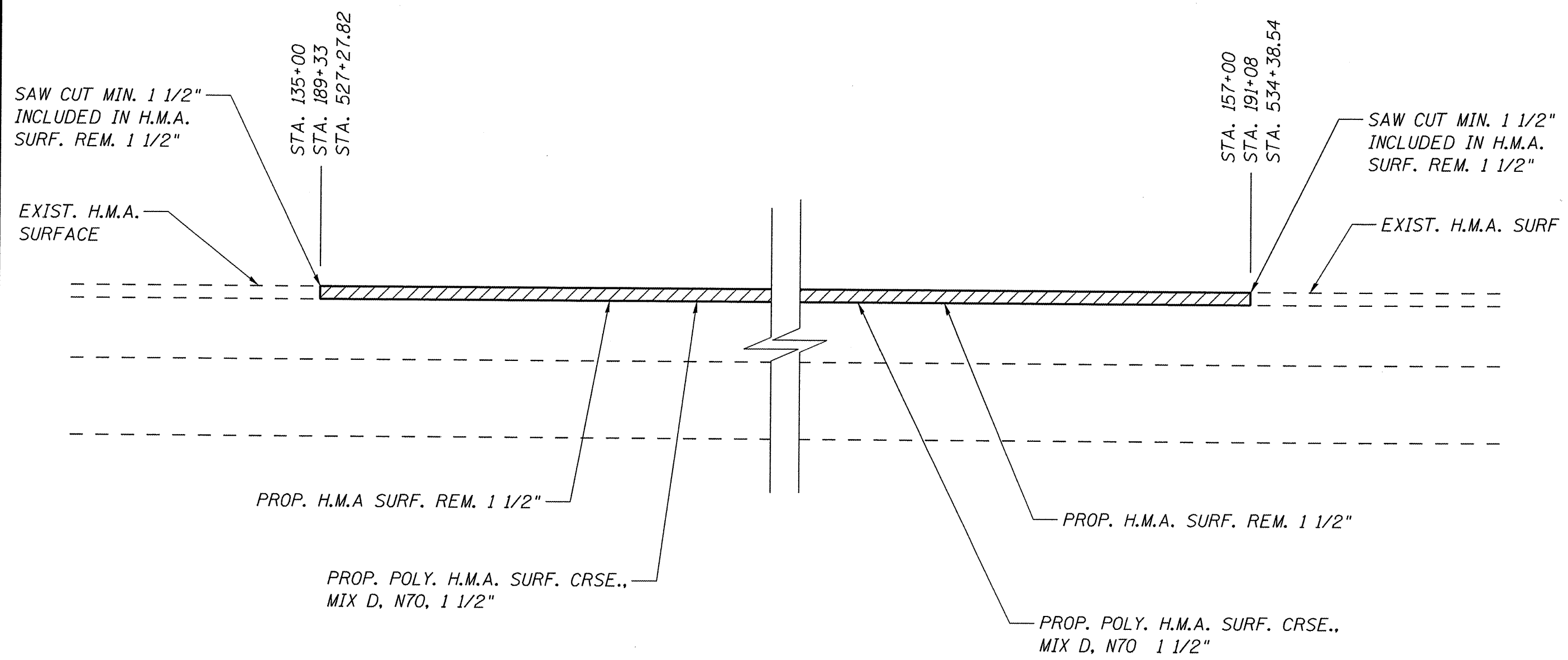

BUTT JOINT  
FAP 745(IL 104)  
SECTION 103I-2, 104I-1  
ADAMS COUNTY