

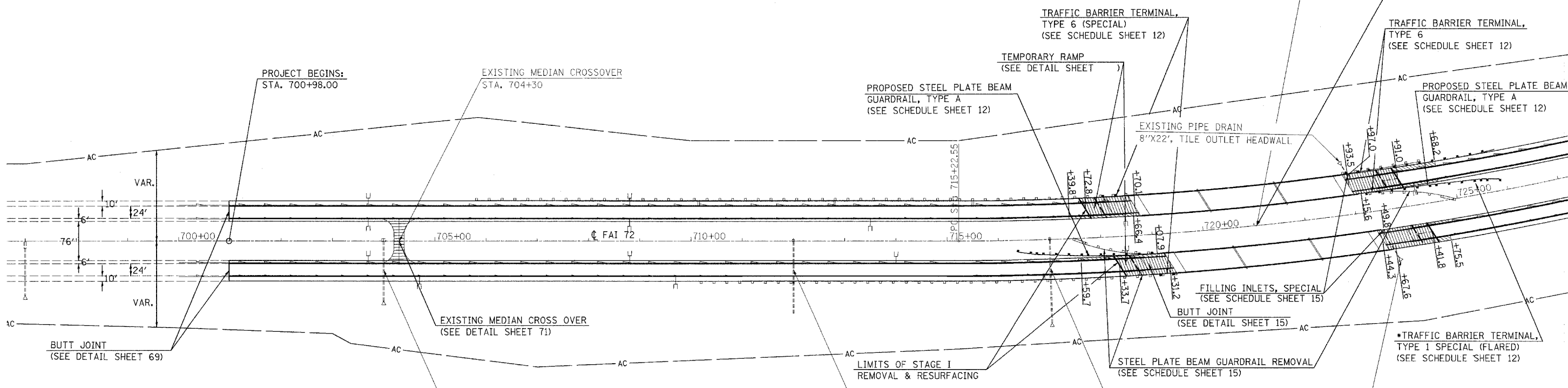

EXISTING STRUCTURE DATA
 CL STATION 721+12.00 (F.A.I. ROUTE 72)
 SKEW 26°-30' RT. FOR.
 APPROX. LENGTH 418'-0"
 (BK.-BK. APPR. BENTS)
 APPROX. HORIZ. CLEARANCE 42'-0"
 CONSTRUCTED AS SECTION 58-66 B
 STRUCTURE No. 058-0093 (E.B.)
 STRUCTURE No. 058-0094 (W.B.)
 DATA OBTAINED FROM OLD PLANS

PAVING OMISSION
 STA. 719+00.65 TO 723+18.90



* NOTE: FOR MEDIAN GUARDRAIL LAYOUT SEE DETAIL SHEET #72

SEC. 31, T18N, R4E, 3rd PM

LEGEND

- HOT MIX ASPHALT SURFACE REMOVAL - VARIABLE DEPTH
- PAVED SHOULDER REMOVAL
- PAVEMENT REMOVAL
- PORTLAND CEMENT CONCRETE SURFACE REMOVAL - BUTT JOINT
- HOT MIX ASPHALT SURFACE REMOVAL - BUTT JOINT

FILE NAME = c:\projects\7417\td\shhtplan.74171.dgn	USER NAME = swartzrw	DESIGNED -	REVISED -
		DRAWN -	REVISED -
	PLOT SCALE = 100.0000' / 1" IN.	CHECKED -	REVISED -
	PLOT DATE = 3/20/2008	DATE -	REVISED -

**STATE OF ILLINOIS
 DEPARTMENT OF TRANSPORTATION**

PLAN SHEET

SCALE: 100 SHEET NO. 1 OF 9 SHEETS STA. 700+98.00 TO STA. 727+00.00

F.A.I. RTE. 72	SECTION (58,74)(66,67)RS-1	COUNTY MACON	TOTAL SHEETS 88	SHE NO. 17
FED. ROAD DIST. NO. ILLINOIS FED. AID PROJECT			CONTRACT NO. 741	