

Note: Trim existing long. reinf. to accommodate new joint opening (typ.)

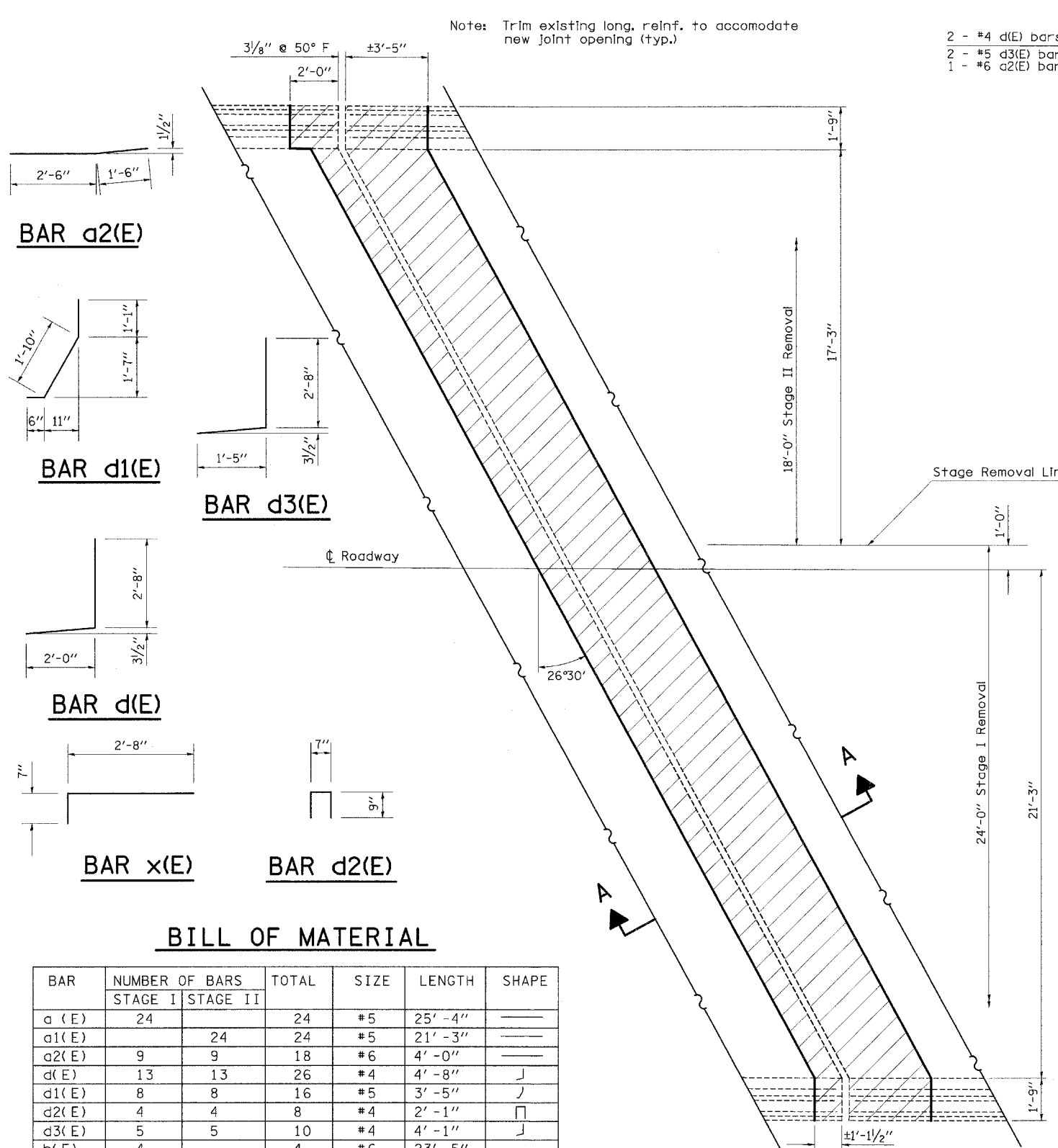

EXISTING PARTIAL PLAN
(West Abutment shown; East Abutment similar)

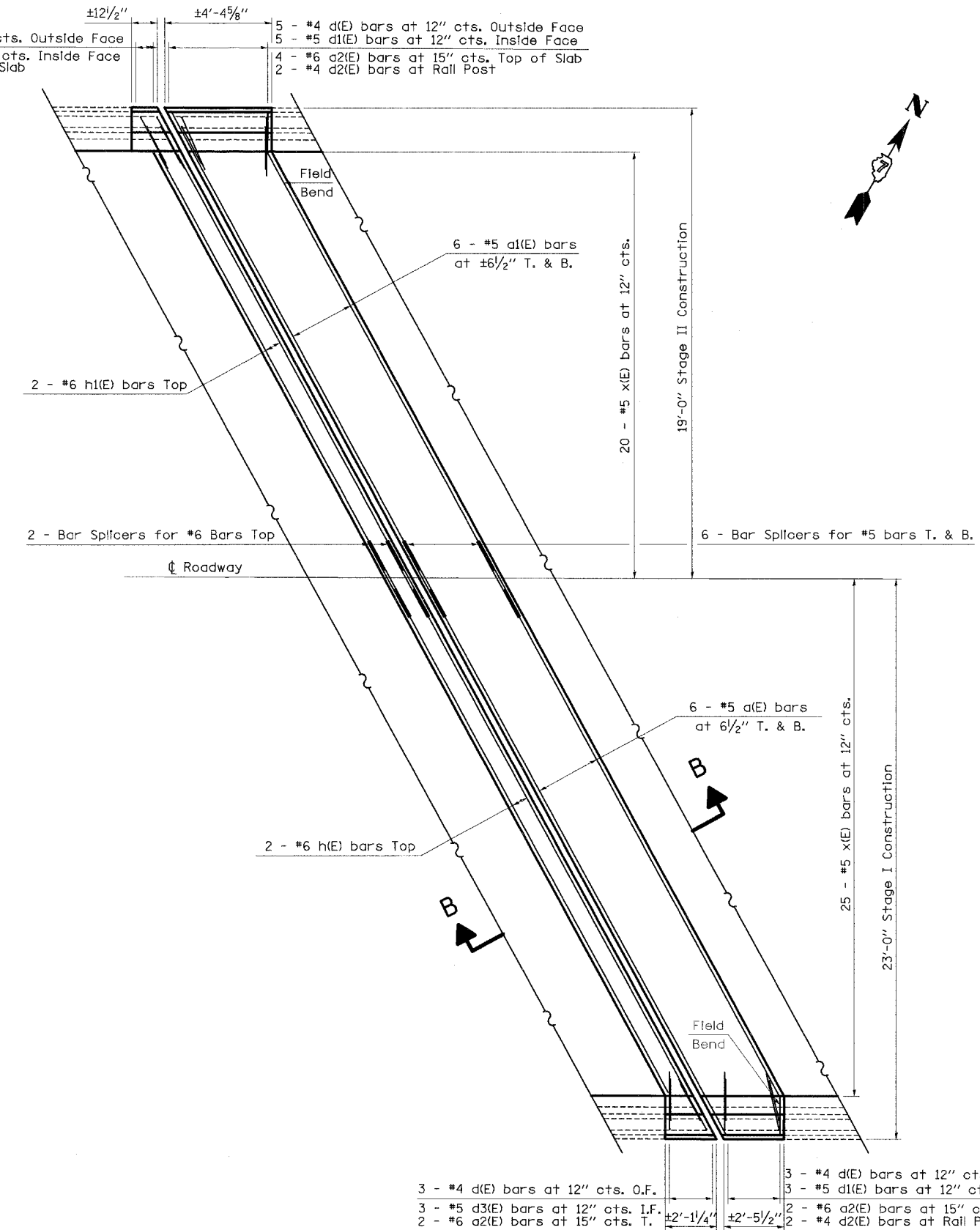

PROPOSED PARTIAL PLAN
(West Abutment shown; East Abutment similar)

BAR d2(E)

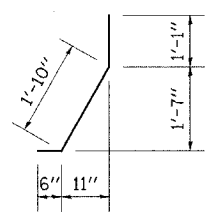

BAR d1(E)

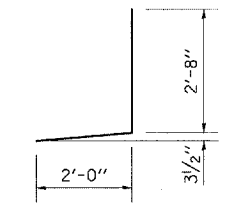

BAR d(E)

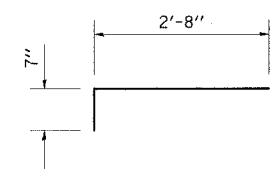

BAR x(E)

BAR d3(E)

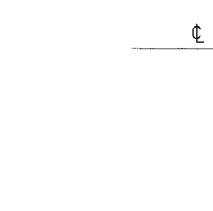

BAR d2(E)

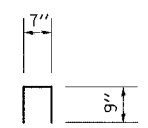

BILL OF MATERIAL

BAR	NUMBER OF BARS		TOTAL	SIZE	LENGTH	SHAPE
	STAGE I	STAGE II				
a (E)	24		24	#5	25' - 4"	—
a1(E)		24	24	#5	21' - 3"	—
a2(E)	9	9	18	#6	4' - 0"	—
d(E)	13	13	26	#4	4' - 8"	J
d1(E)	8	8	16	#5	3' - 5"	J
d2(E)	4	4	8	#4	2' - 1"	□
d3(E)	5	5	10	#4	4' - 1"	J
h(E)	4		4	#6	23' - 5"	—
h1(E)		4	4	#6	19' - 3"	—
x(E)	50	40	90	#5	3' - 3"	—
CONCRETE REMOVAL					CU. YD.	11.6
REINFORCEMENT BARS (EPOXY COATED)					POUND	3410
CONCRETE SUPERSTRUCTURE					CU. YD.	13.5

REINFORCEMENT BARS DESIGNATED (E) SHALL BE EPOXY COATED