

**EXISTING PARTIAL PLAN**  
(West Abutment shown; East Abutment similar)

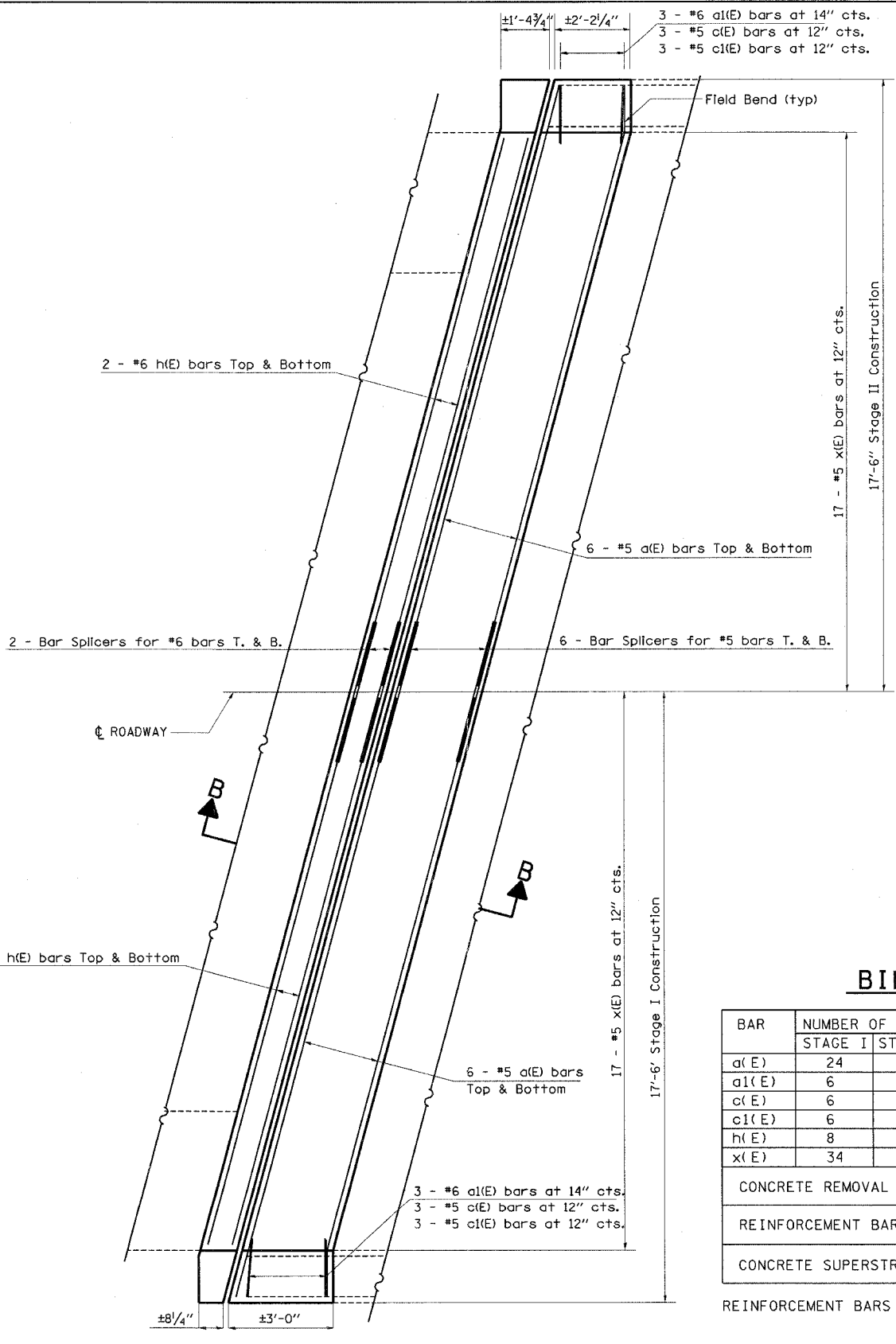

**PROPOSED PARTIAL PLAN**  
(West Abutment shown; East Abutment similar)

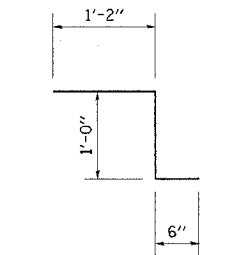

**BAR c1(E)**

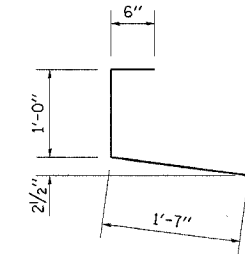

**BAR c(E)**

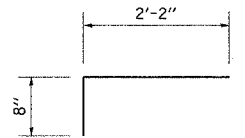

**BAR x(E)**

**BILL OF MATERIAL**

BAR	NUMBER OF BARS		TOTAL	SIZE	LENGTH	SHAPE	
	STAGE I	STAGE II					
a(E)	24	24	48	#5	17'-9"	—	
a1(E)	6	6	12	#6	4'-0"	—	
c(E)	6	6	12	#5	3'-1"	┌	
c1(E)	6	6	12	#5	2'-8"	└	
h(E)	8	8	16	#6	16'-2"	—	
x(E)	34	34	68	#5	2'-10"	┌	
CONCRETE REMOVAL						CU. YD.	9.9
REINFORCEMENT BARS (EPOXY COATED)						POUND	1620
CONCRETE SUPERSTRUCTURE						CU. YD.	9.9

REINFORCEMENT BARS DESIGNATED (E) SHALL BE EPOXY COATED