



CURVE DATA
 PI STA. = 65+68.8
 $\Delta = 3^{\circ} 02'$
 $D = 0^{\circ} 45'$
 $R = 7636.5'$
 $T = 209.0'$
 $L = 417.7'$
 $E = 2.9'$
 $S.E. = 0.0210$ FT/FT
 S.E. ATTAINED
 STA 62+27 TO STA 64+27
 STA 67+10 TO STA 69+10

CURVE DATA
 PI STA. = 74+09.9
 $\Delta = 2^{\circ} 50'$
 $D = 0^{\circ} 30'$
 $R = 11,459.2'$
 $T = 283.4'$
 $L = 566.7'$
 $E = 3.5'$
 $S.E. = 0.015$ FT/FT
 S.E. ATTAINED
 STA 69+93 TO STA 71+93
 STA 76+26 TO STA 78+26

-  BUTT JOINT
-  HOT-MIX ASPHALT SURFACE REMOVAL, 1/2"
-  HOT-MIX ASPHALT SURFACE REMOVAL, 2 1/4"

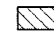
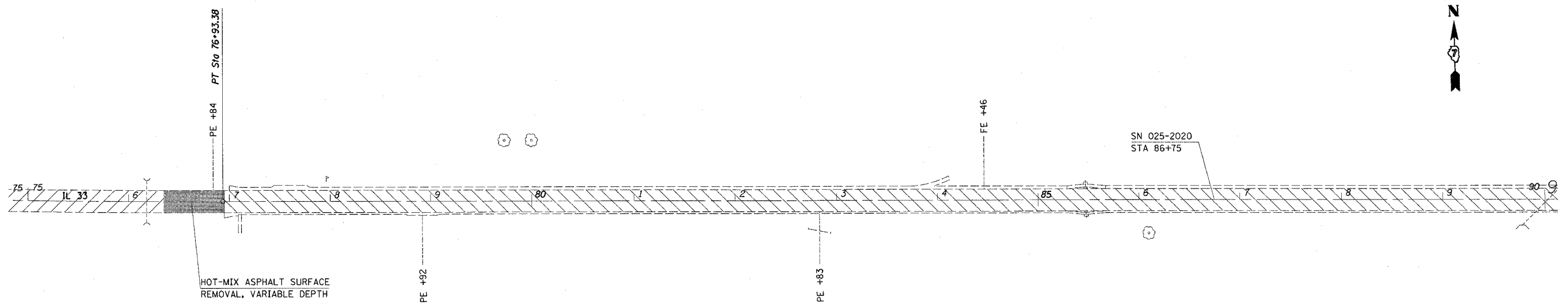
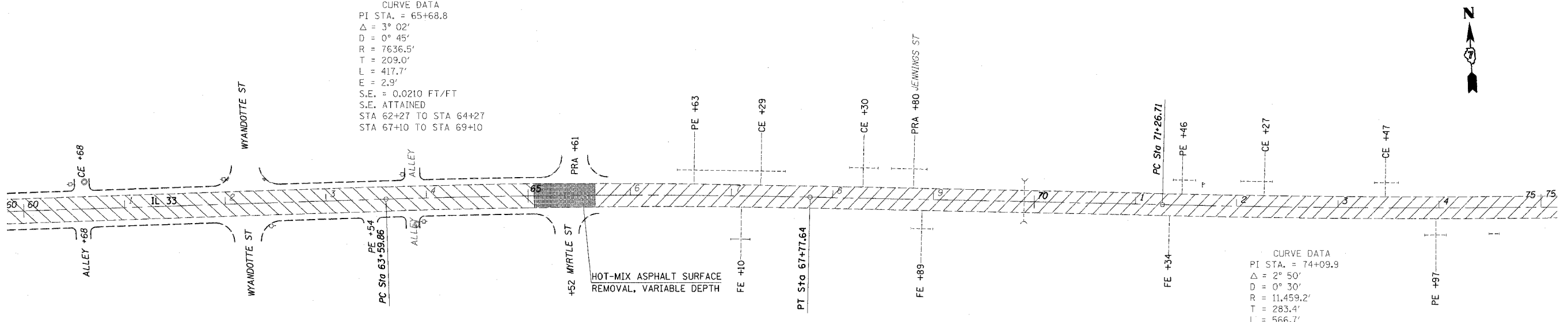

FILE NAME = c:\projects\74251d\shp1en_74251.dgn	USER NAME = teasleyk	DESIGNED - DRAWN -	REVISED - REVISED -	STATE OF ILLINOIS DEPARTMENT OF TRANSPORTATION	PLAN SHEET			F.A.P. RTE. 774	SECTION .	COUNTY EFFINGHAM	TOTAL SHEETS 33	SHEET NO. 23
PLOT SCALE = 50.0000" / IN.		CHECKED -	REVISED -		SCALE: 50	SHEET NO.	OF	SHEETS	STA. 60+00	TO STA. 90+00	CONTRACT NO. 74251	
PLOT DATE = 3/27/2008		DATE -	REVISED -		FED. ROAD DIST. NO. ILLINOIS FED. AID PROJECT							
(1-1MFT,1-WMFT,104Z,104RS-2												