

STATE OF ILLINOIS  
DEPARTMENT OF TRANSPORTATION  
DIVISION OF HIGHWAYS

**PROPOSED  
HIGHWAY PLANS**

FAP ROUTE 793 (US ROUTE 40)  
SECTION 33-1RS-2  
PROJECT 3P RESURFACING  
MADISON COUNTY  
C-98-035-08 *PROJ. ACF-0793(020)*

F.A.P. RTE.	SECTION	COUNTY	TOTAL SHEETS	SHEET NO.
793	33-1RS-2	MADISON	46	1
FED. ROAD DIST. NO.	ILLINOIS	CONTRACT NO. 76B68		

FOR INDEX OF SHEETS, SEE SHEET NO. 2

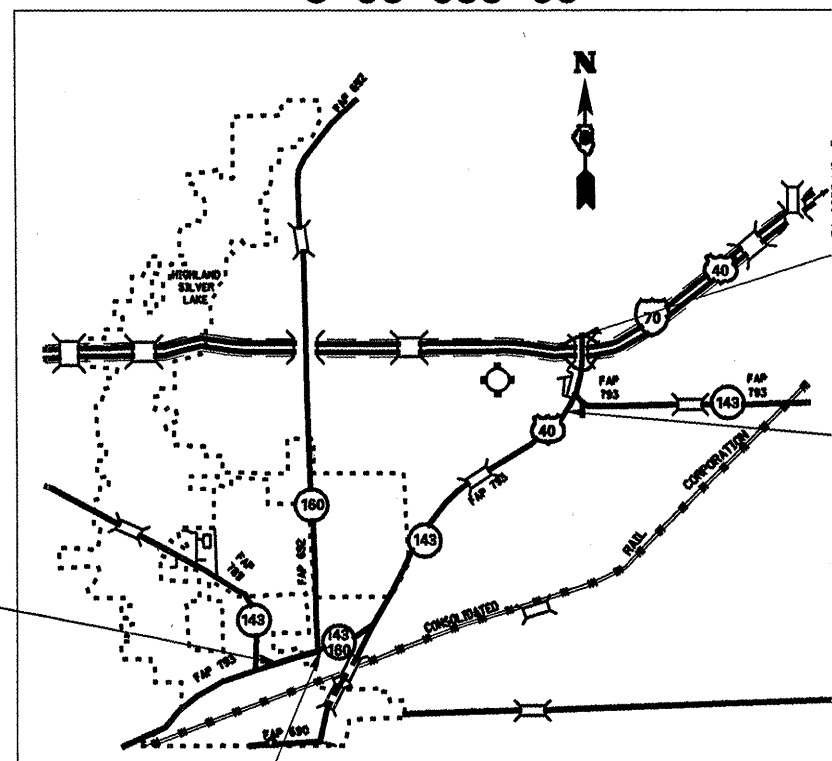
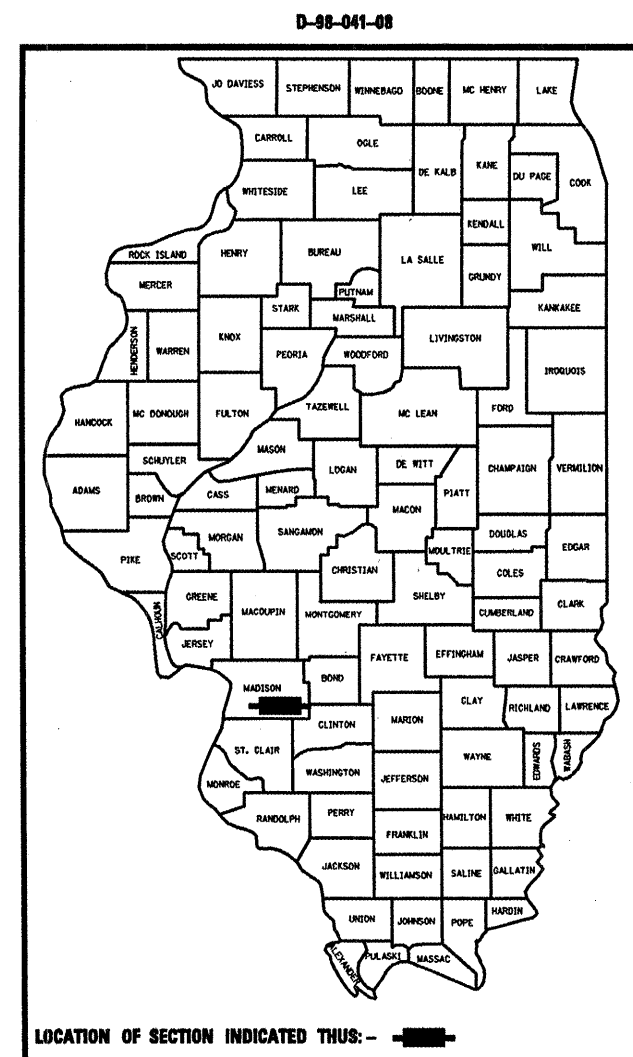

END SECTION 33-1RS-2  
STA. 8+23.00  
LAT. - 38.78835  
LONG. - 89.63106

STATION EQUATION  
STA. 1028+55.99 BACK = STA. 44+49.84 AHEAD

BEGIN STATION 33-1RS-2  
STA. 851+66  
LAT. - 38.74833  
LONG. - 89.67994

OMISSION  
FROM STA. 867+23.0  
TO STA. 880+45.0

NET LENGTH: 21,321 FT - 4.04 MI  
GROSS LENGTH: 19,776 FT - 3.75 MI

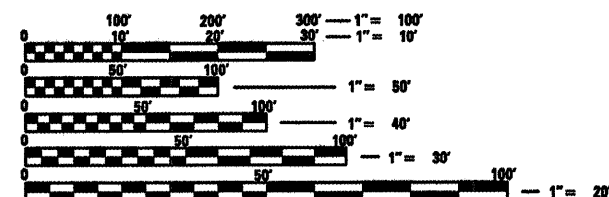

FULL SIZE PLANS HAVE BEEN PREPARED USING STANDARD ENGINEERING SCALES. REDUCED SIZED PLANS WILL NOT CONFORM TO STANDARD SCALES. IN MAKING MEASUREMENTS ON REDUCED PLANS, THE ABOVE SCALES MAY BE USED.

J.U.L.I.E.  
JOINT UTILITY LOCATION INFORMATION FOR EXCAVATION  
1-800-892-0123  
OR 811

PROJECT ENGINEER: PATTI LEBEAU (618) 346-3179  
PROJECT MANAGER: CHERYL KEPLAR (618)346-3186

CONTRACT NO. 76B68

FUNCTIONAL CLASSIFICATION: MINOR ARTERIAL

2007 ADT = 9600 (ACTUAL)
2008 ADT = 9700 (ESTIMATED)
SU = 2.6%
MU = 1.6%

STATE OF ILLINOIS  
DEPARTMENT OF TRANSPORTATION  
DIVISION OF HIGHWAYS

SUBMITTED *March 21, 2008*

*May C. Jamie*  
DEPUTY DIRECTOR OF HIGHWAYS, REGION ENGINEER

*May 9, 2008*  
*Eric E. Harm*  
ENGINEER OF DESIGN AND ENVIRONMENT

*May 9, 2008*  
*Christina M. Reed*  
DIRECTOR OF HIGHWAYS, CHIEF ENGINEER

PRINTED BY THE AUTHORITY  
OF THE STATE OF ILLINOIS

**INDEX OF SHEETS**

- 1 COVER SHEET
- 2 INDEX OF SHEETS, HIGHWAY STANDARDS AND GENERAL NOTES
- 3 SUMMARY OF QUANTITIES
- 4-5 TYPICAL SECTIONS
- 6-8 DETAILED PLANS
- 9-10 SCHEDULES
- 11-25 PROPOSED PLAN SHEETS
- 26 RESURFACING DETAILS

**STANDARDS**

- 000001-05
- 001001-01
- 701006-02
- 701101-01
- 701201-02
- 701301-02
- 701306-01
- 701311-02
- 701336-04
- 701901
- 780001-01
- 781001-02

**GENERAL NOTES**

1. THE CONTRACTOR SHALL VERIFY ALL DIMENSIONS AND CONDITIONS IN THE FIELD PRIOR TO CONSTRUCTION.
2. FINAL PAVEMENT MARKINGS SHALL MATCH EXISTING PAVEMENT MARKINGS.
3. ADDITIONAL ROAD CONSTRUCTION AHEAD SIGNS SHALL BE PLACED AT ALL INTERSECTING SIDE ROADS WITHIN THE LIMITS OF THE PROJECT. ADDITIONAL SIGNS SHALL BE INCIDENTAL TO THE COST BID FOR TRAFFIC CONTROL AND PROTECTION. ALL TRAFFIC CONTROL SIGNS SHALL BE 48A X 48A AND FLUORESCENT ORANGE.
4. NO OVERNIGHT LANE CLOSURES WILL BE PERMITTED.
5. SIDE ENTRANCES SHALL BE KEPT OPEN TO TRAFFIC AT ALL TIMES.
6. FLAGGERS SHALL BE PRESENT DURING ALL LANE CLOSURE HOURS INCLUDING LUNCH PERIODS. WHEN FLAGGERS ARE NOT REQUIRED, FLAGGER SIGNS MUST BE REMOVED OR COVERED. NO ADDITIONAL COMPENSATION WILL BE ALLOWED.
7. THE THICKNESS OF HOT-MIX ASPHALT SHOWN ON THE PLANS IS THE NOMINAL THICKNESS. DEVIATIONS FROM THE NOMINAL THICKNESS WILL BE PERMITTED WHEN SUCH DEVIATIONS OCCUR DUE TO IRREGULARITIES IN THE EXISTING SURFACE OR BASE ON WHICH THE HOT-MIX ASPHALT IS PLACED.
8. THE STANDARDS AND REVISION NUMBERS LISTED SHALL APPLY TO THIS PROJECT.
9. THE CONTRACTOR AND ENGINEER SHALL BE AWARE THAT NO SURVEY WAS PERFORMED FOR THIS PROJECT. THE STATIONING SHOWN IN THE PLANS WAS CREATED USING MICROFILM AND FIELD MEASUREMENTS. THIS INFORMATION SHALL BE ASSUMED TO BE APPROXIMATE.
10. THERE ARE NO COMMITMENTS FOR THIS PROJECT.

ILLINOIS STATE LAW REQUIRES A 48-HOUR NOTICE BE GIVEN TO UTILITIES BEFORE DIGGING. FIELD MARKING OF FACILITIES MAY BE OBTAINED BY CONTACTING J.U.L.I.E. OR FOR NON-MEMBERS, THE UTILITY COMPANY DIRECTLY. AGENCIES KNOWN TO HAVE FACILITIES WITHIN THE PROJECT LIMITS ARE AS FOLLOWS:

UTILITY	ABOVE GROUND	BELOW GROUND
*AMEREN IP	X	X
*CENTERPOINT ENERGY		X
*CHARTER COMMUNICATIONS		X
*VILLAGE OF GRANT FORK		X
*CITY OF HIGHLAND PUBLIC WORKS	X	X
*VILLAGE OF PIERRON		X
*VERIZON NORTH	X	X
MEMBERS OF J.U.L.I.E. (800)-892-0123 ARE INDICATED BY *.		
NON-J.U.L.I.E. MEMBERS MUST BE NOTIFIED INDIVIDUALLY		

THE FOLLOWING MIXTURE REQUIREMENTS ARE APPLICABLE FOR THIS PROJECT:

MIXTURE REQUIREMENTS - SUPERPAVE PROJECT				
ROUTE	FAP 793 (US 40)			
SECTION	33-IRS-2			
COUNTY	MADISON			
CONTRACT	76868			
DESCRIPTION:	IL 143 FROM WALNUT ST. IN HIGHLAND TO IL 143 EAST JUNCTION. 3P-RESURFACING PROJECT.			
ADT (Construction Yr):	9700			
MUX:	1.6			
SUX:	2.6			
20 YR. ESAL'S:	1.20			
MIXTURE USE	POLY SURFACE	LEVEL BINDER	BINDER / PATCHING	INCIDENTAL SURF
AC/PG	SBS 76-22	PG 64-22	PG 64-22	PG 64-22
RAP % (MAX)	10%	15%	15%	10%
DESIGN AIR VOIDS	4.0% @ Ndes=70	4.0% @ Ndes=70	4.0% @ Ndes=70	4.0% @ Ndes=70
MIX COMPOSITION				
(GRADATION MIXTURE)				
FRICTION AGG	MIXTURE "D"	MIXTURE "C"	MIXTURE "B"	MIXTURE "D"

(PLAN QUANTITIES FOR HOT-MIX ASPHALT SURFACE COURSE ITEMS ARE CALCULATED USING A UNIT WEIGHT OF 0.056 TONS/SQ YD/INCH)

FILE NAME = c:\projects\ed84188\plan\in84188a.dgn	USER NAME = a1fordb	DESIGNED - DRAWN -	REVISED - REVISED -	<b>STATE OF ILLINOIS DEPARTMENT OF TRANSPORTATION</b>	<b>GENERAL NOTES</b>	F.A.P. RTE. 793	SECTION 33-IRS-2	COUNTY MADISON	TOTAL SHEETS 26	SHEET NO. 2	
PLOT SCALE = 100.0000' / IN.	CHECKED -	REVISED -	SCALE:			SHEET NO. OF SHEETS	STA. TO STA.	CONTRACT NO. 76868			
PLOT DATE = 3/21/2008	DATE -	REVISED -	FED. ROAD DIST. NO. ILLINOIS FED. AID PROJECT								

80% FED.  
20% STATE

# SUMMARY OF QUANTITIES

80% FED.  
20% STATE

SUMMARY OF QUANTITIES			1000 TOTAL QUANTITIES	CONSTRUCTION TYPE CODE		
CODE NO	ITEM	UNIT				
35800100	PREPARATION OF BASE	SQ YD	87			
35800200	AGGREGATE BASE REPAIR	TON	40			
40600200	BITUMINOUS MATERIALS (PRIME COAT)	TON	17			
40600300	AGGREGATE (PRIME COAT)	TON	84.5			
40600635	LEVELING BINDER (MACHINE METHOD), N70	TON	2315			
40600895	CONSTRUCTING TEST STRIP	EACH	1			
40600982	HOT-MIX ASPHALT SURFACE REMOVAL - BUTT JOINT	SQ YD	939			
40600985	PORTLAND CEMENT CONCRETE SURFACE REMOVAL - BUTT JOINT	SQ YD	305			
40600990	TEMPORARY RAMP	SQ YD	270			
40603540	POLYMERIZED HOT-MIX ASPHALT SURFACE COURSE, MIX "D", N70	TON	4664			
40800050	INCIDENTAL HOT-MIX ASPHALT SURFACING	TON	116			
44002000	CONCRETE CURB REMOVAL	FOOT	30			
44002020	CONCRETE MEDIAN SURFACE REMOVAL	SQ FT	56			
44200116	PAVEMENT PATCHING, TYPE I, 10 INCH	SQ YD	8			
44200120	PAVEMENT PATCHING, TYPE II, 10 INCH	SQ YD	150			
44200188	PAVEMENT PATCHING, TYPE I, 16 INCH	SQ YD	10			
44200192	PAVEMENT PATCHING, TYPE II, 16 INCH	SQ YD	78			
44200196	PAVEMENT PATCHING, TYPE III, 16 INCH	SQ YD	30			
48102100	AGGREGATE WEDGE SHOULDER, TYPE B	TON	1151			
48203100	HOT-MIX ASPHALT SHOULDERS	TON	1701			
60600605	CONCRETE CURB, TYPE B	FOOT	30			
60618300	CONCRETE MEDIAN SURFACE, 4 INCH	SQ FT	56			
67000400	ENGINEER'S FIELD OFFICE, TYPE A	CAL MO	8			
67100100	MOBILIZATION	L SUM	1			
70100450	TRAFFIC CONTROL AND PROTECTION, STANDARD T01201	L SUM	1			
70100460	TRAFFIC CONTROL AND PROTECTION, STANDARD T01306	L SUM	1			
70100600	TRAFFIC CONTROL AND PROTECTION, STANDARD T01336	L SUM	1			
70300100	SHORT-TERM PAVEMENT MARKING	FOOT	12318			
70300210	TEMPORARY PAVEMENT MARKING - LETTERS AND SYMBOLS	SQ FT	78			
70300220	TEMPORARY PAVEMENT MARKING - LINE 4"	FOOT	59614			
70300260	TEMPORARY PAVEMENT MARKING - LINE 12"	FOOT	463			
70301000	WORK ZONE PAVEMENT MARKING REMOVAL	SQ FT	4106			

SUMMARY OF QUANTITIES			1000 TOTAL QUANTITIES	CONSTRUCTION TYPE CODE		
CODE NO	ITEM	UNIT				
72000200 *	SIGN PANEL - TYPE 2	SQ FT	9			
72400320 *	REMOVE SIGN PANEL - TYPE 2	SQ FT	9			
73000100 *	WOOD SIGN SUPPORT	FOOT	15			
73700100 *	REMOVE GROUND-MOUNTED SIGN SUPPORT	EACH	1			
78000100 *	THERMOPLASTIC PAVEMENT MARKING - LETTERS AND SYMBOLS	SQ FT	78			
78000200 *	THERMOPLASTIC PAVEMENT MARKING - LINE 4"	FOOT	59614			
78000600 *	THERMOPLASTIC PAVEMENT MARKING - LINE 12"	FOOT	463			
78100100 *	RAISED REFLECTIVE PAVEMENT MARKER	EACH	371			
78300200	RAISED REFLECTIVE PAVEMENT MARKER REMOVAL	EACH	371			
20076600	TRAINEES	HOOR	500			

\*SPECIALTY ITEMS © YDBO

FILE NAME =	USER NAME = a1fordb	DESIGNED -	REVISED -
ca:\projects\ed84188\plan\pin84188a.dgn		DRAWN -	REVISED -
		CHECKED -	REVISED -
		DATE -	REVISED -

**STATE OF ILLINOIS  
DEPARTMENT OF TRANSPORTATION**

SUMMARY OF QUANTITIES				
SCALE:	SHEET NO.	OF SHEETS	STA.	TO STA.

F.A.P. RTE.	SECTION	COUNTY	TOTAL SHEETS	SHEET NO.
793	33-IRS-2	MADISON	26	3
CONTRACT NO. 76868				
FED. ROAD DIST. NO. ILLINOIS FED. AID PROJECT				



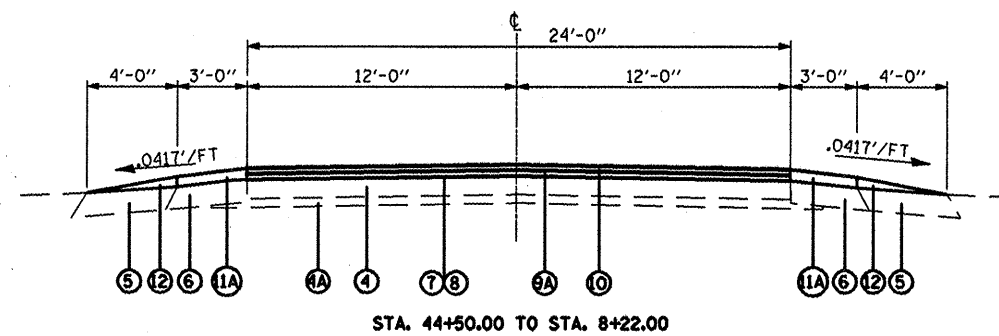
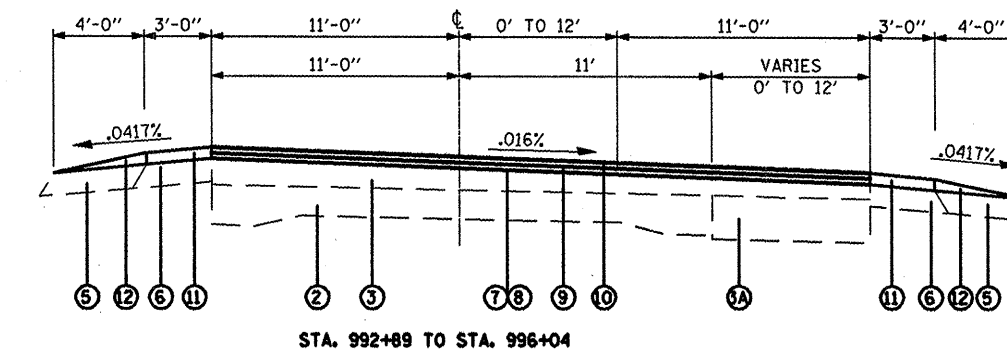
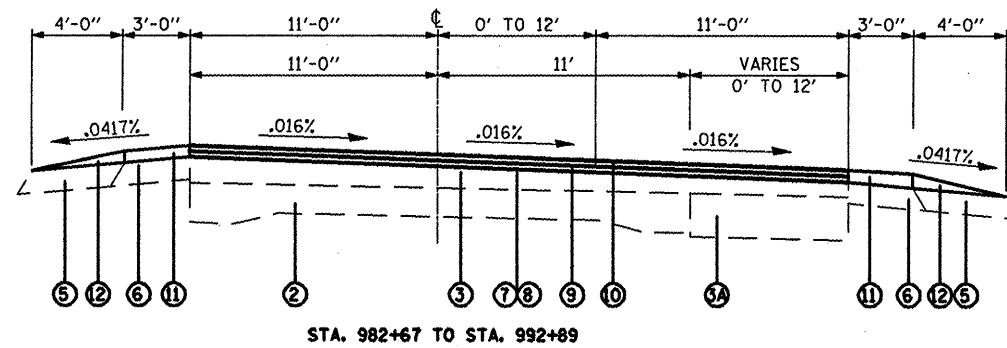

- LEGEND
- ① EXISTING P.C.C. PAVEMENT 10-10-8-10-10, WITH A LONGITUDINAL METAL JOINT, 1/2" Ø DEFORMED TIE BARS 2'-6" LONG, AND PAVEMENT FABRIC.
  - ② EXISTING P.C.C. PAVEMENT 9-9-7-9-9, WITH A LONGITUDINAL METAL JOINT, 1/2" Ø DEFORMED TIE BARS 2'-6" LONG, AND PAVEMENT FABRIC.
  - ③ EXISTING BITUMINOUS RESURFACING
  - ④A EXISTING 6" GRANULAR SUB-BASE
  - ④ EXISTING 10" P.C.C. PAVEMENT, WITH #5 TIE BARS, 2'-6" LONG AND PAVEMENT FABRIC
  - ④A EXISTING 4" GRANULAR SUB-BASE
  - ⑤ EXISTING AGGREGATE SHOULDERS.
  - ⑥ EXISTING HOT-MIX ASPHALT SHOULDER, 6"
  - ⑦ PROPOSED BITUMINOUS MATERIALS (PRIME COAT)
  - ⑧ PROPOSED AGGREGATE (PRIME COAT)
  - ⑨ PROPOSED LEVELING BINDER (MACHINE METHOD) 3/4"
  - ⑨A PROPOSED LEVELING BINDER (MACHINE METHOD) 1"
  - ⑩ PROPOSED POLYMERIZED HOT-MIX ASPHALT SURFACE COURSE, 1 1/2"
  - ⑪ PROPOSED HOT-MIX ASPHALT SHOULDER 2 1/4"
  - ⑪A PROPOSED HOT-MIX ASPHALT SHOULDER 2 1/2"
  - ⑫ PROPOSED AGGREGATE WEDGE SHOULDER, TYPE B

FILE NAME =	USER NAME = e1fordb	DESIGNED -	REVISED -
os\projects\ed04100\plan\pln04108a.dgn		DRAWN -	REVISED -
		CHECKED -	REVISED -
		DATE -	REVISED -

**STATE OF ILLINOIS  
DEPARTMENT OF TRANSPORTATION**

TYPICAL SECTIONS			
SCALE:	SHEET NO.	OF SHEETS	STA. TO STA.

F.A.P. RTE.	SECTION	COUNTY	TOTAL SHEETS	SHEET NO.
793	33-1RS-2	MADISON	26	5
CONTRACT NO. 76868				
FED. ROAD DIST. NO. ILLINOIS FED. AID PROJECT				



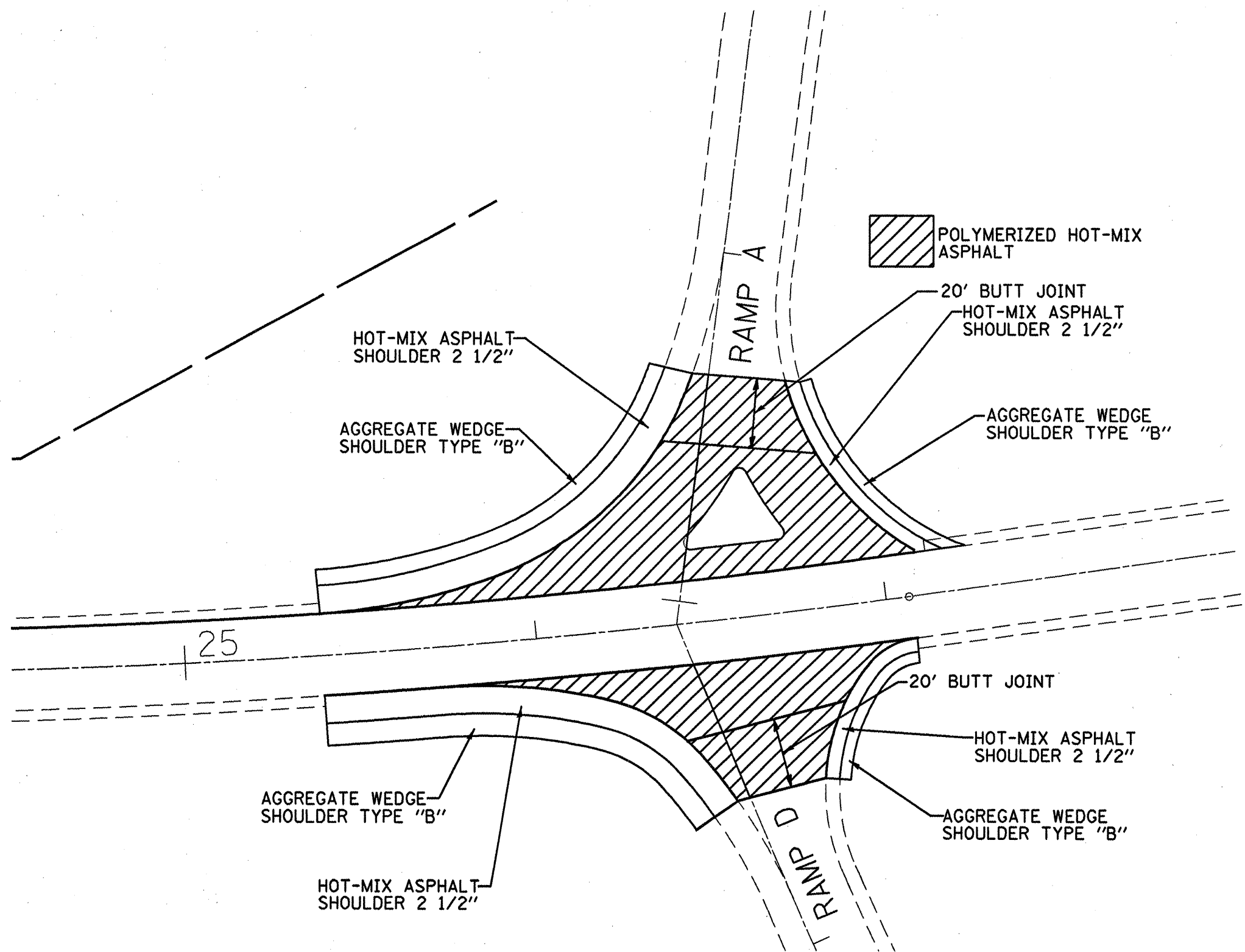

 POLYMERIZED HOT-MIX ASPHALT

20' BUTT JOINT  
HOT-MIX ASPHALT SHOULDER 2 1/2"

AGGREGATE WEDGE SHOULDER TYPE "B"

HOT-MIX ASPHALT SHOULDER 2 1/2"

AGGREGATE WEDGE SHOULDER TYPE "B"

25

20' BUTT JOINT

HOT-MIX ASPHALT SHOULDER 2 1/2"

AGGREGATE WEDGE SHOULDER TYPE "B"

AGGREGATE WEDGE SHOULDER TYPE "B"

HOT-MIX ASPHALT SHOULDER 2 1/2"



FILE NAME =	USER NAME = a1fordb	DESIGNED -	REVISED -
ca\proj\state\ed84108\plan\pin84108a.dgn		DRAWN -	REVISED -
		CHECKED -	REVISED -
		DATE -	REVISED -

**STATE OF ILLINOIS  
DEPARTMENT OF TRANSPORTATION**

**INTERSECTION DETAIL SHEET**

SCALE: SHEET NO. OF SHEETS STA. TO STA.

F.A.P. RTE.	SECTION	COUNTY	TOTAL SHEETS	SHEET NO.
793	33-1RS-2	MADISON	26	7
FED. ROAD DIST. NO. ILLINOIS FED. AID PROJECT			CONTRACT NO. 76868	

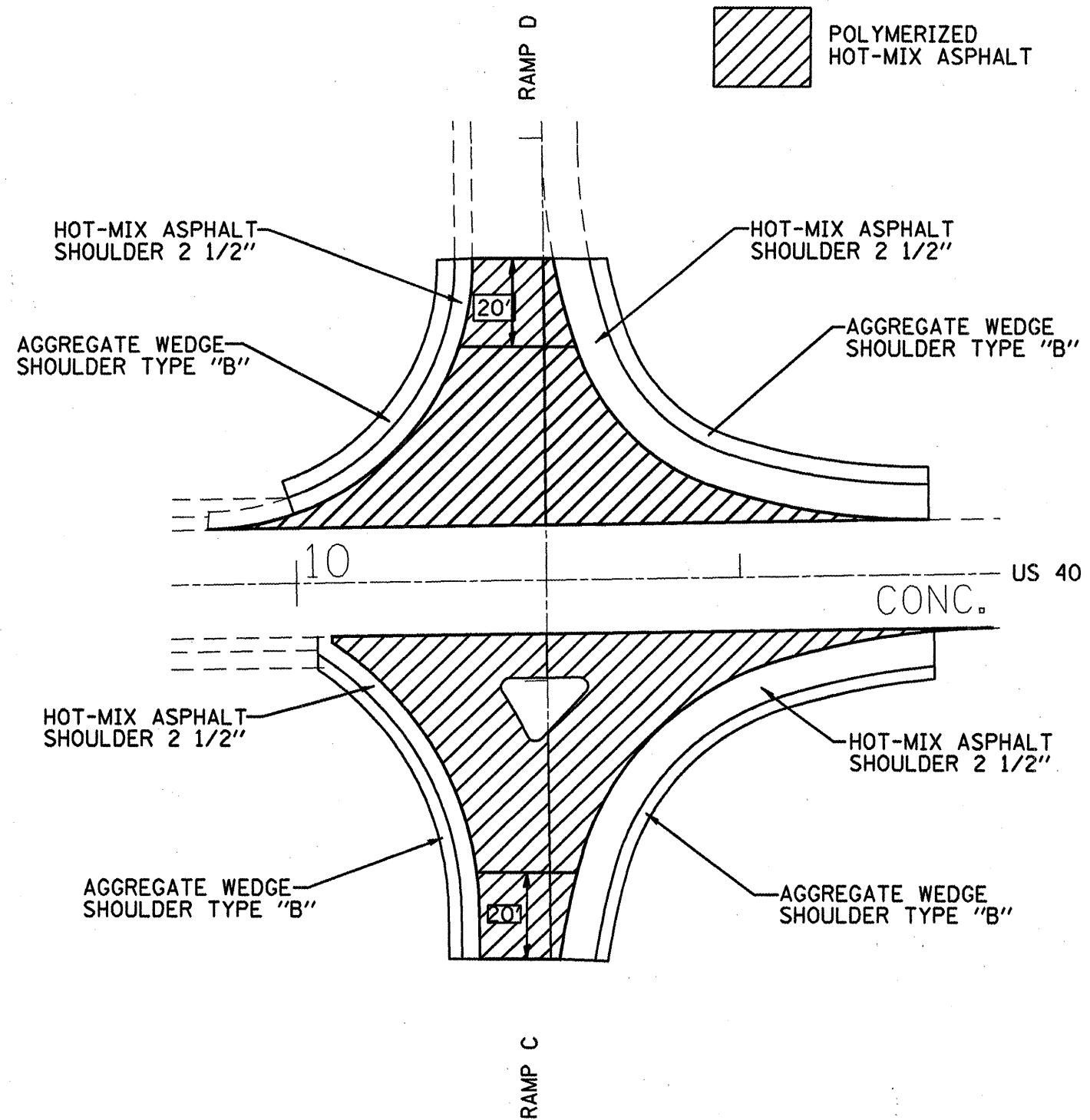

FILE NAME = ca:\projects\ed04108\plan\pln04108a.dgn	USER NAME = aifordb	DESIGNED -	REVISED -	<b>STATE OF ILLINOIS DEPARTMENT OF TRANSPORTATION</b>	<b>INTERSECTION DETAIL SHEET</b>			F.A.P. RTE. 793	SECTION 33-1RS-2	COUNTY MADISON	TOTAL SHEETS 26	SHEET NO. 8
	PLOT SCALE = 100.0000' / IN.	DRAWN -	REVISED -		SCALE:	SHEET NO.	OF	SHEETS	STA.	TO STA.	<b>CONTRACT NO. 76868</b>	
	PLOT DATE = 3/21/2008	CHECKED -	REVISED -		FED. ROAD DIST. NO. ILLINOIS FED. AID PROJECT							
		DATE -	REVISED -									



### INCIDENTAL HMA SCHEDULE

STATION	WIDTH "W" (FT)	LENGTH "L" (FT)	BITUMINOUS MATERIALS PRIME COAT (TON)	AGGREGATE MATERIALS PRIME COAT (TON)	INCIDENTAL HMA SURFACING (TON)	
852+35	LT	77	6	0.02	0.08	5.21
853+35	RT	58	23	0.05	0.22	17.73
857+00	RT	58	23	0.05	0.22	17.73
864+95	RT	35	6	0.01	0.04	2.37
882+11	RT	13	6	0.00	0.01	0.88
882+22	LT	15	6	0.00	0.02	1.02
ENT @ IL 160	SOUTH	49	6	0.01	0.05	3.32
908+34	RT	15	6	0.00	0.02	1.02
908+83	LT	12	6	0.00	0.01	0.81
909+62	LT	21	6	0.00	0.02	1.42
914+71	LT	14	6	0.00	0.01	0.95
916+26	LT	19	6	0.00	0.02	1.29
916+29	RT	14	6	0.00	0.01	0.95
918+30	RT	12	6	0.00	0.01	0.81
918+81	LT	12	6	0.00	0.01	0.81
919+85	LT	12	6	0.00	0.01	0.81
920+70	RT	17	6	0.00	0.02	1.15
921+27	RT	12	6	0.00	0.01	0.81
923+22	RT	21	6	0.00	0.02	1.42
924+05	LT	16	6	0.00	0.02	1.08
924+42	RT	16	6	0.00	0.02	1.08
925+97	LT	21	6	0.00	0.02	1.42
927+88	RT	21	6	0.00	0.02	1.42
932+17	RT	32	6	0.01	0.03	2.17
932+62	RT	21	6	0.00	0.02	1.42
936+06	LT	15	6	0.00	0.02	1.02
937+05	RT	13	6	0.00	0.01	0.88
944+54	RT	13	6	0.00	0.01	0.88
946+65	RT	15	6	0.00	0.02	1.02
950+70	LT	12	6	0.00	0.01	0.81
955+28	LT	13	6	0.00	0.01	0.88
958+16	RT	12	6	0.00	0.01	0.81
958+31	LT	13	6	0.00	0.01	0.88
961+30	RT	44	6	0.01	0.04	2.98
961+86	RT	17	6	0.00	0.02	1.15
965+02	LT	33	6	0.01	0.03	2.23
970+71	RT	21	6	0.00	0.02	1.42
982+67	RT	21	6	0.00	0.02	1.42
988+10	RT	28	6	0.01	0.03	1.89
991+70	LT	42	6	0.01	0.04	2.84
992+70	RT	18	6	0.00	0.02	1.22
994+56	LT	27	6	0.01	0.03	1.83
997+36	RT	21	6	0.00	0.02	1.42
998+58	LT	21	6	0.00	0.02	1.42
1005+00	RT	35	6	0.01	0.04	2.37
1005+92	RT	17	6	0.00	0.02	1.15
1008+82	LT	13	6	0.00	0.01	0.88
1009+92	RT	14	6	0.00	0.01	0.95
1010+90	RT	12	6	0.00	0.01	0.81
1021+72	RT	13	6	0.00	0.01	0.88
41+30	LT	13	6	0.00	0.01	0.97
35+98	RT	39	20	0.03	0.13	11.41
31+15	RT	80	3	0.01	0.04	0.03
<b>TOTALS</b>				<b>0.3</b>	<b>1.6</b>	<b>116</b>

### HMA SHOULDER SCHEDULE

STATION	WIDTH "W" (FT)	LENGTH "L" (FT)	BITUMINOUS MATERIALS PRIME COAT (TON)	AGGREGATE MATERIALS PRIME COAT (TON)	HMA SHOULDER (TON)	
851+66 TO 1028+56	MAINLINE	3	31,582	3.29	15.79	1,326.44
44+50 TO 8+23	MAINLINE	3	5,876	0.61	2.94	274.21
35+98	RT SOUTH	3	80	0.01	0.04	3.73
35+90	LT SOUTH	3	100	0.01	0.05	4.67
35+90	LT NORTH	3	110	0.01	0.06	5.13
23+50	LT SOUTH	8	150	0.04	0.20	18.67
23+50	LT NORTH	4	80	0.01	0.05	4.98
23+50	RT SOUTH	8	140	0.04	0.19	17.42
23+50	RT NORTH	4	50	0.01	0.03	3.11
9+50	LT SOUTH	4	100	0.01	0.07	6.22
9+50	LT NORTH	8	130	0.04	0.17	16.18
9+50	RT SOUTH	4	80	0.01	0.05	4.98
9+50	RT NORTH	8	120	0.03	0.16	14.93
<b>TOTALS</b>			<b>0.2</b>	<b>1.1</b>	<b>1,701</b>	

### PAVEMENT PATCHING SCHEDULE

BEGIN LOCATION STATION	Depth (In.)	LANE LENGTH (FT.)	LANE WIDTH (FT.)	PAVEMENT PATCHING			
				TYPE I PATCH (SQ. YD.)	TYPE II PATCH (SQ. YD.)	TYPE III PATCH (SQ. YD.)	TYPE IV PATCH (SQ. YD.)
<b>EASTBOUND</b>							
1.3	16	15	3	0.00	5.00	0.00	0.00
1.5	16	2	25	0.00	5.56	0.00	0.00
1.5	16	3	25	0.00	8.33	0.00	0.00
1.55	16	3	25	0.00	8.33	0.00	0.00
2.6	16	4	4	1.78	0.00	0.00	0.00
2.8	16	10	3	3.33	0.00	0.00	0.00
2.9	16	12	4	0.00	5.33	0.00	0.00
2.95	16	12	4	0.00	5.33	0.00	0.00
3.55	10	4	6	2.67	0.00	0.00	0.00
3.63	10	4	12	0.00	5.33	0.00	0.00
3.68	10	4	12	0.00	5.33	0.00	0.00
3.72	10	10	3	3.33	0.00	0.00	0.00
3.75	10	4	12	0.00	5.33	0.00	0.00
3.78	10	4	12	0.00	5.33	0.00	0.00
3.9	10	4	12	0.00	5.33	0.00	0.00
3.92	10	4	12	0.00	5.33	0.00	0.00
3.92	10	4	12	0.00	5.33	0.00	0.00
<b>WESTBOUND</b>							
0.1	16	2	50	0.00	11.11	0.00	0.00
2.7	16	70	3	0.00	0.00	23.33	0.00
3.2	16	4	6	2.67	0.00	0.00	0.00
3.3	16	40	3	0.00	13.33	0.00	0.00
3.35	10	40	3	0.00	13.33	0.00	0.00
3.4	10	40	3	0.00	13.33	0.00	0.00
3.45	10	4	12	0.00	5.33	0.00	0.00
3.5	10	4	12	0.00	5.33	0.00	0.00
3.57	10	4	12	0.00	5.33	0.00	0.00
3.6	10	4	12	0.00	5.33	0.00	0.00
3.63	10	4	12	0.00	5.33	0.00	0.00
3.65	10	40	3	0.00	13.33	0.00	0.00
3.68	10	4	12	0.00	5.33	0.00	0.00
3.71	10	4	12	0.00	5.33	0.00	0.00
3.73	10	4	12	0.00	5.33	0.00	0.00
<b>TOTAL 10" PATCH INCLUDING 25% ANTICIPATED FAILURE</b>				<b>8.00</b>	<b>150.00</b>	<b>0.00</b>	<b>0.00</b>
<b>TOTAL 16" PATCH INCLUDING 25% ANTICIPATED FAILURE</b>				<b>10.00</b>	<b>78.00</b>	<b>30.00</b>	<b>0.00</b>
<b>TOTAL</b>				<b>18.00</b>	<b>228.00</b>	<b>30.00</b>	<b>0.00</b>

Conversion Factors 0.0003129 TONS / SQ YD  
0.0015 TONS / SQ YD

### TABULATION OF RESURFACING QUANTITIES

LOCATION	TOTAL ROADWAY WIDTH	LENGTH	AREA	BITUMINOUS MATERIALS PRIME COAT	AGGREGATE MATERIALS PRIME COAT	LEVELING BINDER @	POLY HMA SURF CSE
	FT			FT	TON	TON	0.75/L00 IN
STA. 851 + 66 TO 857 + 41	30.5	975	1949	0.58	2.92	81.84	163.68
STA. 857 + 41 TO 867 + 23	22.0	982	2400	0.72	3.60	100.82	201.64
STA. 880 + 45 TO 896 + 00	22.0	1585	3801	1.14	5.70	159.65	319.29
STA. 896 + 00 TO 896 + 50	23.0	60	128	0.04	0.19	5.37	10.73
STA. 896 + 50 TO 901 + 58	30.5	508	1722	0.52	2.58	72.31	144.61
STA. 901 + 58 TO 910 + 00	29.5	842	2760	0.83	4.14	115.92	231.83
STA. 910 + 00 TO 986 + 32	22.0	7632	18656	5.60	27.98	783.55	1567.10
STA. 986 + 32 TO 991 + 70	29.5	538	1763	0.53	2.65	74.06	148.13
STA. 991 + 70 TO 996 + 00	29.5	430	1409	0.42	2.11	59.20	118.39
STA. 996 + 00 TO 1028 + 56	22.0	3256	7959	2.39	11.94	334.28	668.57
STA. 16 + 52 TO 44 + 50	24.0	2798	7461	2.24	11.19	417.83	835.65
STA. 8 + 23 TO 14 + 29	24.0	606	1616	0.48	2.42	90.50	181.00
35+98 RT	70.0	30	233	0.07	0.38	10.80	21.60
35+90 RT	75.0	55	458	0.14	0.69	19.80	39.60
23+50 LT	75.0	80	800	0.16	0.75	22.50	45.00
23+50 RT	60.0	40	267	0.08	0.40	12.00	24.00
9+50 LT	70.0	60	467	0.15	0.70	21.00	42.00
9+50 RT	90.0	60	600	0.19	0.90	27.00	54.00
<b>GRAND-TOTAL</b>				<b>16.3</b>	<b>81.2</b>	<b>2,295</b>	<b>4,664</b>

#### PRIME COAT CONVERSION FACTORS

SURFACE TYPE	BIT PR COAT	AGG PR COAT
	(GAL/SQ YD)	(LB/SQ YD)
COLD MILLED SURFACES	0.1	4
EXISTING PAVEMENT	0.05	4
NEW BITUMINOUS COURSES	0.03	2

#### BITUMINOUS & AGGREGATE CONVERSION

SURFACE TYPE	
BIT. SURF. COURSES	112 LB /SQ YD/IN
ALL OTHER BIT.	112 LB /SQ YD/IN
AGGREGATE SHOULDERS	2.05 TONS/CIYD

PAVEMENT MARKING SCHEDULE											
LOCATION	STATION TO STATION	SOLID CENTERLINE 4" YELLOW	THERMOPLASTIC PAVEMENT MARKING				SHORT TERM PAVEMENT MARKER 4"	RAISED REFLECTIVE PAVEMENT MARKER REMOVAL	RAISED REFLECTIVE PAVEMENT MARKER 2-WAY AMBER	RAISED REFLECTIVE PAVEMENT MARKER 1-WAY CRYSTAL	WORK ZONE PAVEMENT MARKER REMOVAL
			SKIP-DASH CENTERLINE 4" YELLOW	EDGE LINE 4" WHITE	12" YELLOW	LETTERS & SYMBOLS					
			FOOT	FOOT	FOOT	SQ. FT.					
STA 851+66 TO STA 857+34	1136		1136			360	8	8		120	
STA 857+34 TO STA 867+23	989		1978			600	13	13		200	
STA 880+45 TO STA 883+00			70			168	4	4		56	
STA 883+00 TO STA 891+86			230			552	12	12		184	
STA 891+86 TO STA 913+66	4868		250	4610	238	31	1320	86	80	6	440
STA 913+66 TO STA 928+00	255		360	2868			864	18	18		288
STA 928+00 TO STA 943+00	1075		380	3000			912	19	19		304
STA 943+00 TO STA 958+00	145		380	3000			912	19	19		304
STA 958+00 TO STA 973+00	1590		380	3000			912	19	19		304
STA 973+00 TO STA 981+32	790		210	1664			504	11	11		168
STA 981+32 TO STA 1001+00	4628		250	3966	225	16	1200	81	79	2	400
STA 1001+00 TO STA 1018+00			430	3400			1032	22	22		344
STA 1018+00 TO STA 1028+66			270	2112			648	14	14		216
STA 44+50 TO STA 40+00			120	900			912	6	6		304
STA 40+00 TO STA 29+00			280	2200		31	270	14	14		90
STA 29+00 TO STA 27+98	102			204			72	2	2		24
STA 27+98 TO STA 16+52	1146			2292			696	15	15		232
STA 14+29 TO STA 8+23	606			1212			384	8	8		128
EDGE LINE OMISSIONS FOR ENTRANCES				-1400							
SUB-TOTAL	17,330		3,860	36,424				363	6		
TOTAL			69,614	463	78	12,318	371	371		4,106	

BUTT JOINT SCHEDULE					
LOCATION		LENGTH	WIDTH	HMA	PCC
		FT	FT	SY	SY
851+66	MAINLINE	41.5	45	207.5	
867+23	MAINLINE	22	45	110.0	
880+45	MAINLINE	22	45	110.0	
35+98	RT	50	10		55.6
35+90	LT	40	25	111.1	
23+50	LT	32	20		71.1
23+50	RT	20	35		77.8
9+50	LT	20	24		53.3
9+50	RT	20	21		46.7
16+52	MAINLINE	24	50	133.3	
14+29	MAINLINE	24	50	133.3	
8+23	MAINLINE	24	50	133.3	
TOTALS				939	305









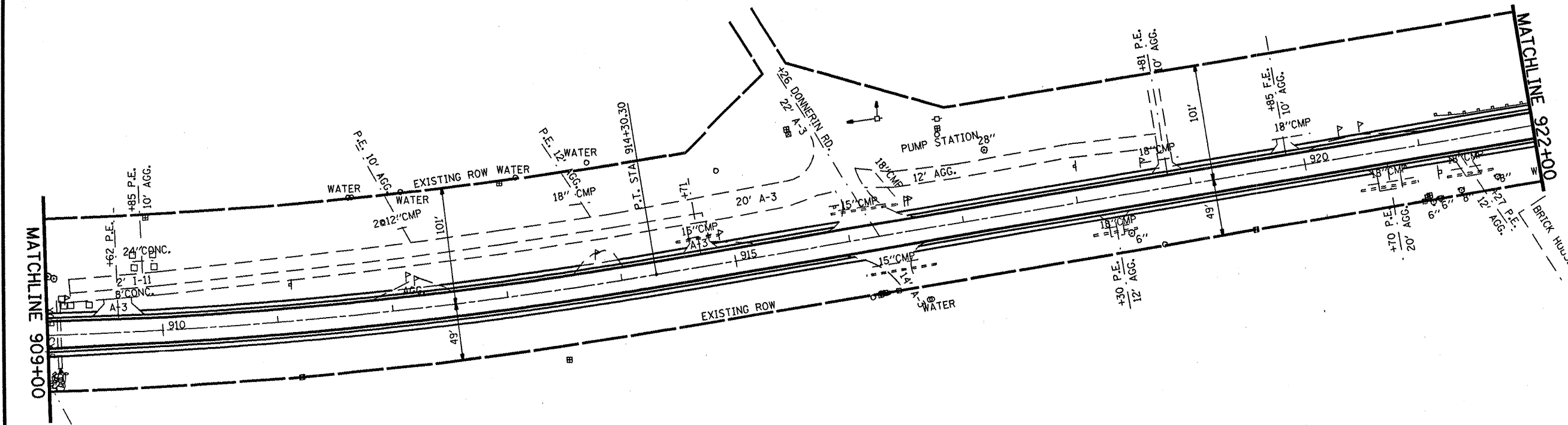

FILE NAME = c:\projects\ed04108\plan\pin04108a.dgn	USER NAME = alfordb	DESIGNED -	REVISED -
		DRAWN -	REVISED -
	PLOT SCALE = 100.0000' / 1"	CHECKED -	REVISED -
	PLOT DATE = 3/21/2008	DATE -	REVISED -

**STATE OF ILLINOIS  
DEPARTMENT OF TRANSPORTATION**

**PROPOSED PLAN SHEET**

SCALE: SHEET NO. OF SHEETS STA. TO STA.

F.A.P. RTE.	SECTION	COUNTY	TOTAL SHEETS	SHEET NO.
793	33-IRS-2	MADISON	26	15
CONTRACT NO. 76868				
FED. ROAD DIST. NO. ILLINOIS FED. AID PROJECT				

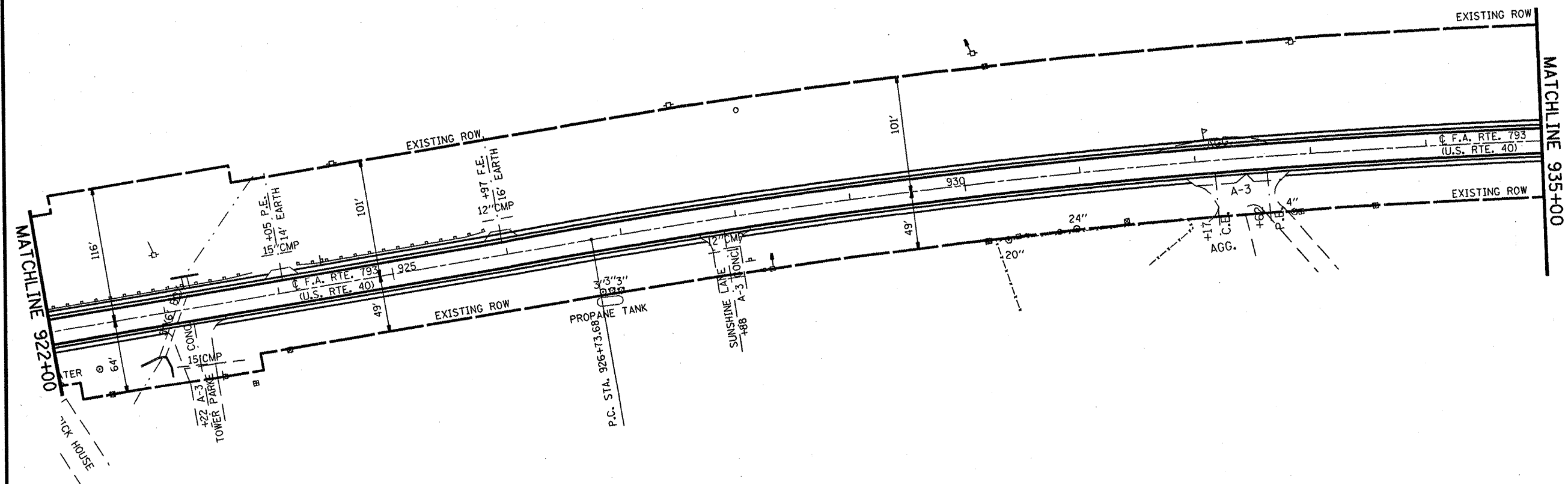

FILE NAME = c:\projects\ed24108\plan\pln04108a.dgn	USER NAME = alferdb	DESIGNED -	REVISED -
		DRAWN -	REVISED -
PLOT SCALE = 100.0000' / IN.		CHECKED -	REVISED -
PLOT DATE = 3/21/2008		DATE -	REVISED -

**STATE OF ILLINOIS**  
**DEPARTMENT OF TRANSPORTATION**

PROPOSED PLAN SHEET			
SCALE:	SHEET NO.	OF SHEETS	STA. TO STA.

F.A.P. RTE.	SECTION	COUNTY	TOTAL SHEETS	SHEET NO.
793	33-IRS-2	MADISON	26	16
FED. ROAD DIST. NO. ILLINOIS FED. AID PROJECT				
<b>CONTRACT NO. 76868</b>				



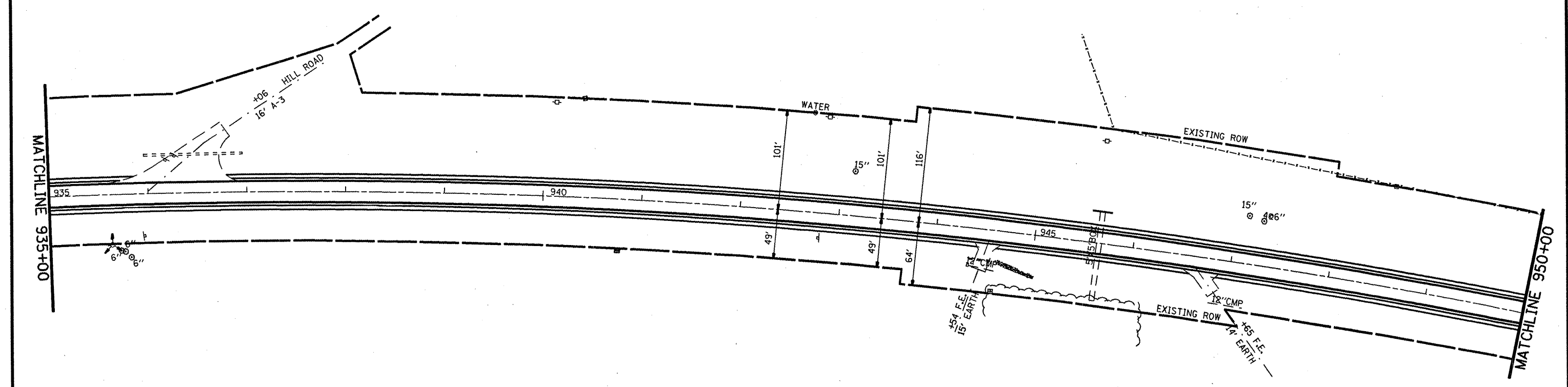

FILE NAME =	USER NAME = ofordb	DESIGNED -	REVISED -
ca\projects\ed04188\plan\pln04188a.dgn		DRAWN -	REVISED -
	PLOT SCALE = 100.0000' / 1IN.	CHECKED -	REVISED -
	PLOT DATE = 3/21/2008	DATE -	REVISED -

**STATE OF ILLINOIS  
DEPARTMENT OF TRANSPORTATION**

**PROPOSED PLAN SHEET**

SCALE:	SHEET NO.	OF	SHEETS	STA.	TO STA.
--------	-----------	----	--------	------	---------

F.A.P. RTE.	SECTION	COUNTY	TOTAL SHEETS	SHEET NO.
793	33-IRS-2	MADISON	26	17
FED. ROAD DIST. NO.			ILLINOIS FED. AID PROJECT	
			CONTRACT NO. 76868	

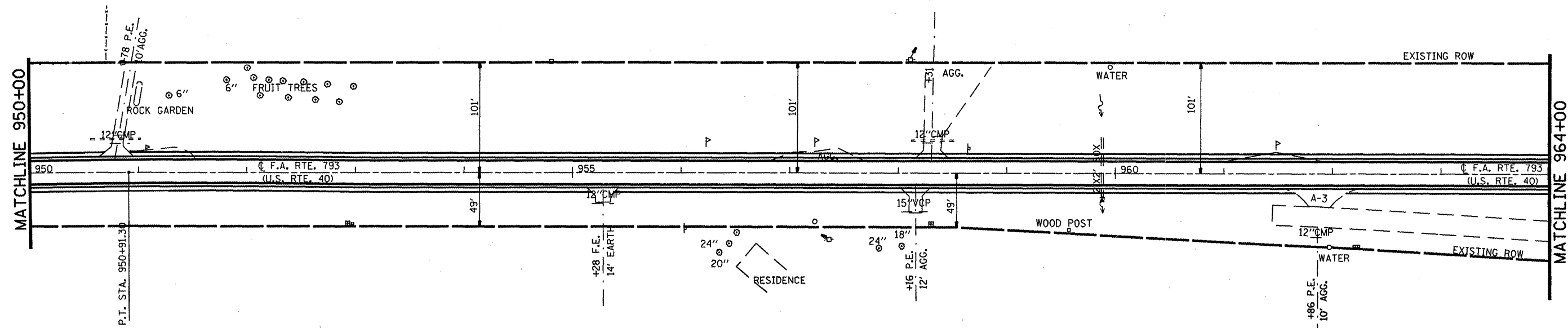
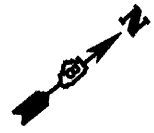

FILE NAME = c:\projects\ed04108\plan\pln04108a.dgn	USER NAME = alfordb	DESIGNED -	REVISED -	<b>STATE OF ILLINOIS DEPARTMENT OF TRANSPORTATION</b>	<b>PROPOSED PLAN SHEET</b>			F.A.P. RTE. 793	SECTION 33-IRS-2	COUNTY MADISON	TOTAL SHEETS 26	SHEET NO. 18
	PLOT SCALE = 100.0000' / IN.	CHECKED -	REVISED -					FED. ROAD DIST. NO.	ILLINOIS FED. AID PROJECT	CONTRACT NO. 76868		
PLOT DATE = 3/21/2008	DATE -	REVISED -	REVISED -	SCALE:	SHEET NO.	OF	SHEETS	STA.	TO STA.			

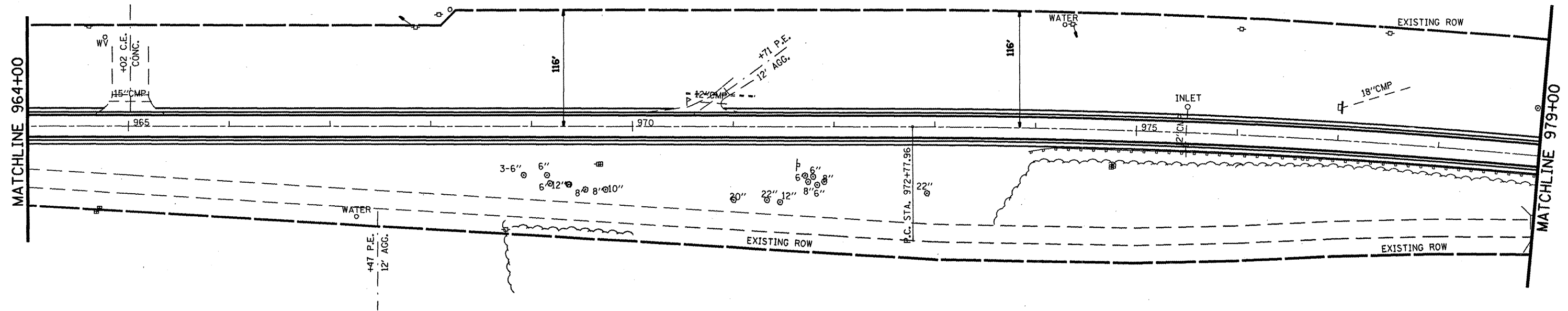
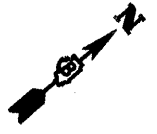

FILE NAME = c:\proj\state\ad04188\plan\pln04188a.dgn	USER NAME = e1fordb	DESIGNED -	REVISED -	<b>STATE OF ILLINOIS DEPARTMENT OF TRANSPORTATION</b>	<b>PROPOSED PLAN SHEET</b>			F.A.P. RTE.	SECTION	COUNTY	TOTAL SHEETS	SHEET NO.
	PLOT SCALE = 100.0000' / IN.	DRAWN -	REVISED -					793	33-IRS-2	MADISON	26	19
PLOT DATE = 3/21/2008	CHECKED -	REVISED -	SCALE:      SHEET NO.    OF    SHEETS    STA.            TO STA.			CONTRACT NO. 76868						
	DATE -	REVISED -	FED. ROAD DIST. NO.    ILLINOIS FED. AID PROJECT									

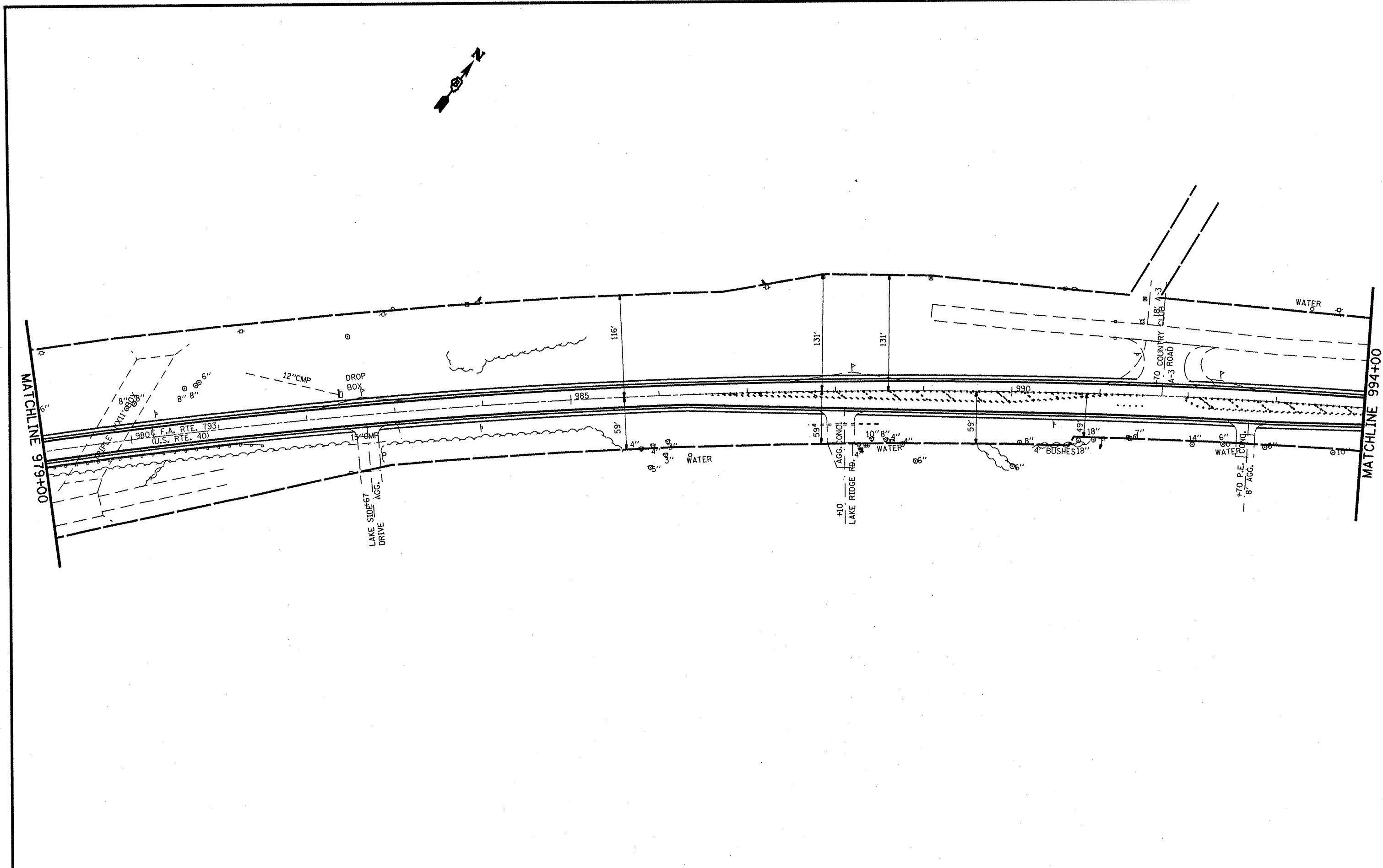

FILE NAME =	USER NAME = a1fordb	DESIGNED -	REVISED -	<b>STATE OF ILLINOIS DEPARTMENT OF TRANSPORTATION</b>	<b>PROPOSED PLAN SHEET</b>				F.A.P. RTE. 793	SECTION 33-IRS-2	COUNTY MADISON	TOTAL SHEETS 26	SHEET NO. 20
ca\projects\ed84188\plan\p1n84188a.dgn	PLOT SCALE = 100.0000' / IN.	DRAWN -	REVISED -		SCALE: SHEET NO. OF SHEETS STA. TO STA.				FED. ROAD DIST. NO. ILLINOIS FED. AID PROJECT				
	PLOT DATE = 3/21/2008	CHECKED -	REVISED -						<b>CONTRACT NO. 76868</b>				
		DATE -	REVISED -										

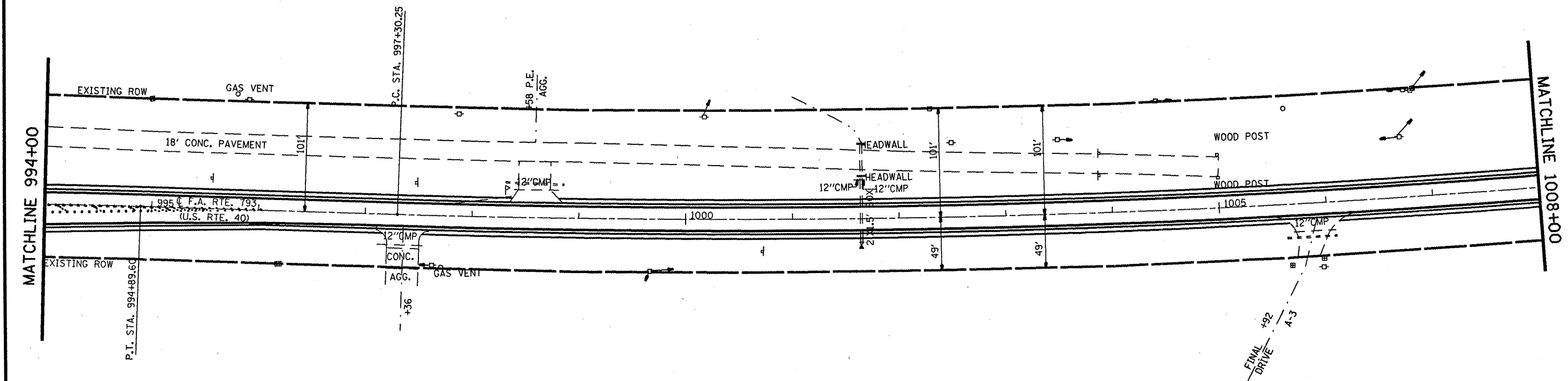

FILE NAME = c:\projects\ed04108\plan\pln04108a.dgn	USER NAME = alfordb	DESIGNED -	REVISED -
		DRAWN -	REVISED -
PLOT SCALE = 100.0000' / IN.		CHECKED -	REVISED -
PLOT DATE = 3/21/2008		DATE -	REVISED -

**STATE OF ILLINOIS  
DEPARTMENT OF TRANSPORTATION**

PROPOSED PLAN SHEET				
SCALE:	SHEET NO.	OF	SHEETS	STA. TO STA.

F.A.P. RTE.	SECTION	COUNTY	TOTAL SHEETS	SHEET NO.
793	33-IRS-2	MADISON	26	21
FED. ROAD DIST. NO. ILLINOIS FED. AID PROJECT				
CONTRACT NO. 76868				

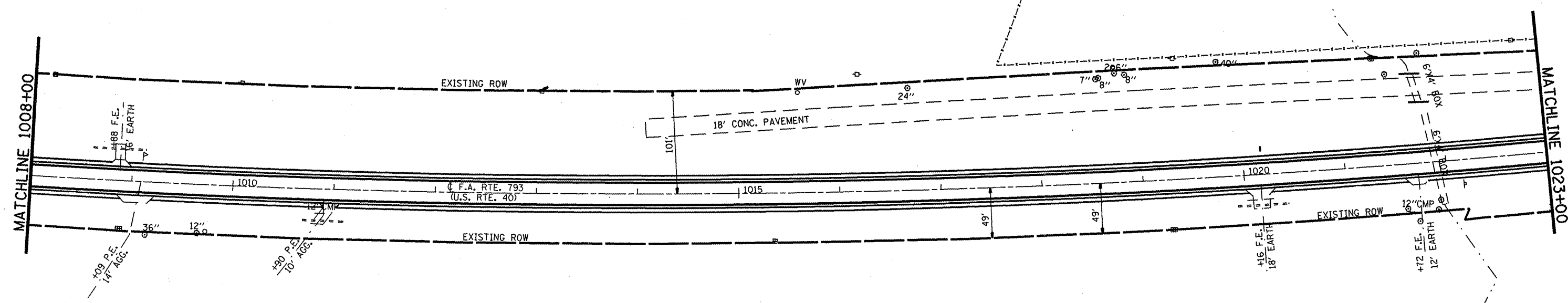
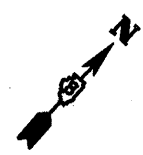

FILE NAME =  
 c:\projects\ed04108\plan\pin04108a.dgn

USER NAME = alfordb  
 PLOT SCALE = 100.0000 ' / IN.  
 PLOT DATE = 3/21/2008

DESIGNED -  
 DRAWN -  
 CHECKED -  
 DATE -

REVISED -  
 REVISED -  
 REVISED -  
 REVISED -

**STATE OF ILLINOIS  
 DEPARTMENT OF TRANSPORTATION**

**PROPOSED PLAN SHEET**

SCALE: SHEET NO. OF SHEETS STA. TO STA.

F.A.P. RTE.	SECTION	COUNTY	TOTAL SHEETS	SHEET NO.
793	33-IRS-2	MADISON	26	22
FED. ROAD DIST. NO. [ILLINOIS] FED. AID PROJECT				
CONTRACT NO. 76868				

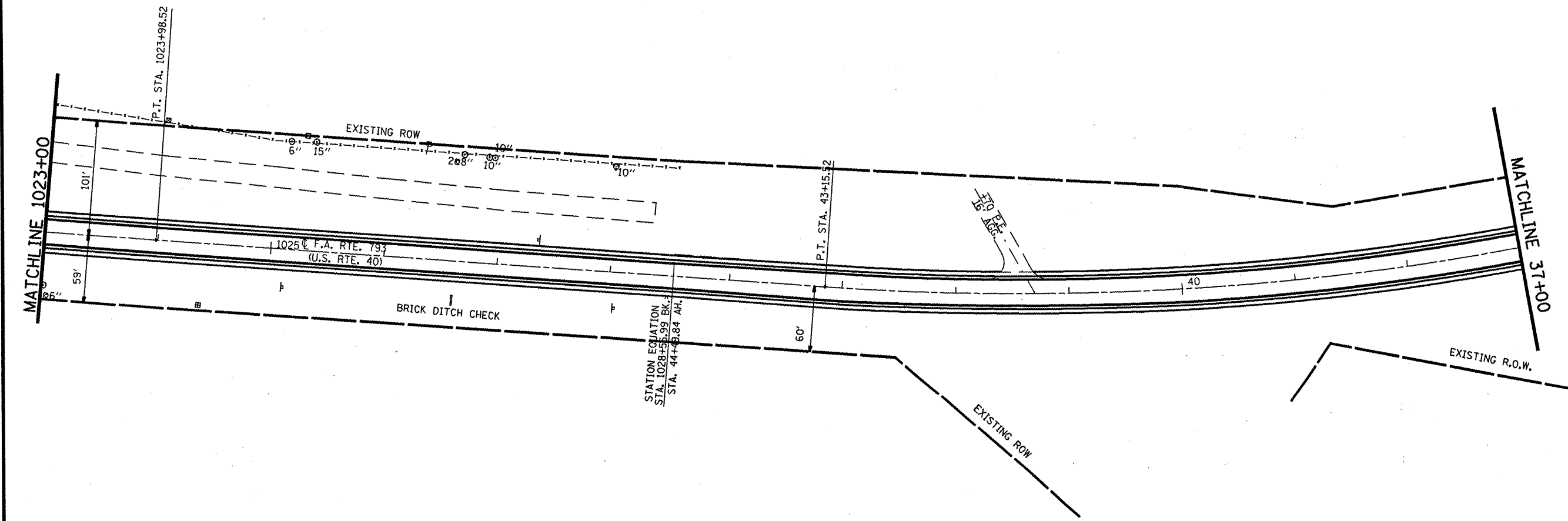
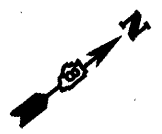

FILE NAME = c:\projects\ed04188\plan\p1n04188a.dgn	USER NAME = eifordb	DESIGNED -	REVISED -
	PLOT SCALE = 100.0000' / IN.	DRAWN -	REVISED -
	PLOT DATE = 3/21/2008	CHECKED -	REVISED -
		DATE -	REVISED -

**STATE OF ILLINOIS  
DEPARTMENT OF TRANSPORTATION**

PROPOSED PLAN SHEET				
SCALE:	SHEET NO.	OF	SHEETS	STA. TO STA.

F.A.P. RTE. 793	SECTION 33-IRS-2	COUNTY MADISON	TOTAL SHEETS 26	SHEET NO. 23
CONTRACT NO. 76868				
FED. ROAD DIST. NO. ILLINOIS FED. AID PROJECT				



SEE DETAILS FOR WORK AT INTERSECTIONS

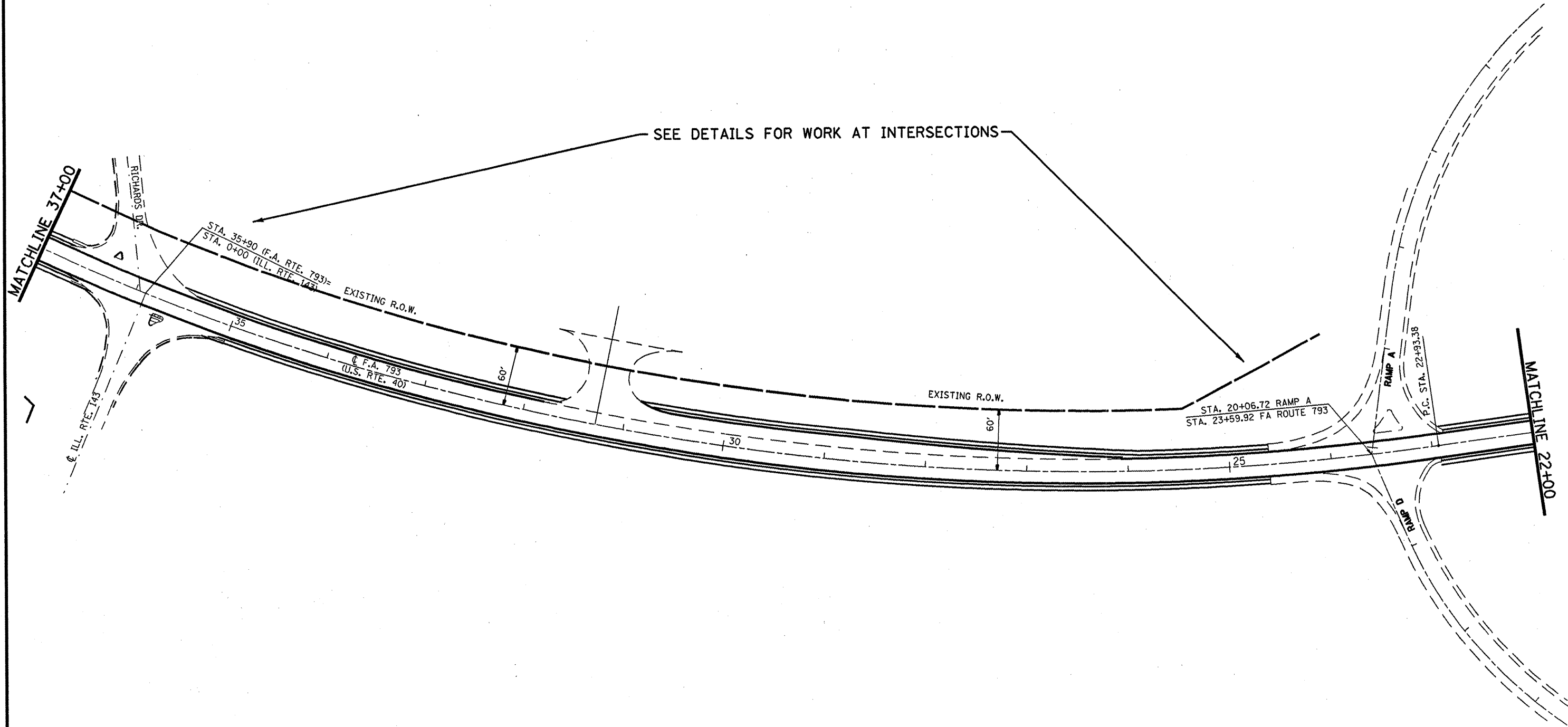

FILE NAME = c:\projects\ed04188\plan\pln04188a.dgn	USER NAME = alfordb	DESIGNED -	REVISED -	<b>STATE OF ILLINOIS DEPARTMENT OF TRANSPORTATION</b>	<b>PROPOSED PLAN SHEET</b>			F.A.P. RTE.	SECTION	COUNTY	TOTAL SHEETS	SHEET NO.
	PLOT SCALE = 100.0000' / 1IN.	DRAWN -	REVISED -					793	33-IRS-2	MADISON	26	24
PLOT DATE = 3/21/2008	CHECKED -	REVISED -	SCALE: SHEET NO. OF SHEETS STA. TO STA.					CONTRACT NO. 76868				
	DATE -	REVISED -	FED. ROAD DIST. NO. ILLINOIS FED. AID PROJECT									



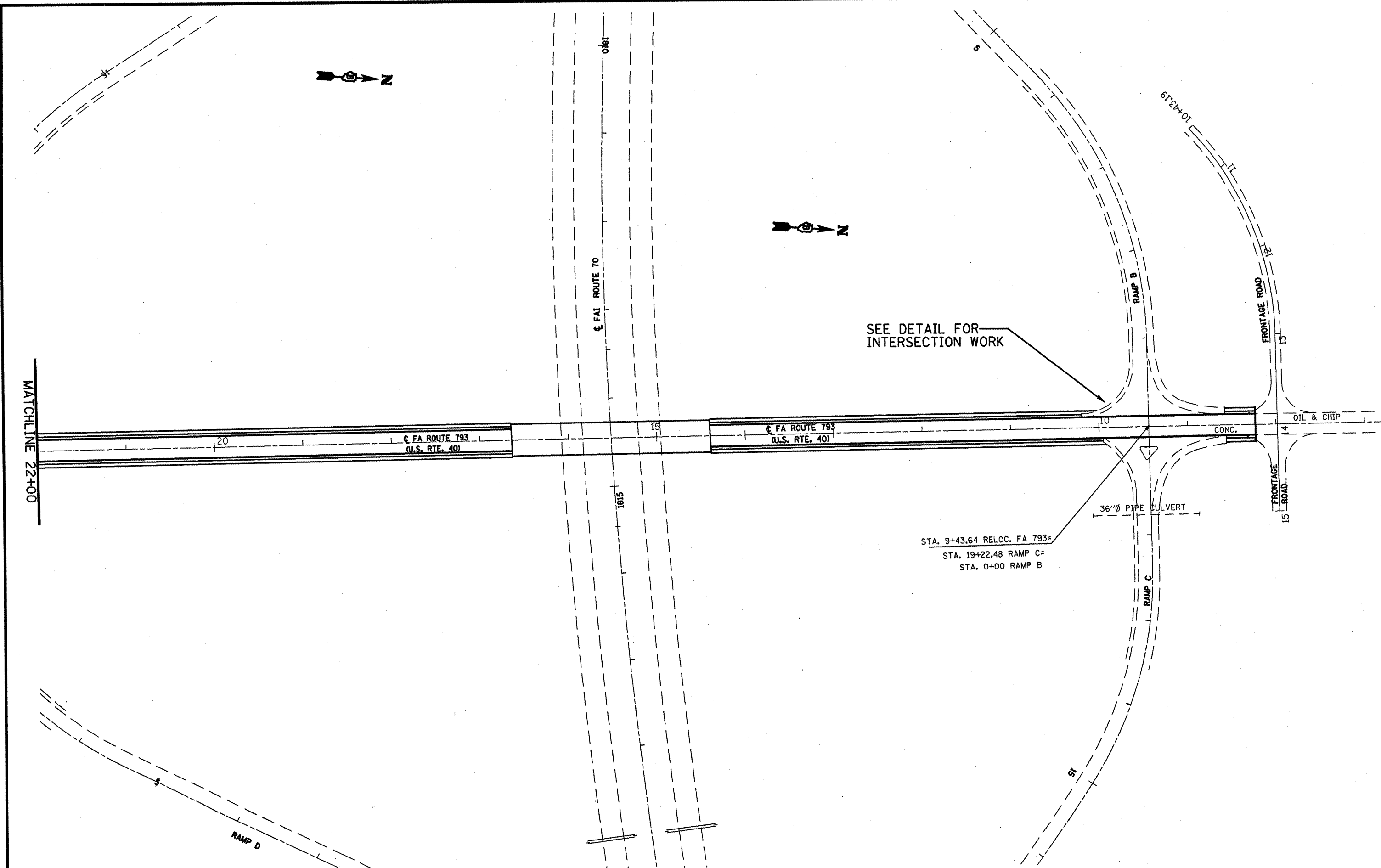

FILE NAME = ca:\projects\ed04108\plan\pin04108a.dgn	USER NAME = a1fordb	DESIGNED -	REVISED -
		DRAWN -	REVISED -
	PLOT SCALE = 100.0000' / IN.	CHECKED -	REVISED -
	PLOT DATE = 3/21/2008	DATE -	REVISED -

**STATE OF ILLINOIS  
DEPARTMENT OF TRANSPORTATION**

PROPOSED PLAN SHEET			
SCALE:	SHEET NO.	OF SHEETS	STA. TO STA.

F.A.P. RTE.	SECTION	COUNTY	TOTAL SHEETS	SHEET NO.
793	33-IRS-2	MADISON	26	25
FED. ROAD DIST. NO. ILLINOIS FED. AID PROJECT			CONTRACT NO. 76B68	

