

ROUTE NO.	SECTION	COUNTY	TOTAL SHEETS	SHEET NO.
T.R. 159	01-1126-00-BR	IROQUOIS	23	1
DOUGLAS ROAD DIST.		ILLINOIS	BROS-075(128)	

CONTRACT NO. 87300

STATE OF ILLINOIS

DEPARTMENT OF TRANSPORTATION

DIVISION OF HIGHWAYS

PLANS FOR PROPOSED HIGHWAY BRIDGE PROGRAM

DOUGLAS ROAD DISTRICT
SECTION 01-1126-00-BR
IROQUOIS COUNTY
PROJECT NO. BROS-075(128)
T.R. ROUTE 159
C-93-029-05

SHEET NO.	INDEX OF SHEETS	TITLE
1.	COVER SHEET	
2.	SUMMARY OF QUANTITIES, GENERAL NOTES & TYPICAL SECTIONS	
3.	PLAN AND PROFILE SHEET	
4.-12.	BRIDGE PLANS	
13.-16.	SOIL BORINGS	
17.-22.	STATION CROSS SECTIONS	
23.	EROSION CONTROL PLAN	

STANDARDS:

280001-04
515001-02
630001-07
630301-04

635006-02
667101
701901
BLR 21-7
BLR 27

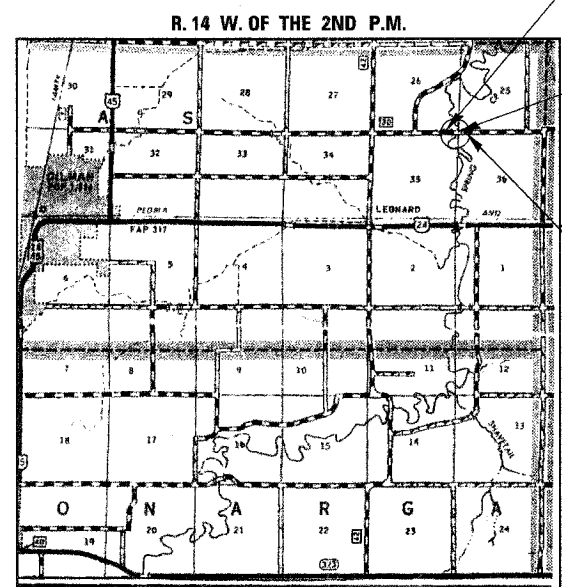
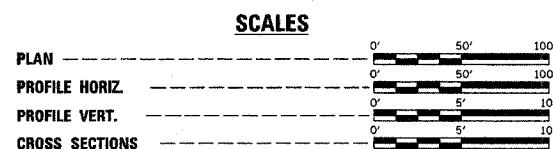

LOCATION PLAN

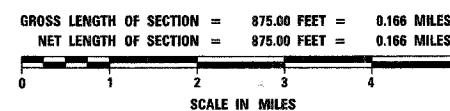

IMPROVEMENT BEGINS
STA. 10 + 00

STA. 14 + 69.94 - SPECIAL BRIDGE DESIGN
PRECAST PRESTRESSED CONCRETE
DECK BEAM BRIDGE - 4 SPANS AT
60', 60', 80', 60': 30' ROADWAY: SKEW = 45° LT.
EXISTING S.N. 038-4030
PROPOSED S.N. 038-4055

IMPROVEMENT ENDS
STA. 18 + 75

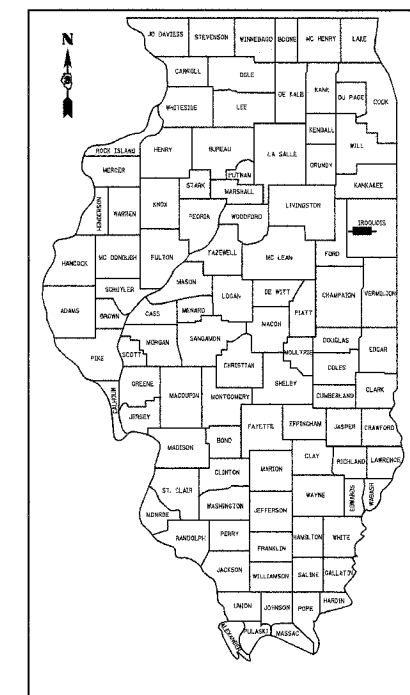

LOCATION OF SECTION INDICATED THUS:

CLASSIFICATION: RURAL TWO-LANE LOCAL ROADS
DESIGN VOLUME: UNDER 250 ADT
CURRENT ADT 81 (2005)
DESIGN SPEED 30 MPH

TOLL FREE JOINT UTILITY LOCATING
INFORMATION FOR EXCAVATORS (J.U.L.I.E.)
TELEPHONE NUMBER 1-800-892-0123

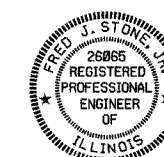

Fred J. Stone, Jr. (11-26-07)
ILLINOIS PROFESSIONAL NO. 26065
EXPIRES 11-30-09

APPROVED	12-11	2007
	<i>Roger Ruffalo</i>	
	ROAD DISTRICT COMMISSIONER	
APPROVED	Dec 12	2007
	<i>Jim ...</i>	
	COUNTY ENGINEER	
PASSED	01-22	2008
	<i>Kenneth ...</i>	
	DISTRICT THREE ENGINEER OF LOCAL ROADS & STREETS	
RELEASING FOR BID	01-22	2008
BASED ON LIMITED		
REVIEW	<i>George F. ...</i>	
	DEPUTY DIRECTOR OF HIGHWAYS, REGION TWO ENGINEER	
	STATE OF ILLINOIS	
	DEPARTMENT OF TRANSPORTATION	

4440 ASH GROVE
SPRINGFIELD, IL 62711
(217) 793-8800
www.fehr-graham.com

FEHR-GRAHAM & ASSOCIATES, LLC
ENGINEERING AND SCIENCE CONSULTANTS
PREPARED BY: MICHAEL S. BOGUELLA, ENGINEER OF ILLINOIS