

F.A.P. RTE.	SECTION	COUNTY	TOTAL SHEETS	SHEET NO.
781	1YRS, 2ZRS-1	CRAWFORD	378	80
STA. 6+450		TO STA. 6+800		
FED. ROAD DIST. NO.	ILLINOIS	FED. AID PROJECT		

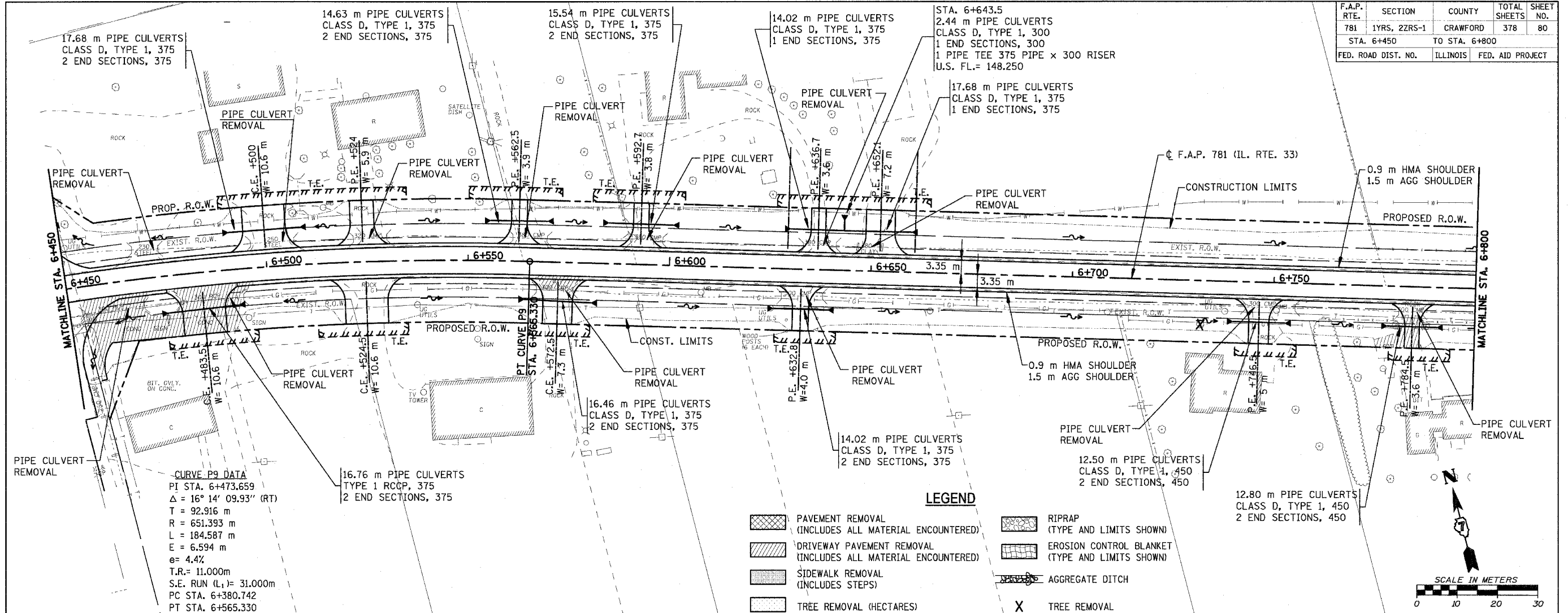

CURVE P9 DATA
 PI STA. 6+473.659
 $\Delta = 16^\circ 14' 09.93''$ (RT)
 T = 92.916 m
 R = 651.393 m
 L = 184.587 m
 E = 6.594 m
 e = 4.4%
 T.R. = 11.000m
 S.E. RUN (L₁) = 31.000m
 PC STA. 6+380.742
 PT STA. 6+565.330

- LEGEND**
- PAVEMENT REMOVAL (INCLUDES ALL MATERIAL ENCOUNTERED)
 - DRIVEWAY PAVEMENT REMOVAL (INCLUDES ALL MATERIAL ENCOUNTERED)
 - SIDEWALK REMOVAL (INCLUDES STEPS)
 - TREE REMOVAL (HECTARES)
 - RIPRAP (TYPE AND LIMITS SHOWN)
 - EROSION CONTROL BLANKET (TYPE AND LIMITS SHOWN)
 - AGGREGATE DITCH
 - TREE REMOVAL

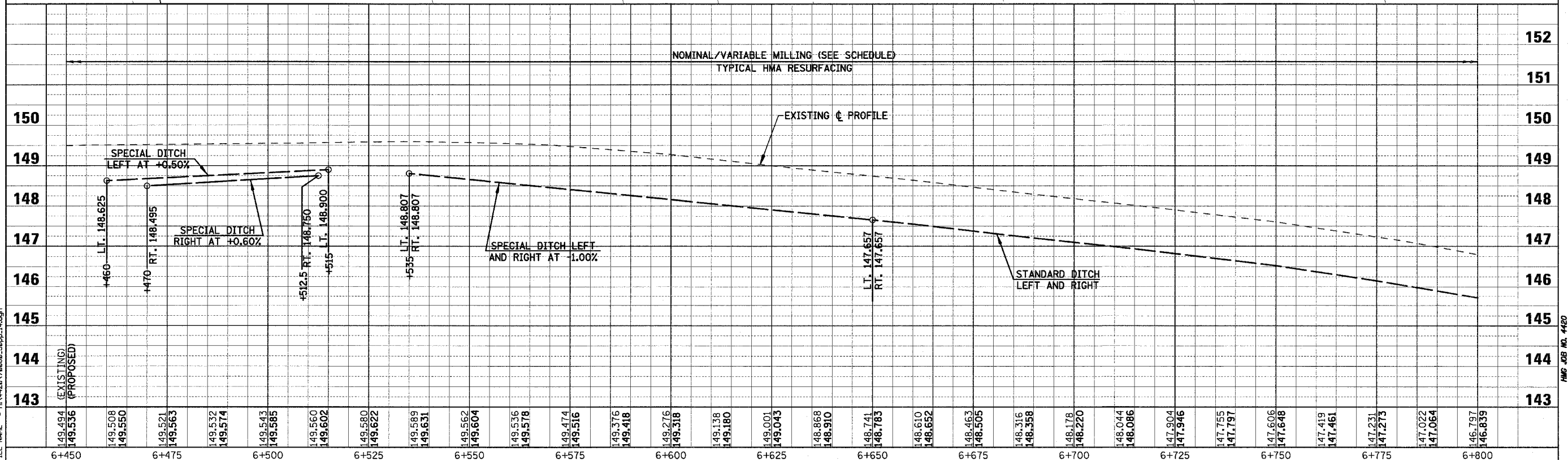
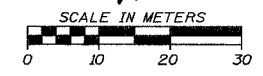

PLOT DATE = 4/18/2008
 FILE NAME = H:\4428\700809_50pp-14.dgn