

F.A.P. RTE.	SECTION	COUNTY	TOTAL SHEETS	SHEET NO.
781	1YRS, 2ZRS-1	CRAWFORD	378	129
STA. 4+025		TO STA. 4+200		
FED. ROAD DIST. NO.		ILLINOIS	FED. AID PROJECT	

- P500 STORM SEWER, CL.A, TY.1, 300 8.496m @ 0.50%
- P501 STORM SEWER, CL.A, TY.1, 300 0.923m @ 0.50%
- P502 STORM SEWER, CL.A, TY.1, 450 108.763m @ 0.40%
- P503 STORM SEWER, CL.A, TY.1, 300 8.496m @ 0.50%
- P504 STORM SEWER, CL.A, TY.1, 300 1.498m @ 2.00%
- P505 STORM SEWER, CL.A, TY.1, 300 8.496m @ 0.50%
- P506 STORM SEWER, CL.A, TY.1, 300 1.498m @ 2.00%
- P507 STORM SEWER, CL.A, TY.1, 300 1.065m @ 1.00%
- P508 STORM SEWER, CL.A, TY.1, 450 16.466m @ 0.40%
- P509 STORM SEWER, CL.A, TY.1, 300 9.610m @ 0.50%
- P510 STORM SEWER, CL.A, TY.1, 300 6.981m @ 0.50%
- P511 STORM SEWER, CL.A, TY.1, 300 8.806m @ 0.50%
- P512 STORM SEWER, CL.A, TY.1, 600 60.815m @ 1.00%
- P513 STORM SEWER, CL.A, TY.1, 300 8.496m @ 0.50%
- P514 STORM SEWER, CL.A, TY.1, 300 1.498m @ 2.00%
- T50 REINFORCED CONC. PIPE TEE 450 PIPE WITH 300 RISER
- T51 REINFORCED CONC. PIPE TEE 450 PIPE WITH 300 RISER
- T52 REINFORCED CONC. PIPE TEE 600 PIPE WITH 300 RISER

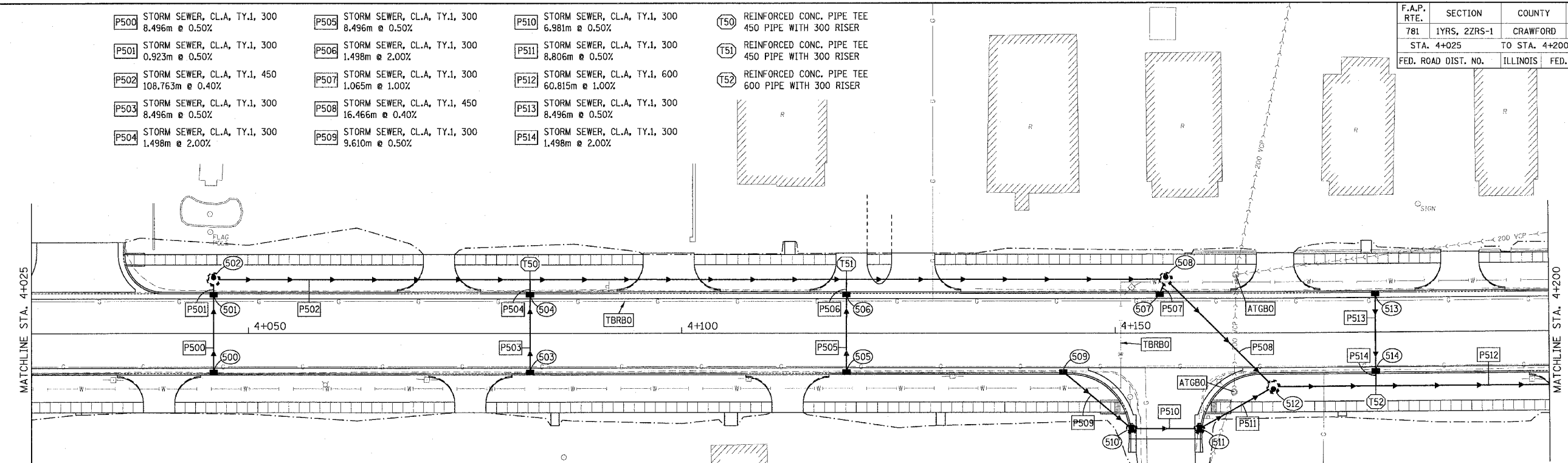

- I500 INLET TY.A, TY.3 F&G STA. 4+046.000, 4.475m RT. GRATE 153.386 INV. 152.400
- I501 INLET TY.A, TY.3 F&G STA. 4+046.000, 4.475m LT. GRATE 153.386 INV. 152.358
- I502 MH, TY.A, RESTRICTED DEPTH 1.2m DIA., TY.1 FRAME, CL. LID STA. 4+046.000, 6.200m LT. SEE DETAIL FOR FRAME OFFSET TOP 153.570 INV.(E) 152.201 INV.(S) 152.353
- I503 INLET TY.A, TY.3 F&G STA. 4+082.500, 4.475m RT. GRATE 153.284 INV. 152.206
- I504 INLET TY.A, TY.3 F&G STA. 4+082.500, 4.475m LT. GRATE 153.284 INV. 152.163
- I505 INLET TY.A, TY.3 F&G STA. 4+119.000, 4.475m RT. GRATE 153.182 INV. 152.017
- I506 INLET TY.A, TY.3 F&G STA. 4+119.000, 4.475m LT. GRATE 153.182 INV. 152.017
- I507 INLET TY.A, TY.3 F&G STA. 4+155.118, 4.475m RT. GRATE 153.024 INV. 151.928
- I508 MH, TY.A, RESTRICTED DEPTH 1.2m DIA., TY.1 FRAME, CL. LID STA. 4+155.833, 6.200m LT. SEE DETAIL FOR FRAME OFFSET TOP 153.235 INV.(W,SE) 151.765 INV.(S,W) 151.917
- I509 INLET TY.A, TY.3 F&G STA. 4+144.000, 4.475m RT. GRATE 153.094 INV. 151.979
- I510 INLET TY.B, RESTRICTED DEPTH 0.9m DIA., TY.3 F&G STA. 4+151.900, 11.000m RT. GRATE 152.887 INV.(NW,E) 151.931
- I511 INLET TY.B, RESTRICTED DEPTH 0.9m DIA., TY.3 F&G STA. 4+159.700, 11.000m RT. GRATE 152.885 INV.(W,NE) 151.896
- I512 MH, TY.A, RESTRICTED DEPTH 1.2m DIA., TY.1 FRAME, CL. LID STA. 4+168.233, 6.200m RT. SEE DETAIL FOR FRAME OFFSET TOP 153.096 INV.(NW) 151.700 INV.(E) 151.547 INV.(SW) 151.852
- I513 INLET TY.A, TY.3 F&G STA. 4+180.000, 4.475m LT. GRATE 152.795 INV. 151.658
- I514 INLET TY.A, TY.3 F&G STA. 4+180.000, 4.475m RT. GRATE 152.795 INV. 151.616

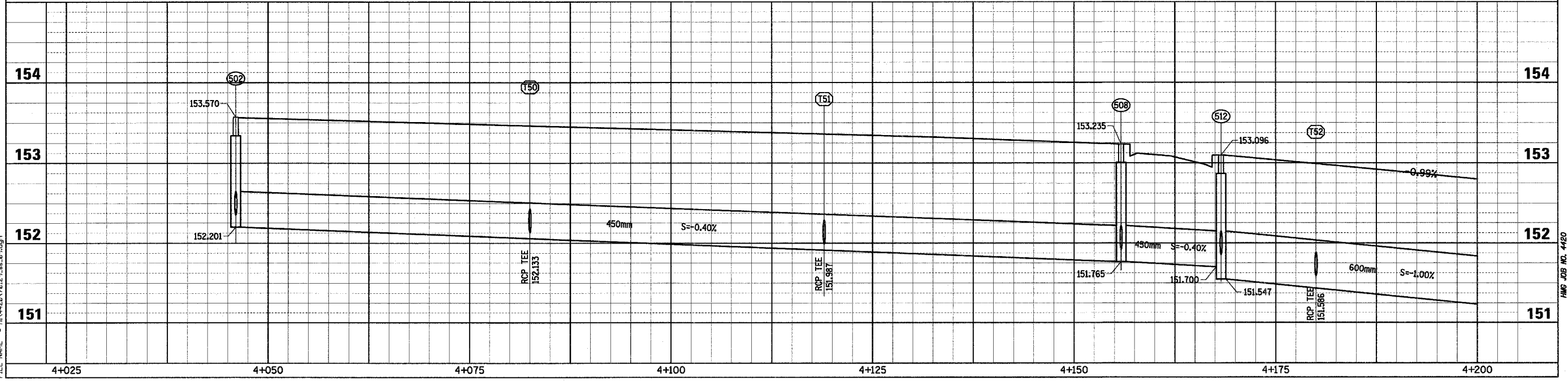
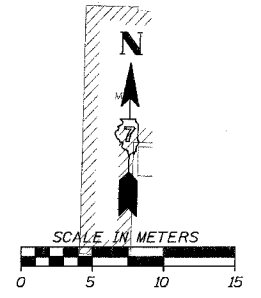

Sheet: 9  
 Angle: 1.3348  
 Chain: P\_IL33

PLOT DATE = 3/23/2008  
 FILE NAME = H:\4422\76125\_swp\_09.dgn

HMG JOB NO. 4420