

09-24-400-011
JAMES J. AND JANE E. PAULEY

PROPOSED 15"
GRAVITY SEWER
BY OTHERS

PROP. CURVE PALIGN-2
PI STA. = 62+85.61
 $\Delta = 3^\circ 17' 05''$ (LT)
 $D = 0^\circ 43' 58''$
 $R = 7,820.00'$
 $T = 224.21'$
 $L = 448.31'$
 $E = 3.21'$
 $\theta = NA$
 $T.R. = NA$
 $S.E. RUN = NA$
P.C. STA. = 60+61.39
P.T. STA. = 65+09.70

MANHOLE T.Y. A, 5 DIA
FST, TYPE 1 F&C
STA. 63+50.48, 13.98' LT
TOP = 428.04
INV = 422.26

09-24-400-016
JAMES MILLER

FAU ROUTE	IDOT SECTION	COUNTY
9380	02-00016-01-PV	ST. CLAIR
FEDERAL AID PROJECT		
IDOT JOB NO.	ILLINOIS	
C-98-318-08		
IDOT CONTRACT NO.	97345	
09-24-400-015 DANIEL BRAYMER		

THOUVENOT, WADE & MOERCHEN, INC.
ENGINEERS • SURVEYORS • PLANNERS



- CORPORATE OFFICE**
4940 OLD COLLINSVILLE RD.
SWANSEA, ILLINOIS 62226
TEL (618) 624-4488
FAX (618) 624-6688
corp@twm-inc.com
- EDWARDSVILLE OFFICE**
1015B CENTURY DRIVE
EDWARDSVILLE, ILLINOIS 62025
TEL (618) 656-4040
FAX (618) 656-4343
edwardsville@twm-inc.com
- ST. LOUIS OFFICE**
1001 CRAIG ROAD, SUITE 260
ST. LOUIS, MISSOURI 63146
TEL (314) 236-5052
FAX (314) 872-2194
stlouis@twm-inc.com
- WATERLOO OFFICE**
113 SOUTH MAIN STREET
WATERLOO, ILLINOIS 62298
TEL (618) 939-5050
FAX (618) 939-3938
waterloo@twm-inc.com

PROFESSIONAL REGISTRATIONS	LICENSE NO.
ILLINOIS PROFESSIONAL DESIGN FIRM	184-001220
PROFESSIONAL ENGINEERING CORP.	62-003370
PROFESSIONAL STRUCTURAL ENGR. CORP.	81-005202
ILLINOIS PROF. LAND SURVEYING CORP.	048-000029
MISSOURI PROFESSIONAL ENGR. CORP.	NC 001528
MISSOURI LAND SURVEYING CORP.	NC 000346

SEAL

Signature:
Signature Date:
Expiration Date:

STATEMENT OF RESPONSIBILITY
I hereby confirm that the document herein to be authorized by my seal is restricted to this sheet, and I hereby disclaim any responsibility for all other drawings, specifications, estimates, reports or other documents or instruments relating to or intended to be utilized for any other part of the architectural, engineering or survey project.

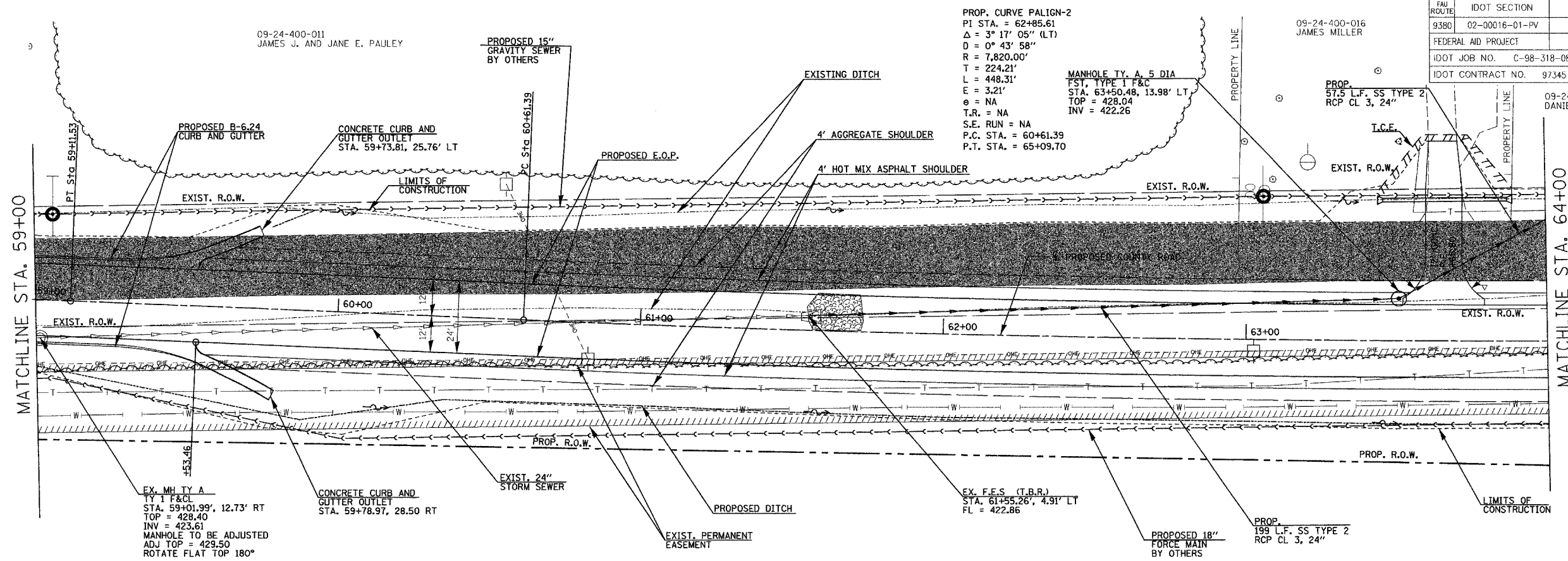

10-19-300-008
CONTEL OF ILLINOIS, INC.

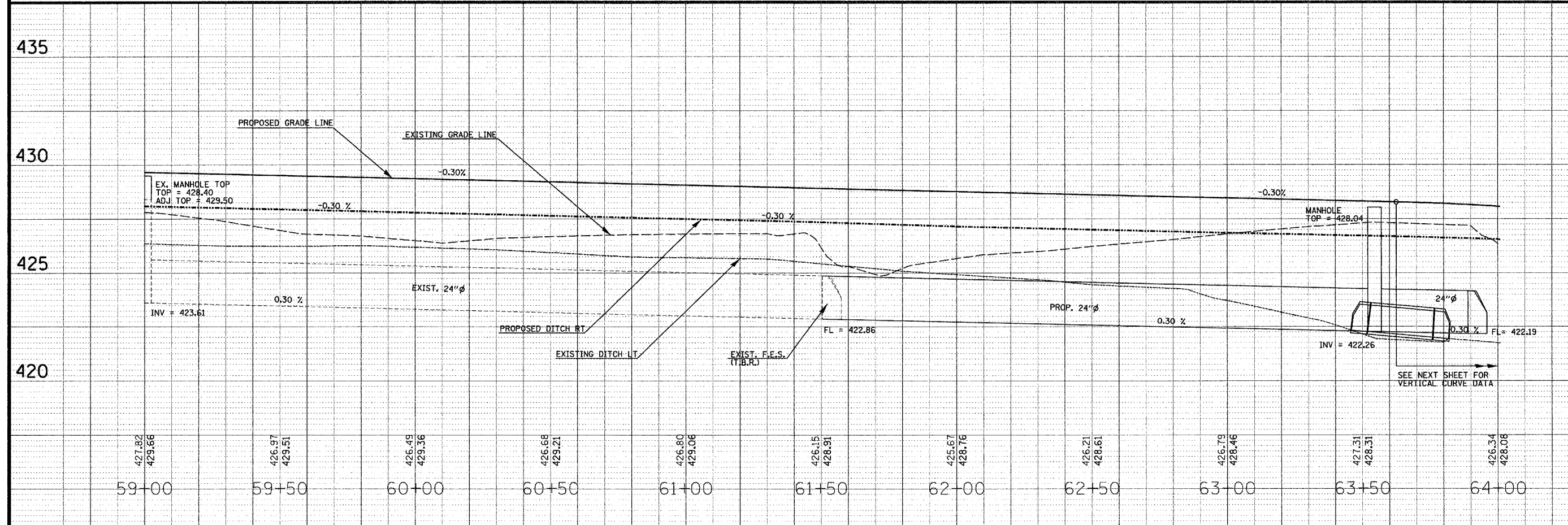
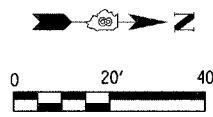

TITLE: COUNTY ROAD ROADWAY PLAN/PROFILES
PROJECT: COUNTY ROAD RECONSTRUCTION - PHASE II CITY OF MASCOUTAH ST. CLAIR COUNTY, ILLINOIS

REV.	DATE	DESCRIPTION
△		
△		
△		

DRAWN BY: MLS
DESIGNED BY: MLS
CHECKED BY: SJK
APPROVED BY:

SHEET 16 OF 113 SHEETS

PROJECT DESCRIPTION: COUNTY ROAD REALIGNMENT

ISSUED FOR REVIEW ISSUED FOR BIDDING
 ISSUED FOR CONSTR. RECORD DRAWING