

DETAIL OF AGGREGATE ENTRANCES

W/ BITUMINOUS SHOULDERS
PRIVATE, COMMERCIAL, & FIELD ENTRANCES

** ALLOWABLE ENTRANCE WIDTHS:
PRIVATE 12' TO 24'
COMMERCIAL 35' MAXIMUM
FIELD 20' MINIMUM
ALLOWABLE ENTRANCE WIDTH SHALL BE INTERPRETED TO BE THE WIDTHS AT THE SPECIFIED COMPLETED RADIUS.

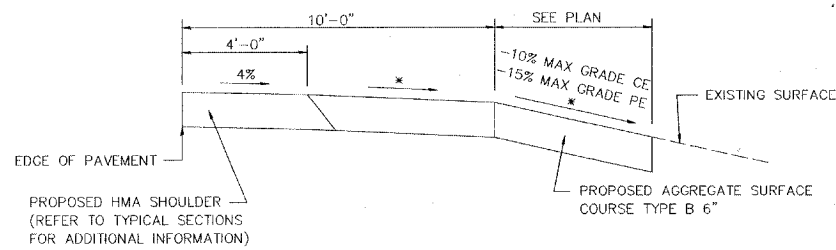
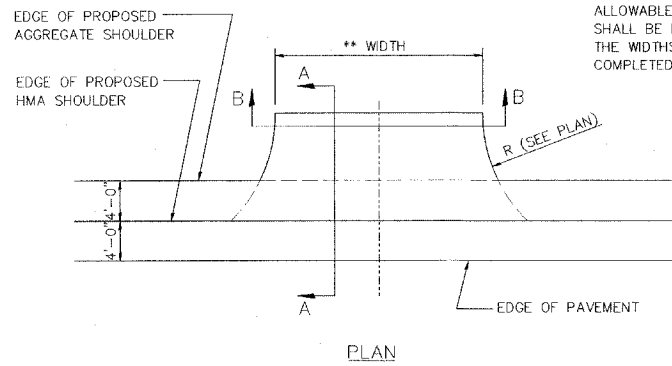

SECTION A-A WITH NEGATIVE GRADE
* SEE CROSS SECTIONS FOR SLOPES

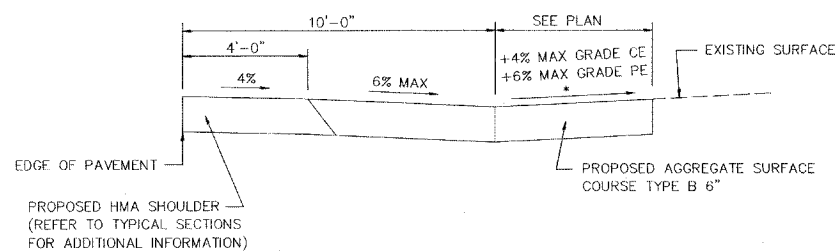

SECTION A-A WITH POSITIVE GRADE
* SEE CROSS SECTIONS FOR SLOPES

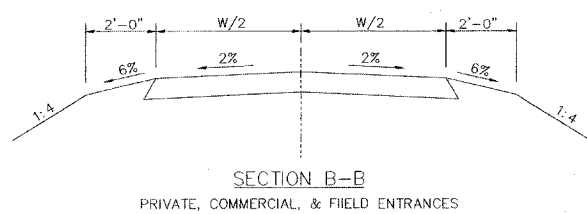

DETAIL OF CONCRETE ENTRANCES

W/ BITUMINOUS SHOULDERS
PRIVATE & COMMERCIAL ENTRANCES

** ALLOWABLE ENTRANCE WIDTHS:
PRIVATE 12' TO 24'
COMMERCIAL 35' MAXIMUM
ALLOWABLE ENTRANCE WIDTH SHALL BE INTERPRETED TO BE THE WIDTHS AT THE SPECIFIED COMPLETED RADIUS.

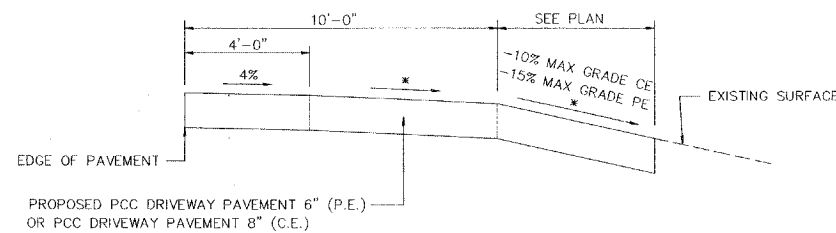
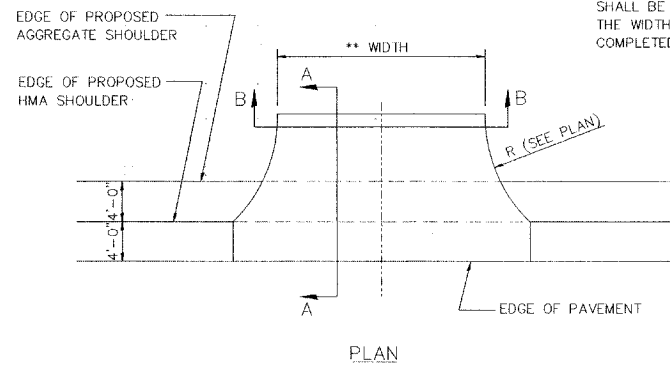

SECTION A-A WITH NEGATIVE GRADE
* SEE CROSS SECTIONS FOR SLOPES

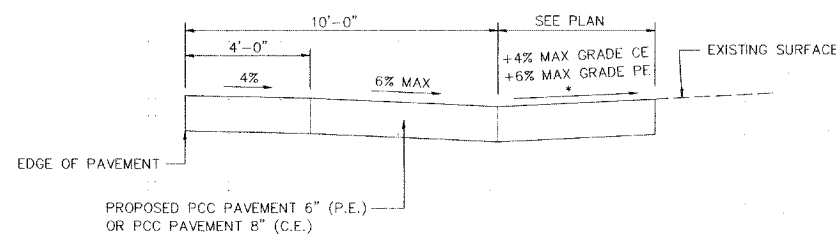

SECTION A-A WITH POSITIVE GRADE
* SEE CROSS SECTIONS FOR SLOPES

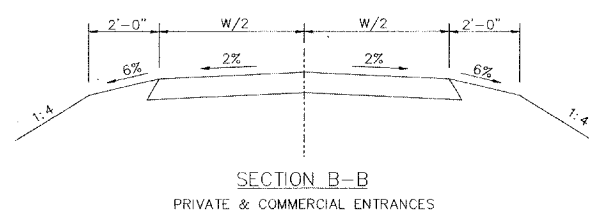

DETAIL OF HMA ENTRANCES

W/ BITUMINOUS SHOULDERS
PRIVATE, COMMERCIAL, & SIDEROADS

** ALLOWABLE ENTRANCE WIDTHS:
PRIVATE 12' TO 24'
COMMERCIAL 35' MAXIMUM
ALLOWABLE ENTRANCE WIDTH SHALL BE INTERPRETED TO BE THE WIDTHS AT THE SPECIFIED COMPLETED RADIUS.

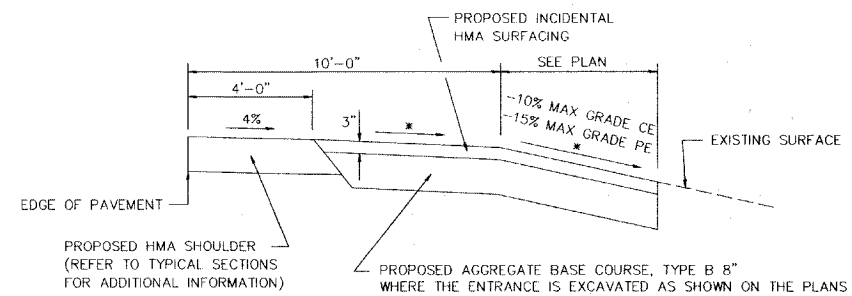
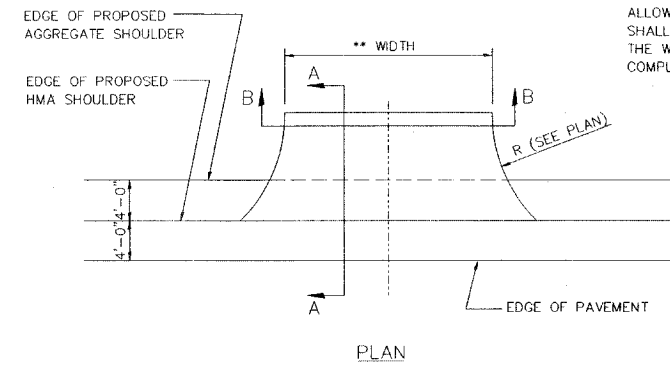

SECTION A-A WITH NEGATIVE GRADE
* SEE CROSS SECTIONS FOR SLOPES

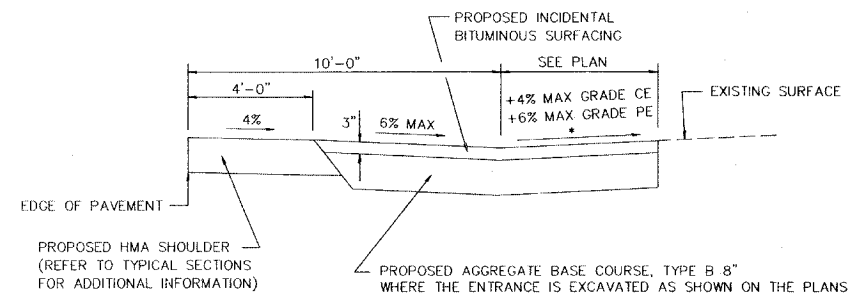

SECTION A-A WITH POSITIVE GRADE
* SEE CROSS SECTIONS FOR SLOPES

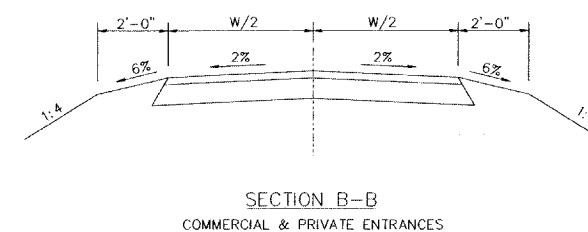

FBI ROUTE	IDOT SECTION	COUNTY
9380	02-00016-01-PV	ST. CLAIR
FEDERAL AID PROJECT	ILLINOIS	
IDOT JOB NO.	C-98-318-08	
IDOT CONTRACT NO.	97345	

THOUVENOT, WADE & MOERCHEN, INC.
ENGINEERS • SURVEYORS • PLANNERS



- CORPORATE OFFICE**
4940 OLD COLLINSVILLE RD.
SWANSEA, ILLINOIS 62226
TEL (618) 624-4488
FAX (618) 624-6688
corp@twm-inc.com
- EDWARDSVILLE OFFICE**
1015B CENTURY DRIVE
EDWARDSVILLE, ILLINOIS 62025
TEL (618) 656-4040
FAX (618) 656-4343
edwardsville@twm-inc.com
- ST. LOUIS OFFICE**
1001 CRAIG ROAD, SUITE 260
ST. LOUIS, MISSOURI 63146
TEL (314) 236-5052
FAX (314) 872-2194
stlouis@twm-inc.com
- WATERLOO OFFICE**
113 SOUTH MAIN STREET
WATERLOO, ILLINOIS 62298
TEL (618) 939-5050
FAX (618) 939-3938
waterloo@twm-inc.com

PROFESSIONAL REGISTRATIONS	LICENSE NO.
ILLINOIS PROFESSIONAL DESIGN FIRM	184-00120
PROFESSIONAL ENGINEERING CORP.	62-035370
PROFESSIONAL STRUCTURAL ENGR. CORP.	81-005202
ILLINOIS PROF. LAND SURVEYING CORP.	048-000029
MISSOURI PROFESSIONAL ENGR. CORP.	MC 001528
MISSOURI LAND SURVEYING CORP.	MC 000346

Signature: _____
Signature Date: _____
Expiration Date: _____

STATEMENT OF RESPONSIBILITY
I hereby confirm that the document herein to be authenticated by my seal is restricted to this sheet, and I hereby disclaim any responsibility for all other drawings, specifications, estimates, reports or other documents or instruments relating to or intended to be utilized for any other part of the architectural, engineering or survey project.

ENTRANCE DETAILS
COUNTY ROAD RECONSTRUCTION - PHASE II
CITY OF MASCOUTAH
ST. CLAIR COUNTY, ILLINOIS

REV.	DATE	DESCRIPTION

DRAWN BY: BJC	SHEET
DESIGNED BY: BJC	54
CHECKED BY: SJK	OF 113 SHEETS
APPROVED BY: _____	PROJECT DESCRIPTION
PROJECT NUMBER: 120-010154	COUNTY ROAD REALIGNMENT
<input checked="" type="checkbox"/> ISSUED FOR REVIEW	<input type="checkbox"/> ISSUED FOR BIDDING
<input type="checkbox"/> ISSUED FOR CONSTR.	<input type="checkbox"/> RECORD DRAWING