

ROUTE NO.	SECTION	COUNTY	TOTAL SHEETS	SHEET NO.
F.A.U. 9641	05-00100 -00-FP	WILLIAMSON	53	07
ILLINOIS		FAIR STREET		

CONTRACT NO. 99309

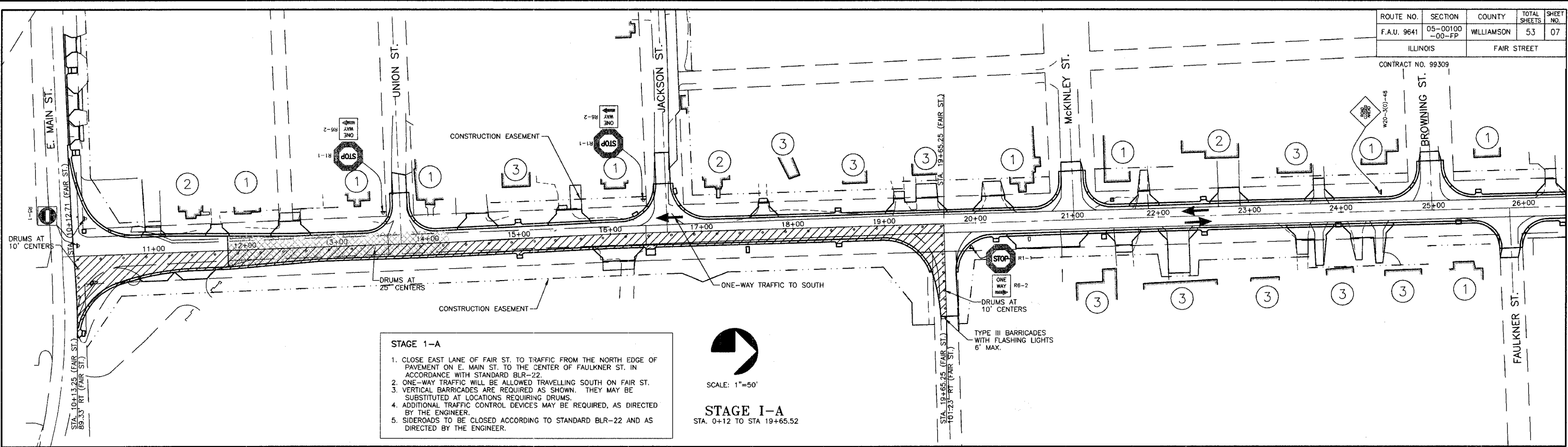

STAGE 1-A

1. CLOSE EAST LANE OF FAIR ST. TO TRAFFIC FROM THE NORTH EDGE OF PAVEMENT ON E. MAIN ST. TO THE CENTER OF FAULKNER ST. IN ACCORDANCE WITH STANDARD BLR-22.
2. ONE-WAY TRAFFIC WILL BE ALLOWED TRAVELLING SOUTH ON FAIR ST.
3. VERTICAL BARRICADES ARE REQUIRED AS SHOWN. THEY MAY BE SUBSTITUTED AT LOCATIONS REQUIRING DRUMS.
4. ADDITIONAL TRAFFIC CONTROL DEVICES MAY BE REQUIRED, AS DIRECTED BY THE ENGINEER.
5. SIDEROADS TO BE CLOSED ACCORDING TO STANDARD BLR-22 AND AS DIRECTED BY THE ENGINEER.

SCALE: 1"=50'

STAGE I-A
STA. 0+12 TO STA 19+65.52

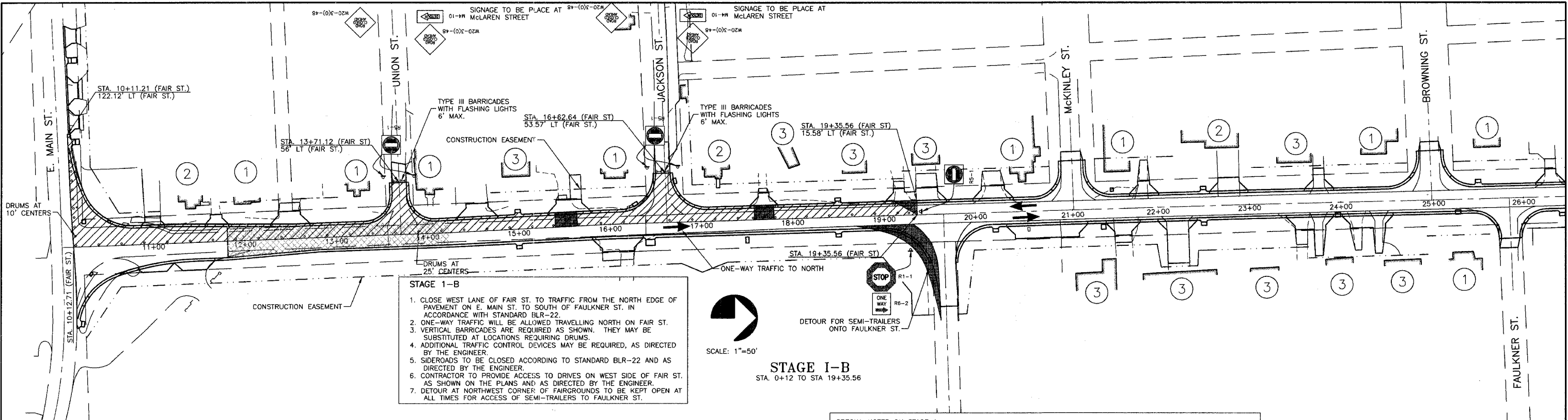

STAGE 1-B

1. CLOSE WEST LANE OF FAIR ST. TO TRAFFIC FROM THE NORTH EDGE OF PAVEMENT ON E. MAIN ST. TO SOUTH OF FAULKNER ST. IN ACCORDANCE WITH STANDARD BLR-22.
2. ONE-WAY TRAFFIC WILL BE ALLOWED TRAVELLING NORTH ON FAIR ST.
3. VERTICAL BARRICADES ARE REQUIRED AS SHOWN. THEY MAY BE SUBSTITUTED AT LOCATIONS REQUIRING DRUMS.
4. ADDITIONAL TRAFFIC CONTROL DEVICES MAY BE REQUIRED, AS DIRECTED BY THE ENGINEER.
5. SIDEROADS TO BE CLOSED ACCORDING TO STANDARD BLR-22 AND AS DIRECTED BY THE ENGINEER.
6. CONTRACTOR TO PROVIDE ACCESS TO DRIVES ON WEST SIDE OF FAIR ST. AS SHOWN ON THE PLANS AND AS DIRECTED BY THE ENGINEER.
7. DETOUR AT NORTHWEST CORNER OF FAIRGROUNDS TO BE KEPT OPEN AT ALL TIMES FOR ACCESS OF SEMI-TRAILERS TO FAULKNER ST.

SCALE: 1"=50'

STAGE I-B
STA. 0+12 TO STA 19+35.56

LEGEND

- ① HAS ACCESS FROM SIDE STREET DURING CONSTRUCTION.
- ② HAS ACCESS FROM REAR ALLEY DURING CONSTRUCTION.
- ③ HAS ACCESS FROM STREET ONLY.
- [Hatched Box] STAGING AREA
- [Solid Black Box] TEMPORARY GRAVEL ACCESS
- [Cross-hatched Box] AREA FOR WIDENING ONLY

SPECIAL NOTES ON STAGE 1:

THE CONTRACTOR SHALL PERFORM THE WORK IN ACCORDANCE WITH THE FOLLOWING SCHEDULE:

1. IF THE CONSTRUCTION FOR STAGE 1 CAN BE SUBSTANTIALLY COMPLETED, TO ALLOW TWO-WAY TRAFFIC, PRIOR TO AUGUST 2, 2008, THE CONTRACTOR SHALL WORK ON STAGE 1 PRIOR TO ANY LANE CLOSURES ON THE OTHER STAGES.
2. IF CONSTRUCTION OF STAGE 1 CANNOT BE SUBSTANTIALLY COMPLETED TILL AFTER AUGUST 2, 2008, THE CONTRACTOR SHALL NOT CLOSE ANY LANES ON STAGE 1 TILL AFTER AUGUST 9, 2008.
3. ANY REQUIRED DRAINAGE WORK IN THE STAGE 1 AREA SHALL BE IN PLACE PRIOR TO AUGUST 2, 2008.
4. NO WORK OF ANY KIND, EXCEPT TRAFFIC CONTROL, SHALL BE PERFORMED ON ANY STAGE OF CONSTRUCTION DURING THE WEEK OF AUGUST 2, 2008 TO AUGUST 9, 2008, DUE TO THE WILLIAMSON COUNTY FAIR. DURING FAIR WEEK, A MINIMUM OF ONE-WAY TRAFFIC, SOUTHBOUND, SHALL BE MAINTAINED ALONG ANY STAGE UNDER CONSTRUCTION WHERE THERE IS ONE-WAY TRAFFIC. ALL AREAS NOT UNDER CONSTRUCTION WILL REMAIN TWO-WAY.

OTHERWISE, THE SEQUENCING OF THE STAGES IS AT THE DISCRETION OF THE CONTRACTOR, WITH THE APPROVAL OF THE ENGINEER.

STATE OF ILLINOIS PROFESSIONAL DESIGN FIRM LICENSE NO. 184-004515

© 2008 ALL RIGHTS RESERVED

CLARIDA & ZIEGLER ENGINEERING CO.
308 South Court St. P.O. Box 937
Marion, Illinois 62959
Phone - (618)993-6411, Fax - (618)993-6750

**STAGING PLAN
FAIR STREET WIDENING
MARION, ILLINOIS**

REVISIONS	DATE	NO.

Date: 2/26/08 DR. By: P.L.D. CK'D By: H.C.G.
Scale: 1"=50' Job No.: 05142 Sheet No.: 7 of 53